

XPERIA 1 II

SOG01

Basic Manual

Online Manual (Japanese)

Check "Online Manual" (Japanese) which describes detail explanations on various functions on the product from this procedure.

In the Home screen, slide the screen up → [お客様サポート (Customer support)] → [取扱説明書 (Online Manual)] (Japanese)

Also, you can check "Online Manual" (Japanese) on the au homepage.
<https://www.au.com/online-manual/sog01/> (Japanese)



Descriptions in this manual are based on Android™ 10. For the latest edition, refer to the "Online Manual" (Japanese) or "取扱説明書 (詳細版) (Full instruction manual)" (Japanese) available on the au homepage.
<https://www.au.com/support/service/mobile/guide/manual/> (Japanese)

*3 For details on handling au IC card (SIM card), refer to the "Online Manual" (Japanese) or "取扱説明書 (詳細版) (Full instruction manual)" (Japanese) available on au homepage.

*4 The back cover is not removable. Removing forcibly might cause damage or a malfunction. Also, battery is built into the main unit and not removable by customers.

FCC ID

To view the regulatory compliance mark

In the Home screen, slide the screen up → [Settings] → [About phone] → [Certificates] Regulatory compliance mark such as FCC ID is displayed on the screen.

au IC card (SIM card)

Your phone number etc. is recorded in au IC card (SIM card).

The product is compatible with au Nano IC Card 04.

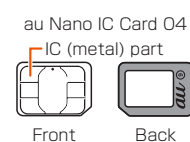

3 Keep the product horizontal and then push the tray in straight
 Pay attention to the direction the tray is being pushed in.
 Firmly press where circled **O**, and check that there is no gap between the main unit and the microSD memory card/au IC card (SIM card) slot cover.

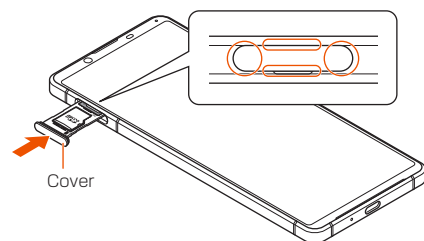

Preface

Thank you for buying "Xperia 1 II" (simply called "the product" or "main unit" from here on). Before using the product, read "Basic Manual" (this manual) and "Cautions on using the product" for proper handling.

About Operating Instructions

■ "Basic Manual" (this manual)
 Handles only basic operations for main features.

■ "Online Manual" (Japanese)
 Check "Online Manual" (Japanese) which describes detail explanations on various functions on the product from this procedure. For details on checking, see "Checking the Online Manual" in this manual.

■ "取扱説明書 (Full Instruction Manual)" (Japanese)
 For detailed descriptions on various functions, you can refer to the "取扱説明書 (詳細版) (Full Instruction Manual)" (Japanese) available on the au homepage.
<https://www.au.com/support/service/mobile/guide/manual/> (Japanese)



■ For Those Requiring an English Instruction Manual
Download URL:
<https://www.au.com/english/support/manual/>

Regarding notations used in this document

- In this manual, operations of tapping menu items/ icons/buttons on the screen, etc. are indicated as [(name of the item, etc.)].
- In this manual, screens and operations for the product with au Nano IC Card 04 attached are described.
- Screen illustrations shown in this manual may look different from the actual screens. In some cases, minor details or a part of a screen may be omitted.
- In this manual, "クイックスタートガイド (Quick Start Guide)" (Japanese), "Basic Manual" (this manual), "Cautions on using the product" and "取扱説明書 (詳細版) (Full instruction manual)" (Japanese) are collectively referred to as "Instruction Manual".
- In this manual, explanations for the wallpaper "Black" are provided.
- In this manual, operations in portrait view are described as a standard. In horizontal view, menu items, icons, buttons on the screen, etc. may differ.
- In this manual, "au Nano IC Card 04" is abbreviated as "au IC card (SIM card)".

Attaching/removing au IC card (SIM card)

Before attaching/removing au IC card (SIM card), make sure to turn off the product.

■ Attaching au IC card (SIM card)

1 Remove the tray from the main unit
 Put your fingertip (nail) into the groove of the microSD memory card/au IC card (SIM card) slot and draw the cover straight out.

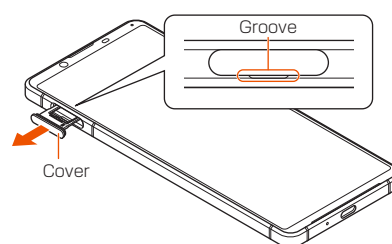

Charging

When you purchase your product, the internal battery is not fully charged. Charge the battery before use.

❖Information

- When charging starts, the Notification LED of the product lights according to the battery level. To check the battery level, see the status bar in the top of the screen, or in the Home screen, slide the screen up → [Settings] → [Battery].
- If you start charging with the product turned off, a screen launches indicating the charging status but operations are not available. Thus, do not charge the product in a place where the use is prohibited.
- The charging time may take longer when charging with a PC or while using the camera function.

■ Charging with the AC Adapter

Charging with connecting TypeC Common AC Adapter 02 (sold separately) is explained.

1 Insert the power plug of TypeC Common AC Adapter 02 (sold separately) into an outlet

- In this manual, "microSD™ memory card (commercially available)", "microSDHC™ memory card (commercially available)" and "microSDXC™ memory card (commercially available)" are abbreviated as "microSD memory card".
- All of the indicated amounts exclude tax unless otherwise specified.
- Company names and product names referred to in this manual are trademarks or registered trademarks of respective companies. The TM and ® marks may be omitted in this manual.
- "The Company" as appears in the manual refers to these companies:
 Sold by: KDDI CORPORATION, OKINAWA CELLULAR TELEPHONE COMPANY
 Manufactured by: Sony Mobile Communications Inc.

Packaged items

Before you start using the product, make sure that you have all these packaged items with the product.

- Xperia 1 II
- Sony mobile TV Antenna cable 03 (04SOHSA)
- クイックスタートガイド (Quick Start Guide) (Japanese)
- ご利用にあたっての注意事項 (Cautions on using the product) (Japanese)
- microSD memory card
- Earphones
- USB Type-C™ cable

These items are not included in the package.

- microSD memory card
- AC adapter
- Earphones
- USB Type-C™ cable

❖Information

- Purchase a specified charger (sold separately).
- The battery is built into the product.
- Illustrations used in this manual are just images for explanations. They may be different from actual ones.

3 Keep the product horizontal and then push the tray in straight
 Pay attention to the direction the tray is being pushed in.
 Firmly press where circled **O**, and check that there is no gap between the main unit and the microSD memory card/au IC card (SIM card) slot cover.

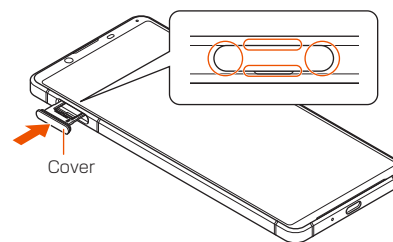

Getting Ready

Names and functions of parts

- Headset connection terminal
- Second microphone^{*1}: Reduces noise so that the other party can easily hear your voice.
- microSD memory card/au IC card (SIM card) slot
- Front camera
- Earpiece/Speaker
- Proximity/Light sensor: Switches the touch panel on and off to prevent from erroneous operation during a call/Auto-control for display brightness.
- Notification LED (▶P.8)
- Display (Touch panel)
- Speaker
- Mouthpiece/Microphone^{*1}
- USB Type-C connection terminal

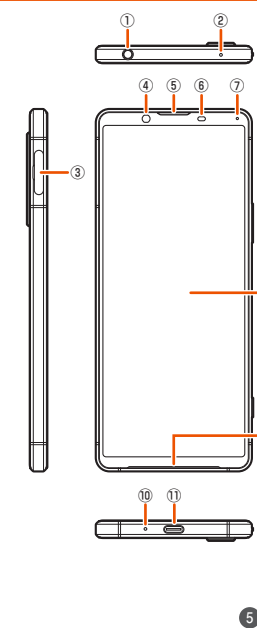

- Volume key/Zoom key
- Power key/Screen lock key/Fingerprint sensor
- Camera key
- Flash/Photo light
- RGBC-IR sensor: Detects element of lighting source of shooting environment to adjust white balance automatically when shooting.
- Wi-Fi® antenna^{*2}
- 5G/4G antenna/Wi-Fi® antenna^{*2}
- 5G/4G antenna^{*2}
- Camera lens
- au IC card (SIM card)^{*3}
- 5G/4G antenna/Wi-Fi®/GPS/Bluetooth® antenna^{*2}
- Laser AF sensor: Autofocuses for shooting based on subject distance.
- mark
- Wireless charging position
- Back cover^{*4}

*1 Do not jab with a sharp object such as a needle. Doing so may cause a malfunction.
 *2 The antenna is built into the main unit. Covering around the antenna by your hand may affect the quality of call/communication.

Attaching/Removing a microSD memory card

Before attaching/removing microSD memory card, make sure to turn off the product.

■ Attaching a microSD memory card

1 Remove the tray from the main unit
 Put your fingertip (nail) into the groove of the microSD memory card/au IC card (SIM card) slot and draw the cover straight out.

2 Set a microSD memory card into the tray with the terminal side facing down
 Surely set a microSD memory card into the tray not to come off.

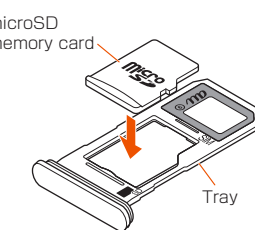

Locking the screen/Unlocking screen lock

■ Locking the screen

Turn off the screen to set sleep mode to prevent the touch panel or key from operating mistakenly or lock the screen.

1 While the screen is displayed, press Power key

■ Unlocking screen lock

The lock screen appears when turning the power on or sleep mode is canceled by pressing Power key.

- While Ambient display (which allows you to check date & time or notifications in sleep mode) is activated, double-tap the screen or press Power key to display the lock screen.

1 On the lock screen, swipe (flick) the screen up

❖Information

- In the lock screen, swipe (flick) or to use Google Assistant or Camera.

Turning the power on/off

■ Turning the power on

1 Press and hold Power key until the product vibrates once
 The lock screen appears.
 When "ようこそ (Welcome)" appears after the product is powered on, follow the onscreen instructions to set the initial settings.
 For details on the initial settings, see "Initial settings" in this manual.
 Swiping (flicking) the screen up displays the Home screen.

■ Turning the power off

1 Press and hold Power key (over one sec.)

2 [Power off]

❖Information

- To restart the product in safe mode (start with almost default state), press and hold Power key (over one sec.) → Long-touch "Power off" → [OK].

■ Forcibly turning the power off

1 Press and hold Power key and the upper part of the volume key at the same time for approximately nine seconds, and release your fingers after the product vibrates three times consecutively

2 Insert the USB Type-C plug of TypeC Common AC Adapter 02 (sold separately) into the USB Type-C connection terminal of the product straight
 When charging is started with the product powered on, the start sound for charging sounds and the Notification LED of the product lights.

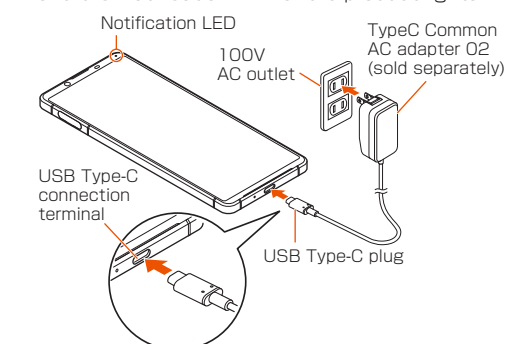

3 When charging is complete, remove the USB Type-C plug of TypeC Common AC Adapter 02 (sold separately) from the product

4 Remove the power plug of TypeC Common AC Adapter 02 (sold separately) from the outlet

Initial settings

When "ようこそ (Welcome)" appears after the product is powered on, follow the onscreen instructions to set functions and services.

- 1 [GET STARTED]
- 2 Confirm important information
- 3 Set a network connection method
- 4 Set copying apps and data
- 5 Set up a Google account
- 6 Set Google services
- 7 Set screen lock or the unlock method of using fingerprint
- 8 Set up Google assistant
- 9 Set up Google Pay
- 10 Set up additional apps
- 11 Set up more things
- 12 [FINISH] on the setup finishing screen
- 13 Perform au initial settings
Tapping [Finish] on the au initial setup finishing screen displays the Home screen.

21

Setting the lighting time of screen

The screen turns off automatically when the set time has elapsed while no operation is made. When you cannot operate readily because the screen turns off soon, change the lighting time.

- 1 In the Home screen, slide the screen up → [Settings] → [Display] → [Screen timeout]
- 2 Select the lighting time

28

au-mail setting

- To use au-mail, subscription to 5G NET is required. If you did not subscribe it when you purchased the product, contact an au shop or Customer Service Center.
- Perform the initial settings in a place with good signal condition in Japan. If you perform in a place with bad signal condition or while moving, the settings may fail. The initial setting cannot be made via Wi-Fi® communication.
- Depending on time zone, the initial settings may take from 30 seconds to 3 minutes. Wait for a while with "Eメールアドレスの設定中です。しばらくお待ちください。 (Setting email address. Wait for a while.)" displayed on the screen.

22

Appendix

Peripheral devices

- Sony mobile TV Antenna cable 03 (04SOHSA)
- TypeC Common AC Adapter 01 (0601PQA) (sold separately)
- TypeC Common AC Adapter 02 (0602PQA) (sold separately)
- Common AC Adapter 05 (0501PWA) (sold separately)^{*1}
- Common DC Adapter 03 (0301PEA) (sold separately)^{*1}
- Wireless Charging Stand 02 (0102PUA) (sold separately)
- Micro-B Type-C Adapter (0601PHA) (sold separately)

^{*1} For use, Micro-B Type-C Adapter (sold separately) is needed.

❖Information

- Accessories can be purchased from the au Online Shop.
<https://onlineshop.au.com/> (Japanese)

29

Making the initial settings

- 1 In the Home screen, slide the screen up → [au-mail]
- 2 Follow the onscreen instructions

Checking your au-mail address

- 1 In the Home screen, slide the screen up → [au-mail] → [☰] → [E-mail information]

Checking the operations of au-mail app

You can check the operations of au-mail app from "Operation guide".

- 1 In the Home screen, slide the screen up → [au-mail] → [☰] → [Operation guide]

- 2 Tap the item to check

You can check instructions by "au動画ガイド" (au movie guide).

Changing your au-mail address

- 1 In the Home screen, slide the screen up → [au-mail] → [☰] → [Change Address/Setting Filter] → [OK]

- 2 Follow the onscreen instructions

23

Main specifications

■ Main unit

Display	Approx. 6.5 inches Organic EL (HDR-capable). Approx. 16.77 million colors 1,644 x 3,840 dots
Weight	Approx. 181 g
Dimension (W x H x T)	Approx. 72 mm x 166 mm x 7.9 mm (9.1 mm where thickest)
Internal memory	ROM: Approx. 128 GB RAM: Approx. 8 GB
External memory	micro SD: Compatible up to 2 GB micro SDHC: Compatible up to 32 GB micro SDXC: Compatible up to 1 TB (As of April, 2020)
Camera pixels	Camera: Effective pixels Approx. 12.2 million pixels/12.2 million pixels Front camera: Effective pixels Approx. 8 million pixels

30

Transferring data from au Settings Menu

Import or export data between the product and your previous au mobile phone by using microSD memory card or via the au server.

- To import data via the au server, save data to the au server from your previous au mobile phone in advance. To use the au server, set au ID (If there is no au Settings Menu on your previous au mobile phone, use "au Cloud" app).
- To import data by using a microSD memory card, save the data to a microSD memory card from your previous au mobile phone in advance (If there is no au Settings Menu on your previous au mobile phone, use "au backup" app).

- 1 In the Home screen, slide the screen up → [Settings] → [au Settings Menu] → [Data Transfer]* → [機種変更はこちら (For change of model, tap here)] → Follow the onscreen instructions

* When the confirmation screen appears, follow the onscreen instructions.

- To back up photos and contacts to the au server automatically using "Data storage App", use this procedure.

In the Home screen, slide the screen up → [Settings] → [au Settings Menu] → [Backup Setting] → Mark items to back up automatically

24

Continuous call time	In Japan	Approx. 1,610 min.
	Overseas (GSM)	Approx. 730 min.
Continuous stand-by time	In Japan	Approx. 420 hours
	Overseas (GSM)	Approx. 450 hours
Charging time	Using TypeC Common AC Adapter 01 (sold separately): Approx. 180 min. Using TypeC Common AC Adapter 02 (sold separately): Approx. 130 min. Using Common DC Adapter 03 (sold separately) ^{*1} : Approx. 520 min.	
Continuous Full Seg watching time	Approx. 11 hours 40 min.	
Continuous 1Seg watching time	Approx. 12 hours 40 min.	
Wi-Fi® tethering maximum connection number	10	

31

Phone

Making a call

■ Direct input calling

- 1 From the Home screen, [☎] → [🌐]
- 2 Enter a phone number → [📞]
To make a call to a land-line phone, enter from the city code even when you stay in the same city.

- 3 Call → [📞]

To adjust the in-coming volume (volume of the other party's voice), press the upper part or lower part of the volume key while calling.

■ Calling from history

- 1 From the Home screen, [☎] → [Recents]
- 2 [📞] of call history

■ Calling from contacts

- 1 In the Home screen, slide the screen up → [Contacts]
- 2 Tap a contact to call
- 3 Tap [Call]/phone number

25

Network environment	Wireless LAN (Wi-Fi®) function: Compliant with IEEE 802.11a/b/g/n/ac/ax (Radio frequency band for IEEE 802.11n: 2.4 GHz/5 GHz)	
Bluetooth® function	Communication type	Compliant with Bluetooth® standard Ver.5.1
	Output	Compliant with Bluetooth® standard Power Class 1
	Communication coverage distance ²	Within 10 m with good visibility
Supported Bluetooth® profile ³	HSP, HFP, PBAP ^{*4} , A2DP, apt-X, AVRCP, SPP, OPP, HID, HOGP, MAP, GATT, PAN-NAP, PANU	
Bluetooth® function	Radio frequency band	2.4 GHz band (2,400 MHz - 2,483.5 MHz)

^{*1} A MicroB-TypeC conversion adapter (sold separately) is required for use.

^{*2} Varies by obstruction between communication devices or radio wave reception status.

^{*3} It is a specification according to purpose of use of Bluetooth® device and is defined by Bluetooth® standard.

^{*4} Some contacts data may not be displayed correctly on the other party's device.

32

Receiving a call

■ Answering an incoming call

- 1 Incoming call screen → Swipe (flick) "📞" up
To answer an incoming call when the screen is ON (except on the lock screen), tap "ANSWER".

- 2 Call → [📞]

26

Setting wireless LAN (Wi-Fi®)

You can use a home wireless LAN (Wi-Fi®) or public wireless LAN to access the Internet services.

Turning on wireless LAN (Wi-Fi®)

- 1 In the Home screen, slide the screen up → [Settings] → [Network & internet]
- 2 Tap "🔌" on "Wi-Fi" to change to "🔌"
Wi-Fi® turns on.
It may take several seconds for Wi-Fi® to turn on.

27

For inquiries, call: Customer Service Center

For general information (toll free)

Business hours 9:00—20:00 (7 days a week)

From au mobile phones | From non-au mobile phones/general subscriber phones

157 without area code ☎ 0077-7-111

In case above numbers are not available (toll free).

☎ 0120-977-033 (except Okinawa) ☎ 0120-977-699 (Okinawa)

For theft, loss, or malfunction (toll free)

Business hours : 24 hours live support

From au mobile phones | From non-au mobile phones/general subscriber phones

113 without area code ☎ 0077-7-113

In case above numbers are not available (toll free).

☎ 0120-925-314

Repair and Delivery Support Center

For theft, loss, or malfunction (toll free)

Business hours 9:00—20:00 (7 days a week)

From au mobile phones/non-au mobile phones/general subscriber phones

☎ 0120-925-919



モバイルリサイクル・リフト・リユース

携帯電話の回収・リユース

携帯電話の回収・リユース

携帯電話の回収・リユース

携帯電話の回収・リユース

携帯電話の回収・リユース

携帯電話の回収・リユース

携帯電話の回収・リユース

携帯電話の回収・リユース

携帯電話の回収・リユース

携帯電話の回収・リユース

携帯電話の回収・リユース

Mobile phone and PHS operators collect and recycle unused telephones, batteries and battery chargers at stores bearing the ♻️ logo regardless of brand and manufacturer to protect the environment and reuse valuable resources.



やめましょう、歩きスマホ。

やめましょう、歩きスマホ。

やめましょう、歩きスマホ。

やめましょう、歩きスマホ。

やめましょう、歩きスマホ。

やめましょう、歩きスマホ。

やめましょう、歩きスマホ。

やめましょう、歩きスマホ。



やめましょう、歩きスマホ。

やめましょう、歩きスマホ。

やめましょう、歩きスマホ。

やめましょう、歩きスマホ。



やめましょう、歩きスマホ。

やめましょう、歩きスマホ。

やめましょう、歩きスマホ。

やめましょう、歩きスマホ。

やめましょう、歩きスマホ。

やめましょう、歩きスマホ。

やめましょう、歩きスマホ。

やめましょう、歩きスマホ。



やめましょう、歩きスマホ。

やめましょう、歩きスマホ。

やめましょう、歩きスマホ。

やめましょう、歩きスマホ。



やめましょう、歩きスマホ。

やめましょう、歩きスマホ。

やめましょう、歩きスマホ。

やめましょう、歩きスマホ。



やめましょう、歩きスマホ。

やめましょう、歩きスマホ。

やめましょう、歩きスマホ。

やめましょう、歩きスマホ。



やめましょう、歩きスマホ。

やめましょう、歩きスマホ。

やめましょう、歩きスマホ。

やめましょう、歩きスマホ。



やめましょう、歩きスマホ。

やめましょう、歩きスマホ。

やめましょう、歩きスマホ。

やめましょう、歩きスマホ。



やめましょう、歩きスマホ。

やめましょう、歩きスマホ。

やめましょう、歩きスマホ。

やめましょう、歩きスマホ。



やめましょう、歩きスマホ。

やめましょう、歩きスマホ。

やめましょう、歩きスマホ。

やめましょう、歩きスマホ。



やめましょう、歩きスマホ。

やめましょう、歩きスマホ。

やめましょう、歩きスマホ。

やめましょう、歩きスマホ。



やめましょう、歩きスマホ。

やめましょう、歩きスマホ。

やめましょう、歩きスマホ。

やめましょう、歩きスマホ。



やめましょう、歩きスマホ。

やめましょう、歩きスマホ。

やめましょう、歩きスマホ。

やめましょう、歩きスマホ。



やめましょう、歩きスマホ。

やめましょう、歩きスマホ。

やめましょう、歩きスマホ。

やめましょう、歩きスマホ。



やめましょう、歩きスマホ。

やめましょう、歩きスマホ。

やめましょう、歩きスマホ。

やめましょう、歩きスマホ。



やめましょう、歩きスマホ。

やめましょう、歩きスマホ。

やめましょう、歩きスマホ。

やめましょう、歩きスマホ。



やめましょう、歩きスマホ。

やめましょう、歩きスマホ。

やめましょう、歩きスマホ。

やめましょう、歩きスマホ。



やめましょう、歩きスマホ。

やめましょう、歩きスマホ。

やめましょう、歩きスマホ。

やめましょう、歩きスマホ。



やめましょう、歩きスマホ。

やめましょう、歩きスマホ。

やめましょう、歩きスマホ。

やめましょう、歩きスマホ。



やめましょう、歩きスマホ。

やめましょう、歩きスマホ。

やめましょう、歩きスマホ。

やめましょう、歩きスマホ。



やめましょう、歩きスマホ。

やめましょう、歩きスマホ。

やめましょう、歩きスマホ。

やめましょう、歩きスマホ。



やめましょう、歩きスマホ。

やめましょう、歩きスマホ。

やめましょう、歩きスマホ。

やめましょう、歩きスマホ。



やめましょう、歩きスマホ。

やめましょう、歩きスマホ。

やめましょう、歩きスマホ。

やめましょう、歩きスマホ。



やめましょう、歩きスマホ。

やめましょう、歩きスマホ。

やめましょう、歩きスマホ。

やめましょう、歩きスマホ。



やめましょう、歩きスマホ。

やめましょう、歩きスマホ。

やめましょう、歩きスマホ。

やめましょう、歩きスマホ。



やめましょう、歩きスマホ。

やめましょう、歩きスマホ。

やめましょう、歩きスマホ。

やめましょう、歩きスマホ。



やめましょう、歩きスマホ。

やめましょう、歩きスマホ。

やめましょう、歩きスマホ。

やめましょう、歩きスマホ。



やめましょう、歩きスマホ。

やめましょう、歩きスマホ。

やめましょう、歩きスマホ。

やめましょう、歩きスマホ。

