

AQUOS sense3 basic

SHV48

Quick Start Guide

- Descriptions in this manual are based on Android™ 9 Pie.
- The company names and product names appearing in this manual are trademarks or registered trademarks of their respective holders.
- For exemptions, refer to “Notes on Usage” available on the homepage of the network operator you contracted.

June 2020, 1st Edition
Manufactured by: SHARP CORPORATION



Cell phone and PHS operators collect and recycle unused telephones, batteries and battery chargers at stores bearing the ♻️ logo regardless of brand and manufacturer to protect the environment and reuse valuable resources.

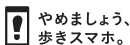

Instruction Manual

■ “Quick Start Guide” (this Manual) “Notes on Usage”

The “Quick Start Guide” (this manual) and “Notes on Usage” available on the homepage of the network operator you contracted describe necessary information and precautions before using the product first time.

■ “Full Instruction Manual” (Japanese)

You can check “取扱説明書 詳細版 (Full Instruction Manual)” (Japanese) that describes detailed of various functions on the homepage of the network operator you contracted.

Turning the Power On

- 1 (hold down for at least 3 seconds) while the product is turned off.

© When you turn the power on for the first time after purchasing the product, the initial setting screen is displayed automatically. For details on the initial setting, refer to “取扱説明書 詳細版 (Full Instruction Manual)” (Japanese).

Names and Functions of Parts

■ Front/Left Side/Right Side

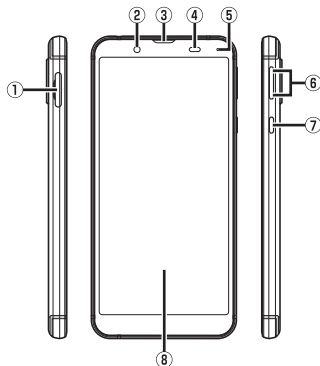

① nano SIM Card/microSD memory card tray

② In camera lens

③ Earpiece (Receiver)/Speaker*1

④ Proximity sensor/Light sensor

Proximity sensor prevents inadvertent operations of the touch panel during a call.

Light sensor detects the ambient brightness and adjusts the brightness of display.

⑤ Charging/Incoming indicator

⑥ Volume up key/ Volume down key

Adjust the volume. Also, set/disable manner mode.

Continued on next page

⑦ **Power key**

Use to turn the power on/off and turn the screen on/off.

⑧ **Display (Touch panel)**

The display is covered with a protective film. To use a commercially-available protective film, remove the protective film on the display first.

■ **Back/Top and Bottom**

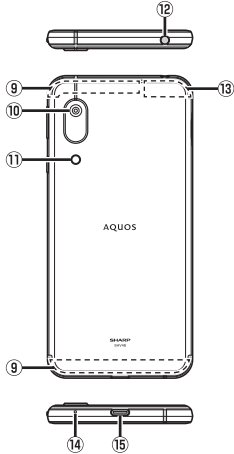

⑨ **4G/UMTS antennas*2**

⑩ **Out camera lens**

⑪ **Mobile light/Air vent*1**

Serves as air vent for maintaining performance.

⑫ **Earphone/Microphone jack**

⑬ **Wi-Fi®/Bluetooth®/GPS antennas*2**

⑭ **Mouthpiece (Microphone)*1**

⑮ **External connection jack**

Use when connecting AC adapter (sold separately), USB Type-C™ cable (commercially available), USB cable for peripherals (commercially available), etc. to the product.

*1 Covering the sections with stickers, fingers, etc. may hinder product performance.

*2 Antennas are built into the product. Do not cover with hand during calls or data communication. Doing so may affect call/communication quality.

⊖ The outer case (back) of the product cannot be removed. Removing it forcibly may cause damage or a fault.

⊖ The battery is built into the product, and cannot be removed by the customer. Hold down for at least 8 seconds if the screen freezes and you force the product to turn off etc.

⊖ This product use it for both a earpiece (receiver) and a speaker. The volume will incrementally rise to the set volume so that loud sounds do not come out of the speaker in your ears after the speakerphone is switched to during calls, or after calls are finished.

Proximity sensor/Light sensor

⊖ Placing stickers, etc. over the proximity sensor/light sensor may prevent the product from operating properly.

Earphone/Microphone jack

⊖ An earphone/microphone with the switch or depending on the type of the earphone/microphone, it may not be available with the product.

IMEI plate

⊖ A plate with the sticker which the IMEI number (International Mobile Equipment Identifier) is printed is stowed near the nano SIM Card/microSD memory card tray. Except when the IMEI number is required such as requesting servicing or repairs, do not pull out the plate or remove the sticker.

For details on handling IMEI plate, refer to “取扱説明書 詳細版 (Full Instruction Manual)” (Japanese).

Attaching the nano SIM Card

Before attaching the nano SIM Card, turn the product off. Also, attach it with the display side turned up.

1 With your finger on the groove, pull out the nano SIM Card/microSD memory card tray.

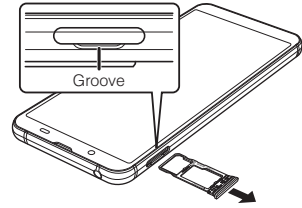

2 Put the nano SIM Card to the nano SIM Card/microSD memory card tray with the IC (metal) side turned down.

Check the direction of the nano SIM Card and put it securely. Not to let the nano SIM Card lift up from the card tray. If the nano SIM Card does not fit the card tray, may cause a fault.

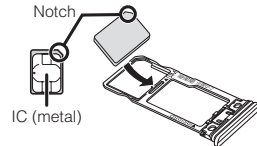

3 Insert the nano SIM Card/microSD memory card tray all the way to the product straight and horizontally.

Push the ⊖ areas securely and make sure there is no space between the product and the card tray.

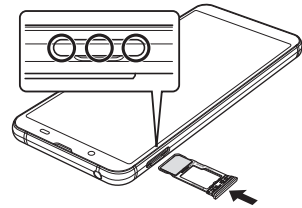

Attaching or removing the nano SIM Card/microSD memory card tray

- ⊖ When pulling out the card tray from the product, pull it slowly and horizontally with the display side turned up.
 - Pulling out the card tray forcefully or obliquely may cause damage.
- ⊖ When attaching the card tray, insert it slowly with the display side turned up and make sure there is no space between the product and the card tray.
 - Do not insert the card tray with the wrong side down. Failure to do so may cause damage it.
 - Inserting the card tray not deeply enough may cause impairment of the waterproof/dustproof property or prevent the product from functioning properly.