

OPPO A54 5G

OPG02

Quick Start Guide



Using Online Manual (Japanese)

For detailed description on various functions, scan the QR code on the right side or use the "オンラインマニュアル (Online Manual)" (Japanese) on the product with the following operations.



From the Home screen, [Tools]→[取扱説明書](Online Manual)

For inquiries, call:

Customer Center

For general information (toll free)

Business hours 9:00 - 20:00 (7 days a week)
From au mobile phones: From non-au mobile phones/
general phones:

157 without area code ☎ 0077-7-111

Incase above numbers are not available, call toll-free:

☎ 0120-977-833

For theft, loss, damage (toll free)

Business hours 24 hours (7 days a week)
From au mobile phones: From non-au mobile phones/
general phones:

113 without area code ☎ 0077-7-113

Incase above numbers are not available, call toll-free:

☎ 0120-925-314

Repair and Delivery Support Center

(For members of Repair and Delivery Support/Reliable support pack for members services)

Failure consultation and Replacement mobile phone delivery service reception (toll free)

Business hours: 9:00 - 20:00 (7 days a week)

From au mobile phones/non-au mobile phones/general phones:

☎ 0120-925-919

やめましょう、
歩きスマホ。

あぶない!
電池への衝撃

キケン!
水ぬれ充電

Call phone and PHG operators collect and recycle unused telephones, batteries and battery chargers at stores bearing the ♻️ logo regardless of brand and manufacturer to protect the environment and reuse valuable resources.

©2023 KDDI CORPORATION. 0120-925-919

Sold by: KDDI CORPORATION, OKINAWA CELLULAR TELEPHONE COMPANY

Imported by: OGA Japan K.K.

Manufactured by: Guangdong OPPO Mobile Telecommunications Corporation Ltd.

May 2021, 1st Edition

List of packaged items

- Main unit (Protective film (sample) attached)
- SIM ejector pin (sample)
- Protective case (sample)
- クイックスタートガイド (Quick start guide) (Japanese)
- ご利用にあたっての注意事項 (Notes on usage) (Japanese)

memo

- Purchase the specified charging equipment (sold separately).
- The battery is built into the product.
- Illustrations of mobile phone used in this manual are just images for explanations. They may be different from actual ones.

Attaching au IC card (SIM card)

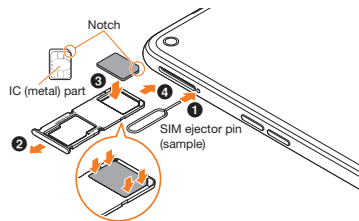

Turning the power on

- 1 Press and hold the Power button/Screen-lock button for at least 2 seconds



Power button/Screen-lock button

memo

- If the power cannot be turned off in a regular way or the screen freezes, press and hold the Power button/Screen-lock button and the volume button (up) for at least 10 seconds at the same time to forcibly restart.

Names of parts

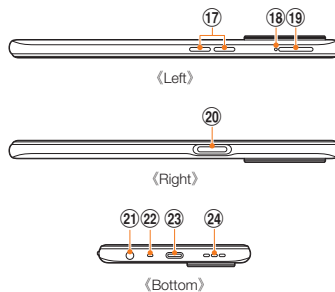
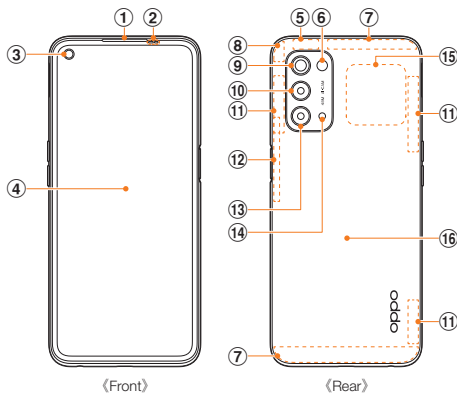

- ① Receiver¹
- ② Light sensor/Proximity sensor²
- ③ Front camera
- ④ Display (touch panel)
- ⑤ GPS/5G antenna³
- ⑥ Super wide-angle camera
- ⑦ 4G antenna³
- ⑧ Wi-Fi®/Bluetooth® antenna³
- ⑨ Wide-angle camera
- ⑩ Monochrome camera
- ⑪ 5G antenna³
- ⑫ 4G/5G antenna³
- ⑬ Macro camera
- ⑭ Flashlight
- ⑮ NFC detector area
- ⑯ Rear cover⁴

- ⑰ Volume button (up/down)
- ⑱ Hole for tray removal
- ⑲ au IC card/microSD memory card tray
- ⑳ Power button/Screen-lock button, Fingerprint sensor
- ㉑ Earphone jack
- ㉒ Microphone¹
- ㉓ USB Type-C™ connection jack (external connection jack)
- ㉔ Speaker¹

^{*1} Be careful not to cover with your finger etc. while using the corresponding function. Do not insert the SIM ejector pin (sample) in a wrong way because it may cause damage.

^{*2} Do not cover with a sticker etc. Functions may not work properly.

^{*3} The antenna is built into the main unit. Covering the antenna area with your hand may affect quality of call/communication.

^{*4} The rear cover cannot be removed. Attempting to remove it forcibly may cause a damage or malfunction. Also, the battery is built into the main unit and you cannot take out it by yourself.

- For the latest contents of this manual, refer to the Online Manual or “取扱説明書 詳細版 (Full instruction manual)” (Japanese) on the au homepage.
<https://www.au.com/support/service/mobile/guide/manual/>
 (Japanese)

- The descriptions may be different from those in this manual due to software version upgrade of the product, change/termination of services. Also, the content of this manual is subject to change without notice.