

au

XPERIA Z5

SOV32

Setting Guide

Introduction

Thank you for buying the "Xperia™ Z5" (simply called the "product" from here on).
In this guide, settings and precautions for using the product are described.

- **Basic operation**
Describes the basic operations.
 - **Initial settings**
Make initial settings when you turn the power on for the first time.
 - **E-mail setting**
Make initial settings for @ezweb.ne.jp etc.
 - **Making a call**
Describes how to make a call.
 - **Receiving a call**
Describes how to receive a call.
- **Transferring data from au Setting Menu**
Import/export data to/from the product using microSD memory card or au Smart Pass server.
 - **Sending contacts**
Send contacts to another phone.
 - **Saving battery power**
Save battery power using the quick setting panel or the quick setting tools.

Company names and product names referred to in this manual are trademarks or registered trademarks of respective companies.
The TM, ® marks may be omitted in this manual.
Screen illustrations shown in this manual may look different from the actual screens.
In some cases, upper or lower part of a screen may be omitted.

October 2015, 1st Edition
Sold by: KDDI CORPORATION, OKINAWA CELLULAR TELEPHONE COMPANY
Manufactured by: Sony Mobile Communications Inc.

Basic operation

For detailed descriptions of operations, refer to the "Basic Manual" (Japanese) app installed on the product or "取扱説明書（詳細版）（Full Instruction Manual)" (Japanese) available on the au homepage.

Status bar

Current status and notification icons are displayed.

Power key/Power Lock key/
Fingerprint sensor

Power ON
Press and hold for over 1 second.

Screen Lock
Press while the screen displayed. The backlight turns off and screen lock is activated (avoiding the keys or touch screen from false operations).

Unlocking Screen Lock
The lock screen appears when turning the power on or the backlight on by pressing . Swipe (flick) the screen up to cancel the screen lock. Register fingerprints to cancel the screen lock by touching .

App key

Tap to display the apps screen.

Recently used apps

Tap to display recently-used apps in the thumbnail list and activate or end them from the list. You can use small apps, too.

Home key

Tap to display the Home screen.

Back key

Tap to return to the previous screen.

Display (Touch panel)

Operate directly touching with your finger.

Opening Notification panel

If any notification icons are displayed on the left side of the status bar, slide down the status bar to open the Notification panel. You can check details of notification icons, start corresponding apps, etc.

Slide the status bar down with two fingers or slide the Notification panel down to display the quick setting panel. You can set on/off of the functions.

Touch panel operations

Tap/Double-tap
Tap: Gently touch a screen and then immediately release your finger.
Double tap: Touch the same position twice.

Slide
While your finger is gently touching the screen, trace it to the desired direction to move over.

Pinch
Touch the screen with two fingers and widen (pinch-out) or narrow (pinch-in) the fingers' distance.

Displaying menu

There are two types for displaying the screen menu; tapping "" and long-touching an input field or item.

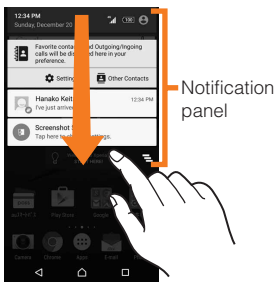

Notification panel

Long-touch

Keep touching an item with your finger.

Flick (swipe)

Operate the screen by quickly moving (flicking) your finger up/down or right/left.

Drag

Keep touching an item or icon, trace it to the desired direction to move.

Character entry

Use software keyboard to enter characters.

The software keyboard appears when you tap the entry field for registering a contact, composing a mail, etc.

Software keyboard

With "International keyboard", you can use QWERTY keyboard to enter characters, Numeric keypad to enter numbers and symbols, and Symbol keypad for more symbols.

- Tap "" to display Numeric keypad. For Symbol keypad, tap "" on the Numeric keypad.
- Tap "" to display the keyboard setting menu.

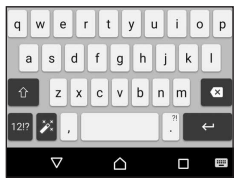

《QWERTY keyboard》

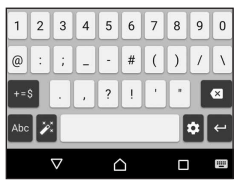

《Numeric keyboard》

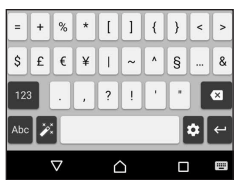

《Symbol keyboard》

Initial settings

When you turn on the product for the first time, follow the onscreen instructions to set the language, functions, services, etc.

STEP START: Setting language

Select "English (United States)" and tap "START".

- Alternatively, after the initial setting is complete, from the Home screen, tap [] → [設定 (Settings)] → [言語と入力 (Language & input)] → [地域／言語 (Language)] to set the language.

STEP 1: Starting basic settings

When "Welcome" appears, tap "NEXT".

STEP 2: Setting Wi-Fi® connection

Use home wireless LAN (Wi-Fi®) or public wireless LAN to connect Internet service. Operate in a place where signal of Wi-Fi® network can be received.

Tap "SEARCH FOR NETWORKS".

- Wi-Fi® network with is open network.
- Wi-Fi® network with is protected by security. To connect, enter password (security key).
- To detect Wi-Fi® network manually or make Wi-Fi® advanced settings, after the initial setting is complete, tap [] → [Settings] → [Wi-Fi] → [] → [Refresh]/[Advanced].

Using Wi-Fi® network selection settings

Select from detected Wi-Fi® network to set.
To select a protected Wi-Fi® network, you need to enter a security key.

1

Select Wi-Fi® network

2

Enter a password (security key) → [CONNECT]

3

Connect Wi-Fi® network → [NEXT] → [NEXT]

Setting Wi-Fi® network manually

Add Wi-Fi® network manually.
Check network SSID, authentication type, etc. in advance.
If security is set, you need to enter a security key.

1

[ADD ANOTHER NETWORK]

2

Select network SSID and security type → Enter a password (security key) as required → [SAVE]

3

Connect Wi-Fi® network → [NEXT] → [NEXT]

STEP 3: Setting up an Google account

Set up a Google account so that you can synchronize with Gmail or contacts or calendar, etc. of online service.

- To set online service, make sure that data communication is enabled. Check that appears on the status bar or the product is connected to a Wi-Fi® network.
- If you set up a Google account, you can use Google apps such as "Gmail", "Google Play" or "Hangouts". Gmail's mail address "(user name) @gmail.com" is automatically created from the user name set with a Google account. To create an account, you are required to register "First name" and "Last name".

1

[GET STARTED] → [SKIP]

2

[Or create a new account]

3

Enter "First name", "Last name" → [NEXT]

4

Enter a user name → [NEXT]

5

Enter a password → [NEXT]

6

Recovery phone → [NEXT] → [VERIFY]

7

[I AGREE] → [NEXT]

8

Set purchase settings for Google Play as required → [NEXT]

9

Confirm the Google services settings → [NEXT]

10

[NEXT]

* To copy a Google account from the other device using Tap & Go, follow the onscreen instructions.

* If you have Google account, enter the mail address and then follow the onscreen instructions.

* After step 4, checking registration of username starts. If the entered user name is unavailable, an entry screen for prompting another user name appears.

* When you enter another phone number in step 6, enter the notified Verification code and then tap "NEXT".

STEP 4: Completion of setup

When the setup completion screen appears, tap "FINISH".

When Data disclaimer screen appears, confirm the content and tap "OK".

au Easy Setting

Set au convenient functions or services.

- By setting au ID, you can use various services provided by au such as auスマートパス (au Smart Pass) or "au Kantan Kessai", which allows you to purchase apps from Google Play.
* au ID which is already used by another user cannot be set.
- Alternatively, after the initial setting is complete, from the Home screen, tap [] → [Settings] → [au Settings Menu] → [au Easy Setting], you can set au service.

1

[Next]

2

Select "Register "au ID" → [Next]

3

[au IDの設定・保存 (Set/save au ID)]

4

Enter a password number → [OK]

5

Set password → [設定 (Set)] → [終了 (Exit)]

6

Select "Update" → [Next]

7

Confirm contents Select "Agree" → [Next] → [Agree]

8

Select "Turn Auto Backup on" or "Turn Auto Backup off" → [Next]

9

Mark apps to install → [次へ (Next)]

10

Select "Activate" or "Skip activation" → [Next]

11

Select "Activate" or "Skip activation" → [Next]

12

Mark data to be restored → [次へ (Next)]

13

[Finish]

* The screens of the step 8 and from 10 to 12 appear only if "Agree" is selected in the step 7.

* If there are apps to be recovered, a recovery screen for applications appears before the step 10. Follow the onscreen instructions.

* Select "Agree" in step 7 to complete pre-configuration of Lookout for au.

* When the use confirmation screen appears, follow the onscreen instructions.

E-mail setting

To use E-mail (@ezweb.ne.jp), subscription to LTE NET is required. If you did not subscribe it when you purchased the product, contact an au shop or Customer Service Center.

This is a service with which you can send/receive mails using E-mail (@ezweb.ne.jp). Your E-mail address is determined automatically after initial setting. You can change the E-mail address later.

* For model change from au cell phone, E-mail address used on the previous model can be used continuously after initial settings.

Initial settings

- From the Home screen, [E-mail]
- Check the contents (Connect) → Confirm your E-mail address → [閉じる (Close)]
- Confirm the content → [Agree]/[Disagree] → [Done] → Confirm the content → [Agree] → Check the content → [Close]

Checking E-mail address

- From the Home screen, [E-mail]
- [E-mail information] → Check your E-mail address

Changing E-mail address

- From the Home screen, [E-mail]
- [E-mail information]
- [Change Address/Setting Filter] → Confirm the content → [接続する (Connect)]
- [Eメールアドレスの変更へ (To change E-mail address)]
- Enter the security code → [送信 (Send)] → Confirm the content → [承諾する (I agree)]
- Enter E-mail address → [送信 (Send)] → [OK]

PC-mail

You can use mail addresses except for E-mail (@ezweb.ne.jp). To use PC-mail, set up PC-mail account. For the first time use, set up as follows. From the Home screen, [E-mail] → [GET STARTED] → Enter Email address → [NEXT] → Enter a password → [NEXT] → Select the sync option → [NEXT] → Select the notification option → [NEXT] → Enter account name and name as sender → [FINISH SETUP]
*For details, refer to the "Basic Manual" (Japanese) app installed on the product or "取扱説明書 (詳細版)" (Full Instruction Manual) (Japanese) available on the au homepage.

Backing up Email

- From the Home screen, [E-mail]
- [E-mail settings]
- [Backup/Restore]
- [Mail Backup] → [OK]
- Select character code for backup data → [OK]
* For character code, tap [Help] to check.
- Mark to back up mails → [OK]

- Mail data is saved in the internal storage (/storage/emulated/0/private/au/email/BU).
- If a microSD memory card is attached, data is saved in the microSD card (/storage/sdcard1/private/au/email/BU).
- To back up mail data or mail settings (notification settings, filtering settings etc.) all at once, back up from "Whole Backup".

Making a call

Direct input calling

- From the Home screen, [Phone]
- All your calls will appear here
- Enter a phone number → [Call]

Calling from Contacts

- From the Home screen, [Contacts]
- Tap a party to call
- Tap a phone number or [Call]

Calling from call log

Tap the party from "Top Contacts" or "Recent calls" that is displayed when tapping [Call] in the Home screen.

Calling overseas from au cell phones (au International Call Service)

You can make international calls without any special procedure from the product. On the phone number input screen → Enter an access code, country code, area code*, and the phone number of the other party → [Call]
* If the area code starts with "0", Enter it without including the "0". (There are some exceptions such as fixed-line phones in Italy or Moscow).

Receiving a call

Answering a call

- Drag [Answer] right
* To reject an incoming call, drag [Decline] left on the receiving screen
- Start a call
- To end the call, [End]
* You can add/display contacts, create a SMS or make a call on call end screen.

Answering a call (pop-up display)

- [Accept]/[Speaker]
* To reject an incoming call, tap [Decline]
- Start a call
* Show/hide pop-ups with [Show/Hide]
- To end the call, [END]

Transferring data from au Settings Menu

Import or export data between this product and your previous au cell phone using microSD memory card or au Smart Pass

- To import or export data using au Smart Pass server, set au ID.
- To import data using microSD memory card, save data to microSD memory card using your previous au cell phone in advance.

Importing data from au Settings Menu

- From the Home screen, [Settings]
- [Settings] → [au Settings Menu]
- [Data Transfer]
- [データを戻す (Import data)]
- Select an import method
* To import data from [auスマートパスから戻す (Import from au Smart Pass)] (exported data on au Smart Pass server), set au ID.
- When [SDカードから戻す (Import from SD card)] is selected, select your previous au phone type
* Does not appear if you select 'auスマートパスから戻す (Import from au Smart Pass)' in step 5.

When "SDカードから戻す (Import from SD card)" is selected

- Mark data to import, then [戻す (Import)] → [完了 (Done)]
* It is a screen for selecting "スマートフォンのデータを戻す (Import smartphone data)".
* When a confirmation screen appears, follow the onscreen instructions.

Saving data from au Settings Menu

- From the Home screen, [Settings]
- [Settings] → [au Settings Menu]
- [Data Transfer]

When "auスマートパスから戻す (Import from au Smart Pass)" is selected

- Mark data to be imported, then [戻す (Import)] → Check the content → Follow the onscreen instructions → [完了 (Done)]

- [データを保存する (Save data)]
- Select a saving location
* When saving from [auスマートパスに預ける (Export to au Smart Pass)], set au ID.

When "SDカードに保存する (Save to SD card)" is selected

- Mark data to save → [保存する (Save)] → [完了 (Done)]

- To back up photos and contacts to au Smart Pass server automatically using "Data Storage" application, from the Home screen, [Settings] → [Settings] → [au Settings Menu] → [Backup Setting] → [定期的に自動で預ける (Export automatically on a regular basis)]

When "auスマートパスに預ける (Export to au Smart Pass)" is selected

- Mark data to export and [預ける (Export)] → Check the content → Follow the onscreen instructions → [完了 (Done)].

Sending contacts

You can send contacts to another phone.

- From the Home screen, [Contacts]
- [Contacts]
- Tap a contact to send
- [Share]
- Select how to send a contact → Follow the onscreen instructions
* Operation differs depending on the app you selected.

Sending several contacts

- Contact list screen → [Mark several] → Mark contacts to send
- [Select an app] → Select an app → Follow the onscreen instructions
* Operation differs depending on the app you selected.

Saving battery power

Use the quick setting panel or the quick setting tools to set Wi-Fi® function, Bluetooth® function, NFC function, STAMINA® mode etc. Switching the settings frequently can reduce the battery power consumption.

Opening the quick setting panel

- Slide down the status bar with two fingers
- Set each item

Quick settings tools

Brightness: Adjust screen brightness
Wi-Fi: Wi-Fi® On/Off
Bluetooth: Bluetooth® On/Off
NFC: NFC On/Off
Hotspot: Wi-Fi® hotspot On/Off
Location: Location On/Off
Auto-rotate: Auto rotate On/Off
Airplane mode: Airplane mode On/Off
STAMINA: STAMINA mode On/Off
Glove mode: Glove mode On/Off
Flashlight: Flash/Photo light On/Off
Cast screen: Display screens of the product on Google Cast device