



AQUOS PAD

SHT21

Basic Manual

[Contents](#)

[Safety Precautions](#)

[Getting Ready](#)

[Basic Operations](#)

[Character Input](#)

[Settings](#)

[Appendix](#)

4G LTE

Preface

Thank you for buying the “AQUOS PAD SHT21” (simply called the “SHT21” or the “product” from here on). Before using the product, be sure to read the “Basic Manual” (this PDF manual) on the au homepage to ensure correct use. After you have finished reading this PDF manual, be sure to store it and the printed manuals (Accessories) in safe places so that you can retrieve them whenever you need them. If you lose the printed manuals (Accessories), contact an au shop or Customer Service Center.

Operating Instructions

■ “Basic Manual” (This PDF Manual)

This manual describes basic operations of major functions.

For detailed descriptions of various functions, refer to the “Instruction Manual application” (Japanese) that can be used on the product or “Full Instruction Manual” (Japanese) on the au homepage:

<http://www.au.kddi.com/torisetsu/index.html>

■ “Instruction Manual Application” (Japanese)

You can use the “Instruction Manual application” on the product to check detailed operational procedures. Also, you can activate intended functions from an explanation screen depending on the functions. On the home screen, tap [APPS] → [Instruction Manual].

- To use the application for the first time, you need to download and install it by following on-screen instructions.

■ Downloading Manuals

You can download the “Basic Manual” (this PDF manual) and the “Instruction Manual” (Accessory) (Japanese) or “Full Instruction Manual” (Japanese) in PDF format from the au homepage.

Safety Precautions

Before you start using the product, be sure to read the “Safety Precautions” to ensure correct use.

Before you assume that the product is malfunctioning, check for possible remedies in the following au Customer Support site of au homepage:

<http://cs.kddi.com/support/komatta/kosho/index.html>

When Using the Product

- Communication is not possible even inside the service area in places where the signal does not reach (e.g. tunnels and basements). Also, communication may not be possible in poor reception areas. Communication may be interrupted if you move into a poor reception areas during communications.
- Since this product uses radio waves, the possibility of communication intercepts by third parties cannot be eliminated. (Though the LTE/CDMA system has highly secure confidential communication features.)
- Since the product is a radio station under the Radio Law, you may be asked to temporarily submit the product for inspection in accordance with the Radio Law.
- The IMEI information of the product is automatically sent to KDDI CORPORATION for maintenance and monitoring operational status of the product.
- Since the battery is built into the product, you cannot replace it yourself. For replacing the battery, contact an au shop or Customer Service Center.
- Take care not to inconvenience people around you when you use the product in a public place.

- If you are using the product overseas, check the relevant laws and regulations of the country/region you visit.
- When the product is used by a child, parents or guardians should thoroughly read this PDF manual and teach the child how to use it.

Etiquette

The product always emits weak radio waves when power is on. Use the product in an enjoyable and safe manner without forgetting to be considerate of others around you.

■ Use of the product is not allowed in the following places!

- Do not use the product while driving a car or riding a motorbike or bicycle. It may cause a traffic accident. Use of the product while driving a car or motorbike is prohibited by law. Use of the product while riding a bicycle may be punishable by some regulations.
- Be sure to turn off the product while you are aboard an airplane. Otherwise, safety of your flight may be compromised.

■ Be considerate of where you use the product and the volume!

In theaters, museums, libraries, and other similar places, turn the power off or turn on the manner mode so as not to disturb others around you by reception sounds.

- Do not use the product on a street where you might interrupt the flow of pedestrians.
- Move to areas where you will not inconvenience others on trains, in hotel lobbies, etc.
- Obtain the permission of other people before you take their photos with the product's camera.

■ Be considerate of people around you!

- Some people close to you in crowded places such as packed trains may be using a cardiac pacemaker. Turn the product off in such places.
- Abide by the rules of hospitals and other medical institutions where it is forbidden to use or carry the product.

List of Packaged Items

Before you start using the product, make sure that you have all the following packaged items with the product.



SHT21



microUSB-3.5φ L-Shaped Conversion Cable (Sample)



Stylus Pen* (SHT21KBA)

* This is inserted into the SHT21 at the time of purchase.

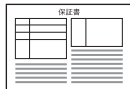

Warranty (Japanese)

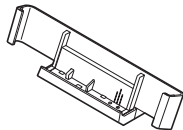

Desktop Holder (SHT21PUA)

- Instruction Manual (Japanese)
- Setting Guide (Japanese)
- Before Using the Product (Japanese)

The following items are not included in the package.

- AC adapter
- Earphone
- microUSB cable
- microSD memory card

- Purchase a specified charger (sold separately).
- Illustrations in this manual are only for reference. They may look different from the actual product.

memo

- ◎ The battery is built into the product.

Using au Disaster Countermeasure Application

au Disaster Countermeasure is an application in which you can use Disaster Message Board, Emergency Rapid Mail (Earthquake Early Warning, Disaster and Evacuation Information, and Tsunami Warning) and Disaster Voice Messaging Service.

- 1 On the home screen, [APPS]**
→ **[au災害対策] (au Disaster Countermeasure).**

The au Disaster Countermeasure menu is displayed.



《au Disaster Countermeasure menu》

■ Using Disaster Message Board

Disaster Message Board is a service to enable customers in disaster areas to register their safety information via LTE NET when large-scale disasters, such as an earthquake whose Japan seismic scale is approximately 6-lower or more, occur. The registered safety information can be checked by customers using au terminals, and also from other carriers' cell phones, PCs, etc.

For details, refer to “Disaster Message Board Service” on the au homepage.

1 From the au Disaster Countermeasure menu, [災害用伝言板] (Disaster Message Board).

Follow the on-screen instructions for registration/confirmation.

memo

- ◎ To register the safety information, an e-mail address (~ezweb.ne.jp) is required. Set the mail address in advance.
- ◎ Deletion of the safety information and configurations for Safety Notification Mail are not available during the wireless LAN (Wi-Fi®) connection.
- ◎ The Company does not guarantee the quality of this service. The Company, regardless of the cause, shall not be liable for any problems related to registration of safety information due to the concentration of access to this service or equipment errors, any loss due to the damage, ruination, etc. of safety information, or any loss arising from registered safety information.

■ Using Emergency Rapid Mail

Emergency Rapid Mail is a service to collectively deliver Earthquake Early Warning and Tsunami Warning provided by the Japan Meteorological Agency, and Disaster and Evacuation Information provided by the national government or the local governments to au terminals in the specified areas. At the time of purchase, receiving setting of Emergency Rapid Mail (Earthquake Early Warning, and Disaster and Evacuation Information) is set to “受信する” (Receive). You can receive Tsunami Warning by setting 災害・避難情報 (Disaster and Evacuation Information). When receiving Earthquake Early Warning, secure your safety and act composedly according to the surrounding situations. When receiving Tsunami Warning, leave sea coasts immediately and evacuate to safe places such as hills and strongly-built tall buildings.

1 From the au Disaster Countermeasure menu, [緊急速報メール] (Emergency Rapid Mail).

The inbox is displayed.

Select a mail to check to display the details of the mail.

削除 (Delete)	Delete received mails.
設定 (Settings)	<p>緊急地震速報 (Earthquake Early Warning) Set whether to receive Earthquake Early Warning.</p> <ul style="list-style-type: none">• Tap [受信する] (Receive)/[受信しない] (Not receive) → [OK]. <p>災害・避難情報 (Disaster and Evacuation Information) Set whether to receive Disaster and Evacuation Information, and Tsunami Warning.</p> <ul style="list-style-type: none">• Tap [受信する] (Receive)/[受信しない] (Not receive) → [OK]. <p>音量 (Volume) Set the volume of the receiving sound.</p> <p>バイブ (Vibrator) Set whether to activate the vibrator at the time of reception.</p>

設定 (Settings)	<p>マナー時の鳴動 (Linkage to the manner mode) Set whether to notify you with the manner mode settings applied in the manner mode.</p> <p>緊急地震速報 (Earthquake Early Warning) Check the operations of the receiving sound and vibrator for Earthquake Early Warning.</p> <p>災害・避難情報 (Disaster and Evacuation Information) Check the operations of the receiving sound and vibrator for Disaster and Evacuation Information, and Tsunami Warning.</p>
------------------	--

memo

- ◎ This service is available only in Japan (Not available overseas).
- ◎ Emergency Rapid Mail is free of both information charges and communication charges.
- ◎ Emergency Rapid Mail cannot be received while the power is turned off.
- ◎ Emergency Rapid Mail may not be received during communication such as while sending and receiving SMSs/ e-mails and while using the browser, or when you are in a place where the signal cannot be received (e.g. tunnels and basements) or the signal is weak, even within the service area.

- ◎ Emergency Rapid Mail which failed to be received cannot be received again.
- ◎ When you receive Emergency Rapid Mail, the dedicated alarm tone rings. The alarm tone cannot be changed.
- ◎ Information intended for the areas of other than your present location may be received.
- ◎ As for this service, the Company shall not be liable for any damage incurred on the users resulted from failure or delay of information delivery due to communication disturbance or system failure, contents of the information or other problems that are not supposed to be blamed on the Company.
- ◎ For details on Earthquake Early Warning and Tsunami Warning provided by the Japan Meteorological Agency, refer to the agency's homepage.
<http://www.jma.go.jp/>

Earthquake Early Warning

- ◎ Earthquake Early Warning notifies areas where a strong shaking (Japan seismic scale 4 or more) is expected when an earthquake whose maximum Japan seismic scale is predicted of 5-lower or more has been detected.
- ◎ This service detects an earthquake (P-wave, preliminary tremors) near the seismic center immediately after the earthquake occurs and automatically calculates its location, scale and predicted strength of the shaking. After that, you will be notified of the earthquake as soon as possible within a few seconds to dozens of seconds before a strong shaking from the earthquake (S-wave, principal shock) occurs.
- ◎ In the vicinity of the seismic center, a strong shaking may reach you before Earthquake Early Warning.

- ◎ The Earthquake Early Warning distribution system provided by this service is different from that provided by TV, radio and other communication media and thus the arriving time of Earthquake Early Warning may be different among those media.

Tsunami Warning

- ◎ Tsunami Warning notifies areas including target sea coasts of Tsunami Warning (major tsunami and tsunami) provided by the Japan Meteorological Agency.

Disaster and Evacuation Information

- ◎ Disaster and Evacuation Information notifies information related to the safety of citizens, such as evacuation advisories, evacuation orders or various alarms delivered by the national government or the local governments.

■ Using Disaster Voice Messaging Service

Disaster Voice Messaging Service is a service to record voices with a smartphone, tablet, etc. and deliver them as a voice message to people to whom you want to deliver the information that you are safe when large-scale disasters occur.

1 From the au Disaster Countermeasure menu, [災害用音声お届けサービス] (Disaster Voice Messaging Service).

■ Sending voices (Send)

Tap “声をお届け” (Send voices) and operate in order of “①お届け先を選択” (Select to whom to send) → “②お届けしたい声を録音” (Record voices to send).

* You can also select to whom to send your voices from the address book.

■ Receiving voices (Receive)

You will be notified via a pop-up screen or an SMS that a voice message has been received. You can listen to the message by receiving (downloading) and playing the voice message.

- If the receivers are using a tablet or smartphone on which an au Disaster Countermeasure application supporting Disaster Voice Messaging Service is not enabled or using an au cell phone, they will be notified via an SMS.
- If the receivers are notified via an SMS, the information will not be saved in the au Disaster Countermeasure application.

memo

- ◎ Sending and receiving voice messages are available only when you are using LTE/3G network. Disable wireless LAN (Wi-Fi[®]) communication etc. before use.
- ◎ Voice messages can be recorded for up to 30 seconds.
- ◎ Voice messages can be exchanged only among au terminals (interoperation with other carriers' cell phones will be available from the spring of 2013).

- ◎ Voices may not be heard when the media sound volume is set to low or the manner mode is set.
- ◎ When no free space is left on the main unit (memory), voice messages may not be saved or played.
- ◎ Some terminals cannot receive voice messages. For details, refer to the au homepage.

Contents

Preface	ii
Operating Instructions	ii
Safety Precautions.....	ii
When Using the Product	1
Etiquette.....	1
List of Packaged Items	2
Using au Disaster Countermeasure Application	3
Contents	8

Safety Precautions

Illustrations and Descriptions in This Manual.....	9
Exemptions	10
Safety Precautions (Observe Strictly).....	11
Handling Precautions	24
Available Security Codes	31
Notes on Waterproof and Dustproof Properties	33
Notes on Using Bluetooth®/Wireless LAN (Wi-Fi®)	
Functions	40
Notes on Packet Communication Charge.....	43
Notes on Google Play/au Market/Applications.....	43

Getting Ready

Names and Functions of Parts	44
Using the au Micro IC Card (LTE)	46
Using a microSD Memory Card	48

Charging.....	50
Turning the Power On/Off.....	54
Sleep Mode	55
Welcome Sheet(Lock Screen).....	56
Switching the Display Language to English.....	56

Basic Operations

Using the Touch Panel.....	57
Using the Stylus Pen.....	58
Using the Touch Keys.....	59
Using the 3-Line Home	60
Using the Status Area.....	64

Character Input

Switching Software Keyboards.....	66
Viewing the Character Input Screen.....	66

Settings

Displaying Setting Menu.....	70
------------------------------	----

Appendix

Introduction of Peripheral Devices.....	71
Troubleshooting	73
Updating Software or OS.....	74
After-Sales Service.....	76
Main Specifications.....	78
CE Declaration of Conformity	80
FCC Notice	82
Export Administration Regulations	83
Intellectual Property Rights.....	83

Illustrations and Descriptions in This Manual

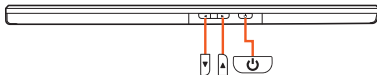

Note on Key Illustrations

In this manual, the key illustrations are simplified as shown below.



Description of Operations for Selecting Item/Icon/Key etc.

In this manual, operation procedures are described as below.

Description	Explanation
On the home screen, [APPS] → [Browser].	Tap "APPS" at the top of the home screen and tap "Browser".
 (hold down for at least 2 seconds).	Hold  down for at least 2 seconds.

* Tapping is to select a key or icon displayed on the screen by lightly tapping it with your finger or the stylus pen.

Notes on Illustrations/Screenshots

The screenshots in this manual are simplified and may look different from the actual screens. Also, part of the screen may be omitted.

Actual screen

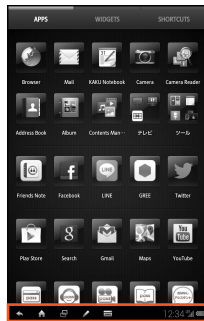

In this manual

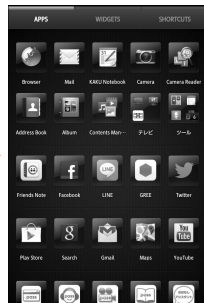

In this manual, part of the screen such as icons are omitted.

memo

◎ Explanations of this manual are based on the case when the product is held vertically. If you hold it horizontally, menu items/icons/on-screen keys etc. may be different.

- Ⓞ Explanations of this manual are based on operations with your finger when you can operate with either your finger or the stylus pen.
- Ⓞ Menu items, layers and icons described in this manual may be different according to functions being used, conditions, etc.
- Ⓞ “microSD™ memory card (sold commercially)”, “microSDHC™ memory card (sold commercially)” and “microSDXC™ memory card (sold commercially)” are abbreviated as “microSD memory card” or “microSD”.

Exemptions

- The Company is not liable for any damages arising from earthquakes, lightning, storms, floods or other natural disasters, as well as fires, actions by third parties, other accidents, intentional or mistaken operation by the customer, or use under other unusual conditions outside the responsibility of the Company.
- The Company is not liable for any incidental damages (change/disappearance of saved content, loss of business income, disruption of business, etc.) arising from use of or inability to use the product. It is recommended that you keep a copy of important phone numbers etc.
- The Company is not liable for any damages arising from failure to observe the described content of this manual.

- The Company is not liable for any damages arising, for example, from malfunction caused by combination with connected devices or software not related to the Company.
- Captured image data or downloaded data may sometimes be altered or lost due to faults, repair or other handling of the product. The Company is not liable for any damage or lost income resulting from recovery of these data.
- It is recommended you keep a copy of important data in your PC's hard disk, etc. Whatever the cause of fault or malfunction may be, the Company assumes no responsibility for alteration or loss of saved information.

* “The Company” as appears in this manual refers to the following companies:
 Sold by: KDDI CORPORATION,
 OKINAWA CELLULAR TELEPHONE COMPANY
 Manufactured by: SHARP CORPORATION

memo



- Ⓞ Reproduction of the content of this manual in part or in whole is prohibited.
- Ⓞ The content of this manual is subject to change without notice.
- Ⓞ Every effort has been made in the preparation of this manual. Should you notice any unclear points, omissions, etc., feel free to contact us.

Safety Precautions (Observe Strictly)

■ **Before using the product, thoroughly read these safety precautions for proper use. After reading, store the precautions in a safe place.**





These "Safety Precautions" describe instructions that should be observed to prevent damage to property or injury to the customer or others using the product. These instructions are divided into the following categories.



■ Explanation of Indications Used in This Manual

 DANGER	This symbol indicates the potential and imminent danger of death or serious injury ^{*1} to a person.
 WARNING	This symbol indicates the possibility of death or serious injury ^{*1} to a person.
 CAUTION	This symbol indicates the possibility of personal injury ^{*2} to a person or physical damage ^{*3} .

- *1 Serious injury: This refers to loss of sight, injury, burns (high- and low-temperature), electric shock, broken bones, injuries with residual aftereffects from poisoning, etc., and injuries requiring hospital admission for treatment or long-term hospital attendance as an outpatient.
- *2 Injury: This refers to injuries, burns (high- and low-temperature), electric shock, etc. that do not require hospital admission for treatment or long-term hospital attendance as an outpatient.
- *3 Physical damage: This refers to extended damage to buildings, furniture, livestock or pets.

■ Explanation of Graphic Symbols Used in This Manual

 Prohibited	Indicates an action that is not allowed.
 Wet hands prohibited	Indicates that handling with wet hands is not allowed.
 Disassembly prohibited	Indicates that disassembly is not allowed.
 Wetting with water prohibited	Indicates that use in a place where the product is likely to get wet or allowing the product to get wet is not allowed.

	Indicates an action that must be done.
	Indicates that the power plug must be disconnected from the power outlet.

■ Precautions Common to the Main Unit, Charger, au Micro IC Card (LTE), microUSB-3.5ϕ L-Shaped Conversion Cable, Stylus Pen, Peripheral Devices



DANGER

Be sure to read the following hazards before use.



Instruction

Be sure to use only the specified peripheral devices. Use of other peripheral devices might cause overheating, ignition, rupture, fault, or leakage of liquid.



Prohibited

Do not use, store or leave the product in hot places (e.g. by the fire, near a heater, under a kotatsu, in direct sunlight, in a car in the hot sun). Doing so might cause ignition, rupture, fault, fire or injury.



Instruction

Before entering an area where flammable gas is generated such as a gas station, be sure to turn off the product. Do not charge the battery. Failure to observe these precautions might cause the gas to catch fire. In addition, when using NFC payment function at a gas station, be sure to turn off the power in advance. (If NFC has been locked, cancel the lock before turning off the power.)



Prohibited

Do not put the product in a cooking apparatus such as microwave oven or a pressure vessel. Doing so might cause leakage of liquid, ignition, rupture, fault, fire or injury.



Prohibited

Do not throw the product into a fire or heat it. Doing so might cause ignition, rupture or fire.



Prohibited

Do not short-circuit the charger terminal, the external connection jack or the connection jack of microUSB-3.5ϕ L-Shaped Conversion Cable (sample). Do not allow conductive foreign objects (metal fragments, pencil leads, etc.) to come into contact with or get inside a terminal/jack. Doing so might cause fire or a fault.



Prohibited

When using metal accessories, etc., do not allow the metal part to come in contact with the connection jack or power outlet. Doing so might cause electric shock, ignition, injury or a fault.



Prohibited

Do not expose the camera lens to direct sunlight for an extended period. Doing so might cause ignition, rupture or fire by the light-collecting mechanism of the lens.



Disassembly
prohibited

The customer is not allowed to disassemble, modify or repair the product. Doing so might cause a fault, ignition, electric shock, or injury. The Company is not liable even in the event of any nonconformities arising on the product or peripheral devices as a result of modification, etc. Modification of the product is in violation of the Radio Law.



WARNING

Be sure to read the following warnings before use.



Prohibited

Do not drop or subject to strong impact, such as throwing. Doing so might cause rupture, overheating, ignition or a fault.



Prohibited

Do not use outside when you can hear thunder. Doing so might risk lightning strikes and electric shock.



Prohibited

Do not let your hands, fingers and other parts of the body touch the external connection jack or connection jack of microUSB-3.5 ϕ L-Shaped Conversion Cable (sample). Doing so might cause electric shock, injury or a fault.



Prohibited

If the product is damaged because it is dropped or something, and its display is cracked or internal parts are exposed, do not touch the cracked display or exposed parts with your hands. Doing so might cause electric shock or injury from damaged parts. Contact an au shop or Secure cell phone support center.



Wetting
with water
prohibited

Although the product model has waterproof property, stop use if liquid such as water gets inside the main unit from the external connection jack cover or microSD memory card/au Micro IC Card (LTE) cover. Continued use of the product in this state might cause overheating, ignition or a fault.



Instruction

If charging is not completed after the specified charging time, stop charging. Failure to do so might cause leakage of liquid, overheating, rupture or ignition.



Prohibited

Do not leave in places within the reach of small children. Small children might swallow part of the equipment by mistake and choke on them, or might drop them by mistake and cause accidents or injury.

**CAUTION****Be sure to read the following cautions before use.**

Prohibited

Do not store the product in places subject to direct sunlight (e.g. in automobiles), places that get hot, places that get extremely cold, and in humid or dusty places. Doing so might cause overheating, ignition, deformation or a fault.



Prohibited

Do not leave on unstable places such as rocky stands or tilting surfaces especially while the vibration mode is set. Dropping the product may cause injury or damage. Also, pay sufficient attention to impact, etc.



Prohibited

Do not cover or wrap the product with bedding, etc. while using or charging the product. Doing so might cause fire, fault or injury.



Prohibited

Do not touch the product or specified chargers (sold separately) for a long time while charging. Doing so might cause low-temperature burns.



Prohibited

Do not use power outlets or wiring apparatus beyond its rating. Also, exceeding rating, for example, by connecting multiple devices to a single power strip might cause overheating and fire.



Prohibited

Do not place near corrosive chemicals or in places where corrosive gas is generated. Doing so might cause a fault or loss of internal data.



Instruction

Stop use if there is smoke, abnormal odor or noise, excessive overheating, or other abnormalities. During charging, disconnect the specified charger (sold separately) from the power outlet or the socket and make sure that the product is not overheating. Also, when using microUSB-3.5 ϕ L-Shaped Conversion Cable (sample), disconnect it from the product, earphone, etc. and make sure that the product is not overheating. After that, turn the power off and contact an au shop or Secure cell phone support center. Also, if you have dropped or damaged the product, do not continue to use it in that state, and contact an au shop or Secure cell phone support center.



Instruction

When inserting an earphone, etc. into the product, adjust the volume to the proper level. Setting too loud a volume or using the earphone continuously for a long period of time might adversely affect your ears. Also, raising the volume too high might prevent you from hearing sounds around you, which might in turn lead to a traffic accident at a railroad crossing or pedestrian crossing.



Instruction

When adjusting the volume with an earphone, etc. inserted into the product, raise the volume a little at a time. If you raise the volume too much from the outset, sudden loud noise from the earphone, etc. might adversely affect your ears.



Instruction

When using a charger or external device, insert/remove the connector straight to/from the jack. Make sure the orientation of the connector is correct. Failure to do so might cause damage or a fault.



Instruction

When small children use the equipment, have the guardian teach them the proper handling procedures so as to avoid potential dangerous situations. In addition, check that they are using the equipment as directed during use. Failure to do so might cause injury etc.

Main Unit



DANGER

Be sure to read the following hazards before use.



Prohibited

Do not puncture the product with a nail, hit it with a hammer or step on it.
Doing so might cause leakage, overheating, rupture or ignition of the internal battery.



WARNING

Be sure to read the following warnings before use.



Instruction

Be careful not to have the product bitten by your pet.
Failure to do so might cause leakage, overheating, rupture or ignition of the internal battery.



Prohibited

Do not use the product while driving a car or riding a motorbike or bicycle. Doing so may cause a traffic accident. Use of the product while driving a car or motorbike is prohibited by law. Use of the product while riding a bicycle may be punishable by some regulations.



Instruction

Turn off the product while you are aboard an airplane.
Otherwise, the product may affect electronic devices and safety of your flight may be compromised. If the product is permitted to be used on an airplane, use it appropriately by following instructions from the airline company. Do not connect the product with a PC aboard an airplane using the microUSB cable 01 (sold separately), since the product is automatically turned on.



Instruction

The product sometimes affects high-precision electronic devices. So, turn it off near such devices. (Examples of electronic devices that might be affected by the product include cardiac pacemakers, hearing aids, other electronic medical devices, fire alarms, and automatic doors. If you are using an electronic medical device, contact the device manufacturer or retailer for information about the possible effects of radio waves.)



Instruction

When using the product near an implanted pacemaker, implanted cardioverter-defibrillator or other electronic medical device, radio waves might affect these units and devices. So, please observe the following.

1. Those with an implanted pacemaker or implanted cardioverter-defibrillator should carry or use the product at least 22 cm away from the pacemaker or cardioverter-defibrillator.
2. Turn the product off in crowded trains or other crowded places, since there may be people with an implanted cardiac pacemaker or implanted cardioverter-defibrillator nearby.
3. Pay attention to the following points when using the product inside medical institutions.
 - Do not bring the product into operating theaters, intensive-care units (ICU) and coronary care units (CCU).
 - Turn the product off in hospital wards. Do not connect the product with a PC in hospital wards using the microUSB cable 01 (sold separately), since the product is automatically turned on.
 - Even if you are in a lobby, etc., be sure to turn the product off when there are electronic medical devices nearby.
 - When a medical institution has laid down designated areas where use of the product is prohibited or is not allowed to be brought in, abide by the instructions of that medical institution.
4. When using electronic medical devices other than an implanted pacemaker and implanted cardioverter-defibrillator outside a medical institution (e.g. home medical treatment), check individually with the manufacturer of the electronic medical device regarding the influence of radio waves.



Instruction

Stay alert to your surroundings when messaging, browsing the Internet, shooting photos, playing games, watching TV (1Seg) or listening to music. Failure to do so might cause a fall or traffic accident.



Prohibited

Do not point the illuminated light directly at someone's eyes. Be especially careful not to shoot small children from a very close distance. Do not use Mobile light near people's faces. Eyesight may be temporarily affected leading to accidents.



Prohibited

Do not light the mobile light toward a driver of a car, motorbike or bicycle. If dazzled by the light, the driver might become unable to drive and cause an accident.



Instruction

Sometimes, very rarely some people demonstrate symptoms such as temporary muscle spasms, loss of consciousness, etc. by watching repeatedly flickering screens. Those with a past history of this should consult with a physician beforehand.



CAUTION

Be sure to read the following cautions before use.



Prohibited

Use of the main unit in an automobile might sometimes affect on-vehicle electronic devices, though this rarely happens. If this happens, do not use since this may impair safe travel.



Instruction

If you feel any abnormality with your skin, immediately consult a dermatologist. Itching, rashes, eczema, etc. sometimes occurs depending on your physical constitution and condition.

The materials of parts used on the product are as follows.

Part	Material	Surface treatment
Outer case (display frame part)	PC/ASA resin + GF30%	Black discontinuous deposition
Outer case (bottom)	PC/ABS resin + GF20%	Black coating
Back cover	PC/ASA resin + GF30%	Black coating
External connection jack cover	PC resin Elastomer resin	Black coating None
microSD memory card/au Micro IC Card (LTE) cover	PC resin Elastomer resin	Black coating None

Part	Material	Surface treatment
TV antenna	PA resin SUS Nickel-titanium alloy	None
Power key	PC resin	Black coating
Volume up/down key	PC resin	Black coating
Display	Hardened glass (Shatterproof sheet of surface: PET)	Acrylic hard coating
Camera lens	Acrylic resin	Hard coating
Mobile light lens	PC resin	None
Mobile light lens ring	PC resin	None
Charger terminal	SUS	Gold plating
Stylus pen	ABS resin POM resin SUS	None

The materials of parts used on the desktop holder are as follows.

Part	Material	Surface treatment
Outer case	ABS resin	None
Back plate	PC resin	None
Back rib (left/right)	POM resin	None
Front rib	POM resin	None
Holder (left/right)	POM resin	None
Switching knob	POM resin	None
Contact lever	POM resin	None

Part	Material	Surface treatment
Contact terminal	Phosphor bronze	Gold plating
Connection jack (microUSB)	SUS	Tin plating
Rubber leg	Polyurethane resin	None



Prohibited

Do not bring the product close to magnetized objects such as cash cards, floppy disks, credit cards, and prepaid cards. Doing so might result in loss of recorded information.



Prohibited

Do not allow liquids, metal objects, burnable items, and other foreign matter to get inside the microSD memory card slot. Doing so might cause fire, electric shock or a fault.



Prohibited

Do not swing the product around by holding the TV antenna or the stylus pen attached into the main unit. Doing so might cause an accident or damage.



Instruction

Use the product with the external connection jack cover, microSD memory card/au Micro IC Card (LTE) cover, etc. closed. If the covers are open, dirt or water may get inside causing a fault.



Instruction

Stow the TV antenna when not watching TV (1Seg). If you use the product with the TV antenna extended, it might cause unexpected injury by hitting your face, etc.



Instruction

If you have a weak heart, be careful when setting the reception vibration and reception volume to prevent adverse effects on your heart.



Instruction

Pay attention to items becoming stuck to the main unit. The speaker uses magnets, and so thumbtacks, pins, craft knife blades, staples, and other metal objects sometimes become stuck to the main unit, and cause unexpected injury.



Prohibited

Do not put the product directly on sand at a beach, etc. Sand or other small particles might get inside the microphone, speaker, etc. causing the volume to drop. If sand gets inside the product, it might cause overheating or a fault.



Instruction

The product may become hot by prolonged use especially in high-temperature environment. Be careful when using the product touching your skin for a long time, as it might cause low-temperature burns.



Prohibited

When using the product for data communication, do not keep the product in direct contact with your skin for a prolonged period, or do not cover the product with paper, cloth, bedding, etc. The product might get hot, causing fire, burns or a fault.



Prohibited

Do not swing the product with the TV antenna pulled out. Doing so may cause injury or deform or damage the TV antenna.

Internal Battery



(The internal battery of the product is a lithium-ion battery.)

The internal battery is not fully charged at the time of purchase. Charge the battery before using the product.



DANGER

Be sure to read the following hazards before use.



Instruction

If the liquid leaking from inside gets on your skin or clothes, immediately rinse it off with water to avoid injury. If the liquid gets into your eyes, do not rub but wash your eyes with water, and immediately consult a doctor to avoid the risk of losing your eyesight.



Instruction

The internal battery is a consumable item. If the performance of the internal battery does not recover (e.g. the usable time after each charge has become extremely short), the internal battery is at the end of service life, so stop using it. Failure to do so might cause overheating, ignition, rupture or leakage. Since the battery is built-in type, the product will be kept at an au shop etc. and charges will be incurred for repair. Also, you may not use the product in certain period of time. Note that the length of service life varies depending on the usage condition, etc.

Charger



WARNING

Be sure to read the following warnings before use.



Prohibited

Do not use at other voltages than the specified power supply voltage. Doing so might cause ignition, fire, overheating or electric shock.

- Common AC adapter 01 (sold separately): 100 V AC (for domestic use in Japan)
Do not charge with single-phase 200 V or voltage converters for overseas travel.
- AC adapter (sold separately) available overseas other than the adapters above: 100 V AC to 240 V AC
- DC adapter (sold separately): 12/24 V DC (for negative grounded vehicles only)



Instruction

Firmly insert the power plug of the specified charger (sold separately) into the power outlet or cigarette lighter socket down to the base of its pins. Incomplete insertion of the power plug might result in electric shock or fire caused by overheating and ignition. Do not use damaged specified charger (sold separately) or loose power outlets or cigarette lighter sockets.



Instruction

If the fuse in the common DC adapter 01/03 (sold separately) blows, replace it with a fuse of the specified type (250 V, 1 A). Replacing with a different type of fuse might cause overheating or ignition. (For information about fuse replacement, carefully read the manual for the common DC adapter 01/03 (sold separately).)



Prohibited

Do not damage, modify, twist, pull or place a heavy object on the cable of the specified charger (sold separately). Do not use a damaged cable. Doing so might cause an electric shock, short circuit or fire.



Prohibited

Do not let your hands, fingers and other parts of the body touch the charger terminal. Doing so might cause electric shock, injury or a fault.



Prohibited

If you hear thunder, do not touch the power plug. Doing so might cause an electric shock as a result of a lightning strike.

Disconnect
plug from
power outlet

Before cleaning the specified charger (sold separately), unplug its power plug from the outlet or cigarette lighter socket. If the plug remains plugged in when you clean the charger, it might cause an electric shock or short circuit. Also, wipe off dust on the power plug of the specified charger (sold separately). If the plug is left covered with dust, it might cause fire.



Instruction

Wipe off dust on the power plug. Failure to do so might cause fire, burns or electric shock.



Instruction

Install and position in-car devices where they do not hinder driving or safety equipment such as airbags. Failure to do so might cause a traffic accident. Install in-car devices following the instructions of their manuals.

Disconnect
plug from
power outlet

When the charger is not to be used for a long time, disconnect the charger's power plug from the power outlet or cigarette lighter socket. Failure to do so might cause electric shock, fire or a fault.

Wetting
with water
prohibited

The desktop holder, microUSB-3.5φ L-Shaped Conversion Cable (sample), stylus pen and specified charger (sold separately) are not waterproof. Never use in places subject to direct splashing with water, pet urine, etc. or in humid places such as a bathroom. Doing so might cause overheating, fire or electric shock. In the event that a charger is splashed with liquid, immediately disconnect its power plug.



Prohibited

Do not use the desktop holder inside a car. Doing so may cause an accident because driving could be hindered.



CAUTION

Be sure to read the following cautions before use.



Wetting with water prohibited

Do not use in humid places such as bath areas. Doing so might cause electric shock or a fault.



Wet hands prohibited

Do not plug or unplug the specified charger (sold separately) with wet hands. Doing so might cause electric shock or fault.



Disconnect plug from power outlet

When unplugging the power plug of the specified charger (sold separately) from the outlet or cigarette lighter socket, hold the charger to do so. If you pull the cable, it might be damaged, causing overheating, ignition or electric shock.



Prohibited

Do not use the common DC adapter 01/03 (sold separately) with the car engine stopped. Doing so might result in draining of the car battery.

microUSB-3.5 ϕ L-Shaped Conversion Cable



DANGER

Be sure to read the following hazards before use.



Instruction

Strictly observe warnings and cautions indicated by the manufacturer of the earphone or peripheral device you use and follow the descriptions on its manuals to ensure correct use.



WARNING

Be sure to read the following warnings before use.



Prohibited

Do not play games, listen to music, watch TV (1Seg), etc. while driving a car, riding a bicycle, walking, etc. Doing so might impair the safety and cause an accident.



CAUTION

Be sure to read the following cautions before use.



Prohibited

Do not allow liquids, metal fragments, flammable materials, etc. to get inside or come into contact with the connection jack of microUSB-3.5 ϕ L-Shaped Conversion Cable (sample). Doing so might cause fire, electric shock or a fault.



Prohibited

Do not damage, modify, twist, pull or place a heavy object on the cable. Doing so might cause a fault, electric shock or fire. Also, do not use a damaged cable.



Instruction

When inserting/removing the cable, hold the connector part. Pulling the cable part might cause damage or a fault of the cable.



Instruction

If you feel any abnormality with your skin, immediately consult a dermatologist. Itching, rashes, eczema, etc. sometimes occurs depending on your physical constitution and condition.

The materials of parts used on microUSB-3.5 ϕ L-Shaped Conversion Cable (sample) are as follows.

Part	Material	Surface treatment
Cable	TPU (Urethane elastomer)	None
Connector cover on microUSB side	TPE (Olefin elastomer)	None
Tip on microUSB side	SUS301	Nickel plating
Connector cover on 3.5 ϕ side	TPE (Olefin elastomer)	None
Tip on 3.5 ϕ side	Brass	Gold plating

■ au Micro IC Card (LTE)



WARNING

Be sure to read the following warnings before use.



Prohibited

Do not put the au Micro IC Card (LTE) in a cooking apparatus such as a microwave oven or a pressure vessel. Doing so might cause melting, overheating, fuming, loss of data or a fault.



CAUTION

Be sure to read the following cautions before use.



Instruction

Be careful not to injure your hand or finger when attaching/removing the au Micro IC Card (LTE).



Instruction

Use only the devices specified by the Company to insert the au Micro IC Card (LTE) in. Using a device not specified by the Company might cause loss of data or a fault.

For the specified devices, contact an au shop or Customer Service Center.



Disassembly prohibited

Do not disassemble or modify the au Micro IC Card (LTE). Doing so might cause loss of data or a fault.



Prohibited

Do not use or leave the au Micro IC Card (LTE) in hot places such as by a fire or a heater. Doing so might cause melting, fuming, loss of data or a fault.



Prohibited

Do not throw the au Micro IC Card (LTE) into a fire or heat it. Doing so might cause melting, fuming, loss of data or a fault.



Prohibited

Do not touch the IC (metal) part of the au Micro IC Card (LTE) or short-circuit it. Doing so might cause loss of data or a fault.



Prohibited

Do not drop the au Micro IC Card (LTE) or subject it to strong impact. Doing so might cause loss of data or a fault.



Prohibited

Do not fold, bend or place a heavy object on the au Micro IC Card (LTE). Doing so might cause loss of data or a fault.



Wetting with water prohibited

Do not wet the au Micro IC Card (LTE). Doing so might cause loss of data or a fault.



Prohibited

Do not scratch the IC (metal) part of the au Micro IC Card (LTE). Doing so might cause loss of data or a fault.



Prohibited

Do not store the au Micro IC Card (LTE) in dusty places. Doing so might cause loss of data or a fault.



Prohibited

Do not store the au Micro IC Card (LTE) in places exposed to direct sunlight or hot and humid places. Doing so might cause loss of data or a fault.



Instruction

Store the au Micro IC Card (LTE) out of reach of small children. Accidental swallow might cause asphyxiation, injury, etc.

■ Stylus Pen



WARNING

Be sure to read the following warnings before use.



Prohibited

Do not swing the stylus pen toward people. It might hit yourself or other people and cause injury or loss of eyesight.

Handling Precautions

These precautions are provided to ensure that performance can be fully demonstrated. Thoroughly read these precautions to ensure correct use.

■ Precautions common to the main unit, internal battery, charger, au Micro IC Card (LTE), microUSB-3.5 ϕ L-Shaped Conversion Cable, stylus pen, peripheral devices

- Do not apply excessive force to the product during use. Be sure not to put the product into a tightly packed bag or place a heavy object on the product in a bag. Doing so might damage the display or internal circuit board resulting in a malfunction.
Keeping an external device connected to the external connection jack might damage the connector resulting in a malfunction. Such damage and malfunction are not covered by the warranty, even if there is no external damage.

- To ensure waterproof property (equivalent to IPX5 and IPX7) of the product, use the product with the external connection jack cover and microSD memory card/au Micro IC Card (LTE) cover tightly closed.
Note that the waterproof property is not guaranteed in every usage condition. Do not allow water to get inside the product or splash water on the charger or optional accessories. Do not open/close the external connection jack cover or microSD memory card/au Micro IC Card (LTE) cover in the rain or with water drops on the surface of the product. Doing so might cause water intrusion resulting in internal corrosion. Malfunctions determined to be caused by water intrusion are not covered by the warranty.
- Do not use the product in extremely hot, cold or humid places. (Use within an ambient temperature range of 5°C to 35°C and humidity range of 35% to 85%.)
 - Charger
 - Conversion cables
- Do not use the product in extremely hot, cold or humid places. (Use within an ambient temperature range of 5°C to 35°C and humidity range of 35% to 85%. Using at a temperature of 36°C to 40°C is allowed only when you use the product temporarily.)
 - SHT21
 - au Micro IC Card (LTE) (inserted into the SHT21)
- Do not use in places subject to lots of dust or vibration.

-
- Clean the charger terminal and external connection jack of the product, connection jack of microUSB-3.5ϕ L-Shaped Conversion Cable (sample), and connection jack of the desktop holder with dry cotton swabs, etc. every now and then. A soiled terminal/jack might cause poor connection. When cleaning them, do not exert a strong force to prevent deformation.
-
- Clean the product with a soft dry cloth (such as the type used for eyeglasses). Forceful rubbing with a dry cloth may scratch the display. The display may be stained if splash or smear is left attached to the surface. Wiping the product using alcohol, thinner, benzene, detergent, etc. might erase the printing on the outer casing or cause discoloration.
-
- Use as far away as possible from fixed-line phones, TVs and radios. Use nearby might affect them.
-
- The product may become warm while charging or during other operations, depending on the situation, but this is not abnormal.
-
- When the temperature of the product gets high during use, the product may temporarily lower the screen brightness or may stop part of its functions to protect the main unit.
-

■ Main unit

- Do not forcefully press, tap or intentionally subject the display to strong impact. Doing so might cause scratching or damage.
-
- Do not forcefully press sharp objects or hard objects against keys or display surface. Doing so might cause scratching or damage.
The touch panel is designed to be lightly touched by fingers or the stylus pen. Do not apply strong pressure with your fingers, the stylus pen or sharp-pointed objects (such as ballpoint pens and pins) on the touch panel.
In the following cases, the product may not respond to touching the touch panel, or errors in operation may occur.
 - Operation with gloved hands
 - Operation with fingernails
 - Operation with a foreign object placed on the touch panel
 - Operation with a protective film or sticker on the touch panel
 - Operation with water drops left or condensation formed on the surface
 - Operation with wet or sweaty fingers
 - Operation under water
-

- Never use modified au terminals. Use of a modified device violates the Radio Law.
You can perform the following operations on the product to confirm the unique authentication and standard marks (including certification/authentication numbers) for the product.
On the home screen, tap [APPS] → [Settings] → [Device info] → [Technical Regulations Conformity Certification].
The product has acquired the certification of conformity with technical regulations for the specified radio station based on the Radio Law and certification of conformity with technical regulations for the terminal based on the Telecommunications Business Law, and the "Technical Conformity Mark (㊦)" can be confirmed in the product as a certificate. Confirm contents of electrical certificates in the product for information on certification.
If the screws of the product are removed and modifications are made to the internal components, the certification of conformity with technical regulations will become invalid.
Never use the product without the valid certification. Doing so violates the Radio Law.
- To prevent unlawful modification, the product has been designed so that it cannot be easily disassembled. Modifying the product is prohibited by the Radio Law.
- Contents saved in the product, such as contacts, mails and bookmarks might be altered or lost by an accident, fault, repair or mishandling. Be sure to keep a copy of important contents. Note that the Company assumes no responsibility for any damages or lost profits resulting from altered or lost contents.

- Note that content data (both charged or free content) saved on the product cannot be returned to the customer when the product is replaced for repair of a fault, for example.
- The product uses liquid crystal for its display. The display response speed may become slow when the ambient temperature is low, which is due to the property of liquid crystal and not a malfunction. The display response speed will return to normal at room temperature.
- Although the display used on the product is made using high-precision technology, some pixels (dots) might be lit or out at all times. This is not a malfunction.
- Take care not to inconvenience people around you when you use the product in a public place.
- You are recommended to store copies of individual data such as still pictures you took, videos and music in your PC by sending each file as mail attachment, etc. Note, however, that you may not be able to make copies of some copyrighted data even by the above-mentioned means.
- Take care not to place magnetized items such as magnetic cards, speakers and TV sets near the product, as it might cause malfunction.
Putting strong magnetism close to the product might cause false operation.
- When you put the product in your bag etc., take care so that the display does not come in contact with metal objects or other hard objects, as it might cause scratching or damage.

- When suddenly brought into a warm place from a cold place, or when in a humid location, or when used where temperature suddenly changes (e.g. near the air discharge port of an air conditioner), water drops (i.e. condensation) sometimes are formed inside the product. Note that when used under conditions such as this, humidity might cause corrosion or a fault.
- When wiping the display, wipe with a soft, dry cloth. Use of a moistened cloth, glass cleaner or other similar liquid might cause a fault.
- When connecting/disconnecting an external device to/from the external connection jack, make sure to insert/remove the connector of the external device straight to/from the jack.
- Note that applying unnecessary force with an external device connected to the external connection jack may cause damage.
- Do not discard the product together with regular trash. Please cooperate in the collection of the product when it is no longer needed to protect the environment and effectively use resources. Old products are collected at au shops and other places.
- Insert only a microSD memory card into the microSD memory card slot on the product.
- Do not exert excessive force when attaching/removing a microSD memory card. Doing so might injure your hands or fingers.
- While writing/reading data to/from a microSD memory card, do not subject the product to vibration or impact or turn off the power. Doing so might cause loss of data or a fault.
- Do not cover the light sensor with your finger or put a sticker on it. Doing so may hinder the light sensor from detecting the ambient brightness and functioning correctly.
- If the display gets damaged, immediately stop use and contact an au shop or Secure cell phone support center. Keeping using it may cause injury.
- Putting a sticker, etc. on the display or a key may cause malfunction or shortened usage time. Also, doing so may damage the product.
- When using the product while the TV antenna is pulled out or it is kept standing (e.g. while you are watching TV (1Seg)), take lots of care especially to the tip of the TV antenna so that it will not do any harm on surrounding people nor touch your own eye.
- If you put magnetized objects close to the product, the speaker section sometimes emits sounds. This is not a fault.
- Note that if you forcefully pull the external connection jack cover or microSD memory card/au Micro IC Card (LTE) cover or apply excessive force on them, they may be damaged.
- When you put the product in your bag, do not forget to replace the TV antenna to its original position. Also, do not forcefully pull out or bend the TV antenna intentionally. Doing so may cause scratching or damage.
- Bright places such as under the direct sunlight sometimes make it hard to see the display. This is not a fault.

■ Touch panel

- Use your finger or the stylus pen to operate the touch panel. Do not use ballpoint pens, pencils or other sharp-pointed objects. Using such objects does not only hinder correct operation of the touch panel, but also might cause scratching or damage to the display.
- Do not put an object such as the stylus pen on the touch panel. The touch panel might respond to it, causing unexpected operations of the touch panel.
- Do not put stickers or sheets (e.g. commercially available protective films, peep prevention sheets) on the display. Doing so might hinder correct operation of the touch panel.
- Operating the touch panel with fingernails might result in split nails or jammed fingers.
- If the display surface is dirty or wet with sweat or water, it may not function correctly. In such case, wipe the display surface with a dry, soft cloth.
- When carrying the product in your bag, take care not to put the touch panel close to metals or other conductive materials, as it might cause false operation of the touch panel.

■ Internal battery

- Use in very hot or cold environments, for example, when left in an automobile with the windows closed in summer, will cause the internal battery capacity to drop and shorten the available battery usage time. This will also shorten the internal battery's service life. Try to use the internal battery as much as possible at room temperature.

- The internal battery gradually discharges after charging even if the product is not used. The internal battery may discharge completely after long time no use. Charge before using the product.
- Because the internal battery performance or service life will become low, do not store the product in the following conditions.
 - Battery level is full (soon after charging is complete)
 - Battery level is empty (to the extent that the product is not powered on)
 - In extremely hot or humid conditions
- Charge the battery before using the product for the first time after purchase, or if you have not used the product for a long time.
- The internal battery is a consumable item. If the performance of the internal battery does not recover after charge, the internal battery is at the end of service life, so stop using it. Since the battery is built-in type, the product will be kept at an au shop etc. and charges will be incurred for repair. Also, you may not use the product in certain period of time. Note that the length of service life varies depending on the usage condition, etc.
- Internal batteries sometimes swell up as they approach the end of their service life depending on the usage condition. This is due to the properties of lithium-ion batteries, and is not a problem in terms of safety.

■ Charger

- When not using the specified charger (sold separately), remove its power plug from the power outlet or the cigarette lighter socket.
- Do not wrap the power cord of the specified charger (sold separately) around the power plug or desktop holder. Doing so might cause electric shock, overheating or fire.
- Do not forcibly bend the charger's plug or the connection between the connector and power cord. Doing so might cause electric shock, overheating or fire.

■ microUSB-3.5 ϕ L-Shaped Conversion Cable

- Do not wrap microUSB-3.5 ϕ L-Shaped Conversion Cable (sample) around the product and use it.
- Do not dangle, pull or swing around the product by holding the cable. Doing so might cause snapping of the cable or a fault.
- When connecting the connector of microUSB-3.5 ϕ L-Shaped Conversion Cable (sample) to the product, an earphone, etc., insert it all the way in. Failure to do so might cause electric shock or fire due to overheating and ignition. Also, insert/remove the connector in parallel with the connection jack. Failure to do so might cause a fault or an operational problem.
- When carrying or storing the cable, put it into a bag etc. so as not to get dust to adhere to the connection jack or get the connection jack deformed.

- The cable may become warm depending on the situation, such as during communication or charging, but this is not abnormal.

- Use as far away as possible from fixed-line phones, TVs, radios, etc. Use nearby might affect them.

- When the cable gets dirty, wipe it with a soft and dry cloth. Do not use benzene, thinner, alcohol, detergent, etc. as they might alter the outer covering or characters.

■ au Micro IC Card (LTE)

- The au Micro IC Card (LTE) is lent to you by au. In case of loss or damage, the card will be replaced at your expense. When malfunction is suspected, or in case of theft or loss, contact an au shop or PiPit.

- Do not forcibly remove or insert the au Micro IC Card (LTE). Be careful not to exert excessive force when inserting the card into your au terminal.

- You are responsible for any damage caused by inserting your au Micro IC Card (LTE) into some other IC card reader/writer, etc.

- Keep the IC (metal) part of your au Micro IC Card (LTE) clean. Wipe the card with a dry, soft cloth (such as for cleaning eyeglasses) for cleaning.

- Do not put stickers, etc. on the au Micro IC Card (LTE).

- Do not touch the IC (metal) part of the au Micro IC Card (LTE) when inserting or removing it.

■ Stylus pen

- When the tip of the stylus pen is broken or scraped, do not use it. Doing so might damage the display or cause errors in operation.
- Do not lift or swing around the main unit by holding the stylus pen attached into the main unit. Also, do not forcibly pull, attach or remove the stylus pen. Doing so might damage the stylus pen and cause a fault of the main unit.
- Use only the supplied stylus pen when operating the main unit with a stylus pen. Using unspecified one might damage or contaminate the display.
- Do not use the stylus pen to operate other devices. Doing so might cause a fault or damage of the devices.

■ Camera

- When using the camera, follow common rules of etiquette regarding camera use.
- Image data might be altered or lost due to malfunction, repair or mishandling of the product. The Company takes no responsibility for recovery of altered or lost data, damages resulting from altered or lost data, and lost profits.
- When photographing important occasions (such as a wedding), take a trial shot and check the shot image to make sure it is correctly shot.
- Do not use the camera for recording commercially available books or information of which photographing is not allowed.
- Do not leave the camera lens exposed to direct sunlight. Imaging elements might be discolored or burnt.

■ Music, videos and TV (1Seg)

- Do not listen to music, watch videos or TV (1Seg) while driving a car or motorbike, or riding a bicycle. Use of the product while driving a car or motorbike is prohibited by law. (Use of the product while riding a bicycle may also be punishable by law.) In addition, stay alert to the traffic around you even when walking. Surrounding sounds might not be heard clearly, and gazing at the screen may distract your attention causing a traffic accident. Be especially careful at railroad crossings, station platforms and pedestrian crossings.
- Take care not to listen at ear-splitting volume for a long time, as it might affect hearing.
- Be careful of sound leakage from earphones in trains or other places with many people around you.

■ Copyrights and rights of portrait

- If the data you shot or recorded using the product or part or whole of the data you downloaded from the Internet etc. is protected by the third party's copyright, you are not allowed to copy, distribute, publicly send, modify the data without consent of the copyright holder, except for personal use, under the copyright law.
In addition, do not use or modify portraits or names of other individuals without their consent, as it may infringe on rights of portrait.
Note that shooting and recording might be restricted at some live performances, shows and exhibitions even for personal use.

- Be careful about the copyright and portrait right when posting still pictures you shot, etc. on Internet homepages.

■ Backup content on the product

- Please back up important content recorded or downloaded to the product to an outside source. Content recorded to memory on the product sometimes disappears or is altered by unexpected factors, such as static electricity or a fault, repair, mishandling, etc.
* How to make backups: Store important data such as phonebook data, music, shot still pictures and videos on microSD memory cards. You can also send files as mail attachment or transfer to your PC. Note, however, that there are some data that cannot be copied by using these means.

Available Security Codes

Security Codes

The product has various security codes that you can use.

The available security codes are as follows. Do not forget the various security codes that are set as they are necessary for various operations and contracts.

■ Security code

Example of usage	To use Customer Service Center and to do various inquiries, applications, and modifications on the au homepage
Initial value	A four digit number chosen by the customer and noted on the application form

■ Security key

Example of usage	To set and release Restrict address book etc.
Initial value	1234

■ PIN code

Example of usage	To prevent unauthorized use of the au Micro IC Card (LTE) by third parties
Initial value	1234

■ Lock No. (NFC/Osaifu-Keitai lock)

Example of usage	To use the NFC/Osaifu-Keitai lock
Initial value	1234

■ Functions to Protect Your Privacy

The product has the following functions to protect the privacy of saved data.

- Register secret folder
- NFC/Osaifu-Keitai lock
- Screen lock
- Restrict address book

PIN

■ PIN Code

To prevent unauthorized use of the au Micro IC Card (LTE) by a third party, you can set the product to require PIN code entry every time the power is turned on. You also need to enter PIN code when setting whether PIN code entry is required.

If PIN code is incorrectly entered three times consecutively, the PIN code will be locked. You can unlock the PIN code using PUK code.

- PIN code is “1234” and PIN code entry is set to not be required at the time of purchase. You can change PIN code to any four- to eight-digit number, and set PIN code entry to be required as necessary.

■ PUK Code

In case PIN code is locked, you can unlock it by entering PUK code.

- PUK code is an eight-digit number given at the time of purchase, which is printed on the back side of the plastic card on which your au Micro IC Card (LTE) is attached.
- After entering PUK code, you need to set a new PIN code.
- If PUK code is incorrectly entered ten times consecutively, contact an au shop, PiPiit or Customer Service Center.
- “PIN code” is not reset by initializing the product.

memo

- © When the PIN code is locked, the product may be restarted for the security reasons.

Notes on Waterproof and Dustproof Properties

Before using the product, thoroughly read the contents of "Notes on Waterproof and Dustproof Properties" to ensure correct use. Failure to follow the contents described in these sections may cause intrusion of water, sand or other foreign material, resulting in overheating, ignition, electric shock, injury or fault. Proper operations of the product are not guaranteed in every possible condition during actual use. Faults determined, after an inspection, to be caused by mishandling by the customer such as by using the product without following the contents written on "Notes on Waterproof and Dustproof Properties" are not covered by the warranty.

Waterproof and Dustproof Properties of the Product

The product has a protection rating (JIS C 0920) for waterproof property equivalent to IPX5^{*1} and IPX7^{*2} and for dustproof property equivalent to IP5X^{*3} on the condition that the external connection jack cover and microSD memory card/au Micro IC Card (LTE) cover are securely closed (Based on the experiments by the Company).

- *1 IPX5 means that the tablet continues to function as a tablet after being subjected to a water jet (approximately 12.5 liters/min) discharged from a water pouring nozzle (inner diameter: 6.3 mm), from all directions and approximately 3 meters away from the tablet for at least 3 minutes.
- *2 IPX7 means that the tablet continues to function as a tablet after being gently lowered into a tank filled with still tap water (at room temperature) to the depth of 1 meter, immersed at the bottom for approximately 30 minutes and then taken out of the tank.
- *3 IP5X means the level of dust protection. The tablet continues to function as a tablet in safety after it is left in a device containing dust (diameter: 75 μm or smaller) for 8 hours, agitated and then taken out.

Waterproof and dustproof properties of the product enable you

- To use the product in the rain without an umbrella. (with a precipitation of 20 mm/hour or smaller)
- To use the product at the poolside. However, do not get it wet with water other than tap water such as water in the swimming pool or submerge it in water in the swimming pool.
- To wash the product with the low-pressure water flow of a tap water (up to 6 liters/min) at the room temperature (5°C to 35°C).

■ Handling the product

- Close the external connection jack cover and microSD memory card/au Micro IC Card (LTE) cover securely. Even a fine obstacle (one hair, one grain of sand, tiny fiber, etc.) put between contact surfaces may cause intrusion of water or dust.
- If liquid such as water is splashed onto the product with the external connection jack cover or microSD memory card/au Micro IC Card (LTE) cover opened, the liquid may seep inside and cause electric shock or fault. Stop using it, turn off the power and then contact an au shop near you or Secure cell phone support center.
- When the product is wet, wipe it with a dry and clean cloth.
- When your hand or the product is wet, never open/close the external connection jack cover or microSD memory card/au Micro IC Card (LTE) cover.
- The product is resistant to fresh and tap water at room temperature (5°C to 35°C) only.
- Even if the stylus pen is removed from the stylus pen holder, the waterproof property is maintained.

■ Dustproof property of the product

- The dustproof property of the product only guarantees a protection rating equivalent to IP5X and does not guarantee its performance under other using conditions such as when the product is directly put on sand such as a beach.
- If dust is attached to the product, immediately wash it away with water or otherwise clear it completely before use.

■ Notes on Using the Product

- Do not let the product get wet with or submerged into the following liquids.
 - Water containing soap, detergent or bath powder
 - Seawater or water from a swimming pool
 - Hot spring, hot water, etc.
- If the product gets wet with seawater, water from a swimming pool, soft drink, etc. or dust, sand, mud, etc. is attached on the product, immediately wash it away. When it gets dry and coagulated on the product, the stains get hard to get rid of and may cause fault.
- Using the product without completely washing sand or mud away may cause fault such as scratches and damages on the product.
- Do not immerse the product in a bathtub or swimming pool. Also, do not use it under water. (including key operations.)

- The product is not designed to withstand high water pressure. Do not expose the product to a strong water flow with tap water, shower, etc. (more than 6 liters/min) or submerge it under water.
- To prevent condensation, wait until the product reaches room temperature before you bring it from a cold place into a warm place. If condensation occurs, leave it in room temperature until the condensation is removed.
- Do not immerse the product in hot water, use it in saunas or expose it to hot air from hair dryer etc.
- Do not place the product where it gets extremely hot or cold such as near a stove or in a refrigerator.
- Volumes may temporarily become lower due to water entering in the microphone and speaker. Drain water and dry the product well before use.
- When water drops are attached on the touch panel or you perform touch operations with your fingers wet, the product may not properly function.
- The product does not float on water.
- Do not use the product in heavy rain.
- Do not leave the product wet. Doing so may cause fault due to the liquid frozen in a cold place etc.

- Do not drop or otherwise subject the product to strong impact or jab the microphone, speaker, etc. with a cotton swab or any sharp object. Doing so may cause scratching, deformation, etc. on/of the product, resulting in impairment of waterproof/dustproof property.
- Do not place the product directly on sand at a beach, sandbox, etc. or on mud. Grains of sand may get into the speaker etc., causing the volume to drop.
- Packaged items (desktop holder, microUSB-3.5 ϕ L-Shaped Conversion Cable (sample) and stylus pen) and optional accessories are not waterproof/dustproof. When you watch 1Seg etc. with the product set on the desktop holder among packaged items, do not use them in places where water is regularly used such as a bathroom, shower room, kitchen and lavatory even if the specified AC adapter (sold separately) is not connected to the desktop holder.
- If the external connection jack cover or microSD memory card/au Micro IC Card (LTE) cover degrades or is damaged, the waterproof and dustproof properties cannot be maintained. In such case, contact an au shop near you.

■ Maintaining the Waterproof and Dustproof Properties

■ Rubber seals

The rubber seals on the external connection jack cover and microSD memory card/au Micro IC Card (LTE) cover are important to maintain the waterproof property. Be sure to observe the following items.

- Do not remove or scratch them.
- When closing the external connection jack cover and microSD memory card/au Micro IC Card (LTE) cover, do not get the rubber seals caught. Also, do not insert sharp objects into gaps around the external connection jack cover or microSD memory card/au Micro IC Card (LTE) cover. Doing so may damage the rubber seals and cause intrusion of water or dust.
- It is recommended to replace the parts for maintaining the waterproof and dustproof properties (pay service) once every two years regardless of whether any abnormality is present. For information on part replacement, contact an au shop near you.

■ Precautions on Charging

The desktop holder, microUSB-3.5 ϕ L-Shaped Conversion Cable (sample), stylus pen, specified charger (sold separately) and optional accessories are not waterproof/dustproof. Be sure to check the following items before and after charging.

- Check that the product is not wet. If it is wet or after it gets wet, drain water well and wipe remaining water off with a clean dry cloth etc. before setting it on the desktop holder among the packaged items or opening the external connection jack cover.
- If you charge the battery with the external connection jack cover opened, be sure to tightly close the cover when charging is finished. It is recommended to use the desktop holder among the packaged items to charge the battery to prevent water and dust from entering from the external connection jack cover.
- Never charge the battery if the product is wet. Doing so may cause electric shock, short circuit, etc., resulting in fire or fault.
- Do not touch the desktop holder among the packaged items or specified charger (sold separately) with wet hands. Doing so may cause electric shock.

- Do not splash water onto the desktop holder, microUSB-3.5 ϕ L-Shaped Conversion Cable (sample) and stylus pen among the packaged items, specified charger (sold separately) or optional accessories when using the equipment. Do not use the equipment in places where water is regularly used such as a bathroom, shower room, kitchen and lavatory. Doing so may cause fire or electric shock.

■ Washing the Product

If any stain, dust, sand, soft drink, etc. is attached to the surface of the product, gently wipe it off with a cloth and wash the product under a mild water flow (up to 6 liters/min) of tap water at room temperature (5°C to 35°C) at a distance of approximately 10 cm away from the faucet or shower head.

Hold the external connection jack cover and microSD memory card/au Micro IC Card (LTE) cover so that they do not open, and wash the product with your hands without using a brush or sponge. After washing the product, drain water off and then use the product.

- Make sure that the external connection jack cover and microSD memory card/au Micro IC Card (LTE) cover are securely closed before washing the product.
- Do not wash the product with a washing machine or an ultrasound bath.
- Never put the product in a microwave oven for drying it. Doing so may cause the internal battery to leak liquid, overheat, rupture or ignite. Also, doing so may cause the product to overheat, emit smoke, ignite or cause destruction of circuit components.
- Do not expose the product to hot air from a hair dryer or leave it in a high temperature environment for drying it. Doing so may cause the product to deform, discolor, get out of order, etc.

■ Draining Water

If the product gets wet, make sure to drain water remaining in the “microphone”, “speaker section”, “camera lens fringe section”, “key section”, “TV antenna section”, “stylus pen holder”, etc.

- 1 Wipe off water on the surface of the product carefully with a dry and clean cloth etc.**

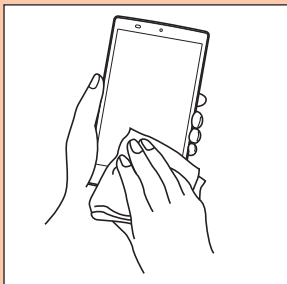

- 2 Pull out the TV antenna, wipe off water remaining on it and stow it into the main unit.**
- 3 Remove the stylus pen and wipe off water remaining on it.**
 - For details on how to attach/remove the stylus pen, refer to "Using the Stylus Pen" (▶ P.58).

- 4 Hold the product securely and shake it approximately 20 times until there is no more water splashing.**

- Make sure of the safety around you and shake the product while holding it securely not to let it drop.

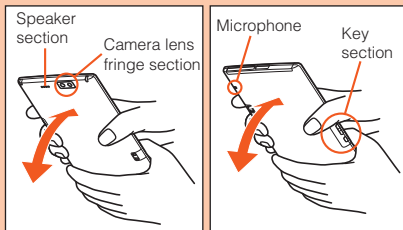

5 Wipe off water remaining in the grooves of each section by gently putting the product against a dry and clean cloth etc.

- Since water is sometimes left in the grooves of each section, clear them of water by putting a cloth against their openings and gently patting them. Make sure that there is no more water or foreign objects remaining in them.

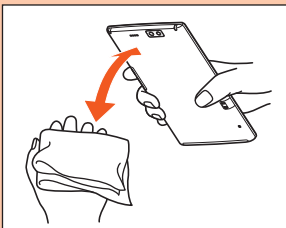

6 Lay out a dry cloth etc. beneath and leave the product on the cloth at room temperature for approximately 2 to 3 hours to dry it.

- Water, if any, remaining in the product may ooze up after wiping off.
- Do not wipe off water remaining in the grooves directly by a cotton swab etc.

7 Attach the stylus pen.

■ Precautions to be taken after water draining

Do not use the product with water drops still left on it.

- Doing so may cause operational failure or cause clothes or bags to get wet.
- Doing so may cause short circuit of a jack section.
- Doing so may cause fault due to the water drops frozen in a cold place.

Notes on Using Bluetooth®/ Wireless LAN (Wi-Fi®) Functions

Frequency Band

Bluetooth® and wireless LAN (Wi-Fi®) functions (2.4 GHz band) of the product use frequencies in the 2.4 GHz band ranging from 2.402 GHz to 2.480 GHz.

- Bluetooth® function: 2.4FH1/XX4

2.4FH1/XX4

The product uses the 2.4 GHz band.

FH1 uses FH-SS as the modulation scheme. The interference distance is about 10 m or less.

XX4 uses other schemes. The interference distance is about 40 m or less.

Bands of mobile unit identification devices cannot be avoided.

- Wireless LAN (Wi-Fi®) function: 2.4DS/OF4

2.4DS/OF4

The product uses the 2.4 GHz band.

DS-SS and OFDM are used as the modulation schemes. The interference distance is about 40 m or less.

Bands of mobile unit identification devices can be avoided.

Channels available with the 2.4 GHz band wireless LAN (Wi-Fi®) of the product are between 1 to 13. Available channels differ depending on the country. For use in airplane, check with the airline company in advance.

Precautions about Bluetooth®

- The Bluetooth® function of the product conforms to the domestic standards of Japan and FCC standards and EC directives, and has been certified. Use of the Bluetooth® function may be restricted in some countries/regions. If you are using the Bluetooth® function overseas, check the relevant laws and regulations of the country/region you visit.
- The 2.4 GHz band used by wireless LAN (Wi-Fi®) and Bluetooth® devices is shared by various other devices. For this reason, Bluetooth® devices use technologies for minimizing effects from other devices using the same radio frequency band. In some cases, however, the communication speed and connectable range may be decreased, or disconnection may occur, due to interference by other devices.
- The communication speed and connectable range vary depending on the distance between communication devices, obstacles and the Bluetooth® devices used.

■ Bluetooth® function precautions

The frequencies used by the Bluetooth® function of the product are in the 2.4 GHz band. In this frequency band, other similar wireless stations, in-plant wireless stations for mobile unit identification that require a license for use, such as factory production lines, specific small power wireless stations that do not require licenses and amateur wireless stations (collectively called “other wireless stations” from here on) are operated in addition to home electrical appliances such as microwave ovens and industrial, scientific and medical devices.

1. Before using the product, make sure that “other wireless stations” are not in operation nearby.
2. In the event that instances of radio wave interference have occurred between the product and “other wireless stations”, immediately either relocate the product or stop operation of the device (stop emission of radio waves).
3. If you are unclear on any points or are troubled by anything, contact an au shop or Customer Service Center.

Precautions about Wireless LAN (Wi-Fi®)

- The wireless LAN (Wi-Fi®) function of the product conforms to the domestic standards of Japan, FCC standards and EC directives, and has been certified. Use of the wireless LAN (Wi-Fi®) function is restricted in some countries/regions. If you are using the wireless LAN (Wi-Fi®) function overseas, check the relevant laws and regulations of the country/region you visit.
- Do not use the product in places where electromagnetic waves are generated or near electric products, AV and OA equipment, or other magnetized devices.
- Subjecting the product to magnetic or electrical noise might increase noise and prevent it from performing communications. (The product is particularly susceptible to noise when it is used near a microwave oven.)
- Using the product near a TV, radio or similar appliance might cause reception interference and disrupt TV images.
- Searching might not be successful if there are multiple wireless LAN (Wi-Fi®) access points near the product and the same channel is being used.

■ 2.4 GHz band wireless LAN (Wi-Fi®) precautions

The frequencies used by the wireless LAN (Wi-Fi®) function of the product are in the 2.4 GHz and 5 GHz band. In the 2.4 GHz frequency band, other similar wireless stations, in-plant wireless stations for mobile unit identification that require a license for use, such as factory production lines, specific small power wireless stations that do not require licenses and amateur wireless stations (collectively called “other wireless stations” from here on) are operated in addition to home electrical appliances such as microwave ovens and industrial, scientific and medical devices.

1. Before using the product, make sure that “other wireless stations” are not in operation nearby.
2. In the event that instances of radio wave interference have occurred between the product and “other wireless stations”, immediately either relocate the product or stop operation of the device (stop emission of radio waves).
3. If you are unclear on any points or are troubled by anything, contact an au shop or Customer Service Center.

■ 5 GHz band wireless LAN (Wi-Fi®) function precautions

In the 5 GHz frequency band, three channels of 5.2 GHz/5.3 GHz/5.6 GHz band (W52/W53/W56) are available.

- W52 (5.2 GHz band/36, 40, 44, 48 ch)
- W53 (5.3 GHz band/52, 56, 60, 64 ch)
- W56 (5.6 GHz band/100, 104, 108, 112, 116, 120, 124, 128, 132, 136, 140 ch)

Making a communication with 5.2 GHz/5.3 GHz band (W52/W53) outdoors is prohibited by the Radio Law.

memo

- Connections between the product and all other Bluetooth® and wireless LAN (Wi-Fi®) devices have not been confirmed. Therefore, connections with all Bluetooth® and wireless LAN (Wi-Fi®) devices are not guaranteed.
- The product supports security features for wireless communications that are compliant with the Bluetooth® and wireless LAN (Wi-Fi®) standard specifications, but the security may not be sufficient depending on the usage environment and configuration. Be careful when making data communication using Bluetooth® or wireless LAN (Wi-Fi®) function.
- Wireless LAN (Wi-Fi®) has the advantage that it can be freely connected anywhere within the radio wave range, as it uses radio waves for exchanging information. At the same time, there is a risk that a malicious third party may obtain unauthorized access if security settings have not been configured. You are recommended to configure security settings before using wireless LAN (Wi-Fi®) at your decision and responsibility.
- The Company assumes no responsibility for leakage of data or information that may occur during Bluetooth®/wireless LAN (Wi-Fi®) communication.

© Since Bluetooth® and wireless LAN (Wi-Fi®) functions use the same frequency band, using the both functions at the same time may cause radio wave interference resulting in decreased communication speed or disconnection from the network. If connection fails, stop using either of the Bluetooth® and wireless LAN (Wi-Fi®) functions.

Notes on Packet Communication Charge

- Since constant Internet connection is possible with the product, packet communication may be performed automatically by some applications, resulting in high packet communication charges. Therefore, subscription to the flat-rate/discount service for packet communication charges is recommended.
- To browse homepages, download applications, communicate using applications, send/receive e-mails and configure various settings, connection to the Internet is required, to which packet communication charge applies.
 - * Packet communication charge does not apply to Wi-Fi® connection.

Notes on Google Play/au Market/ Applications

- Be sure to check the security of the application, then install it at your own risk. Some applications might cause virus infection, damage various data, and send out your location information, usage history or personal information etc. stored in the product via the Internet.
- The Company assumes no responsibility for any problems that might be caused by applications you have installed. In such case, you may be charged a repair fee even during the warranty period.
- The Company assumes no responsibility for any disadvantage brought to you or any third party by applications you have installed.
- Insertion of a microSD memory card is necessary to use some applications.
- Some applications prohibit the product from entering sleep mode while they are active, or rapidly drain the battery while running in the background.
- Operation procedures and screen appearances of the applications preinstalled in the product and those installed by you are subject to change without notice as a result of version upgrade. In addition, operation procedures described in this manual may differ from the actual procedures.
- Applications are either installed on the microSD memory card or the main unit (system).

Names and Functions of Parts

Front/Bottom

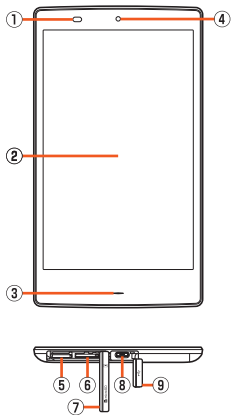

① **Light sensor**

Detects the ambient brightness and adjusts the brightness of display.

② **Display (Touch panel)**

③ **Charging/Notification indicator**

④ **In camera lens**

⑤ **microSD memory card slot**

⑥ **au Micro IC Card (LTE) slot**

⑦ **microSD memory card/au Micro IC Card (LTE) cover**

⑧ **External connection jack**

When you connect microUSB-3.5 ϕ L-Shaped Conversion Cable (sample), the common AC adapter 04 (sold separately), the microUSB cable 01 (sold separately), the MHL cable (sold commercially), etc. to the product, some applications may not function properly since the geomagnetic sensor is affected by the magnetism of connected devices. Use the product after removing the cable.

⑨ **External connection jack cover**

Back/Right Side

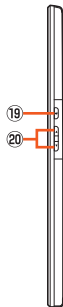
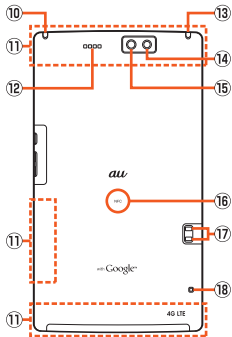

10 TV antenna

11 Internal antennas area

Do not cover the internal antennas area with your hand during communication. Also, do not paste stickers etc. around the internal antennas area. Doing so may make the quality of communication deteriorate.

12 Speaker

13 Stylus pen

14 Mobile light

15 Out camera lens

16 NFC mark

Hold it over a reader/writer when using NFC. Send and receive data using Android beam.

17 Charger terminal

18 Microphone

Use it for recording sounds etc. Take care not to cover the microphone with your fingers etc. when using it.

19 Power key

Set sleep mode.

Hold it down to turn on/off the power, set the manner mode, etc.

20 Volume up/down key

Adjust the volume for playing music or video. Tap “” to adjust the volume of the alarm sound or notification sound by the slide operation.

Hold  down on the Welcome Sheet(Lock Screen) to turn on the mobile light.

memo

- The back cover of the product is not removable.
- The battery is built in the product.

Using the au Micro IC Card (LTE)

au Micro IC Card (LTE)

The au Micro IC Card (LTE) records your personal information such as phone numbers. The product is compatible with au Micro IC Card (LTE) only. You cannot use the product by inserting the au IC-Card or micro au IC-Card for au phones and smartphones instead.

au Micro IC Card (LTE)



memo

- © Make sure to unplug the microUSB plug of the common AC adapter 04 (sold separately) etc. from the product when attaching or removing the au Micro IC Card (LTE).

When the au Micro IC Card (LTE) is not inserted

If the au Micro IC Card (LTE) is not inserted, the following operations are unavailable.

- Sending/Receiving a mail
- Confirming your own phone number/own mail address
- Setting UIM card lock

Besides the above, functions which require your phone number etc. may not be available.

Attaching the au Micro IC Card (LTE)

Before attaching the au Micro IC Card (LTE), turn the product off.

- 1 Open the microSD memory card/au Micro IC Card (LTE) cover.**
- 2 Insert slowly the au Micro IC Card (LTE) into the au Micro IC Card (LTE) slot.**

Confirm the direction of the au Micro IC Card (LTE) and insert it in the direction of the arrow until you hear a click and confirm it is locked.

Releasing your finger before the au Micro IC Card (LTE) is locked may cause it to pop out.

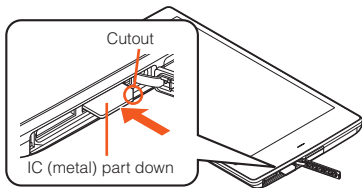

3 Close the microSD memory card/au Micro IC Card (LTE) cover.

memo

© Inserting the au Micro IC Card (LTE) not deeply enough may prevent the product from functioning properly.

Removing the au Micro IC Card (LTE)

Before removing the au Micro IC Card (LTE), turn the product off.

1 Open the microSD memory card/au Micro IC Card (LTE) cover.

2 Push slowly the au Micro IC Card (LTE) towards inside.

After it clicks, pull back your finger without releasing it from the au Micro IC Card (LTE) until it comes out a little. Releasing your finger from the au Micro IC Card (LTE) when it is pushed deeply into the slot may cause it to pop out.

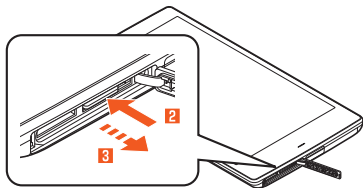

3 Pull slowly the au Micro IC Card (LTE) straight out.

4 Close the microSD memory card/au Micro IC Card (LTE) cover.

Using a microSD Memory Card

microSD Memory Card

You can save, move and copy data by attaching one of microSD memory cards (including microSDHC memory cards and microSDXC memory cards) in the product.

memo

- ◎ The maximum file size available on a microSD memory card is 2 GB per file when saving data to a microSD memory card.
- ◎ A microSD memory card initialized on other devices may not work on the product properly. On the home screen, tap [APPS] → [Settings] → [microSD & tablet storage] → [Erase microSD] → [Erase SD card] → Unlock → [Erase everything] to initialize the microSD memory card.
- ◎ To play/display data on the microSD memory card, on the home screen, tap [APPS] → [Contents Manager] and use Contents Manager.
- ◎ Some copyright protected data may not be played on the product even if they can be moved/copied from a PC etc. to a microSD memory card successfully.

- ◎ microSDXC memory cards are available only on SDXC compatible devices. If you attach a microSDXC memory card to a device that does not support SDXC, the message inducing you to initialize the card may be displayed. However, do not initialize the card. If you initialize a microSDXC memory card on a device that does not support SDXC, it will erase data on the microSDXC memory card and rewrite the file system. Part of space on the microSDXC memory card may become unavailable.

Handling Precautions

- Do not turn off the product or subject it to impact while microSD memory card data is being accessed. Doing so may cause data corruption.
- The product supports microSD/microSDHC/microSDXC memory cards. For the supported microSD/microSDHC/microSDXC memory cards, contact each microSD memory card vendor or refer to the au homepage.

Attaching a microSD Memory Card

Before attaching a microSD memory card, turn the product off.

- 1** Open the microSD memory card/au Micro IC Card (LTE) cover.

2 Insert slowly a microSD memory card into the microSD memory card slot.

Confirm the direction of the microSD memory card and insert it in the direction of the arrow until you hear a click and confirm it is locked.

Releasing your finger before the microSD memory card is locked may cause it to pop out.

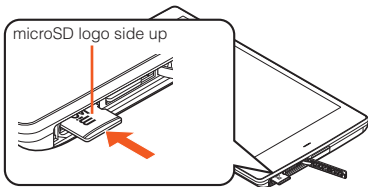

3 Close the microSD memory card/au Micro IC Card (LTE) cover.

memo

- ◎ Make sure that the top/bottom and front/rear of the microSD memory card are facing correctly. Trying to force a wrongly oriented card into the slot could make it impossible to remove the card or result in damage.
- ◎ Do not touch the terminal part of a microSD memory card.

Removing the microSD Memory Card

Before removing the microSD memory card, turn the product off.

1 Open the microSD memory card/au Micro IC Card (LTE) cover.

2 Push slowly the microSD memory card towards inside.

After it clicks, pull back your finger without releasing it from the microSD memory card until it comes out a little. Releasing your finger from the microSD memory card when it is pushed deeply into the slot may cause it to pop out.

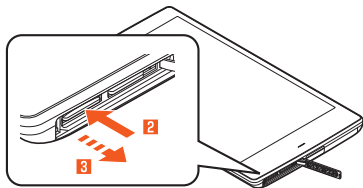

3 Pull slowly the microSD memory card straight out.

4 Close the microSD memory card/au Micro IC Card (LTE) cover.

memo

- ⊙ Do not remove the microSD memory card forcefully. Doing so may result in damage or data loss.
- ⊙ Applications installed to a microSD memory card cannot be used when you remove the microSD memory card.
- ⊙ The microSD memory card may become warm after a long time use, but this is not a fault.

Charging

Charging

When you purchase the product, the internal battery is not fully charged. Be sure to charge the internal battery before use.

- If the performance of the battery does not recover (e.g. the usable time after each charge has become extremely short), the internal battery may be at the end of service life. On the home screen, tap [APPS] → [Settings] → [Device info] → [Status] → [Battery status] to check the charging performance of the internal battery.

- While charging, the charging/notification indicator illuminates in red, and the battery icon is displayed with ⚡ superimposed. When charging is finished, the charging/notification indicator goes out.

memo

- ⊙ Depending on the operation procedure and usage environment, the temperature inside the product may get high and the product may even get heated. In such case, charging may stop for security reasons.
- ⊙ Charging the internal battery while using the camera function etc. may lengthen the charging time.
- ⊙ If you perform various operations with a specified charger (sold separately) connected to the product, charging/discharging may take place repeatedly in a short time. Frequently charging the internal battery shortens its service life.
- ⊙ If you charge the internal battery when the battery has run out, the charging/notification indicator may not illuminate soon. However, charging is in progress.
- ⊙ If the charging/notification indicator flashes in red, turn the power off forcibly (▶ P.55) and turn it on. If the indicator flashes even after that, stop charging the internal battery and contact an au shop or Secure cell phone support center.
- ⊙ If you stop charging while the charging/notification indicator still illuminates during charging, the internal battery may be left not fully charged even if 🔋 is displayed. In such case, the usage times shorten.

Ⓞ If you start charging when no application is activated, Charging theater is activated and a slideshow is displayed.

Charging with the Desktop Holder and the Specified AC Adapter (Sold Separately)

The followings are the explanation of how to connect the desktop holder and the common AC adapter 04 (sold separately) to charge. For details on the specified AC adapter (sold separately), refer to "Introduction of Peripheral Devices" (▶ P.71).

1 Insert the microUSB plug of the common AC adapter 04 (sold separately) to the connection jack of the desktop holder.

Confirm the direction of the microUSB plug and insert it in the direction of the arrow.

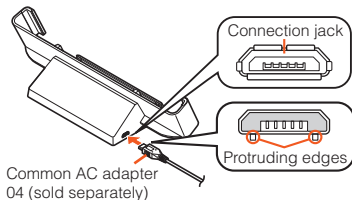

2 Place the main unit on the desktop holder with the charger terminal of the main unit facing down.

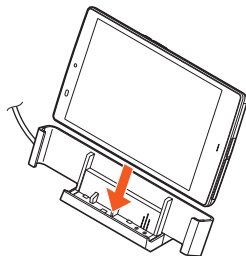

3 Plug the common AC adapter 04 (sold separately) power plug into a 100 V AC power outlet.

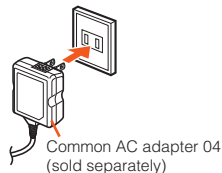

- 4** When charging is finished, remove the main unit from the desktop holder and unplug the common AC adapter 04 (sold separately) power plug from the power outlet.

Hold the desktop holder when removing the main unit. Also, pull the microUSB plug of the common AC adapter 04 (sold separately) straight out from the desktop holder.

memo

- ◎ When using the desktop holder, connect only the specified AC adapter (sold separately). Connecting equipment not specified such as a PC or portable charger to the desktop holder may cause fault. Do not connect such equipment to the desktop holder.

Charging with the Specified AC Adapter (Sold Separately)/Specified DC Adapter (Sold Separately)

The followings are the explanation of how to connect the common AC adapter 04 (sold separately)/common DC adapter 03 (sold separately) to charge. For details on the specified AC adapter (sold separately)/specified DC adapter (sold separately), refer to "Introduction of Peripheral Devices" (▶ P.71).

- 1** Open the external connection jack cover of the product.

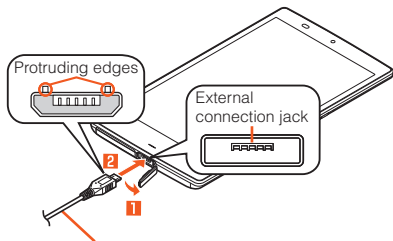

Common AC adapter 04 (sold separately)/
Common DC adapter 03 (sold separately)

- 2 Confirm the direction of the microUSB plug of the common AC adapter 04 (sold separately)/common DC adapter 03 (sold separately) and insert it in the direction of the arrow to the external connection jack of the product.
- 3 Plug the common AC adapter 04 (sold separately) power plug into a 100 V AC power outlet/Plug the common DC adapter 03 (sold separately) plug into a cigarette lighter socket.

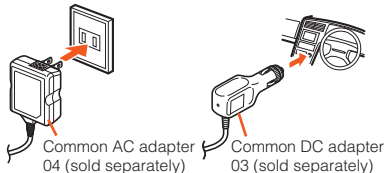

- 4 When charging is finished, pull the microUSB plug of the common AC adapter 04 (sold separately)/common DC adapter 03 (sold separately) straight out from the external connection jack of the product.
- 5 Close the external connection jack cover of the product.
- 6 Unplug the common AC adapter 04 (sold separately) power plug from the power outlet/Unplug the common DC adapter 03 (sold separately) plug from the cigarette lighter socket.

memo

- ⦿ Although you can charge the internal battery while the power is turned on, charging time lengthens.

Charging with a PC

The followings are the explanation of how to charge the internal battery by connecting the product to a USB port of a PC through which the battery can be charged.

- 1 Connect the microUSB cable 01 (sold separately) to a USB port of a PC after the PC is activated completely.**

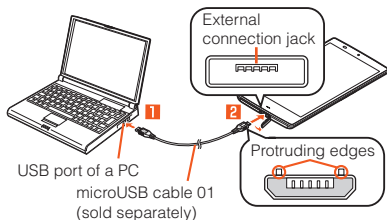

- 2 Connect the microUSB cable 01 (sold separately) to the product after the product is activated completely.**

memo

- If you use the microUSB cable to charge the internal battery, it may take the internal battery longer to be fully charged than if you use the specified AC adapter (sold separately).
- The product supports two microUSB plug shapes.
- Turn the protruding side of the microUSB plug up and insert the microUSB plug to the external connection jack of the product straightly. Inserting the microUSB plug in the wrong direction may result in damage to the external connection jack of the product.
- The product is turned on when it is connected to a PC while the power is turned off.
- If you charge the internal battery when the battery has run out, the charging/notification indicator may not illuminate. In such case, use the specified AC adapter (sold separately) for charging.

Turning the Power On/Off

Turning the Power On

- 1**  (hold down for at least 2 seconds).

memo

- The initial setting of the touch panel will be executed until "AQUOS PAD" disappears from the screen after the power is turned on. Do not touch the screen, otherwise touch panel operations may not be performed properly.

■ Turning the Power Off

1  (hold down for at least 2 seconds).

2 [Power off] → [OK].

■ Restarting the Product

You can restart the product after turning it off.

1  (hold down for at least 2 seconds).

2 [Reboot] → [OK].

■ Turning the Power Off Forcibly

Since the battery is built in the product, it cannot be removed.

To turn the power off forcibly, follow the step below.

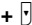
1  +  (hold down for at least 12 seconds).

memo

- Ⓞ If the power is turned off forcibly, unsaved data will be deleted. Do not turn the power off forcibly unless you cannot operate the product.

Sleep Mode

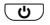
If you press  or no operation is made for a specified time, the screen is turned off temporarily, and then sleep mode is set.

■ Disabling Sleep Mode

1  while sleep mode is set.

memo



- Ⓞ Do not touch the screen when you disable sleep mode. Otherwise touch panel operations may not be performed properly.

Welcome Sheet(Lock Screen)

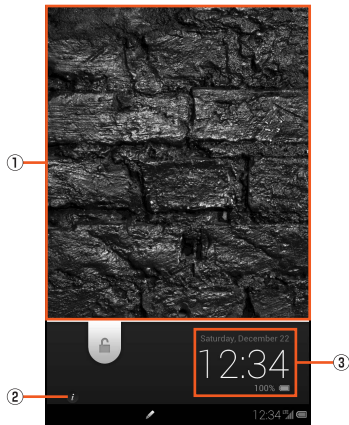
The Welcome Sheet(Lock Screen) is displayed if you disable sleep mode.



《Welcome Sheet(Lock Screen)》

Slide “” to the bottom of the screen to unlock.
Tap, long touch or slide “” up to display shortcuts.

① Wallpaper

② Owner info key

Display texts according to items set for “Owner info” in “Lock & Security”.

③ Info Area

Flick to the left/right to switch the weather, stock prices information, media operation keys, and date and time.

Switching the Display Language to English

You can switch the display language for function names and other items to English.

1 On the home screen, [アプリ] (APPS).

2 [設定] (Settings).

3 [言語と文字入力] (Language & input).

4 [言語(Language)を選択] (Select language).

5 [English].

Using the Touch Panel

The display on the product is a touch panel operated by touching it with your finger or the stylus pen.

■ Tap/Double Tap

Tap: Gently touch the screen and then immediately release your finger.

Double tap: Tap the same position twice.

- Select an item or icon displayed on the screen. Double tap on the browser etc. to enlarge/reduce the screen.

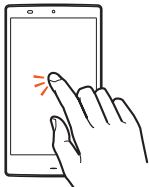

■ Long Touch

Keep touching an item etc. with your finger.

- Display context menu etc.

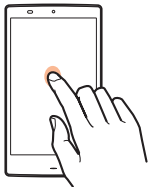

■ Slide

While your finger is gently touching the screen, trace it to the desired direction to move over when all items cannot be displayed within the screen.

- Scroll screen or switch pages. In addition, operate gauge and bar when adjusting volume and brightness.

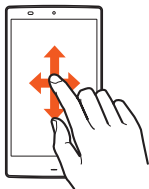

■ Flick

Operate the screen by quickly moving (flicking) your finger up, down, right or left.

- Switch pages, enter characters by flick input, etc.

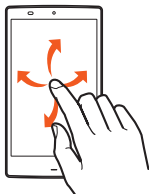

Pinch

Touch the screen with two fingers and widen (pinch-out) or narrow (pinch-in) the fingers' distance.

- Enlarge/Reduce the screen of the browser etc.

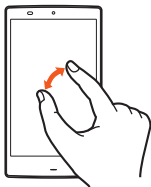

Drag

While your finger is gently touching an item or icon, trace it to the desired position to move or perform other operations.

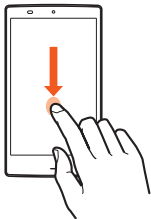

Using the Stylus Pen

Basic operations which can be operated with your finger also can be operated with the stylus pen.

- If you tilt the stylus pen, operations may not be recognized.
- When using the stylus pen, do not touch the touch panel with your hand, finger, etc. The touch panel may not function properly.
- The touch panel may not function properly depending on the application.
- When not using the stylus pen, you can attach it into the main unit.

memo

- ◎ The touch panel is designed to be lightly touched with the supplied stylus pen. Operations with touch pens etc. other than the supplied stylus pen are not guaranteed.

■ Removing the Stylus Pen

1 Remove the stylus pen.

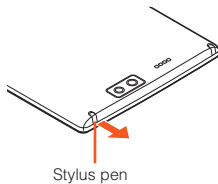

■ Attaching the Stylus Pen

1 Insert the stylus pen into the stylus pen holder of the main unit.

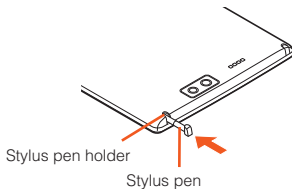





memo

© Insert the stylus pen all the way in. Otherwise, it may fall off.

Using the Touch Keys

The following icons are displayed on the system bar and can be used as touch keys.

- Touch keys with other than the following icons may be displayed depending on the screen being displayed.

Icon	Description
	Return to the previous screen.
	Close the software keyboard or history of activated applications being displayed.
	Display the home screen.
	Display the history of activated applications.
	Use KAKU Notepad and KAKU Notebook.

Using the 3-Line Home

3-Line Home

The 3-Line Home is a home screen which consists of the Apps Sheet, the Widget Sheet and the Shortcut Sheet. You can use a function by tapping an icon/a widget/shortcut on each sheet.

- You can switch each sheet by tapping “APPS”, “WIDGETS” or “SHORTCUTS” on the Sheet Switcher, or sliding/flicking the home screen to the left/right.

Switching sheets

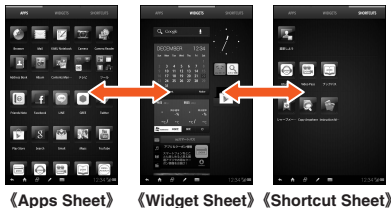

Viewing the 3-Line Home

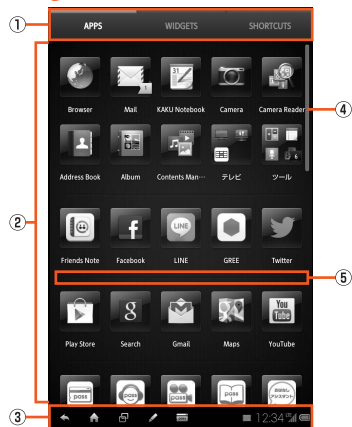

① Sheet Switcher

Long touch Sheet Switcher, drag it to the destination and release your finger to move it.

② Apps Sheet/Widget Sheet/Shortcut Sheet

③ System bar

Touch keys are displayed on the left side. The status area is displayed on the right side. Notification/Status icons and time are displayed on the status area.

④ Scroller

Displayed when the screen is scrolled. You can scroll the screen by sliding the displayed scroller up/down.

⑤ Separator



Pinch out vertically on the home screen to add a separator. You can delete the separator by pinching in vertically.

memo





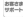

- If the usage guide for handwriting notepad is displayed, confirm the contents and follow the on-screen instructions.
- If there is no item such as an application between separators, you cannot add a separator.

Main Application List

Application	Description
 auテレビ.Gガイド (au TV. G-GUIDE program table)	View TV program table or search programs. Functions using 1Seg or remote timer recording can be used.
 Friends Note	"Friends Note" can manage Native Address Book and multiple social networking services in just one application.
 Facebook	Use Facebook.
 au Smart Pass	You can enjoy over 500 apps by ¥390 per month! Also coupon, present, photo storage and security apps are available! Please enjoy your safety and comfortable tablet life!
 Uta Pass	Streaming music channel service that enables you to listen to varieties of preset channels and you can also listen with your friends.

Application	Description
 LISMO Player	Plays music or checks information on the music using the LISMO Player. Moreover, try listening to it and purchase the investigated music.
 Karada Manager	“Karada Manager” supports you to go on a diet. It has “本格ダイエットモード” (genuine diet mode)” which is enhanced of a recording function. In addition, it supports you to lose your weight with “スペシャルトレーナー” (Special trainer)” which is supervised program by celebrities of diet and beauty. © KDDI / Powered by neos
 Play Books	Purchase books from Google Play or read the books.
 auお客さまサポート (au Customer Support)	You can check the subscription contents or monthly usage of your au terminals etc. with this application. You can change your rate plan, apply for optional services and so on at au Customer Support website.

Application	Description
 au災害対策 (au Disaster Countermeasure)	This is an application in which you can use Disaster Message Board, Emergency Rapid Mail (Earthquake Early Warning, Disaster and Evacuation Information, and Tsunami Warning) and Disaster Voice Messaging Service.
 安心アクセス (Safety Access)	This is an application which limits the access to the inappropriate application and web page so that your child can use a tablet safety.
 3LM	Delete data in the SHT21 and microSD memory card or lock its operations in case of loss of your SHT21.
 リモートサポート (Remote Support)	Call for technical supports on the tablet operations by sharing the tablet's screen that you are watching with au operators.
 NFC Menu	Shows compatible applications list with the NFC service, sets NFC lock, or makes NFC settings.

Application	Description
 Instruction Manual	Check the contents written in “Full Instruction Manual” (Japanese). You can search explanations of a function that you want to use by using the table of contents, index and search engine. Also, you can easily search explanations often confirmed by putting bookmarks on them.
 au ID Setting	Set au ID.
 au Market	You can install Android-based applications offered with au Smart Pass service.
 au Easy Setting	“au Easy Setting” assists you to set up au services and functions.
 au Wi-Fi接続ツール (au Wi-Fi connection tool)	Connects to a Wi-Fi network easily in an area where au Wi-Fi SPOT is available. Also, you can set Wi-Fi® easily with a wireless LAN (Wi-Fi®) access point on which “Simple connection” is available.
 Settings	From Settings, set up and manage functions.

* Requires download and installation to use.

memo

- When you tap an application icon to use the corresponding function, communication charges may be incurred depending on the function.
- The design of icons etc. may be changed without prior notice.
- Besides the above, some applications are installed on the product. For details, refer to “Instruction Manual application” (Japanese).

Using the Status Area

Icons

The status area is displayed on the right side of the system bar.

The notification icons to notify you of a new mail message, a running operation, etc. are displayed on the left side of the status area, while the status icons to show the status of the product are on the right side.

Main Notification Icons

Icon	Description
	New mail message (Mail)
	New mail message (PC-mail)
	New mail message (Gmail)
	Manner mode status : Standard manner mode : Silent manner mode
	Space on the main unit (system) available less than approx. 10 %
	Reading the main unit (memory)/a microSD memory card
	USB connecting
	Update available
	Software update available
	Major Update (OS Update) available

Main Status Icons

Icon	Description
	Time
	Battery level ~ : Battery level display : No battery <ul style="list-style-type: none">While charging, the battery icon is displayed with superimposed.
	Airplane mode set
	Signal strength (Receiving electric field) ~ : Level display : Out of service area <ul style="list-style-type: none">The icon indicating network is displayed at the upper left.During a communication, the icon is displayed with superimposed.

Using the Notification/Status Panel

In the notification/status panel, you can check the details on notification icons and status icons or activate an application corresponding to the icon.

You can also set the manner mode, VeilView, etc.

1 Tap the status area.

Alternatively, slide the status area up.



《Notification/Status panel》

① Status panel

Status icons are displayed. Tap it to display “settings list”. For details on “settings list”, refer to “Setting Guide”.

② Notification panel

Check the status of the product and contents of notifications. You can activate a corresponding application depending on the tapped information.

③ Clear

Tap it to clear all the notifications.

Switching Software Keyboards

- 1 On the character input screen, []
 - [Change input UI]
 - [Set 12 keyboard]/[Set QWERTY keyboard].

Viewing the Character Input Screen

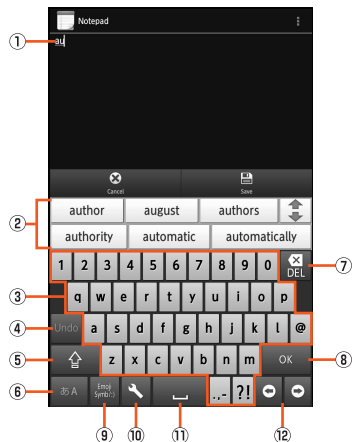

《Character input screen (QWERTY)》

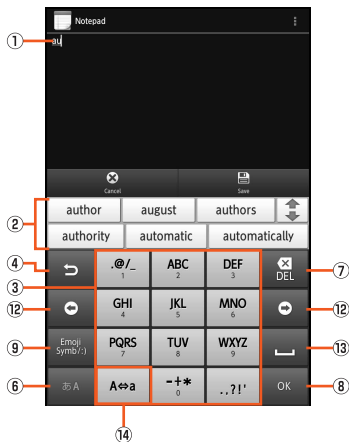

《Character input screen (12 Key)》

① Character entry area

② Input candidates list

If the predictive conversion is enabled, the predictive conversion candidates list is displayed when characters are entered. If the relational prediction is enabled, the relational prediction candidates list is displayed when you determine the entered characters.

Enter characters and tap “Convert” to display the normal conversion candidates list.

- You can enlarge the candidates list area by tapping “”. If you tap “”, it returns to the original display.

③ Character entry key

④ Undo key/Reverse toggle key

: Cancel the last operation such as returning the determined characters to the undetermined state by tapping the key.

: Display the characters assigned to the same key in the reverse rotation.

⑤ Shift key

Switch uppercase character entry and lowercase character entry by tapping the shift key. The display changes as follows each time you tap it.

 : Lowercase character entry

 : Uppercase character entry

 : Uppercase character entry lock

You can switch the symbols to enter by tapping the key in numeric entry.

⑥ Input mode key

When you switch the input modes, the display changes as follows.

 : Kanji

 : Half Alphabet

 : Half Numeric

 : Half Katakana

 : Full Alphabet

 : Full Numeric

 : Full Katakana

 : Character Code



⑦ Delete key**⑧ OK key/Line feed key**

 : Determine the characters being entered.

 : Insert a line feed at the cursor position.

⑨ Emoji, symbol and facemark key/Kana and alphanumeric key

 : Display the emoji/decoration-emoji/symbol/facemark list.

 : Display katakana, alphabet, number, and predicted date and time assigned to the entered characters as conversion candidates. If you tap “”, it returns to the previous display.

⑩ Settings key

Display the iWnn IME menu.

⑪ Space key/Conversion key

 : Enter a space.

 : Display the normal conversion candidates list.

⑫ Cursor key

Move the cursor to the left/right. You can enter a space by moving the cursor to the right at the end of a text. Also, you can change the range of the characters for character input and conversion.

⑬ Settings key/Space key/Conversion key

 : Display the iWnn IME menu.

 : Enter a space.

 : Display the normal conversion candidates list.

14 Space key/Uppercase and lowercase characters switch key

 : Enter a space.





 : Switch the entered alphabet to the uppercase/lowercase one.

 : Switch the entered character to the uppercase/lowercase one or add dakuten/handakuten to the character.

memo

- While the predictive conversion candidates list/relational prediction candidates list/normal conversion candidates list is not displayed, tap “” to hide the keyboard.

Flick operations

- Flick the emoji, symbol and facemark key/kana and alphanumeric key to the right to display Quote apps list. You can activate an application by tapping it.
- Flick the input mode key to the right to switch the input mode to “Half Numeric”.
- Flick the settings key to use the following functions.
 -  /  : Set QWERTY keyboard/Set 12 keyboard
 -  : Handwriting input
 -  : Voice input

Displaying Setting Menu

From Settings, you can set up and manage functions.

- 1 On the home screen, [APPS]
→ [Settings].

Item	Description
Sound settings	Set the manner mode, adjust the notification sound volume, playback volume, etc.
Wallpaper & display	Make settings for the brightness of the screen, switch text fonts, etc.
Energy saving settings	Activate Energy save.
au ID setting	Set au ID.
microSD & tablet storage	Check the memory space of the microSD memory card and the main unit, initialize the microSD memory card, etc.
Battery	Check the battery usage.
Profile	Check or edit your profile.
Home applications	Switch home applications to use.
Charging theater	Make settings for Charging theater.
Application	Uninstall applications etc.
Wi-Fi	Make settings for Wi-Fi®.

Item	Description
au Wi-Fi connection tool	Activate au Wi-Fi connection tool.
Wireless output	Set wireless connection to TVs with a wireless connection function.
Bluetooth	Make settings for Bluetooth®.
Data usage	Make settings for data traffic.
Network settings	Make settings for network such as Airplane mode and Home network settings.
Accounts & sync	Make settings for managing accounts or synchronizing data.
Location services	Make settings for location services.
Lock & Security	Make settings for the lock or security function of the product.
Language & input	Set the language to be displayed and make settings for character input.
Reset all	Restore the default settings.
External connection	Make settings for USB connection.
Date & time	Make settings for the date and time.
Accessibility	Set user support services.
Developer options	Set tools etc. for developing applications.
Device info	Check the signal level etc.
Initial setting	Make initial settings.

Introduction of Peripheral Devices

■ Desktop Holder (SHT21PUA)

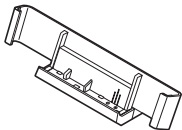

■ Stylus Pen (SHT21KBA)



- Common AC Adapter 01 (0202PQA) (sold separately)*
- Common AC Adapter 02 (0203PQA) (sold separately)*
- Common AC Adapter 03 (0301PQA) (sold separately)
- Common AC Adapter 04 (0401PWA) (sold separately)
- Common AC Adapter 03 Navy (0301PBA) (sold separately)
- Common AC Adapter 03 Green (0301PGA) (sold separately)

Common AC Adapter 03 Pink (0301PPA) (sold separately)

Common AC Adapter 03 Blue (0301PLA) (sold separately)

AC Adapter MIDORI (0205PGA) (sold separately)*

AC Adapter AO (0204PLA) (sold separately)*

AC Adapter SHIRO (0204PWA) (sold separately)*

AC Adapter MOMO (0204PPA) (sold separately)*

AC Adapter CHA (0204PTA) (sold separately)*

AC Adapter REST (LS1P002A) (sold separately)*

AC Adapter RANGERS (LS1P003A) (sold separately)*

AC Adapter CHARGY (LS1P001A) (sold separately)*

AC Adapter WORLD OF ALICE (LS1P004A) (sold separately)*

AC Adapter KiiRoll (L01P005A) (sold separately)*

AC Adapter JUPITRIS (White) (L02P001W) (sold separately)

AC Adapter JUPITRIS (Red) (L02P001R) (sold separately)

AC Adapter JUPITRIS (Blue) (L02P001L) (sold separately)

AC Adapter JUPITRIS (Pink) (L02P001P) (sold separately)

AC Adapter JUPITRIS (Champagne) (L02P001N) (sold separately)

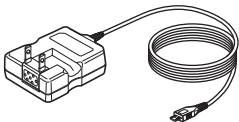

Common AC adapter 04

- Illustrations and forms may not match depending on the AC adapter you use.
- Common AC adapter 01 can only be used in Japan. When you use an AC adapter overseas, choose available one from among the above-mentioned models (except for Common AC adapter 01) to use.

- **Common DC adapter 01 (0201PEA) (sold separately)***
- **Common DC adapter 03 (0301PEA) (sold separately)**

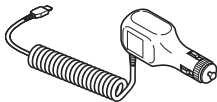

Common DC adapter 03

- **Portable charger 01 (0201PDA) (sold separately)***
- **Portable charger 02 (0301PFA) (sold separately)**

- **microUSB cable 01 (0301HVA) (sold separately)**
- **microUSB cable 01 Navy (0301HBA) (sold separately)**
- **microUSB cable 01 Green (0301HGA) (sold separately)**
- **microUSB cable 01 Pink (0301HPA) (sold separately)**
- **microUSB cable 01 Blue (0301HLA) (sold separately)**
- **SHARP microUSB-3.5 ϕ conversion cable 01 (SHX11QVA) (sold separately)**
- **SHARP microUSB-18-pin (charger) conversion cable 01 (SHI01HVA) (sold separately)**
- **18 pin-microUSB conversion adapter 01 (0301QYA) (sold separately)**



* When using this with the product, you need to connect it to SHARP microUSB-18-pin (charger) conversion cable 01 (sold separately) or 18 pin-microUSB conversion adapter 01 (sold separately).

memo

- For the latest information about available peripheral devices, check the au homepage (<http://www.au.kddi.com/>) or contact Customer Service Center.
- The product does not support ASYNC/Fax transmission.
- The above-mentioned peripheral devices can be purchased from au Online Shop. <http://auonlineshop.kddi.com/>

Troubleshooting

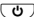
Before you assume that the product is malfunctioning, check the following:

Trouble	Detail
Cannot turn on the power.	<ul style="list-style-type: none"> Is the internal battery charged? (▶ P.50) Did you hold  down? (▶ P.54)
Cannot charge the battery.	<ul style="list-style-type: none"> Is the power plug of the specified charger (sold separately) securely plugged into an outlet or a cigarette lighter socket? (▶ P.50) Are the desktop holder, charger terminal, etc. clean? (▶ P.24)
Cannot operate/The screen does not respond/Cannot turn off the power.	<ul style="list-style-type: none"> Turn the power off forcibly by pressing  and  simultaneously for at least 12 seconds. Turn it on after a while. (▶ P.55)
Cannot operate the keys/touch panel.	<ul style="list-style-type: none"> Turn off the power and then turn it on. Is the power turned on? (▶ P.54)

Trouble	Detail
Battery usage time is short.	<ul style="list-style-type: none"> Make sure you do not often use the product in places where  (out of service area) is displayed. (▶ P.64) Make sure the internal battery does not approach the end of its service life. (▶ P.19) Is the internal battery charged enough? (▶ P.50) Suspend the functions not being used. (▶ P.65)
Cannot operate the touch panel as intended.	<ul style="list-style-type: none"> Make sure you are not operating with hands wearing gloves etc. Make sure you are not operating with the tip of a fingernail or with foreign object between the screen and your fingers. Check the proper operation of touch panel. (▶ P.57) Make sure you are not operating with the stylus pen. If the touch panel does not respond to the stylus pen, operate with your fingers. Restart the product. (▶ P.55)
Screen response is slow when you tap on the screen/press the keys.	<ul style="list-style-type: none"> Screen response may be slowed down when a large amount of data is stored in the product or being transmitted between the main unit and a microSD memory card.

Trouble	Detail
auIC Card(UIM) error. is displayed.	<ul style="list-style-type: none"> Is an au Micro IC Card (LTE) inserted? (▶ P.46)
Cannot recognize a microSD memory card/Cannot find target data.	<ul style="list-style-type: none"> Is a microSD memory card inserted properly? (▶ P.48) Make sure data is not saved on the main unit (memory). Data can be saved on the main unit (memory) besides a microSD memory card.
The power is turned off automatically.	<ul style="list-style-type: none"> Make sure the battery has not run out. (▶ P.50)
The power is turned off while the wake-up logo is displayed.	<ul style="list-style-type: none"> Make sure the battery has not run out. (▶ P.50)
 (out of service area) is displayed.	<ul style="list-style-type: none"> Is reception good enough? (▶ P.64) Is the product within the service area? (▶ P.64) Is your finger etc. off the area around the internal antenna? (▶ P.45)
A message indicating that charging is necessary is displayed.	<ul style="list-style-type: none"> The battery is almost empty. (▶ P.50)

For more details, contact Customer Service Center.

From a fixed-line phone,  **0077-7-111**

From an au cell phone, **157** without area code

Updating Software or OS

Software Update

The product supports the software update.

1 On the home screen, [APPS] → [Settings] → [Device info] → [Software update].

2 Software update	Check whether software update is necessary or not. The confirmation starts when you tap "Yes". When it is necessary, you can download data for software update.
Auto-check settings	Set whether to regularly check the presence of data for software update available.

Notes on Software Update

- You are charged for data communication when connecting to the Internet from the product by using packet communication.
- When software update is necessary, you will be informed on au homepage etc. For details, contact an au shop or Customer Service Center (call toll-free 157). In addition, users of the SHT21 will receive a notice from au, when the software update is necessary to improve the functionality of the SHT21.

- It is recommended to back up your data before updating software.
- If the software update is performed, the product will restart before and after the update.
- If the software update has failed or stopped, perform the same procedures again.
- If the software update fails, it may become impossible to operate the product. If this happens, bring it to an au shop or PiPit (not accepted by some shops).
- Charge the battery sufficiently before starting update. If the battery level is insufficient or the battery runs out during the update, the software update will fail.
- Check out the signal reception status. The software update may fail if the product is in a place with bad signal reception status.
- Various data registered on the product (address books, mails, still pictures, music data, etc.) and information of settings will not be changed even after software is updated. However, note that data may not be protected depending on the state of the product (fault, damage, getting wet with water, etc.).
- After software is updated, the download of next update software may automatically start (consecutive update).

Do not conduct the following operations during the software update

- Do not move during software update.

The following operations are not available during the software update

- Operations are not available during software update. Also, the alarm etc. does not function.

Major Update (OS Update)

Major update is a function to update the OS of the product.

- Attach a microSD memory card in advance.

1 On the home screen, [APPS] → [Settings] → [Device info] → [Major Update].

2 Confirm update	Manually check the presence of data for OS update available.
Start update	Carry out OS update via Wi-Fi®.
Check for updates	Set whether to regularly and automatically check the presence of data for OS update available.

After-Sales Service

When Asking for Repair

For repair, contact Secure cell phone support center.

During the warranty period	Repairs will be done based on the <terms of services of the free-of-charge repair warranty> described on the warranty card.
Outside the warranty period	We shall repair the product for a charge as requested by the customer if repair renders it usable.

memo

- Before handing in the product for repair, make a backup of the contents of memory since they may disappear during repair. Note that the Company shall not be liable for any damages and loss of income should the contents of memory be altered or lost.
- Recycled parts that meet the Company's quality standards are sometimes used for repair.
- au terminals collected by Replacement cell phone delivery service which you used before are recycled to terminals for replacement after repairs. Also parts replaced by au after-sales service are collected and recycled by the Company. They are not returned to customers.

Performance Parts for Repair

The Company retains performance parts for repair of the SHT21 main unit and its peripheral devices for 6 years after discontinuation of production. "Performance parts for repair" refers to parts required for maintaining the functions of the product.

Warranty Card

At the store of purchase, thoroughly check and read the name of the retailer, date of purchase and other necessary details filled in on the warranty card, and be sure to keep it in a safe place.

Secure cell phone support plus LTE

An after-sales service membership program on a monthly basis called "Secure cell phone support plus LTE" (monthly fee: 399 yen including tax) is available for using your au terminal for a long time without worries. This service expands coverage for many troubles including malfunction, theft and loss. For details of this service, check on the au homepage or contact Secure cell phone support center.

memo

- You can apply for the membership only at the time of purchasing your au terminal.
- Once you cancel the membership, you cannot reapply for it until you purchase an au terminal next time.

- Note that when changing the model or purchasing an extra terminal, this service only covers the most recently purchased au terminal.
- When an au terminal is handed over to you or someone else, the Secure cell phone support plus LTE membership is also handed over to the successor of the terminal.
- When you get a new au terminal by changing the model, purchasing an extra terminal, etc., the "Secure cell phone support plus" or "Secure cell phone support plus LTE" membership for the old au terminal is automatically canceled.
- Service contents are subject to change without notice.

■ au Micro IC Card (LTE)

The au Micro IC Card (LTE) is lent to you by au. In case of loss or damage, the card will be replaced at your expense. When malfunction is suspected, or in case of theft or loss, contact an au shop or PiPit.

■ After-Sales Service

If you are unsure about anything regarding after-sales service, contact the following service counter.

Customer Service Center (for service canceling procedure or operation in case of loss or theft)

From a fixed-line phone, **☎ 0077-7-113** (toll free)

From an au cell phone, **113** without area code (toll free)

Secure cell phone support center (for loss, theft or damage)

From a fixed-line phone/an au cell phone,

☎ 0120-925-919 (toll free)

Business hours 9:00 to 21:00 (7 days a week)

■ au After-Sales Service Information

Service contents	Secure cell phone support plus LTE member	Non-Secure cell phone support plus LTE member
Replacement cell phone delivery service (spontaneous failure: 1st year)	Free	N/A
Replacement cell phone delivery service (spontaneous failure: 2nd year and later)	Customer charge 1st: 5,250 yen 2nd: 8,400 yen	N/A
Replacement cell phone delivery service (partial damage, water soak, irreparable damage, theft and loss)	Customer charge 1st: 5,250 yen 2nd: 8,400 yen	N/A
Holding over and repair (spontaneous failure: 1st year)	Free	Free
Holding over and repair (spontaneous failure: 2nd year and later)	Free (three-year warranty)	Actual cost

Service contents	Secure cell phone support plus LTE member	Non-Secure cell phone support plus LTE member
Holding over and repair (partial damage)	Customer charge Upper limit: 5,250 yen	Actual cost
Holding over and repair (water soak and irreparable damage)	Customer charge 10,500 yen	Actual cost
Holding over and repair (theft and loss)	N/A	N/A (model change)

* All the prices written above include tax.

memo

Replacement cell phone delivery service

- When you have trouble with your au terminal, you can have a terminal for replacement (same model and color as your old one) delivered to any destination that you specify by calling us. Please return your old au terminal got out of order within 14 days after the terminal for replacement is delivered to you.
- You can use this service up to twice within one year starting from the day when you first use this service. If you have not used this service over the past one year at the time of your application for this service, the application will be regarded as your first time. If you have, the application will be regarded as your second time.

* For details, check on the au homepage.

Holding over and repair

- Damages and malfunctions intentionally caused by the customer as well as those due to modification (e.g. disassembly, change of parts, painting, etc.) by the customer are not covered by this service.
- You cannot receive a refund for replacement of the outer casing due to stains, scratches, paint removal, etc. on the outer casing.

Main Specifications

Display	Approx. 7 inches, approx. 16.77 million colors, IGZO, 1,280×800 (WXGA)
Weight	Approx. 272 g (including the internal battery)
Size (W×H×D)	Approx. 106 mm×190 mm×9.4 mm
CPU	MSM8960 1.5 GHz Dual-core
Memory (built-in (ROM)) ¹	Approx. 16 GB
Continuous standby time	Approx. 980 hours (while LTE is used) Approx. 1,040 hours (while 3G is used)
Continuous tethering time	Approx. 500 min (LTE on WAN) Approx. 850 min (3G on WAN)
Charging time	Desktop holder: Approx. 320 min Common AC adapter 04 (sold separately): Approx. 330 min Common DC adapter 03 (sold separately): Approx. 590 min

1Seg continuous watching time*2	Approx. 11 hours (earphone) Approx. 10 hours (speaker)
Camera device	Out camera CMOS image sensor In camera CMOS image sensor
Effective pixels	Out camera Approx. 8.08 million pixels In camera Approx. 0.31 million pixels
Picture size/ Magnification and its steps of still picture	Out camera VGA: 640×480/4.0-fold and 13 steps HD: 1,280×720/4.0-fold and 13 steps 2M: 1,600×1,200/4.0-fold and 13 steps FULL HD: 1,920×1,080/4.0-fold and 13 steps 8M: 3,264×2,448/4.0-fold and 13 steps In camera VGA: 640×480/4.0-fold and 13 steps

Picture size/ Magnification and its steps/ Recording time*3 of video	Out camera QVGA: 320×240/4.0-fold and 13 steps/ Max. approx 90 min VGA: 640×480/4.0-fold and 13 steps/ Max. approx 90 min HD: 1,280×720/4.0-fold and 13 steps/ Max. approx 45 min FULL HD: 1,920×1,080/4.0-fold and 13 steps/Max. approx 16 min In camera QVGA: 320×240/4.0-fold and 13 steps/ Max. approx 90 min VGA: 640×480/4.0-fold and 13 steps/ Max. approx 90 min
--	--

Bluetooth® Function	<p>Communication method: Bluetooth® Standard Ver.4.0</p> <p>Output: Bluetooth® Standard Power Class 2</p> <p>Communication distance*4: Within 10 m with no obstacles in the range</p> <p>Compatible Bluetooth® profile*5: A2DP (Advanced Audio Distribution Profile), AVRCP (Audio/Video Remote Control Profile) Ver.1.3, OPP (Object Push Profile), SPP (Serial Port Profile), PBAP (Phone Book Access Profile)*6, HID (Human Interface Device Profile), HDP (Health Device Profile), PAN (Personal Area Networking Profile), PXP (Proximity Profile)*7, 8, FMP (Find Me Profile)*7, 8, ANP (Alert Notification Profile)*7, 8, TIP (Time Profile)*7</p> <p>Frequency bands: 2.4 GHz band (2.402 GHz to 2.480 GHz)</p>
Network environment	Wireless LAN (Wi-Fi®) function: IEEE802.11a/b/g/n (2.4 GHz/5 GHz) Standard
Interface	microUSB jack

*1 Since data and applications share the saving space, available memory capacity on the main unit decreases depending on how much space the applications in use are taking up.

*2 The 1Seg continuous watching time varies depending on the usage.

*3 It varies depending on the recording condition, memory space of other saved data, etc. Also, the recording time decreases depending on the temperature at the location where the product is used and usage.

*4 It changes according to objects obstructing devices and signal reception.

*5 This is the specification provided in Bluetooth® standards for making communication between Bluetooth® compatible devices in accordance with their intended use.

*6 Some contents of address book data may not be properly displayed on the device of the other party. Also, you may not be able to connect to the device of the other party depending on its specifications.

*7 This profile supports Bluetooth® Standard Ver.4.0.

*8 The product will support this after the software update.

For details, refer to the support page in SH DASH.

<http://k-tai.sharp.co.jp/support/a/sht21/>

memo

- The continuous standby time may drop to less than half depending on the battery charging status, usage environment such as temperature, reception condition at the location where the product is used, and the function settings.

CE Declaration of Conformity



In some countries/regions including Europe, there are restrictions on the use of 5GHz WLAN that may limit the use to indoors only. If you intend to use 5GHz WLAN on the device, check the local laws and regulations beforehand.

Hereby, Sharp Telecommunications of Europe Ltd, declares that this SHT21 is in compliance with the essential requirements and other relevant provisions of Directive 1999/5/EC. A copy of the original declaration of conformity can be found at the following Internet address:
<http://www.sharp.co.jp/k-tai/>

■ Mobile Light

Do not point the illuminated light directly at someone's eyes.

Be especially careful not to shoot small children from a very close distance.

Do not use Mobile light near people's faces. Eyesight may be temporarily affected leading to accidents.

■ AC Adapter

Any AC adapter used with this device must be suitably approved with a 5Vdc SELV output which meets limited power source requirements as specified in EN/IEC 60950-1 clause 2.5.

■ Battery - CAUTION

Use specified Charger only.

Non-specified equipment use may cause malfunctions, electric shock or fire due to battery leakage, overheating or bursting.

The battery is embedded inside the product. Avoid removing the embedded battery since this may cause overheating or bursting.

Do not dispose of the product with ordinary refuse. Take the product to an au Shop, or follow the local disposal regulations.

Charge battery in ambient temperatures between 5°C and 35°C; outside this range, battery may leak/overheat and performance may deteriorate.

■ Loudness Warning

Excessive sound pressure from earphones and headphones can cause hearing loss.

■ Headphone Signal Level

The maximum output voltage for the music player function, measured in accordance with EN 50332-2, is 25 mV.

■ European RF Exposure Information

Your mobile device is a radio transmitter and receiver. It is designed not to exceed the limits for exposure to radio waves recommended by international guidelines. These guidelines were developed by the independent scientific organization ICNIRP and include safety margins designed to assure the protection of all persons, regardless of age and health.

The guidelines use a unit of measurement known as the Specific Absorption Rate, or SAR. The SAR limit for mobile devices is 2 W/kg. The SAR for this device is compliant with these SAR exposure requirements.

The World Health Organization has stated that present scientific information does not indicate the need for any special precautions for the use of mobile devices.

FCC Notice

- This device complies with part 15 of the FCC Rules. Operation is subject to the following two conditions: (1) This device may not cause harmful interference, and (2) this device must accept any interference received, including interference that may cause undesired operation.
- Changes or modifications not expressly approved by the manufacturer responsible for compliance could void the user's authority to operate the equipment.

Information to User

This equipment has been tested and found to comply with the limits of a Class B digital device, pursuant to Part 15 of the FCC Rules. These limits are designed to provide reasonable protection against harmful interference in a residential installation. This equipment generates, uses and can radiate radio frequency energy and, if not installed and used in accordance with the instructions, may cause harmful interference to radio communications.

However, there is no guarantee that interference will not occur in a particular installation; if this equipment does cause harmful interference to radio or television reception, which can be determined by turning the equipment off and on, the user is encouraged to try to correct the interference by one or more of the following measures:

1. Reorient/relocate the receiving antenna.

2. Increase the separation between the equipment and receiver.
3. Connect the equipment into an outlet on a circuit different from that to which the receiver is connected.
4. Consult the dealer or an experienced radio/TV technician for help.

FCC RF Exposure Information

Your device is a radio transmitter and receiver. It is designed and manufactured not to exceed the emission limits for exposure to radio frequency (RF) energy set by the Federal Communications Commission of the U.S. Government.

The guidelines are based on standards that were developed by independent scientific organizations through periodic and thorough evaluation of scientific studies. The standards include a substantial safety margin designed to assure the safety of all persons, regardless of age and health.

The exposure standard for wireless devices employs a unit of measurement known as the Specific Absorption Rate, or SAR. The SAR limit set by the FCC is 1.6 W/kg. The SAR for this device is compliant with these SAR exposure requirements.

Export Administration Regulations

The product and its accessories may be subject to the Japan Export Administration Regulations ("Foreign Exchange and Foreign Trade Law" and its related laws). In addition, U.S. Re-export Regulations (Export Administration Regulations) may apply to the product and its accessories. To export and re-export the product and its accessories, take the required measures on your responsibility and at your expenses. For details on the procedures, contact the Ministry of Economy, Trade and Industry or the U.S. Department of Commerce.

Intellectual Property Rights

Trademarks

The company names and product names appearing in this manual are trademarks or registered trademarks of their respective holders.

- The microSD logo, microSDHC logo and microSDXC logo are trademarks of SD-3C and LLC.



- The Bluetooth® word mark and logo are registered trademarks owned by the Bluetooth SIG, Inc., and SHARP CORPORATION is licensed to use these trademarks.



- This product is loaded with Bluetooth® Stack for Embedded Systems Spec 5.0 by Toshiba Corp.
- Wi-Fi® is a registered trademark of Wi-Fi Alliance®.



- Wi-Fi Protected Setup™ and Wi-Fi Protected Setup logo are trademarks of Wi-Fi Alliance®.
The Wi-Fi Protected Setup Mark is a mark of the Wi-Fi Alliance.



- Wi-Fi Direct™ is a trademark of Wi-Fi Alliance®.

- “ **AOSS™** ” is a trademark of BUFFALO INC.



- The official name for Microsoft® Windows® is Microsoft® Windows® Operating System.
- Microsoft®, Windows®, Windows Vista®, Microsoft® Excel®, Microsoft® PowerPoint®, Windows Media® and Exchange® are trademarks or registered trademarks of Microsoft Corporation in the U.S.A. and other countries.
- Microsoft® Word and Microsoft® Office are product names of Microsoft Corporation in the U.S.A.

- Music recognition technology and related data are provided by Gracenote®.

Gracenote is a business standard for music recognition technology and related contents delivery.

For details, refer to the following web page:

www.gracenote.com

CD and music data provided by Gracenote: Copyright © 2000 - present Gracenote.

Gracenote Software: Copyright 2000 - present Gracenote.

This product and services may include one or several of the following US Patent. #5,987,525, #6,061,680, #6,154,773, #6,161,132, #6,230,192, #6,230,207, #6,240,459, #6,330,593, and other granted or applied patents.

Part of services are provided by Open Globe, Inc. for US patent (#6,304,523) under license.

Gracenote and CDDB are registered trademarks of Gracenote, Inc.

Logo and logo type of Gracenote and “Powered by Gracenote” logo are either registered trademarks or trademarks of Gracenote, Inc.

For information on the use of Gracenote services, refer to the following web page: www.gracenote.com/corporate



- QR code is a registered trademark of DENSO WAVE INCORPORATED.
- Osaifu-Keitai is a registered trademark of NTT DOCOMO, INC.

- Twitter and Twitter logo are trademarks or registered trademarks of Twitter, Inc.
- Facebook® is a registered trademark of Facebook, Inc.
- Google, Google logo, Android, Android logo, Google Play™, Google Play logo, Google+, Google+ logo, Gmail™, Gmail logo, Calendar logo, Google Maps™, Google Maps logo, Google Talk™, Google Talk logo, Google Chrome™, Google Chrome logo, Google Voice Search™ logo, Picasa™, Picasa logo, YouTube and YouTube logo are trademarks or registered trademarks of Google Inc.
- “Jibe” is a trademark of Jibe Mobile K.K.
- GREE and the GREE logo are registered trademarks of GREE, Inc. in Japan. All other trademarks are the property of their respective owners.
- LINE is a trademark of NHN Japan Co. Ltd.
- Rovi, G-GUIDE, G-GUIDE MOBILE and G-Guide related logos are trademarks or registered trademarks of Rovi Corporation and/or its subsidiaries in Japan.
- Manufactured under license from Dolby Laboratories. Dolby and the double-D symbol are registered trademarks of Dolby Laboratories.



- TRENDMICRO, VirusBuster are trademarks of Trend Micro Inc.

- Copyright © 2010 - Three Laws of Mobility. All Rights Reserved.



- The “RSA Secure” AND “Genuine RSA” logos are trademarks of RSA Data Security, Inc.



- DLNA®, the DLNA Logo and DLNA CERTIFIED™ are trademarks, service marks, or certification marks of the Digital Living Network Alliance. Sharp Corporation has acquired DLNA certification for the device.
- Oracle and Java are registered trademarks of Oracle and/or its affiliates. Other names may be trademarks of their respective owners.



- “Chaku-uta”, “Chaku-uta full” and “Chaku-uta full plus” are registered trademarks of the Sony Music Entertainment (Japan) Inc.
- “VeilView”, “Best select photo”, “Egao focus shutter”, “Furimuki shutter”, “AQUOS”, “AQUOS PAD”, “ファミリンク”, “FAMILINK”, the “エコ技” symbol and “エコ技”, “アウトドアビュー”, “おまかせアルバム”, “OneTouch Shutter”, “GALAPAGOS”, “SH SHOW”, “IGZO”, “LCフォント”, “LCFONT” and the LC logo symbol are registered trademarks or trademarks of Sharp Corporation.



- Included Document Viewer is Documents To Go provided by DataViz, Inc.
© 2011 DataViz, Inc. and its licensors. All rights reserved.
DataViz, Documents To Go and InTact Technology are trademarks or registered trademarks of DataViz, Inc.
- PhotoScouter® is a registered trademark of Morpho, Inc.
- MyScript® Stylus Mobile is a trademark of VISION OBJECTS.

- Content owners use Microsoft PlayReady™ content access technology to protect their intellectual property, including copyrighted content. This device uses PlayReady technology to access PlayReady-protected content and/or WMDRM-protected content. If the device fails to properly enforce restrictions on content usage, content owners may require Microsoft to revoke the device’s ability to consume PlayReady-protected content. Revocation should not affect unprotected content or content protected by other content access technologies. Content owners may require you to upgrade PlayReady to access their content. If you decline an upgrade, you will not be able to access content that requires the upgrade.
- iWnn of OMRON SOFTWARE Co., Ltd. is used for conversion methods for Japanese language, and for phrase prediction methods for English.
iWnn © OMRON SOFTWARE Co., Ltd. 2008-2012 All Rights Reserved.
iWnn IME © OMRON SOFTWARE Co., Ltd. 2009-2012 All Rights Reserved.
- Powered by emblend Copyright 2009-2010 Aplix Corporation. All rights reserved.
emblend is a name of Japanese product provided by Aplix Corporation.
- The font type pre-installed in this product, Shin Go M, is licensed by Morisawa Inc. solely for the use with this product. “Morisawa” and “Shin Go” are registered trademarks or trademarks of Morisawa Inc.

- Portions Copyright ©2004 Intel Corporation
- The MHL logo, MHL and Mobile High-Definition Link are trademarks or registered trade marks of MHL, LLC.



- aptX is a registered trademark of CSR plc.
- The product includes pictograms that SHARP CORPORATION is licensed by NTT DOCOMO, INC.

■ Open Source Software

- The product includes software based on GNU General Public License (GPL), GNU Lesser General Public License (LGPL) and other licenses.

For details on licenses of related software, on the home screen, tap [APPS] → [Settings] → [Device info] → [Legal information] → [Open source licenses].

- Source codes of software based on GPL, LGPL and Mozilla Public License (MPL) can be referred to on the following site for free. For details, refer to the following site.
<https://sh-dev.sharp.co.jp/android/modules/oss/>

■ OpenSSL License

【OpenSSL License】

Copyright © 1998-2009 The OpenSSL Project. All rights reserved.

This product includes software developed by the OpenSSL Project for use in the OpenSSL Toolkit. (<http://www.openssl.org/>)

THIS SOFTWARE IS PROVIDED BY THE OpenSSL PROJECT "AS IS" AND ANY EXPRESSED OR IMPLIED WARRANTIES, INCLUDING, BUT NOT LIMITED TO, THE IMPLIED WARRANTIES OF MERCHANTABILITY AND FITNESS FOR A PARTICULAR PURPOSE ARE DISCLAIMED. IN NO EVENT SHALL THE OpenSSL PROJECT OR ITS CONTRIBUTORS BE LIABLE FOR ANY DIRECT, INDIRECT, INCIDENTAL, SPECIAL, EXEMPLARY, OR CONSEQUENTIAL DAMAGES (INCLUDING, BUT NOT LIMITED TO, PROCUREMENT OF SUBSTITUTE GOODS OR SERVICES; LOSS OF USE, DATA, OR PROFITS; OR BUSINESS INTERRUPTION) HOWEVER CAUSED AND ON ANY THEORY OF LIABILITY, WHETHER IN CONTRACT, STRICT LIABILITY, OR TORT (INCLUDING NEGLIGENCE OR OTHERWISE) ARISING IN ANY WAY OUT OF THE USE OF THIS SOFTWARE, EVEN IF ADVISED OF THE POSSIBILITY OF SUCH DAMAGE.

【Original SSLeay License】

Copyright © 1995-1998 Eric Young (eay@cryptsoft.com) All rights reserved.

This product includes cryptographic software written by Eric Young (eay@cryptsoft.com)

THIS SOFTWARE IS PROVIDED BY ERIC YOUNG "AS IS" AND ANY EXPRESS OR IMPLIED WARRANTIES, INCLUDING, BUT NOT LIMITED TO, THE IMPLIED WARRANTIES OF MERCHANTABILITY AND FITNESS FOR A PARTICULAR PURPOSE ARE DISCLAIMED. IN NO EVENT SHALL THE AUTHOR OR CONTRIBUTORS BE LIABLE FOR ANY DIRECT, INDIRECT, INCIDENTAL, SPECIAL, EXEMPLARY, OR CONSEQUENTIAL DAMAGES (INCLUDING, BUT NOT LIMITED TO, PROCUREMENT OF SUBSTITUTE GOODS OR SERVICES; LOSS OF USE, DATA, OR PROFITS; OR BUSINESS INTERRUPTION) HOWEVER CAUSED AND ON ANY THEORY OF LIABILITY, WHETHER IN CONTRACT, STRICT LIABILITY, OR TORT (INCLUDING NEGLIGENCE OR OTHERWISE) ARISING IN ANY WAY OUT OF THE USE OF THIS SOFTWARE, EVEN IF ADVISED OF THE POSSIBILITY OF SUCH DAMAGE.

■ Windows Notations

The names of operating systems (Japanese versions) used in this manual are as follows.

- Windows 8 is the abbreviation for Microsoft® Windows® 8, Microsoft® Windows® 8 Pro and Microsoft® Windows® 8 Enterprise.
- Windows 7 is the abbreviation for Microsoft® Windows® 7 (Starter, Home Basic, Home Premium, Professional, Enterprise, Ultimate).
- Windows Vista is the abbreviation for Microsoft® Windows Vista® (Home Basic, Home Premium, Business, Enterprise, Ultimate).
- Windows XP is the abbreviation for Microsoft® Windows® XP Professional operating system and Microsoft® Windows® XP Home Edition operating system.

■ Gracenote® End User License Agreement

This application or device contains software from Gracenote, Inc. of Emeryville, California ("Gracenote"). The software from Gracenote (the "Gracenote Software") enables this application to perform disc and/or file identification and obtain music-related information, including name, artist, track, and title information ("Gracenote Data") from online servers or embedded databases (collectively, "Gracenote Servers") and to perform other functions. You may use Gracenote Data only by means of the intended End-User functions of this application or device.

You agree that you will use Gracenote Data, the Gracenote Software, and Gracenote Servers for your own personal non-commercial use only. You agree not to assign, copy, transfer or transmit the Gracenote Software or any Gracenote Data to any third party. **YOU AGREE NOT TO USE OR EXPLOIT GRACENOTE DATA, THE GRACENOTE SOFTWARE, OR GRACENOTE SERVERS, EXCEPT AS EXPRESSLY PERMITTED HEREIN.**

You agree that your non-exclusive license to use the Gracenote Data, the Gracenote Software, and Gracenote Servers will terminate if you violate these restrictions. If your license terminates, you agree to cease any and all use of the Gracenote Data, the Gracenote Software, and Gracenote Servers.

Gracenote reserves all rights in Gracenote Data, the Gracenote Software, and the Gracenote Servers, including all ownership rights. Under no circumstances will Gracenote become liable for any payment to you for any information that you provide. You agree that Gracenote, Inc. may enforce its rights under this Agreement against you directly in its own name.

The Gracenote service uses a unique identifier to track queries for statistical purposes. The purpose of a randomly assigned numeric identifier is to allow the Gracenote service to count queries without knowing anything about who you are. For more information, see the web page for the Gracenote Privacy Policy for the Gracenote service.

The Gracenote Software and each item of Gracenote Data are licensed to you "AS IS." Gracenote makes no representations or warranties, express or implied, regarding the accuracy of any Gracenote Data from in the Gracenote Servers. Gracenote reserves the right to delete data from the Gracenote Servers or to change data categories for any cause that Gracenote deems sufficient. No warranty is made that the Gracenote Software or Gracenote Servers are error-free or that functioning of Gracenote Software or Gracenote Servers will be uninterrupted. Gracenote is not obligated to provide you with new enhanced or additional data types or categories that Gracenote may provide in the future and is free to discontinue its services at any time.

- **GRACENOTE DISCLAIMS ALL WARRANTIES EXPRESS OR IMPLIED, INCLUDING, BUT NOT LIMITED TO, IMPLIED WARRANTIES OF MERCHANTABILITY, FITNESS FOR A PARTICULAR PURPOSE, TITLE, AND NON-INFRINGEMENT. GRACENOTE DOES NOT WARRANT THE RESULTS THAT WILL BE OBTAINED BY YOUR USE OF THE GRACENOTE SOFTWARE OR ANY GRACENOTE SERVER. IN NO CASE WILL GRACENOTE BE LIABLE FOR ANY CONSEQUENTIAL OR INCIDENTAL DAMAGES OR FOR ANY LOST PROFITS OR LOST REVENUES.**

© Gracenote, Inc. 2000-present

■ IPA Font

The product includes IPA Font (IPAex Mincho).

Your agreement to “IPA Font License Agreement v1.0” is required for using IPA Font.

You can confirm “IPA Font License Agreement v1.0” by performing the following operations on the product.

On the home screen, tap [APPS] → [Settings] → [Device info] → [Legal information] → [IPA Font License Agreement v1.0].

■ More

The software installed on this product or part of it may not be altered, translated/adapted, reverse-engineered, decompiled or reverse-assembled and any such actions are prohibited.

Under the MPEG-4 Visual Patent Portfolio License, customers have licensed permission for the following use of this product to engage in non-profit personal use. Other uses are not permitted.

- Recording MPEG-4 Visual standard video (henceforth referred to as MPEG-4 Video)
- Playing back MPEG-4 Video that a customer engaged in personal and non-profit activities has recorded
- Playing back MPEG-4 Video obtained from a provider licensed by MPEG-LA

When using for promotion, in-house use, profit use, and other intended uses, contact MPEG LA. LLC.

- This product is licensed under the AVC patent portfolio license for the personal and noncommercial use of a consumer to (i) encode video in compliance with the AVC standard (henceforth referred to as AVC video) and/or (ii) decode AVC video that was encoded by a consumer engaged in a personal and noncommercial activity and/or was obtained from a video provider licensed to provide AVC video. No license is granted or shall be implied for any other use. Additional information may be obtained from MPEG LA, L.L.C.

Visit <http://www.mpegla.com>

- This product is licensed under the VC-1 Patent Portfolio License for the personal and noncommercial use of a consumer to (i) encode video in compliance with the VC-1 standard (henceforth referred to as VC-1 video) and/or (ii) decode VC-1 video that was encoded by a consumer engaged in a personal and noncommercial activity and/or was obtained from a video provider licensed to provide VC-1 video. No license is granted or shall be implied for any other use. Additional information may be obtained from MPEG LA, L.L.C.

Visit <http://www.mpegla.com>

This product is licensed under the MPEG-4 Visual Patent Portfolio License for the personal and non-commercial use of a consumer to (i) encode video in compliance with the MPEG-4 Video Standard ("MPEG-4 Video") and/or (ii) decode MPEG-4 Video that was encoded by a consumer engaged in a personal and non-commercial activity and/or was obtained from a licensed video provider. No license is granted or implied for any other use. Additional information may be obtained from MPEG LA. See <http://www.mpegla.com>.

This product is licensed under the MPEG-4 Systems Patent Portfolio License for encoding in compliance with the MPEG-4 Systems Standard, except that an additional license and payment of royalties are necessary for encoding in connection with (i) data stored or replicated in physical media which is paid for on a title by title basis and/or (ii) data which is paid for on a title by title basis and is transmitted to an end user for permanent storage and/or use. Such additional license may be obtained from MPEG LA, LLC. See <http://www.mpegla.com> for additional details.

For inquiries, call: Customer Service Center

For general information and charges (toll free)

From fixed-line phones: | From au cell phones:
 0077-7-111 | 157 area code not required

PRESSING ZERO WILL CONNECT YOU TO AN OPERATOR
AFTER CALLING 157 ON YOUR au CELL PHONE.

For service canceling procedure or operation
in case of loss or theft (toll free)

From fixed-line phones: | From au cell phones:
 0077-7-113 | 113 area code not required

In case above numbers are not available,
call toll-free:

 0120-977-033 (except Okinawa)
 0120-977-699 (Okinawa)

Secure cell phone support center

For loss, theft or damage (toll free)

From fixed-line phones/au cell phones:

 0120-925-919

Business hours: 9:00 to 21:00 (7 days a week)



モバイル・リサイクル・ネットワーク
携帯電話 PHS 携帯 PHS ネットワーク

Cell phone and PHS operators collect and recycle
unused telephones, batteries and battery
chargers at stores bearing the  logo regardless
of brand and manufacturer to protect the
environment and reuse valuable resources.

November 2012, 1st Edition

Sold by: KDDI CORPORATION,
OKINAWA CELLULAR TELEPHONE COMPANY
Manufactured by: SHARP CORPORATION