

Qua tab PZ

Basic Manual

Preface

Thank you for purchasing the "Qua tab PZ" (simply called the "product" from here on). Before using the product, be sure to read the supplied "Setting Guide", "Notes on Usage", "Basic Manual" (this manual) or "User Guide 取扱説明書 詳細版 (Full Instruction Manual)" (Japanese) available on the au homepage to ensure correct use. After you have finished reading this manual, be sure to store them in safe places so that you can retrieve them whenever needed.

List of Packaged Items

Before your start using the product, make sure that you have all the following packaged with the product.

- Main unit
- LG TV antenna cable O1
- 設定ガイド (Setting Guide) (Japanese)
- 取扱説明書 (Basic Manual) (Japanese)
- ご利用にあたっての注意事項 (Notes on Usage) (Japanese)
- microUSB cable
- AC adapter
- microSD memory card
- Earphone

The following items are not included in the package.

- Purchase a specified charger (sold separately).
- The battery is built into the product.
- The illustrations in the manual are used only for explaining. They may differ from the actual product.

memo

● Illustrations and screens shown in this manual may look different from the actual product or screen. Note that in some cases, a part of a screen may be omitted.

- In this manual, screenshots for body color "White" are provided as examples.
- In this manual, except as specified, the descriptions of operation procedures are those with keys/buttons.
- Descriptions in this manual are based on the operations of horizontal screen. Menu items/icons/buttons on a screen may be different from the ones in the vertical display.
- In this manual, operation procedures are described based on au Basic Home. When the home application is changed by "Select Home" etc., operation procedures may be different.
- Items, title levels, and icons in this manual may look different based on different functions you use or different conditions, etc.
- In this manual, "microSD™" memory card (commercial item), "microSDHC™" memory card (commercial item) or "microSDXC™" memory card (commercial item) is called "microSD memory card" or "microSD" for short.
- All of the indicated amounts exclude tax unless otherwise specified.
- All company names and product names in this manual are either trademarks or registered trademarks. The TM, ® marks may be omitted in this manual.

About Basic Manual

設定ガイド (Setting Guide) (Japanese)/ 取扱説明書 (Basic Manual) (Japanese)

Handles only basic operations for main features.

Basic Manual application

You can use the "Basic Manual application" on the product to confirm basic operational procedures for main features.

- Operation procedures
- 1 On the Home screen ► [au Supports] ► [Basic Manual]
- When you activate for the first time, follow the onscreen instructions to download and install the application.

User Guide 取扱説明書 詳細版 (Full Instruction Manual) (Japanese)

For detailed descriptions on various functions, refer to the "User Guide 取扱説明書 詳細版 (Full Instruction Manual)" (Japanese) available on the au homepage. <http://www.au.kddi.com/support/mobile/guide/manual/>

Downloading Manuals

You can download the English version of the Basic Manual from the au website.

You can find "Basic Manual" (English excerpts from Instruction Manual) on au homepage. Download URL: <http://www.au.kddi.com/support/mobile/guide/manual/> * You can use the English version of the manual from the Basic Manual application.

Regarding Notations Used in This Manual

■ Key/button indications
In this manual, keys/buttons are represented by simplified illustrations as shown below.

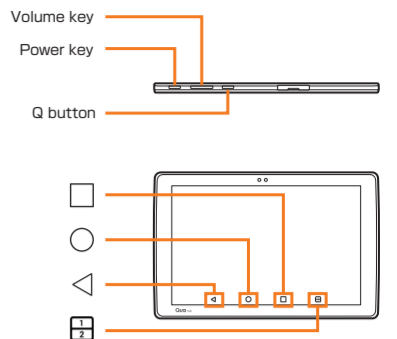

■ Description of operations for selecting item/icon/button etc.
The notations used for operation procedures in this manual are as follows.
Tap means to lightly touch and release the button or icon shown on the display to select it.

- 1 External connection terminal
 - 2 Earphone jack
 - 3 Microphone
 - 4 Power key
 - 5 Volume key (UP/DOWN)
 - 6 Q button
Activates a set application.
 - 7 Tray
Stores the au Nano IC Card O4 LE/microSD memory card.
 - 8 Light sensor
Adjust the display brightness according to the ambient brightness.
 - 9 Inward-facing camera (lens)
 - 10 Display (Touch panel)
 - 11 Built-in antenna (Wi-Fi®, Bluetooth®)
 - 12 Built-in antenna (Internet)
 - 13 Speaker
 - 14 Built-in antenna (GPS)
 - 15 Outward-facing camera (lens)
 - 16 Vent hole
Combines inner and external pressures.
- * Do not cover the built-in antenna with your hand or put stickers etc. Data communication quality becomes worse.

For inquiries, call:

Customer Service Center
For general, charge, operations (toll free)
Business hours 9:00 ~ 20:00 (7 days a week)
From fixed-line phones: ☎ 0077-7-111 | 157 area code not required
From au cell phones: ☎ 0077-7-113 | 113 area code not required
PRESSING ZERO WILL CONNECT YOU TO AN OPERATOR AFTER CALLING 157 ON YOUR au CELL PHONE

For service canceling procedure in case of loss or theft (toll free)
Business hours 24-hour (7 days a week)
From fixed-line phones: ☎ 0120-977-033 (except Okinawa)
From au cell phones: ☎ 0120-977-699 (Okinawa)

In case above numbers are not available,
☎ 0120-977-033 (except Okinawa)
☎ 0120-977-699 (Okinawa)

Keitai Guarantee Service Center
For loss, theft or damage (toll free)
Business hours 9:00 ~ 20:00 (7 days a week)
From fixed-line phones/au cell phones, ☎ 0120-925-919

やめましょう、歩きスマホ。
キケン! 水ぬれ充電
It is very dangerous to charge the product in a wet state, this could cause abnormal heat generation or a burnout.

Cell phone and PHS operators collect and recycle unused telephones, batteries and battery chargers at stores bearing the ♻️ logo regardless of brand and manufacturer to protect the environment and reuse valuable resources.

Sold by: KDDI CORPORATION, OKINAWA CELLULAR TELEPHONE COMPANY
Imported by: LG Electronics Japan Inc.
Manufactured by: LG Electronics Inc.

Description	Explanation
On the Home screen ► [Chrome] ► [:]	Tap [Chrome] (Chrome) on the bottom of Home screen. And tap [:] .
On the Home screen ► []	Tap [] on the bottom of Home screen.

■ Illustrations and screen displays
This manual uses screenshots and describes operations with the au Nano IC Card O4 LE inserted.

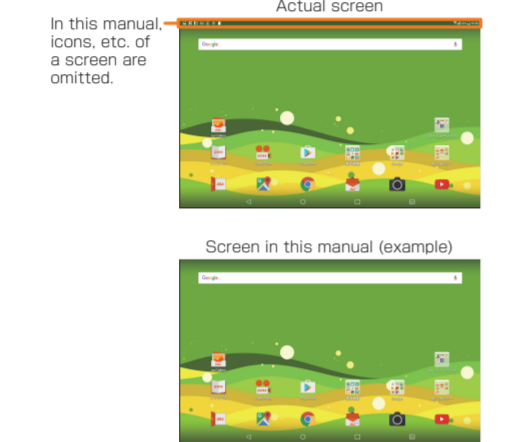

Names and Functions of Parts

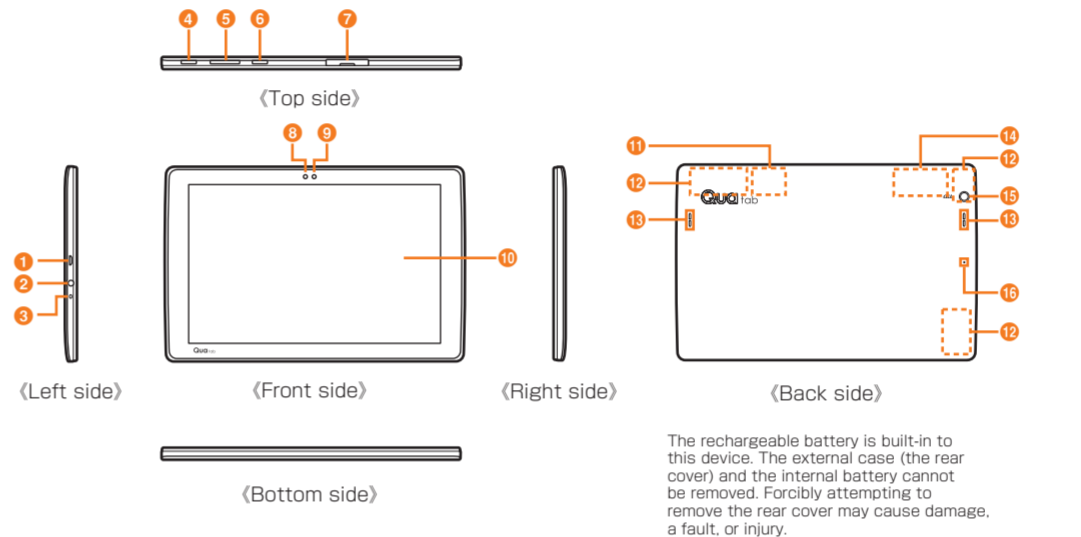

The rechargeable battery is built-in to this device. The external case (the rear cover) and the internal battery cannot be removed. Forcibly attempting to remove the rear cover may cause damage, a fault, or injury.

au Nano IC Card O4 LE

The au Nano IC Card O4 LE contains a phone number and other information.

- The product is compatible with au Nano IC Card O4 LE.

(au Nano IC Card O4 LE)
Back Front
IC (metal) part

- Note the following points, which may cause malfunction or damage, when handling the au Nano IC Card O4 LE.
 - Do not touch the IC (metal) part of the au Nano IC Card O4 LE.
 - Insert in the correct direction.
 - Do not use force to attach or remove the IC card.
- When the au Nano IC Card O4 LE is not attached properly or the au Nano IC Card O4 LE is abnormal, an error message appears.
- Do not lose the au Nano IC Card O4 LE after it has been removed.
- Do not insert the au Nano IC Card O4 LE with a conversion adapter. Doing so may cause a fault.

■ When au Nano IC Card O4 LE is not inserted
When the au Nano IC Card O4 LE is not inserted, the following operations are not available. The will be [] displayed.

- Receiving/sending SMS
- Receiving/sending and initial settings of e-mail (@ezweb.ne.jp)
- Setting up SIM card lock
- Checking the phone number and mail address of this product.

Besides the above, some functions requiring your phone number might not be available.

■ Restriction settings with PIN
You can set the product to restrict the use of the product by others through changing the PIN code or locking the SIM card in order to protect your important private information while you are using your au Nano IC Card O4 LE.

Attaching/Removing au Nano IC Card O4 LE

Attaching au Nano IC Card O4 LE

Before attaching the au Nano IC Card O4 LE, make sure to turn the product off.

- 1 Hook the groove of the tray with your fingernail and pull it out straight to remove the tray from the main unit.
- 2 Put the au Nano IC Card O4 LE into the tray with the IC (metal) part downwards, insert the tray into the main unit, and then push it firmly all the way straight into the slot.
 - Note the direction of the notch.
 - Insert the au Nano IC Card O4 LE so that it is tightly attached to the tray.
 - Make sure that there is no gap between the tray and the main unit.

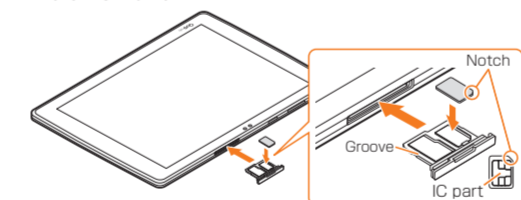

Removing au Nano IC Card O4 LE

Before removing the au Nano IC Card O4 LE, make sure to turn the product off.

- 1 Hook the groove of the tray with your fingernail and pull it out straight to remove the tray from the main unit.
- 2 Remove the au Nano IC Card O4 LE, insert the tray into the main unit, and then push it firmly all the way straight into the slot.
 - Make sure that there is no gap between the tray and the main unit.

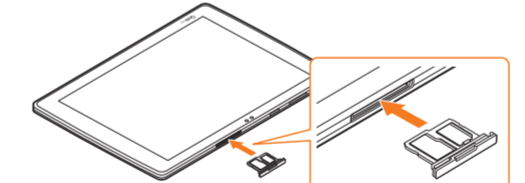

Charging

When you purchase your tablet, the internal battery is not fully charged. Charge the internal battery when you use it for the first time or when its battery is not enough.

- While charging, the product and its internal battery might become hot (when activating camera or communicating data while charging, the internal battery becomes hot).
- It may take longer to charge the built-in battery when you use a computer to charge the battery or use the camera function or the like while charging the battery.
- Operating with the specified charging equipment (sold separately) being connected might cause short-time charge/discharge repeatedly. Life of the internal battery becomes shorter when you repeatedly charge it frequently.

Charging with the Specified AC Adapter (Sold Separately)

Describe how to charge by using the common AC adapter O5 (sold separately).

- 1 Insert the microUSB connector of the common AC adapter O5 (sold separately) straight into the external connection terminal of the product
 - Insert the microUSB connector straight with the "▲" mark facing up.

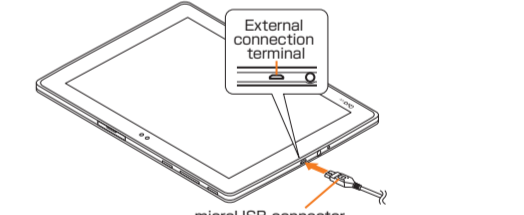

- 2 Insert the power plug of the common AC adapter O5 (sold separately) into a 100 V AC power outlet
The Info Clock screen appears.

- 3 When charging is completed, remove the microUSB connector of the common AC adapter O5 (sold separately) straight from the external connection terminal of the product
- 4 Remove the power plug of the common AC adapter O5 (sold separately) from power outlet

memo
To check the charging status

- To close the Info Clock screen, tap [] on the Info Clock screen. On the status bar of the screen top, [] is displayed to show the charging is starting. When the charging is finished, [] is displayed. When [] is not displayed
- Wait until [] is displayed on the status bar of the top screen. Bad connection is assumed if it does not appear after a while. Check if common AC adapter O5 (sold separately) is securely connected. If it still does not appear, stop charging and contact an au shop or a Keitai Guarantee Service Center.

About Info Clock Screen

The display of the product will be turned on when changing, and the Info Clock screen appears. You can check the clock, calendar, weather and news on the Info Clock screen.



memo

- The Info Clock screen is composed of more than one screen, you can view the screens such as the calendar screen and the news screen when you slide/flick the screen to left or right.
- To change the setting of the Info Clock screen, on the Home screen ► [基本機能 (Basic functions)] ► [Settings] ► [Display] ► [Info Clock].

Turning the Power On/Off

Turning the Power On

- 1 Power key (Press and hold for more than 2 seconds)
The lock screen appears.
Swipe the screen to unlock.

Turning the Power Off

- 1 Power key (Press and hold for more than 2 seconds)
- 2 [Power off] ► [POWER OFF]

Forcibly Turning the Power Off and Restarting the Device

- 1 Hold down the power key and volume key (DOWN) at the same time for more than nine seconds
If you forcibly turn the power off and restart the device, any unsaved data will be lost. Do not perform this operation unless this device stops operating.

Sleep Mode

Pressing the Power key or not touching the screen for a certain period of time will enable Sleep mode. If you press the Power key during Sleep mode, Sleep mode will be canceled and the Lock screen (Info Clock screen when charging) will appear.

Lock Screen

This screen is displayed when turning the power on or sleep mode is canceled. On the Lock screen, you can check the date and time, and notification information as well as use application shortcuts.

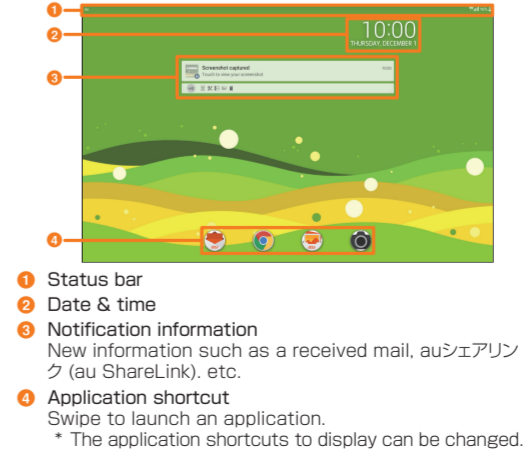

- 1 Status bar
- 2 Date & time
- 3 Notification information
New information such as a received mail, auシェアリンク (au ShareLink), etc.
- 4 Application shortcut
Swipe to launch an application.
* The application shortcuts to display can be changed.

Unlocking the Lock screen

- 1 Swipe on the lock screen
The Home screen appears.
 - The unlock method differs depending on the screen lock settings.

Setting Application Authority

When activating the applications/functions that access the functions or information of the product for the first time, the confirmation screen appears to request the permission for the access authority. When the confirmation screen appears, confirm the content and tap "DENY" or "ALLOW". Example: To activate Photo

- 1 [On the Home screen ► [Google] ► [Photos] ► [ALLOW]]
The application activates.

SIM Unlock

The product supports SIM unlock. By unlocking SIM lock, you can use non-au-SIM cards.

- SIM unlock service is provided at the au homepage and au shops.

- When using non-au SIM card, some services, functions, etc. may be unavailable. The Company is not liable for any operations.

- To operate SIM unlock, on the Home screen ► [基本機能 (Basic functions)] ► [Settings] ► [About tablet] ► [SIM card]

- For details, refer to au homepage. https://cs.kddi.com/support/simcard/

Related Accessories

■ LG TV antenna cable 01 (01LGHSA)

■ AC Adapter (sold separately)

- Common AC adapter 03 (0301PQA)
- Common AC adapter 03 Navy (0301PBA)
- Common AC adapter 03 Green (0301PGA)
- Common AC adapter 03 Pink (0301PPA)
- Common AC adapter 03 Blue (0301PLA)
- Common AC adapter 05 (0501PWA)
- AC Adapter JUPITRIS (White) (L02P001W)
- AC Adapter JUPITRIS (Red) (L02P001R)
- AC Adapter JUPITRIS (Blue) (L02P001L)
- AC Adapter JUPITRIS (Pink) (L02P001P)

- AC Adapter JUPITRIS (Champagne Gold) (L02P001N)

■ Common DC adapter 03 (0301PEA) (sold separately)

■ microUSB Cable (sold separately)

- microUSB cable 01 (0301HVA)
- microUSB cable 01 Navy (0301HBA)
- microUSB cable 01 Green (0301HGA)
- microUSB cable 01 Pink (0301HPA)
- microUSB cable 01 Blue (0301HLA)

■ Portable Charger 02 (0301PFA) (sold separately)

 memo
<ul style="list-style-type: none">Portable charger 02 (sold separately) might not fully charge the product. You can purchase accessories on this page from au online shop. http://auonlineshop.kddi.com

TV Antenna

To watch TV, make sure that you connect LG TV antenna cable 01 bundled with this device.

To listen to TV audio through the device's speaker, connect only LG TV antenna cable 01 to the device.

To listen to TV audio using commercial earphones, connect the earphones to LG TV antenna cable 01.

When connecting earphones, insert the plug in a straight line into the LG TV antenna cable 01 earphone jack.

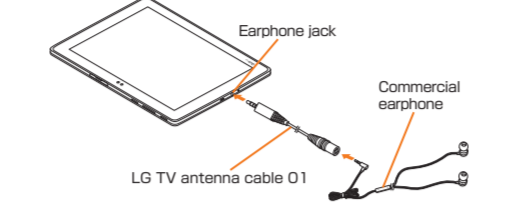

Main Specifications

Display	Approx. 10.1 inches, Approx. 16.77 million colors, IPS liquid crystal	
Weight	Approx. 486 g (including internal battery)	
Size (W x H x D)	Approx. 258 × 164 × 7.9 mm	
CPU	MSM8952 (1.5 GHz × 4, 1.2 GHz × 4)	
Internal memory (Storage/RAM)	Storage: 16 GB, RAM: 2 GB	
Continuous stand-by time*	Approx. 930 hours	
Continuous tethering time	Approx. 1 070 minutes	
Number of concurrent connections with tethering	13 devices (Wi-Fi® tethering: 8, Bluetooth® tethering: 4 and USB tethering: 1)	
Charging time	AC adapter	Approx. 230 minutes (When using Common AC adapter 05 (sold separately))
	DC adapter	Approx. 960 minutes (When using Common DC adapter 03 (sold separately))

* Continuous standby times are measurements in a static state.

■ Wireless LAN (Wi-Fi®)

Compatible Networks	IEEE802.11a/b/g/n/ac-compliant
Frequency bands	2.4 GHz/5 GHz

■ Bluetooth®

Compatible Networks	Bluetooth® standard Ver.4.2 BLE
Output	Bluetooth® standard Power Class1
Communication range*1	Within 10 m with no obstacles in the range
Supported Bluetooth profile*2	GATT (Generic Attribute Profile), Android Bluetooth Low Energy Improvements, A2DP (Advanced Audio Distribution Profile), AVRCP (Audio/Video Remote Control Profile), HDP (Health Device Profile), HID (Human Interface Device Profile), HSP (Headset Profile), OPP (Object Push Profile), PAN (Personal Area Networking Profile), PAN NAP, PAN U, SPP (Serial Port Profile), apt-X, Bluetooth SSP, DI (Device ID), GAVDP (Generic Audio/Video Distribution), HOGP (HID over GATT Profile) ³ , ScPP (Scan Parameters Profile)
Frequency bands	2.4 GHz band

*1 Changes according to objects obstructing devices and signal reception.

*2 Specifications provided in Bluetooth® standards for making communication between Bluetooth®-compatible devices in accordance with their intended use.

*3 A profile compatible with Bluetooth® standard Ver.4.0.

 memo
<ul style="list-style-type: none">The continuous standby time may drop to less than half depending on the battery charging status, usage environment such as temperature, reception condition at the location where the product is used, and the function settings.

■ Outward-facing camera

Image pickup device	CMOS
Number of effective pixels	Approx. 5 million pixels

■ Inward-facing camera

Image pickup device	CMOS
Number of effective pixels	Approx. 5 million pixels

■ TV

Continuous watching time	Full Seg	Approx. 6 hours 20 minutes
	1Seg	Approx. 6 hours 40 minutes

* Continuous viewing time may change depending on the usage condition.