

Notes on Usage

When Using the Product

Before using the product, be sure to read the "Notes on Usage" (this manual) available on the au homepage to ensure correct use. Before you assume that the product is malfunctioning, check for possible remedies in the following au Customer Support site of au homepage: <http://www.au.kddi.com/support/mobile/trouble/repair>

- Communication is not possible even inside the service area in places where the signal does not reach (e.g. tunnels and basements). Also, communication is sometimes not possible in poor reception areas. Communication is sometimes interrupted if you move into a poor reception areas during communications.
- Since this product uses radio waves, the possibility of communication intercepts by third parties cannot be eliminated. (Though LTE/WiMAX 2+/GSM/UMTS system has highly secure confidential communication features.)
- When connecting to emergency services in Japan, use au VoLTE (LTE network). You cannot connect through 3G (circuit switching network).
- This product is compatible with the international roaming service. Each network service described in this manual varies depending on the area and service content.
- Since this product is a radio station under the Radio Law, you may be asked to temporarily submit the product for inspection in accordance with the Radio Law.
- IMEI information of your cell phone is automatically sent to KDDI CORPORATION for maintenance and monitoring operational status of your cell phone.
- Before you start using the product overseas, check the relevant laws and regulations of the country/region you visit.

"Setting Guide", "Basic Manual", "Notes on Usage", etc. are collectively referred to as "Instruction Manual".
In this manual, isai vivid (LGV32) is usually referred to as the "product".
In this manual, "microSD™ memory card", "microSDHC™ memory card" and "microSDXC™ memory card" are abbreviated as "microSD memory card" or "microSD".



September 2015, 2nd Edition
MFL69165003(1.1)

- The Company is not liable for any damages arising from earthquakes, lightning, storms, floods or other natural disasters, as well as fires, actions by third parties, other accidents, intentional or mistaken misoperation by the customer, or use under other unusual conditions outside the responsibility of the Company.
- The Company is not liable for any incidental damages (change/disappearance of described content, loss of business income, disruption of business, etc.) arising from use or inability to use the product.
- The Company is not liable for any damages arising from failure to observe the described content of the "Basic Manual" or "Notes on Usage" (this manual).
- The Company is not liable for any damages arising, for example, from malfunction caused by combination with connected devices or software not related to the Company.
- Captured image data or downloaded data may sometimes be altered or lost due to faults, repair or other handling of the product. The Company is not liable for any damage or lost income resulting from recovery of these data.
- It is recommended you keep a copy of important data on your PC's hard disk, etc. Whatever the cause of the defect or malfunction may be, the Company assumes no responsibility for alteration or loss of saved data.
- Contents saved in the product, such as contacts, mails and favorites, might be altered or lost in an accident, fault, repair or mishandling. Be sure to keep a copy of important contents. Note that Company assumes no responsibility for any damages or lost profits resulting from altered or lost contents.
- Note that contents (both charged or free content) saved with the product cannot be returned to the customer when it is replaced for repair of a fault, for example.

The product uses liquid crystal for its display. The display response speed may become slow when the ambient temperature is low, which is due to the property of liquid crystal and not a malfunction. The display response speed will return to normal at room temperature.

- Although the display used on the product is made using high-precision technology, some pixels (dots) might be lit or out at all times. Note that this is not a malfunction.
- You are recommended to store copies of individual data such as photos you took, videos and music on your PC by sending each file as mail attachment, etc. Note, however, that you may not be able to make copies of any copyrighted data even by the above mentioned means.
- Do not discard this product together with regular trash. Please cooperate in the collection of the product when it is no longer needed to protect the environment and effectively use resources. Old product are collected at au shops and other places.
- "The Company" as appears in this manual refers to the following companies:
Sold by : KDDI CORPORATION
OKINAWA CELLULAR TELEPHONE COMPANY
Imported by : LG Electronics Japan, Inc.
Manufactured by : LG Electronics Inc.

memo
 • Reproduction of the content of this manual in part or in whole is prohibited.
 • The content of this manual is subject to change without notice.
 • Every effort has been made in the preparation of this manual. Should you notice any unclear points, omissions, etc., feel free to contact us.

Cell Phone Etiquette

Use of the product is not allowed in the following places!

- Do not use a cell phone while driving a car or riding a motorbike or bicycle. It might cause a traffic accident. Use of a cell phone while driving a car or motorbike is prohibited by law. Use of a cell phone while riding a bicycle may be punishable by some regulations.
- Use of cell phones on board is restricted. Follow the instructions of each airline.

Consider people around you!

- To prevent ringing from bothering other people, not only refrain from making a call but also power off or use Silent mode at a movie theater, theater, museum, library, etc.
- In a city area, use in a place where you do not bother people walking.
- It is extremely dangerous to walk while looking at the screen of the cell phone. Do not make calls or operate a cell phone while walking or by stopping suddenly.
- Move to a place where you do not disturb others while you are in shinkansen, a hotel lobby, etc.
- Be careful not to be loud while talking.
- Be careful of sound leakage from earphones in trains or other places with many people around you.
- Ask permission if you take photos with your cell phone camera.
- There may be a person with a cardiac pacemaker nearby at a place filled with people such as in a crowded train. Set "Airplane mode" or turn off beforehand.

- When a medical institution has laid down designated areas where the use of the product is prohibited or is not allowed to be brought in, follow the instructions of that medical institution.
- The product is equipped with the functions used by shaking the product. Shake at right and left twice for use. Do not get your hands off of this product and do not shake beyond necessity when shaking. If this product is gotten your hands off in shaking beyond necessity, the terminal may be broken down. And the surrounding people or other things may be damaged.

Safety Precautions (Observe Strictly)

- Before using the product, thoroughly read these safety precautions for proper use. After reading, store the precautions in a safe place.
- These "Safety Precautions" describe instructions that should be observed to prevent damage to property or injury to the customer or others using the product.
- When the product is used by a child, parents or guardians should thoroughly read "Notes on Usage" (this manual) and teach the child how to use it.
- These instructions are divided into the following categories.

Explanation of graphic symbols used in this manual

	Indicates an action that is not allowed.		Indicates that use in a place where the product is likely to get wet or allowing the product to get wet is not allowed.
	Indicates that handling with wet hands is not allowed.		Indicates an action that must be done.
	Indicates that disassembly is not allowed.		Indicates that the power plug must be disconnected from the power outlet.

Precautions common to the main unit, battery pack, charging equipment, au Nano IC Card O4, peripheral devices

DANGER Be sure to read the following hazards before use.

Be sure to use only the specified peripheral devices. Use of other devices might cause overheating, ignition, rupture, fault, or leakage of liquid.

Do not use, store or leave the product in hot places (e.g. by the fire, near a heater, under a kotatsu, in direct sunlight, in a car in the hot sun). Doing so might cause ignition, rupture, fault, fire or injury.

Do not put the product in a cooking apparatus such as a microwave oven or a pressure vessel. Doing so might cause ignition, rupture, fault, fire or injury.

Do not throw the product into a fire or heat it. Doing so might cause fire, rupture or fire.

The customer is not allowed to disassemble, modify or repair the product. Doing so might cause a fault, ignition, electric shock, or injury. The Company is not liable even in the event of any non-conformities arising on the product or peripheral devices as a result of modification, etc. Modification of the product is in violation of the Wireless Telegraphy Act.

WARNING Be sure to read the following warnings before use.

Before entering an area where flammable gas is generated such as a gas station, be sure to turn off this product. Do not charge the battery. Failure to observe these precautions might cause the gas to catch fire. In addition, when using Osaifu-Keitai™ at a gas station, be sure to turn off the power in advance. (If NFC/Osaifu-Keitai™ lock has been set, cancel the lock before turning off the power.)

When using metal accessories, etc., make sure not to allow the metal part come in contact with the connection terminals, earphone terminal or power outlet. Doing so might cause electric shock, ignition, injury or a fault.

Do not drop or subject to strong impact, such as throwing. Doing so might cause rupture, overheating, ignition, or a fault.

Do not use outside when you can hear thunder. Doing so might risk lightning strikes and electric shock.

To prevent short-circuiting the external connection terminal, earphone terminal, etc., do not allow body parts or conductive foreign objects (metal fragments, pencil leads, etc.) to come into contact with or get inside them. Doing so might cause overheating, fire, a fault, electric shock, or burns.

If the product is damaged because it is dropped or something, and its display is cracked or internal parts are exposed, do not touch the cracked display or exposed parts with your hands. Doing so might cause electric shock or injury from damaged parts.

If the wet main unit is charged, electric shock, short circuit, or corrosion may occur and overheating may cause fire or malfunction or burns.

Do not splash with water or other liquids. Also, never use in places subject to direct splashing with water or pet urine, etc. or in humid places such as both areas, or use with wet hands. Doing so might cause electric shock, fault from short-circuiting, or corrosion of electronic circuits. In the event that the product is splashed with liquid, immediately disconnect the AC adapter's power plug. Faults caused by wetting with water or humidity are not covered by the warranty and charges will be incurred for repair.

Although this product model has waterproof property, stop using it if liquid such as water gets inside the main unit from the back cover. Continued use of the product in this state might cause overheating, fire, or a fault.

Battery pack

Li-ion00 (The battery pack of the product is lithium-ion battery.)
It is not fully charged at the time of purchase. Charge the battery before using the product. Also charge the battery before using the product if you have not used the product for a long time.

DANGER Be sure to read the following hazards before use.

Do not short-circuit the positive (+) and negative (-) terminals of the battery pack.

Connect the battery pack to the product in the correct orientation. Connecting in an incorrect orientation might cause rupture, fire or overheating. Do not try to forcibly connect the battery pack, instead thoroughly check the connection terminals before connection.

Do not puncture the battery pack with a nail, hit it with a hammer or step on it. Doing so might cause fire or damage.

When carrying or storing the product, make sure that pieces of metal (such as necklaces and hair pins) do not touch the external connection terminal. Doing so might cause overheating, a fire, liquid leaks, or a fault from a short-circuit.

Do not disassemble, modify or directly solder the product. Doing so might cause spilling of the battery liquid resulting in an accident such as loss of eyesight if it gets into the eyes, or cause overheating, fire, explosion, or injury.

Do not use the product while driving a car or motorbike, riding a bicycle, or walking. Doing so may cause a traffic accident or a fall. The use of a mobile phone while driving a car or motorbike is prohibited by law. The use of a mobile phone while riding a bicycle may also be punishable under law.

If charging is not completed after the specified charging time, stop charging. Failure to do so might cause leakage of liquid, overheating, rupture or ignition.

Do not leave in places within the reach of small children. Small children might swallow small parts, etc. by mistake and choke on them, or might drop them by mistake and cause accidents or injury.

Do not cover or wrap this product with bedding, etc. while using or charging the product. Doing so might cause fire, fault or injury.

When using an charging equipment or external device, insert/remove the connector straight to/from the terminal. Unless it's correct, it may cause overheating, ignition, damage or a fault.

CAUTION Be sure to read the following cautions before use.

When removing the back cover, do not exert more than necessary force. Doing so might cause injury or a fault.

Do not expose the camera lens to direct sunlight for an extended period. Doing so might cause ignition, rupture, fire or a fault by the light-collecting mechanism of the lens.

Do not use a battery pack that has been dropped, stepped on, damaged, or leaks liquid. Doing so might cause overheating, a fire, liquid leaks, a fault, or injury. If it leaks liquid or makes an abnormal smell, keep it away from open flames. Leaked liquid may catch fire causing an explosion.

Do not get the battery pack wet. Doing so may cause overheating, an explosion, fire, fault, or injury. If you accidentally drop the product in water, immediately turn off the power, remove the battery pack, and contact an au shop or Keitai Guarantee Service Center. Do not charge a wet battery pack.

If the leaked liquid gets on your skin or clothes, immediately rinse it off with water to avoid injury. If the liquid gets into your eyes, do not rub them, wash them with water, and immediately consult a doctor to avoid the risk of losing your eyesight. If the liquid gets on a device, wipe it off without touching it.

The battery pack is a consumable part. If usage time is extremely short or the product does not function even after the battery has been charged, the battery has reached the end of its service life, so stop using it and purchase a specified, new battery pack. Continual use may cause overheating, fire, an explosion, or leakage of liquid. The battery lifespan varies depending on how the product is used.

Make sure that any pets you may have do not bite the battery pack. Doing so might cause the battery pack to leak, overheat, explode, ignite, catch fire or a fault.

Do not store the product in places subject to direct sunlight (e.g. in cars), places that get hot, places that get extremely cold, and in humid or dusty places. Doing so might cause overheating, deformation or a fault.

Do not leave on unstable places such as rocky stands or tilting surfaces. Dropping the product may cause injury or damage. Pay sufficient attention while vibrator is set to ON. Also, pay sufficient attention to impact, etc. Doing so might cause injure or a fault.

This product may become hot if you use it for a long period of time or when it is connected to an external power source. Do not touch this product or the specified charging equipment (sold separately) for a long period of time. Doing so may result in a low temperature burn. Also do not cover this device with paper, clothes or blankets. Doing so might cause a fire, injury or a fault.

When charging this product, do not use power outlets or wiring apparatus beyond its rating. Also, exceeding rating, for example, by connecting multiple devices to a single power strip might cause overheating and fire.

Do not use the product with the back cover removed. Also, do not leave or store. Doing so might allow dust or other foreign objects to get inside and cause a fault.

Do not place near corrosive chemicals or in places where corrosive gas is generated. Doing so might cause a fault or loss of internal data.

Charging equipment

WARNING Be sure to read the following warnings before use.

Do not use at other voltages than the specified power supply voltage. Doing so might cause ignition, fire, overheating, injure or electric shock.

- AC adapter (sold separately): 100 VAC to 240 VAC
- Common DC adapter O3 (sold separately) : 12/24 VDC (for negative grounded vehicles only)

Firmly insert the plug of the specified charging equipment (sold separately) into the power outlet or cigarette lighter socket down to the base of its pins. Incomplete insertion of the power plug might result in electric shock, overheating, ignition, injure and fire. Do not use the damaged specified charger, power outlet or cigarette lighter socket with loose insertion connector.

If the fuse in the common DC adapter O3 (sold separately) blows, replace it with a fuse of the specified type (250 V, 1A). Replacing with a different type of fuse might cause overheating or fire. (For information about fuse replacement, carefully read the manual for the common DC adapter O3 (sold separately).)

Do not damage, modify, twist, pull, or place a heavy object on the power cord of the specified charging equipment (sold separately). Do not use a damaged cord. Doing so might cause an electric shock, injure, short circuit or fire.

If you hear thunder, do not touch the specified charging equipment (sold separately). Doing so might cause an electric shock as a result of a lightning strike.

Do not use the product if there is smoke, abnormal odor or noise, excessive overheating, or other abnormalities. If an abnormality occurs, disconnect the specified charging equipment (sold separately) from the power outlet, make sure that the product is not overheating before turning the power off, and contact an au shop or Keitai Guarantee Service Center. Also, if you have dropped or damaged the product, do not continue to use it in that state, and contact an au shop or Keitai Guarantee Service Center.

When inserting an earphone, etc. into the product, slowly adjust the volume to the proper level. Setting the volume loud from the start of use, setting it too loud, or using the earphone continuously for a long period of time might adversely affect your ears. Also, raising the volume too high might prevent you from hearing sounds around you, which might in turn lead to a traffic accident at a railroad crossing or pedestrian crossing.

Sound from speaker may be very loud when you use hands-free calling. Keep it away from your ear when using it.

Main unit

WARNING Be sure to read the following warnings before use.

Turn off the product or put it in Airplane mode before boarding an airplane. Use of cell phones on board is restricted. Follow the instructions of each airline. Failure to do so may adversely affect on-board electronic equipment. Prohibited acts related to cell phone usage on an airplane may be punished by law.

Before cleaning the specified charging equipment (sold separately), unplug its power plug from the power outlet or cigarette lighter socket. If the plug remains plugged in when you clean the equipment, it might cause an electric shock or short circuit.

Wipe off the dust on the power plug. Failure to do so might cause a fire, burns, or electric shock.

When the AC adapter is not to be used for a long time, disconnect the AC adapter's power plug from the power outlet. Doing so might cause fire or a fault.

Do not use in places subject to direct splashing with water, pet urine, or other liquids. Doing so might result in faults and injure resulting from overheating, fire, electric shock, or short-circuiting of electronic circuits. In the event that the product is splashed with liquid, immediately disconnect the AC adapter's power plug.

When not using the specified charging equipment (sold separately), remove the power plug from the power outlet or cigarette lighter socket. Also, do not wrap the power cord of the specified charging equipment (sold separately) around the adapter. Doing so might cause electric shock, overheating, fire, a fault or injury.

Do not forcibly bend the charging equipment's plug or the connection between the connector and power cord. Doing so might cause electric shock, fault, injure, overheating or fire.

These instructions are divided into the following categories.

	This symbol indicates the potential and imminent danger of death or serious injury ¹ to a person if the product is handled incorrectly.
	This symbol indicates the possibility of death or serious injury ¹ to a person if the product is handled incorrectly.
	This symbol indicates the possibility of minor injury ² to a person or physical damage ³ if the product is handled incorrectly.

- Serious injury: This refers to loss of sight, injury, burns (high- and low-temperature), electric shock, broken bones, injuries with residual aftereffects from poisoning, etc., and injuries requiring hospital admission for treatment or long term hospital attendance as an outpatient.
- Minor injury: This refers to injuries, burns (high- and low-temperature), electric shock, etc. that do not require hospital admission for treatment or long-term hospital attendance as an outpatient.
- Physical damage: This refers to extended damage to buildings, furniture, livestock, or pets.

Follow the instructions of each medical facility for the use of cell phones on their premises. Power off the product in a place where the use is prohibited. Failure to do so may affect electronic equipment and electronic medical equipment.

Do not look directly at the light of the laser autofocus sensor. Doing so might cause damage to your vision.

If using the flash, do not direct it at people's eyes, people driving cars, riding motorbikes or bicycles. Also, do not look directly at the light source when the flash is turned on. Doing so might cause damage to your vision. In particular, do not take pictures of infants from a very close distance.

Sometimes, very rarely some people demonstrate symptoms such as temporary muscle spasms, loss of consciousness, etc. by watching repeatedly flickering screens. Those with a past history of this should consult with a physician beforehand.

CAUTION Be sure to read the following cautions before use.

Use of the main unit in an automobile sometimes affects on-vehicle electronic devices, though this rarely happens. If this happens, stop use since this may impair safe travel.

If you feel any abnormality with your skin, immediately consult a dermatologist. Itching, rashes, eczema, etc. sometimes occurs depending on your physical constitution and condition.

CAUTION Be sure to read the following cautions before use.

Do not use in humid places such as bath areas, or connect/disconnect the AC adapter with wet hands. Doing so might cause electric shock, injure or a fault.

When unplugging the plug of the specified charging equipment (sold separately) from the power outlet or cigarette lighter socket, hold and pull the power plug. Pulling on the cable might damage it.

Do not use the common DC adapter O3 (sold separately) with the car engine stopped. Doing so might result in draining of the car battery.

Do not leave the unit plugged into the specified charging equipment (sold separately) with the battery pack removed. Doing so might cause a fire, electric shock, or injure.

au Nano IC Card O4

CAUTION Be sure to read the following cautions before use.

Be careful when attaching/removing the au Nano IC Card O4. Doing so might injure your hands or fingers.

■ **Draining water after wetting the product**
As some parts of this product are not watertight, if you use the product after it gets wet, water remaining in those parts might wet your clothes or bag, or the sound might become hard to hear. Follow the steps below to drain water.

1 **Carefully wipe the moisture off the main unit with a dry towel, cloth, etc.**

2 **Hold the product firmly and shake it about 20 times in the direction of the arrow shown in the figure until water drops no longer fly off.**

When shaking the product, confirm the safety around you and hold it firmly so as not to drop it.

3 **Cover the power key and volume key with a towel, cloth, etc. and press each key two to three times.**

4 **Wipe the moisture coming out from inside with a dry towel, cloth, etc.**

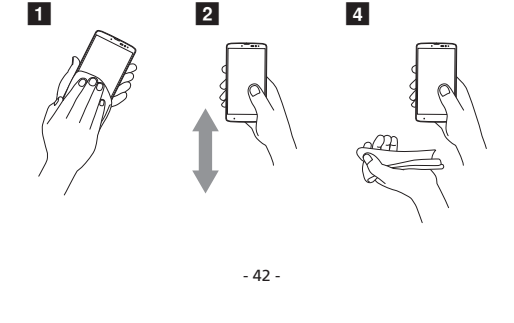

Organization (WHO), and the permissible limits include a substantial safety margin designed to assure the safety of all persons, regardless of age and health condition.

The Japanese technical regulations and international guidelines define the limits using a unit of measurement known as the Specific Absorption Rate (SAR), which represents the average amount of radio frequency energy absorbed by the human. The SAR limit for mobile phones is 2.0 W/kg. The highest SAR value for this mobile phone when tested for use at the ear is 0.323 W/kg. The highest SAR value for this mobile phone when tested for use on the body is 0.265 W/kg. There may be slight differences in SAR levels among individual products, but they all satisfy the limit.

The actual SAR of this mobile phone while talking on the phone can be well below that indicated above. This is due to automatic changes in the power level of the mobile phone to ensure it only outputs the minimum power required to communicate with a base station. Therefore in general, the closer you are to a base station, the lower the power output of the mobile phone.

This mobile phone can be used in positions other than against your ear. Use an accessory such as a carrying case, etc. so that you can hold the product at least 1.5 cm away from your body and also do not contain metal parts between the product and your body. By doing this, this mobile phone complies with Japanese technical regulations and international guidelines regarding exposure to radio waves.

The World Health Organization has stated that present scientific information does not indicate that use of mobile devices has any harmful effects on the human body. They recommend that if you are still worried about your exposure then you can limit your talk time or use a handsfree kit to keep the mobile phone away from your head and body.

If you would like to know more detailed information, please refer to the WHO website.

http://www.who.int/docstore/peh-emf/publications/facts_press/fact_english.htm

- 49 -	- 50 -	- 51 -	- 52 -	- 53 -	- 54 -	- 55 -
--------	--------	--------	--------	--------	--------	--------

For inquiries, call:

Customer Service Center

For general, charge, operations (toll free)
Business hours 9:00 – 20:00 (7 days a week)

From fixed-line phones:	From au cell phones:
☎ 0077-7-111	157 area code not required

PRESSING ZERO WILL CONNECT YOU TO AN OPERATOR
AFTER CALLING 157 ON YOUR au CELL PHONE

For service canceling procedure in case of loss or theft (toll free)
Business hours 24-hour (7 days a week)

From fixed-line phones:	From au cell phones:
☎ 0077-7-113	113 area code not required

In case above numbers are not available,

☎ 0120-977-033	(except Okinawa)
☎ 0120-977-699	(Okinawa)

Keitai Guarantee Service Center	やめましょ、歩きスマホ。
For loss, theft or damage (toll free) Business hours 9:00 – 21:00 (7 days a week)	
From fixed-line phones/au cell phones,	キケン！ 水ぬれ充電
☎ 0120-925-919	It is very dangerous to charge the product in a wet state, this could cause abnormal heat generation or a burnout.

Cell phone and PHS operators collect and recycle unused telephones, batteries and battery chargers at stores bearing the ♻️ logo regardless of brand and manufacturer to protect the environment and reuse valuable resources.

モバイル・リサイクル・ネットワーク

Sold by: KDDI CORPORATION, OKINAWA CELLULAR TELEPHONE COMPANY
Imported by: LG Electronics Japan Inc.
Manufactured by: LG Electronics Inc.

5 **Place it on a dry towel, cloth, etc. and let it dry at ambient temperature. (Around 30 minutes)**

If it is not fully dried, the sound may become hard to hear. Let it fully dry before use.

■ **Precautions on charging**

The supplied and optional accessories are not waterproof/ dustproof. Be sure to check the following points before and after charging.

- Never charge the battery if the main unit is wet. Doing so might cause electric shock or short circuit resulting in a fire, burns or a fault.

- Check that the main unit is not wet. If you are charging the battery just after the product gets wet, drain water well and wipe remaining water off with a clean dry cloth before connecting it to the specified charging equipment (sold separately).

- Do not touch the specified charging equipment (sold separately) with wet hands. Doing so might cause electric shock.

- Do not splash water over the specified charging equipment (sold separately) when using them. Do not use them near water such, as in a bathroom, shower room, kitchen or washroom. Failure to do so might cause fire, electric shock, injury or a fault. Do not bring them into a bathroom, etc. even when you are not charging with them.

- Failure to do so might cause fire, electric shock, injury or a fault.

Bluetooth®/Wireless LAN (Wi-Fi®) Function

- The Bluetooth® function and the wireless LAN (Wi-Fi®) function of this product conforms to the domestic standards of Japan, FCC standards, and EC directives, and has been certified.

- The 2.4 GHz band used by wireless LAN (Wi-Fi®) and Bluetooth® devices is shared by various other devices. For this reason, the communication speed and connectable range may be decreased, or disconnection may occur, due to interference from other devices.

- Do not use this product in places where electromagnetic waves are generated or near electric products, AV and OA equipment, or other magnetized devices.

- Subjecting this product to magnetic or electrical noise might increase noise and prevent it from performing communications. (This product is particularly susceptible to noise when it used near a microwave oven.)

- Using this product near a TV, radio or similar appliance might cause reception interference and disrupt TV images.

- The searching might not be successful if there are multiple wireless LAN (Wi-Fi®) access points near to the product or the same channel is being used.

- Use of cell phones on board is restricted. Follow the instructions of each airline.

- The communication speed and connectable range vary depending on the distance between communication devices, obstacles and the devices to connect.