

For detailed operation methods, refer to "Basic Manual" application installed on the product.



September 2015, 2nd Edition  
MFL69165002(1,1)

### Preface

Thank you for purchasing the "isai vivid (LGV32)" (simply called the "product" from here on). Before using the product, be sure to read the "Setting Guide", "Notes on Usage", "Basic Manual" (this manual) or "取扱説明書 詳細版 (Full Instruction Manual)" (Japanese) available on the au homepage to ensure correct use. After you have finished reading this PDF and the printed manuals, be sure to store them in safe places so that you can retrieve them whenever needed.

### List of Packaged Items

Before you start using the product, make sure that you have all of the following packaged with the product.

- Main unit (including back cover)
- Battery pack (LGV32UAA)

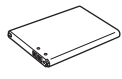

The following items are not included in the package.

- microUSB cable
- microSD memory card
- Earphone
- AC adapter
- Desktop holder

### memo

- Purchase a specified charger (sold separately).
- The illustrations of the cell phone in the manual are used only for explaining. They may differ from the actual product.
- When watching TV, connect the antenna cable. For details on connecting, refer to "TV antenna cable."

### About Operating Instructions

#### Basic Manual (this manual)

Handles only basic operations for main features. For detailed descriptions on various functions, refer to the "Basic Manual" application installed on the product or "取扱説明書 詳細版 (Full Instruction Manual)" (Japanese) available on the au homepage. <http://www.au.kddi.com/support/mobile/guide/manual/>

- All company names and product names in this manual are either trade marks or registered trade marks.

#### Basic Manual application

You can use the "Basic Manual" application on the product to confirm detailed operational procedures. Certain functions can be directly activated from the application screens on which their operations are described.

#### Operation procedures

- 1 On the home screen ▶ "☰" ▶ "サポート (Support)" ▶ "Basic Manual"

- When you activate for the first time, follow the onscreen instructions to download and install the application.

### Downloading Manuals

You can download the "Basic Manual" (this PDF manual), the "Setting Guide", the "Notes on Usage" and "取扱説明書 詳細版 (Full Instruction Manual)" (Japanese) in PDF format from the au homepage. Download URL: <http://www.au.kddi.com/support/mobile/guide/manual/>

#### Support information

You can view videos and images describing basic operations and recommended functions as well as instruction manuals, update information, and other support information.

#### Operation procedures

- 1 On the home screen ▶ "☰" ▶ Slide the browser screen page down

A tool bar is displayed at the bottom of the browser screen.

- 2 "☰" ▶ "isai vividサポート情報 (isai vivid support information)"

#### From a computer or smartphone

<http://www.au.kddi.com/support/mobile/guide/smartphone/lgv32/index.html?bid=cs-cs-mobile0002>



### Regarding Notations Used in This Manual

#### Key indications used in this manual

In this manual, keys are represented by simplified illustrations as shown below.

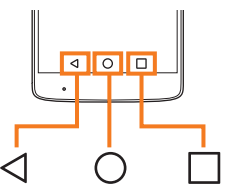

#### Indications used for the operation of selecting items/icons/buttons, etc.

The notations used for operation procedures in this manual are as follows.

Tap means to lightly touch and release the button or icon shown on the display to select it.

Description	Explanation
On the home screen ▶ "☰" ▶ "1" "4" "1"	Tap "☰" (Phone) on the bottom of home screen. Tap "1" "4" "1"
▶ "☰"	"1" and "☰".

### For inquiries, call:

#### Customer Service Center

For general, charge, operations (toll free)  
Business hours 9:00 - 20:00 (7 days a week)

From fixed-line phones: 0077-7-111

From au cell phones: 157 (area code not required)

PRESSING ZERO WILL CONNECT YOU TO AN OPERATOR AFTER CALLING 157 ON YOUR au CELL PHONE.

For service canceling procedure in case of loss or theft (toll free)  
Business hours 24-hour (7 days a week)

From fixed-line phones: 0077-7-113

From au cell phones: 113 (area code not required)

In case above numbers are not available.

0120-977-033 (except Okinawa)

0120-977-699 (Okinawa)

#### Keitai Guarantee Service Center

For loss, theft or damage (toll free)  
Business hours 9:00 - 21:00 (7 days a week)

From fixed-line phones: 0120-925-919

From au cell phones: 113 (area code not required)

0120-925-919

0120-925-919

0120-925-919

0120-925-919

0120-925-919

0120-925-919

0120-925-919

0120-925-919

0120-925-919

0120-925-919

0120-925-919

0120-925-919

0120-925-919

0120-925-919

0120-925-919

0120-925-919

0120-925-919

0120-925-919

0120-925-919

0120-925-919

0120-925-919

0120-925-919

0120-925-919

0120-925-919

0120-925-919

0120-925-919

0120-925-919

0120-925-919

0120-925-919

0120-925-919

0120-925-919

0120-925-919

0120-925-919

0120-925-919

0120-925-919

0120-925-919

0120-925-919

0120-925-919

0120-925-919

0120-925-919

0120-925-919

0120-925-919

0120-925-919

0120-925-919

0120-925-919

0120-925-919

0120-925-919

0120-925-919

0120-925-919

0120-925-919

0120-925-919

0120-925-919

0120-925-919

0120-925-919

0120-925-919

0120-925-919

0120-925-919

### Removing Battery Pack

- 1 Remove the back cover

- 2 Insert your fingernail in the recess of the unit, and while pushing the battery pack in the direction of the arrow (1), lift it in the direction of the arrow (2)

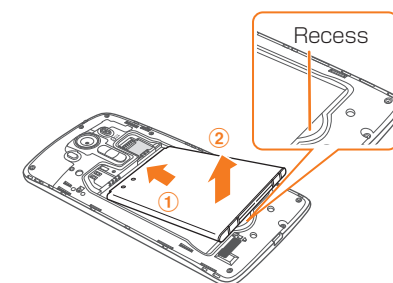

- 3 Attach the back cover

- Emergency Rapid Mail may not be received when your cell phone is communicating if you are in a place where signal does not reach even in the service area (e.g. in a tunnel, basement) or in a place with a poor reception.
- You cannot receive Emergency Rapid Mail once the reception is failed.
- This delivery system is different from Earthquake Early Warning provided through TV, radio, or other communication procedures, which means that the time the Earthquake Early Warning arrives may vary.
- Information from someplace other than your current location may be received.

### au Nano IC Card O4

au Nano IC Card O4 stores your personal information such as a phone number.

- The product is compatible with au Nano IC Card O4 only. You cannot use the product with an IC card other than au Nano IC Card O4. IC (metal) part

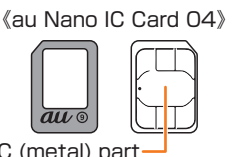

### memo

- Note the following points, which may cause malfunction or damage, when handling the au Nano IC Card O4.
  - Do not touch the IC (metal) part of the au Nano IC Card O4 or the IC card terminal inside the product.
  - Insert the au Nano IC Card O4 in the correct orientation.
  - Do not use force to attach or remove the IC card.
- Do not lose the au Nano IC Card O4 after it has been removed.
- Before attaching/removing au Nano IC Card O4, be sure to remove the microUSB connector of specified AC adapter (sold separately) etc. from the product.

### Using Disaster Voice Messaging Service

Disaster Voice Messaging Service is a service which allows you to record your voice and send someone you want to inform your well-being in case of a large-scale disaster.

- 1 au災害対策 (au Disaster Countermeasure) menu screen ▶ "災害用音声お届けサービス (Disaster Voice Messaging Service)"

■ Sending voice (sending)  
Select "声をお届け (Sending voice)". \*①お届け先を選択 (Select delivery)\*\* → \*②お届けしたい声を録音 (Record voice)\*  
\* Alternatively, delivery address can be selected in Contacts.

■ Receiving voice (receiving)  
Receiving voice messages is notified on a pop-up screen or SMS. To listen to voice messages, receive (download) and play it.

- When a recipient uses a smartphone without au災害対策 (au Disaster Countermeasure) activated or au cell phone, SMS is sent.
- In case of receiving SMS, the information is not saved on au災害対策 (au Disaster Countermeasure).

■ When au Nano IC Card O4 is not inserted  
You cannot use this product with any cards other than au Nano IC Card O4.

If you turn the product on when the au Nano IC Card O4 is not inserted or when you insert any cards other than au Nano IC Card O4, [ ] and [ ] are displayed on the status bar and the following operations are not available.

- Make a call\*/receive a call
- Receiving/sending and initial settings of e-mail (@ezweb.ne.jp)
- Receiving/sending SMS
- Confirm your own phone number
- Set up UIM card lock
- \* Emergency calls to 110 (Police), 119 (Fire department or ambulance service), 118 (Japan Coast Guard), and 157 (Customer Service Center) are also not available.

Besides the above, some functions requiring your phone number might not be available.

■ Restriction settings with PIN  
You can set the product to restrict the use of the product by others through changing the PIN code or locking the UIM card in order to protect your important private information while you are using your au Nano IC Card O4.

### memo

- For use over Wi-Fi®, it is necessary to carry out initial settings over 4G (LTE/WiMAX 2+) network.
- Voice messages can be recorded for up to 30 seconds.
- Messages can be sent and received to or from au cell phones, other network operators' cell phones and PHS.
- Voice message may be difficult to hear if the media volume is low or Silent mode (sets Sound profile to "Vibrate only") is set.
- Saving or playing Voice messages may fail if a phone does not have available memory.
- Some cell phones do not support receiving voice messages. For details, refer to au homepage.

### Using Disaster-related information

You can check Disaster and Evacuation Information history delivered by local government, and disaster-related portals, etc.

- 1 au災害対策 (au Disaster Countermeasure) menu screen ▶ "災害関連情報 (Disaster-related information)"

- 2 Follow the onscreen instructions

### Attaching/Removing au Nano IC Card O4

#### Attaching au Nano IC Card O4

Before attaching the au Nano IC Card O4, first turn off this product, and remove the back cover and battery pack.

- 1 Remove the back cover
  - 2 Remove the battery pack
  - 3 Insert the au Nano IC Card O4 card into the au Nano IC Card O4 slot in the direction of the arrow
- Note the direction of the notch.

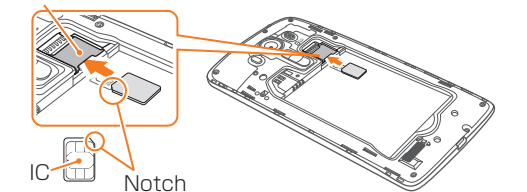

### Attaching/Removing Battery Pack

- Before attaching/removing the back cover and/or battery pack, be sure to turn off the product. Do not attach/remove the back cover and/or battery pack with AC adapter (sold separately) connected to the external connection terminal.
- Only use the battery pack made for this product.

#### Attaching Battery Pack

- 1 Hook the groove of the back cover with your fingernail, then lift it from the bottom in the direction of the arrow to remove it



#### Removing au Nano IC Card O4

Before removing the au Nano IC Card O4, first turn off this product, and remove the back cover and battery pack.

- 1 Remove the back cover
  - 2 Remove the battery pack
  - 3 Insert your fingernail into the groove at the back of the au Nano IC Card O4 slot and push the au Nano IC Card O4 in the direction of the arrow (1)
- If a microSD memory card is inserted, remove that first.

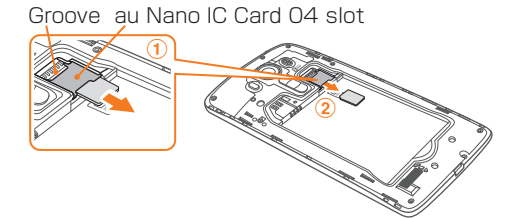

- 2 Place the face of the battery pack with the au logo upwards, align the product connector with the battery pack terminal, and insert the battery pack in the direction of the arrow (1)

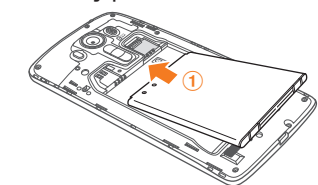

- 3 Check the orientation of the back cover, align it with the top of the unit (camera lens and keys, etc.), and press each tab firmly to attach the cover

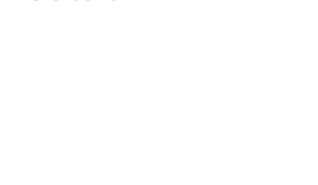

### Charging

When you purchase your cell phone, the battery pack is not fully charged. Charge the battery pack when you use it for the first time or when its battery is not enough.

### memo

- While charging, the product and its battery pack might become hot. It is not abnormal. (When activating camera or communicating data while charging, the battery pack becomes hot.)
- It may take longer to charge the built-in battery when you use camera function, etc. while charging the battery.
- Operating with the specified charging equipment (sold separately) being connected might cause short-time charge/discharge repeatedly. Life of the battery pack becomes shorter when you repeatedly charge it frequently.

#### Charging with the Specified AC Adapter (Sold Separately)

Describe how to charge by using the common AC adapter O5 (sold separately). For details on the specified AC adapter (sold separately), refer to "Introduction of Related Accessories".

Description	Explanation
On the home screen ▶ "☰"	On the bottom of the home screen, tap "☰".

### memo

- This manual uses screenshots and describes operations with the au Nano IC Card O4 inserted.
- Descriptions in this manual are based on the operations of portrait screen. Items, icons, or the keys on the screen may look different with landscape screen.
- Items, title levels, and icons in this manual may look different based on different functions you use or different conditions, etc.
- In this manual, "microSD™ memory card", "microSDHC™ memory card" or "microSDXC™ memory card" is called "microSD memory card" or "microSD" for short.
- All of the indicated amounts exclude tax unless otherwise specified.

■ Illustrations and screen displays used in this manual  
Illustrations and screens shown in this manual may look different from the actual product or screen. In some cases, minor details or a part of a screen may be omitted.

### memo

- Reception of Emergency Rapid Mail is notified by a special warning tone and vibration. It is not possible to change the warning tone.
  - \* Reception of Earthquake Early Warning is notified by a special warning tone, voice ("地震です" "Jishindesu" (An earthquake)) and vibration.
- When you receive Emergency Rapid Mail during a call, the warning tone does not sound.
- Earthquake Early Warning is sent to areas where strong quakes (over 4 degrees) are expected when the earthquake whose the maximum seismic intensity 5 lower is anticipated occurs.
- Immediately after an earthquake occurs, quakes (P waves and initial tremors) near the epicenter are detected and position, scale, and expected strength are automatically calculated and notification is sent as soon as possible within a few seconds to tens of seconds before the strong quakes (S waves and major tremors) caused by the earthquake start.
- Earthquake Early Warning may not arrive before strong tremors in arrears near the epicenter.

- To maintain waterproof performance, securely close the cover to make sure that the cover is not partially open.

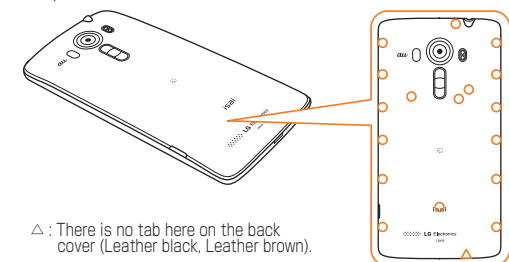

△: There is no tab here on the back cover (Leather black, Leather brown).

- 1 Insert the microUSB connector of the common AC adapter O5 (sold separately) straight into the external connection terminal of the product
- Insert the microUSB connector straight with the "▲" mark facing up.

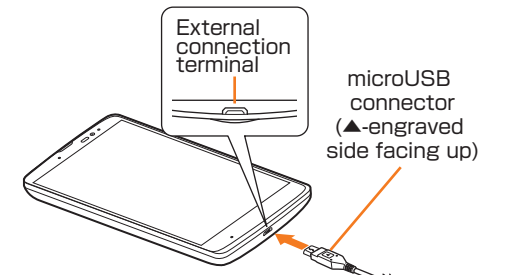

- 2 Insert the power plug of the common AC adapter O5 (sold separately) into a 100 V AC power outlet

On the status bar of the screen top, [ ] is displayed to show the charging is starting. When the charging is finished, [ ] is displayed.



- When charging is completed, remove the microUSB connector of the common AC adapter O5 (sold separately) straight from the external connection terminal of the product
- Remove the power plug of the common AC adapter O5 (sold separately) from power outlet

**memo**

When **[ ]** is not displayed

- Wait until **[ ]** is displayed on the status bar of the top screen. Bad connection is assumed if it does not appear after a while. Check if Common AC Adapter O5 (sold separately) is securely connected. If it still does not appear, stop charging and contact an au shop or a Keitai Guarantee Service Center.

### Charging with a PC

- Insert the microUSB connector of the microUSB cable (sold separately) directly into the external connection terminal of the product
  - Insert the microUSB connector straight with the "B" mark facing up.

- 27 -

### Adding shortcuts/widgets etc.

- On the home screen ► Touch and hold " **[ ]** " ► "Add apps & widgets"

- Tap an item shown below

Apps	Create a shortcut of an application.
Widgets	You can add widgets such as calendar, music, etc. You can add shortcut of settings menu also.
Wallpapers	Select from Gallery, Multi-photo, Live wallpapers, Photos, etc.

- Drag to the area to add shortcuts/widgets

#### ■ Adding a folder

- Touch and hold app/shortcut to store into a folder

- Drag onto another app/shortcut and release your finger  
App/shortcut is stored into the folder.

- 34 -

### Switching the Software Keyboard

- Character input screen ► Touch and hold " **[ ]** " keyboard)"
- Touch and hold " **[ ]** " (QWERTY keyboard) / " **[ ]** " (10-key keyboard)"
  - On the 10-key keyboard, tap the same key repeatedly or flick up/down/left/right to enter the desired character.
  - On the QWERTY keyboard, tap the key of your desired character to enter. Romaji input is applied for "Hiragana-Kanji" mode.

**memo**

- LG Japanese keyboard is initially installed as an input software.
- To switch input mode, character input screen ► Touch and hold " **[ ]** " ► "Input Mode" to select input mode.
- To set ringtone and vibration for key operations on LG Japanese keyboard, character input screen ► Touch and hold " **[ ]** " ► "Keyboard Settings" ► "Touch feedback".
- Tap " **[ ]** " to switch Input Mode.
- Tap " **[ ]** " to delete the selected character or characters on the left side of cursor.
- Tap " **[ ]** " to enter numbers, symbols, and tap again to enter smiley, symbol and emoticon.

- 41 -

### Troubleshooting

Before you assume that this product is malfunctioning, check the following:

Symptom	Check item
Cannot charge the battery	Is the AC adapter securely plugged into an outlet?
Battery usage time is short	Do you use this product more in the places without signal reception (out of service)? Is the battery pack end-of-life?
Cannot operate touch panel as intended	Are you operating with gloved hands? Make sure you are not operating with your finger tip or there is no foreign object in the middle of the panel.
Cannot operate the keys/touch panel	Is the screen lock set? Turn off the power and turn it on again.
Screen response is slow when you tap on the screen/press the keys	Screen response may slow down when a large amount of data is stored in this product or being transmitted between the product and a microSD memory card.

- 48 -

- Insert the microUSB connector of the microUSB cable (sold separately) straight into the USB port of the PC

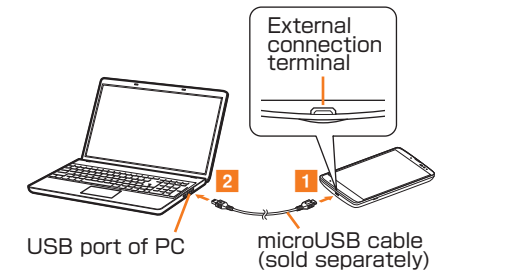

**memo**

- Although charging with the power of the product on is available, it takes longer.
- It may take longer to charge with USB than the specified AC adapter (sold separately).
- When the "Start new hardware search wizard" window appears, select "Cancel".

- 28 -

### Smart Notice and Weather Information

#### Smart Notice

Displays notifications (card notifications), such as current time, weather information, and terminal information.

- Weather information
- Date & time
- Notifications from Smart Notice
- Update
- Smart Notice settings



#### Weather information

Display weather information for the set city. You can also check hourly and weekly forecasts.

- On the home screen ► Tap Smart Notice weather information  
Detailed weather information is displayed.

- 35 -

### Using a microSD Memory Card

#### Installing a microSD Memory Card

- Remove the back cover
- Remove the battery pack
- Place the face of the microSD memory card with the logo upwards and insert all the way into the microSD memory card slot in the direction of the arrow

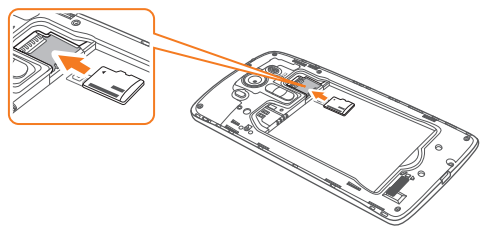

- 42 -

Symptom	Check item
No UIM card is displayed	Is your au Nano IC Card O4 inserted?
Phone is SIM Network Subset locked is displayed	Is an IC card other than au Nano IC Card O4 inserted?
The volume of the ringtone is low at first	The volume of the ringtone gradually increases to the volume that you have set not to affect your ears.
Cannot make calls	Is your au Nano IC Card O4 inserted? Did you enter the wrong phone number? (Did you enter the phone number starting with an area code?)
Cannot receive calls	Is reception good enough? Are you out of service area? Is Call forwarding service set?
Display is dark	Is "Brightness" set to dark?
Cannot hear the other party	Is the earpiece volume too low? Do you bring earpiece close to your ear? Put the earpiece close to your ear hold.

- 49 -

### Turning the Power On/Off

#### Turning the Power On

- Power key (Press and hold for more than 2 seconds)  
The lock screen appears. Swipe the screen to unlock.

#### Turning the Power Off

- Power key (Press and hold for more than 2 seconds)
- "Power off" ► "OK"

- 29 -

### Checking The Product State

#### Understanding Icons

Notification icons such as a missed call, new mail, or other operations in use are displayed on the left side of status bar. On the right side, status icons showing the state of the product are displayed. Also slide the status bar downwards to display the notification panel.

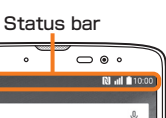

#### ■ Major notification icons

Icon	Description
[Missed call]	Missed call
[New mail]	New mail message (E-mail)
[New mail]	New mail message (PC mail)
[New mail]	New mail message (Gmail)
[SMS]	New SMS message
[Address Book Plus]	Display notification for Address Book Plus setting
[Phone]	Receiving a call
[VoLTE]	Displayed during a high quality call from an au cell phone that supports VoLTE

- 36 -

**memo**

- Make sure that the top and bottom of the microSD memory card are facing correctly. Trying to force a wrongly oriented card into the slot could make it impossible to remove the card and result in damage.

#### Removing a microSD Memory Card

- On the home screen ► Touch and hold " **[ ]** " ► "System settings" ► "General" tab ► "Storage" ► "Unmount SD card"
- Remove the back cover
- Remove the battery pack
- Gently pull out the microSD memory card  
Gently and straightly pull it out.

- 43 -

Symptom	Check item
Cannot use NFC/Osaifu-Keitai®	Has the battery run out? Is "NFC/Osaifu-Keitai lock" set? Do you hold this product so that the mark area is placed over the reader?
Cannot recognize a microSD memory card	Is a microSD memory card inserted properly? Is the microSD memory card unmounted?

If the symptom does not improve after checking the above items, contact the below au website or au customer support.  
<http://www.au.kddi.com/support/mobile/trouble/repair>

- 50 -

### Lock screen

The Lock screen is displayed when the power is turned on or after sleep mode has been deactivated. On the Lock screen, you can check the date and time, and notification information as well as use application shortcuts.

- Status bar
- Date & time
- Address Book Plus  
Displays various information registered in the Address Book. You can also display information about favorites and contacts that you contact frequently in the notification area.
- Notification information
- Application shortcut  
Swipe to launch an application.

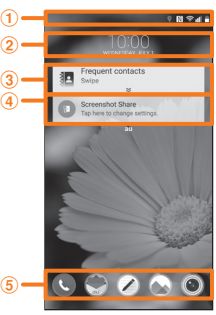

- 30 -

#### Unlocking the Lock screen

- Swipe the Lock screen  
The home screen appears.
  - The unlock method differs depending on the screen lock settings.

### Using the Home Screen

#### Viewing Home Screen

The home screen is configured of multiple desktops, and desktops can be switched by sliding/flicking to the right and left. Shortcuts, widgets, and folders can be added by adding a desktop.

- Status bar
- Quick search box (widget)
- Smart Notice (widget)
- Shortcuts/Folders
- Apps  
Main menu is open and the application list is displayed.
- Quick menu
- Desktop
- Home touch button  
Returns to the previous screen.



- 31 -

#### Notification Panel

When a notification icon appears on the status bar, slide the status bar down to open the notification panel to check the notification or launch the application.

- Slide the status bar downwards

- Date & time
- Quick Settings
- Brightness
- Volume
- Settings
- Notification information
- Clear  
Clear notification information and notification icons.



- 38 -

### Viewing the Setting Menu

- On the home screen ► Touch and hold " **[ ]** " ► "System settings"

#### ■ Setting menu item list

**Networks tab**  
Make communication settings such as Wi-Fi®, Bluetooth®, call settings.

#### Sound & notification tab

Configure sound and vibration for the ringtone and music playback as well as notification settings.

#### Display tab

Make settings of home screen, lock screen, display brightness, etc.

#### General tab

Set security, add/delete accounts for online services, set such as backup and reset, check about phone, etc.

- 44 -

### Updating Software

#### Notes on Software Update

- You are charged for data communication when connecting to the Internet from the product by using packet communication.
- When software update is necessary, you will be informed on au homepage, etc. For details, contact an au shop or Customer Service Center (157/call toll-free). In addition, users of this product will receive a notice from au, when software update is necessary to improve the functionality of the product.
- Make sure to charge your phone before software update. If battery is not enough, software update may fail.
- Check out the signal reception. Software update may fail if you are at a place with bad signal reception.
- Data registered on the product (Contacts, mail, still images, music, etc.) and setting information will not be changed even after software is updated. However, note that data might not be protected depending on the state of the product (malfunction, damage, getting wet, etc.).

- 51 -

You are recommended to back up your data before updating software.

- If software update has failed or stopped, update the software again.
- Update is unavailable during international roaming.

**Do not conduct the following operations during software update.**

- Do not move this product during software update.

**The following operations are not available during software update**

- Operations are not available during software update. Calls to 110 (Police), 119 (Fire department or ambulance service), 118 (Japan Coast Guard) and 157 (Customer Service Center) are also not available. Also, alarm, etc. cannot be used.

**When software update is not available, etc.**

- If you fail to update software, it may become impossible to operate the product. In that case, bring the product to an au shop or PiPi (not accepted by some shops).

- 52 -

- Home key  
Displays home screen.
- Task key  
Displays a list of active applications. Touch and hold to configure settings.

**memo**

- When you tap an icon to use its functions, communication fee may be charged depending on the function.

- 32 -

#### LED Notification

LED notification informs charging prompt, battery level while charging, missed calls, etc. by lighting on or flashing.

LED color and movement	Description
Flashing red	Indicates that it is charging.
Flashing green	Indicates incoming call, missed call, notification message.
Lighting green	Indicates that charging is complete.
Flashing rainbow	Indicates that an alarm is sounding.

#### Checking Your Phone Number

- On the home screen ► Touch and hold " **[ ]** " ► "System settings" ► "General" tab ► "About phone" ► "Status"  
Status screen appears and your phone number is shown in My phone number field

**memo**

- For details on making/receiving a call, refer to "Setting Guide".

- 39 -

### Introduction of Related Accessories

- Battery pack (LGV32UAA)
- Back cover (LGV32TNA/LGV32TWA/LGV32TKA/LGV32TFA/LGV32TTA)
- LG TV antenna cable O1 (O1LGHSA)
- au Carrying Case G Black (O1O6FCA) (sold separately)
- AC Adapter (sold separately)
  - Common AC adapter O3 (O3O1PGA)
  - Common AC adapter O3 Navy (O3O1PBA)
  - Common AC adapter O3 Green (O3O1PGA)
  - Common AC adapter O3 Pink (O3O1PPA)
  - Common AC adapter O3 Blue (O3O1PLA)
  - Common AC adapter O5 (O5O1PWA)
  - AC Adapter JUPITRIS (White) (LO2P001W)
  - AC Adapter JUPITRIS (Red) (LO2P001R)
  - AC Adapter JUPITRIS (Blue) (LO2P001L)
  - AC Adapter JUPITRIS (Pink) (LO2P001P)
  - AC Adapter JUPITRIS (Champagne Gold) (LO2P001N)
- Common DC adapter O3 (O3O1PEA) (sold separately)

- 46 -

#### Downloading and Updating Software

- On the home screen ► Touch and hold " **[ ]** " ► "System settings" ► "General" tab ► "About phone" ► "Update Center" ► "Software Update"  
When you use the product for the first time, a screen confirming software updates appears. Check the content and tap "AGREE".
- "Check now for update"  
Check if there is new software. Software update screen is displayed when software updates available.

- Select a communication method to download software.
- "DOWNLOAD"  
A new software download starts.
- "INSTALL NOW"  
Software update starts. The product will restart a couple of times during the software update.
- "OK"

- 53 -

### Using the Home Screen

#### Changing Desktop

Desktops can be switched by sliding/flicking to left or right.



**memo**

- Thumbnails can be displayed by pinching in on the home screen to add/delete desktop, change order etc.

- 33 -

### Setting Silent Mode

Set Silent mode (Sound profile) not to inconvenience people around you in a public place.

- Open the Notifications panel ► "Sound"/"Vibrate"

### Setting Airplane Mode

When Airplane mode is set, wireless functions are disabled (telephone, packet transmission, wireless LAN (Wi-Fi®), Bluetooth®).

- Power key (Press and hold for more than 2 seconds) ► "Turn on Airplane mode" ► "OK"

### Entering Text

Use the software keyboard to enter characters. To display the software keyboard, tap a character input box in the character input screen when adding contacts, creating a message, etc.

- 40 -

**memo**

- microUSB cable (sold separately)
  - microUSB cable O1 (O3O1HVA)
  - microUSB cable O1 Navy (O3O1HBA)
  - microUSB cable O1 Green (O3O1HGA)
  - microUSB cable O1 Pink (O3O1HPA)
  - microUSB cable O1 Blue (O3O1HLA)
- Portable Charger O2 (O3O1PFA) (sold separately)
- The Portable Charger O2 (sold separately) may not be able to sufficiently charge the product.
- For the latest information on accessories, visit the au homepage (<http://www.au.kddi.com/>) or contact the Customer Service Center.
- This product does not support ASYNC/Fax transmission.
- You can purchase accessories on this page from au online shop. Some accessories may not be purchased due to the availability. <http://auonlineshop.kddi.com/>

### After-sales Service

**■ When asking for repair**  
For repair, contact a Keitai Guarantee Service Center.

During the warranty period	Repairs will be done based on the terms of services of the free-of-charge repair warranty described on the warranty card.
Outside the warranty period	We shall repair the product for a charge as requested by the customer if repair renders it usable.

**memo**

- Before handing in the product for repair, make a backup of the contents of memory since they may disappear during repair. Note that the Company shall not be liable for any damages and loss of income should the contents of memory be altered or lost.
- Recycled parts that meet the Company's quality standards are sometimes used for repair.
- Collected au cell phones by Replacement cell phone delivery service which you used before are recycled to cell phones for replacement after repairs. Also replaced parts by au after-sales service are collected and recycled by KDDI. They are not returned to customers.

- 54 -



- If this unit is machined, altered, analyzed (including software modifications and analysis (including rooting) reverse engineering, decompiling, and reverse assembling) or is repaired by a repair facility that is not an au-specified official repair facility may not be covered by warranty or eligible for repair.

#### ■ Performance parts for repair

The Company retains performance parts for repair of main unit and its peripherals for 4 years after discontinuation of production. "Performance parts for repair" refers to parts required for maintaining the functions of the product.

#### ■ Warranty card

At the store of purchase, thoroughly check and read the name of the retailer, date of purchase and other necessary details filled in on the warranty card, and be sure to keep it in a safe place.

#### ■ Keitai Guarantee Service Plus LTE

An after-sales service membership program on a monthly basis called "Keitai Guarantee Service Plus LTE" (monthly fee: 380 yen, tax excluded) is available for using your au cell phone for a long time without worries. This service expands coverage for many troubles including malfunction, theft and loss. For details of this service, refer to au homepage or contact a Keitai Guarantee Service Center.

#### memo

- You can apply for membership only at the time of purchasing your au cell phone.
- Once you cancel the membership, you cannot re-apply for it until you purchase an au cell phone next time.
- Note that when changing the model or purchasing an extra cell phone, this service only covers the most recently purchased au cell phone.
- When an au cell phone is handed over to you or someone else, the Keitai Guarantee Service Plus LTE membership is also handed over to the successor of the cell phone.

- When you get a new au cell phone by changing the model or purchasing an extra cell phone, the "Keitai Guarantee Service Plus"/"Keitai Guarantee Service Plus LTE" membership for the old au cell phone is automatically canceled.

- Service contents are subject to change without notice.

#### ■ au Nano IC Card Q4

The au Nano IC Card Q4 is lent to you by au. In case of loss or damage, the card will be replaced at your expense. When a malfunction is suspected, or in case of theft or loss, contact an au shop or PiPiT.

#### ■ After-sales Service

If you are unsure about anything regarding after-sales service, contact the following service contact. **Customer Service Center (for service canceling procedure in case of loss or theft)**

From a land-line phone, ☎ **0077-7-113** (toll-free)

From an au mobile phone, **113** without area code (toll free)

Business hours 24-hour (7 days a week)

#### Keitai Guarantee Service Plus (for loss, theft, damage)

From a land-line phone/From an au cell phone,

☎ **0120-925-919** (toll free)

Business hours 9:00 ~ 9:00 PM (7 days a week)

**Repair service from online (24 hours a day over the Internet)**

\* Reception only from PC or smartphone

[https://cs.kddi.com/support/n\\_login.html](https://cs.kddi.com/support/n_login.html)

- The Application for the Internet acceptance, if "damage", "wet", "theft" and "loss" are eligible. In the case of spontaneous failure (not the cause damage, such as water wet, but does not power on, the screen does not function or other), it will be accepted by phone for interview is required.

- To apply for the Internet, you need the e-mail address.

#### ■ au after-sales service information

Service Contents			Keitai Guarantee Service Plus LTE	
			Member	Nonmember
Replacement cell phone delivery service	Spontaneous failure	1st year	Free	N/A
		2nd year or later	Customer charge 1st: 5,000 yen	
	Partial damage, water stained, irreparable damage, theft, or loss		2nd: 8,000 yen	

Service Contents			Keitai Guarantee Service Plus LTE	
			Member	Nonmember
Holding over and repair	Spontaneous failure	1st year	Free	Actual cost
		2nd year or later	Free of charge (3-year warranty)	
	Partial damage	Customer charge Upper limit: 5,000 yen		
	Water stained, irreparable damage	Customer charge 10,000 yen		
	Theft, loss		N/A	N/A (model change)

\*Charge amounts are all tax excluded.

#### memo

#### Replacement cell phone delivery service

- When you have trouble with your au cell phone, a replacement cell phone (same model, same color, including new battery) is delivered to the specified place by calling to. Return your damaged cell phone within 14 days after the replacement cell phone is delivered.

- Available up to twice in a year from the day you use this service as a start day. If you do not use this service in the past year for the subscription to this service, it will be 1st time and if you use, it will be the 2nd.

\* For details, refer to au homepage.

#### Holding over and repair

- Damages and malfunctions intentionally caused by the customer as well as those due to modification (e.g. disassembly, change of parts, painting, etc.) by the customer are not covered by this service.

- You cannot receive a refund for the replacement of the outer casing due to stains, scratches, paint removal, etc. on the outer casing.

- 55 -

## Unlocking the SIM lock

You can unlock the SIM lock for this product. If you unlock the SIM lock, you can use other carrier's SIM cards.

- The au homepage and au shops are accepting requests to unlock the SIM lock.
- If you use another carrier's SIM card, some services and functions may be restricted. Note that au does not guarantee any operations.
- To unlock the SIM lock, go to home screen ► Touch and hold "□" ► "System settings" ► "General" tab ► "About phone" ► "SIM card".
- For more details, refer to the au homepage.

- 56 -

## TV Antenna Cable

When watching TV, connect the supplied LG TV antenna cable O1 to the product.

Also, connect the commercial earphone to the LG TV antenna cable O1 to listen to the TV's audio.

The connection procedures for the LG TV antenna cable O1 are described here.

**1 Insert the commercial earphone plug into the LG TV antenna cable O1 earphone jack**

**2 Insert the LG TV antenna cable O1 connection plug into this product's earphone jack**

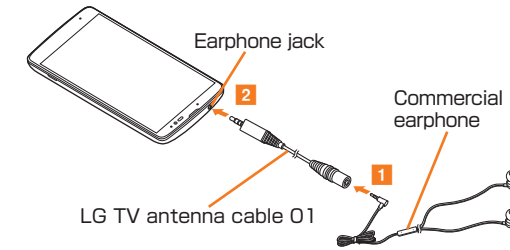

- 63 -

- 57 -

## Main Specifications

Display	Approx. 5.5 inches, Approx. 16.77 million colors, AH-IPS liquid crystal 2560 x 1440 dots (WQHD)
Weight	Approx. 150 g (including battery pack) <sup>1</sup> / Approx. 151 g (including battery pack) <sup>2</sup>
Size (W x H x D)	Approx. 76 mm x 150 mm x 10.3 mm (thickest part 11.3 mm) <sup>1</sup> / Approx. 76 mm x 150 mm x 10.5 mm (thickest part 11.3 mm) <sup>2</sup>
CPU	MSM8992:(1.8 GHz x 2 ea) + (1.4 GHz x 4 ea)
Memory (Internal)	ROM : 32 GB, RAM : 3 GB
Continuous calling time	In Japan Approx. 1,300 minutes Overseas (GSM) Approx. 870 minutes
Continuous standby time <sup>3</sup>	In Japan Approx. 380 hours Overseas (GSM) Approx. 400 hours

- 64 -

- 58 -

Continuous tethering time	Approx. 500 minutes	
Number of concurrent connections with tethering	13 devices (Wi-Fi® tethering: 8, Bluetooth® tethering: 4 and USB tethering: 1)	
Charging time	AC adapter	Approx. 110 minutes (When using Common AC adapter O5 (sold separately))
	DC adapter	Approx. 630 minutes (When using Common DC adapter O3 (sold separately))
Continuous watching time <sup>4</sup>	Full Seg	Approx. 5 hours 10 minutes
	1Seg	Approx. 5 hours 50 minutes

\*1 When the back cover is mounted (White, Champagne, Black).

\*2 When the back cover is mounted (Leather black, Leather brown).

\*3 Continuous standby times are measurements in a static state.

\*4 Continuous viewing time may change depending on the usage condition.

- 65 -

- 59 -

#### memo

- The continuous talk time and continuous standby time may drop to less than half depending on the battery charging status, usage environment such as temperature, reception condition at the location where the product is used, and the function settings.

- 66 -

- 62 -

- 60 -

- 61 -