

Setup Guide

Read this to connect and configure the product

WiMAX HOME 01

Technically Certified

Preface
Thank you for buying the WiMAX HOME 01 (simply called the "product" from here on). Before using the product, be sure to read the "Notes on usage" (on the next page) to ensure correct use.

List of Packaged Items

Before you start using the product, make sure that you have all the following items packaged with the product.

- WiMAX HOME 01 (main unit)
- WiMAX HOME 01 AC adapter (AL1-004259-003)



- つなぎガイド "Setup Guide" (with warranty) (Japanese)
- 「らくらくQRスタート」用QRコード"QR Code (sticker) for 'Rakuraku QR Start'" (Japanese)

* Keep the packaged items, including the warranty, in a safe place.
* Ethernet cable is not included. Use one that is commercially available.
* The illustrations of the product used in this manual are simulated images. They may differ from the actual product.

About the Instruction Manual

The "Setup Guide" (this manual) explains only the main operations and settings of the main functions for using this product. As an instruction manual related to the product, the "Setup Guide" (this manual) and "取扱説明書 詳細版 (Full Instruction Manual)" (Japanese) are available for download from the WiMAX Support Information website. In this manual, all such manuals are collectively referred to as the "Instruction Manual".
* A PDF version of the "取扱説明書 詳細版 (Full Instruction Manual)" (Japanese), in which the explanations of various functions are described in detail, is also included with this product.
Connect the product to a PC or the like by means of wireless LAN (Wi-Fi*) or an Ethernet cable, launch the web browser, type "http://192.168.179.1/" in the address field and log in to the Advanced Settings on Quick Setting Web (page for PC) to view (情報 (Information)), and access (メニュー) (Manual).
* The PDF versions of the "Instruction Manual" can be downloaded from the au website.
https://www.au.com/support/service/mobile/guide/manual/
* The PDF versions of the "Instruction Manual" can also be downloaded from the WiMAX Support Information website.
https://www.necplatforms.co.jp/support/wimax/wh01/index.html (in Japanese only)

About the Notations in This Manual

- Notes on Illustrations / Screenshots**
- The screenshots and methods of operation in this manual are those when an au Nano IC Card 04 LE is inserted.
- The illustrations and screenshots in this manual are simplified and may look different from the actual illustrations and screens. Also, a part of a screen may be omitted.
- In this manual, the "au Nano IC Card 04 LE" is referred to as an "au IC card".
- In this manual, the "WiMAX HOME 01 AC adapter" is referred to as an "AC adapter".
- Company names and product names referred to in this manual are trademarks or registered trademarks of their respective companies. TM and the ® mark may be omitted in this manual.

Setting up the product

Possible Uses for the WiMAX HOME 01

Connect via Wireless LAN (Wi-Fi*)
This manual explains how to connect the product to a smartphone or computer using wireless LAN (Wi-Fi*). A maximum of 20 devices can be connected (10 devices each in 2.4 GHz band and 5 GHz band).

Connect Using an Ethernet Cable (Commercially Available)
* You can use both wireless LAN (Wi-Fi*) and wired LAN simultaneously. By using both, a maximum of 22 devices can be connected.

* Depending on the connection environment, communication speeds may not reach the maximum. Furthermore, depending on the connected devices or games, some online competitive games may not operate normally.

Preparations

Before using the product
The product can transmit data by using the WiMAX 2+ system or the LTE system. You can select from the following communication modes to use this.

	High Speed	High Speed Plus Area
WiMAX 2+	○	○
LTE	○	○

* For an explanation of how to select and set the communication modes, see "Button Operations" in this manual.
* The default setting is "High Speed" mode. Note that an additional charge may be incurred, depending on your billing plan, when you switch to "High Speed Plus Area" mode.

About the Installation Location

- Install the product in a location where there is nothing, such as walls or other devices, within 5 cm of the front, back, right, or left, or within 5 cm of the top of the product.
- Install the product so it is possible to see the state of the Tail Lamp, Mode Lamp, Update Lamp, and Status Lamp on the front of the product.
- Locations in which 4 of the Tail Lamps light green (reception level: strength 4) are locations that have high signal reception strength. (Refer to "Main LED Lamp Displays")

We recommend installing the product in a location that has the highest signal reception strength for good communication.

* You can use the 電波インジケータ (Reception level indicator) in the smartphone application "NEC WiMAX 2+ Tool" to confirm signal levels in more detail to find better installation locations.

Downloading the "NEC WiMAX 2+ Tool" Application for Your Smartphone

- By using "NEC WiMAX 2+ Tool", an application designed especially for this product, you can connect the product to your smartphone, etc. by wireless LAN (Wi-Fi*) and check information about the product.
- Download "NEC WiMAX 2+ Tool" from the Google Play Store or the App Store.

<Google Play Store>

<App Store>

(As of March, 2019)

* The "NEC WiMAX 2+ Tool" smartphone application has a Japanese user interface.

Part Names and Functions

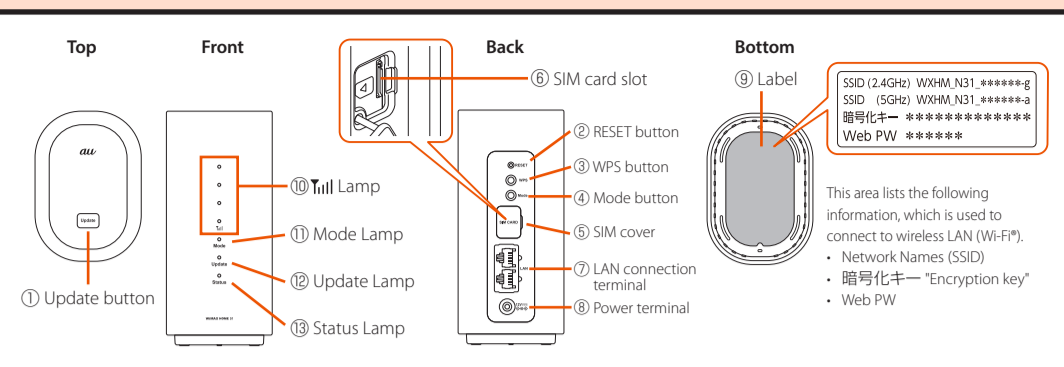

Name	Function
① Update button	Use to update the firmware.
② RESET button	Returns the settings to their factory settings.
③ WPS button	Use to connect WPS compatible devices to wireless LAN (Wi-Fi)*.
④ Mode button	Use to switch communication modes.
⑤ SIM cover	Open the SIM cover to access the SIM card slot. This cover is normally closed during use.
⑥ SIM card slot	Insert the au IC card into this slot.
⑦ LAN connection terminal	Connect computers and other devices to this terminal using an Ethernet cable (commercially available).
⑧ Power terminal	Connect the AC adapter to this terminal.
⑨ Label	You can check the Network Names (SSID), 暗号化キー "Encryption key", Web PW, and IMEI. Do not remove this label.

Main LED Lamp Displays

The LED lamps light in different colors and patterns to notify you of the state of the product. The main LED lamp displays are described below.

Lamp	Color and lighting pattern	Explanation
⑩ Tail Lamp	● Lights green (strength 1 to 4) ● Off	Indicates the signal reception strength of WiMAX 2+/LTE in 4 levels Indicates the product is outside the service area or that WiMAX 2+/LTE is not connected
⑪ Mode Lamp	● Lights orange ● Lights green ● Lights orange	Indicates excessive amount of data transmission Indicates High Speed mode Indicates High Speed Plus Area mode*
⑫ Update Lamp	● Lights orange	Indicates there is new firmware
⑬ Status Lamp	● Off ● Lights green ● Lights orange → ● Lights orange (slowly) ● Lights red	Indicates the newest firmware has been installed Indicates the product is operating normally Indicates the product is starting up (Changes from lit to flashing orange) Indicates that WiMAX 2+/LTE is outside the service area
	●●●● Flashes red (slowly)	Indicates an au IC card is not inserted or the APN settings are incorrect

*1 Note that a separate designated additional charge may be incurred when you switch to High Speed Plus Area mode.

Button Operations

The buttons on the product are used to switch communication modes, update firmware, and do other operations.

- Switching communication modes**
[Mode] button
Used to switch communication modes.

Mode button	Mode Lamp	Operation
Hold down for at least 2 seconds	● Lights green	Switches to High Speed mode
	● Lights orange	Switches to High Speed Plus Area mode

* Approximately 10 seconds after the Mode Lamp changes, the Tail Lamp lights.
* Note that a designated additional charge may be incurred when you switch to High Speed Plus Area mode.
- Updating the Firmware**
[Update] button
Used to start updates when there is new firmware.

Update button	Update Lamp	Operation
—	● Lights orange	There is new firmware
Hold down for about 5 seconds	●●●● Flashes orange (slowly)	Currently updating
—	● Lights green	Restarts automatically after updates are complete

You can also update firmware from Quick Setting Web.
* Operating procedure: [Maintenance] - [Update firmware] - (for PC page, [online version url]) - [Confirmation/Update]
- Connecting to WPS compatible wireless LAN (Wi-Fi*) device**
[WPS] button
Connecting to WPS compatible wireless LAN (Wi-Fi*) device.

WPS button	Status Lamp	Operation
Hold down for about 2 seconds	●●●● Flashes green (fast)	Connecting via WPS to 2.4 GHz band compatible device
Hold down for at least 5 seconds	●●●● Flashes green (slowly)	Connecting via WPS to 5 GHz band compatible device
	● Lights green	Connection via WPS complete
- Initializing**
[RESET] button
When the product is not operating properly, or to bring back the initial settings, perform initialization.
* All of the settings you made since purchasing the product will be deleted. This function should only be used after careful consideration.
 - Use something with a thin tip to press and hold the RESET button for about 5 seconds. Stop when the Tail Lamp on the front of the main unit turns off. All of the LED lamps turn off after about 20 seconds, and the product restarts.

You can also do initialization from Quick Setting Web.
* Operating procedure: [Maintenance] - [Initialization] - [Initialization] - [OK]

Advance preparations

Insert the au IC Card

- Confirm that the product is turned off. Also, disconnect the Ethernet cable if one is connected to the product.
- Open the SIM cover on the back of the product. Use your finger (or fingernail, etc.) to hook the concave part along the right side of the SIM cover and pull it open.
- Hold the au IC card so the notch is facing downward, and then insert it straight into the card slot until you hear a click.
 - Face the IC (metal) part of the au IC card to the right when you insert it.
 - The au IC card locks.
- Close the SIM cover.
 - Your telephone number and other details are stored on the au IC card.
 - This product supports au Nano IC Card 04 LE.
 - Data communication via a Wide Area Network (WAN) cannot be done if the au IC card is not inserted.
 - Confirm the correct inserting direction of the IC card. Failure to do so might cause a malfunction or damage.
 - Do not insert or push the IC card forcefully. Doing so might cause a malfunction or damage.
 - Refrain from inserting an SD card or IC card with a conversion adapter. Doing so might cause failures.
 - Be careful not to touch or damage the IC (metal) part of the au IC card.
 - The Status Lamp flashes red (slowly) if the au IC card is not properly inserted, or if there is an abnormality with the au IC card.

Turn the Power On

The product does not have a power button. To turn on the power, connect the AC adapter to the product, and then plug the power plug into a power outlet.

- Connect the DC plug of the AC adapter to the power terminal of the product. Insert it straight and securely all the way in.
- Plug the power plug of the AC adapter into a 100 VAC power outlet.
 - During startup, the Status Lamp lights orange, after about 15 seconds the Mode Lamp lights green and the Status Lamp flashes orange (slowly).
 - When startup is normal, the Tail Lamp, Mode Lamp, and Status Lamp light green.

Confirm that this product has the latest firmware.
* The latest firmware is available when the Update Lamp lights orange. (Refer to "Button Operations")

STEP 1 Connecting to Wireless LAN (Wi-Fi®)

Refer to "POINT I Do Wireless LAN (Wi-Fi®) Connections via Manual Settings" on the next page to do connection settings manually.

To Connect by Using the Wi-Fi Settings Moving Function

You can carry over to the product the settings for a wireless LAN (Wi-Fi*) router that you used in the past by using the "Wi-Fi Settings Moving" function. This way you do not need to redo the wireless LAN (Wi-Fi*) settings.

- The settings that are moved are the SSID, encryption mode, and the encryption key.
- Frequency bands: Settings can be done for the 2.4 GHz band and the 5 GHz band.
- The router you have used in the past needs to have supported WPS. In addition, some of the wireless LAN (Wi-Fi*) settings may not carry over, depending on the functions and settings (such as unusable text or encryption mode) of the router you were using in the past.

- Turn the product off. Pull the DC plug of the AC adapter straight out of the power terminal on the back of the main unit.
- Press the WPS button on the back of the main unit as you turn on the power to the product, and keep pressing the WPS button (for about 15 seconds).
- Confirm that the Status Lamp lights green. Wi-Fi Settings Moving has failed if the Status Lamp flashes orange (fast) for about 5 seconds in step 2. If you do the settings again and they still fail, the WPS function, which is used for Wi-Fi Settings Moving, may not be compatible, so connect the wireless LAN (Wi-Fi*) manually.
- Decide the frequency band (2.4 GHz band or 5 GHz band) for Wi-Fi Settings Moving.
- Start up the WPS function of the router you were using previously. (Refer to the user manual of the router you have been using so far, for the method to start up the WPS function.)
- Press and hold the WPS button on the product again (select the frequency band by how long you press the button). Release the button when the Status Lamp starts flashing green (fast or slowly).

When the Mode Lamp on the front of the main unit flashes green (slowly), release the WPS button. Wait until the Status Lamp lights green.

Wi-Fi Settings Moving has failed if the Status Lamp flashes orange (fast) for about 5 seconds in step 2. If you do the settings again and they still fail, the WPS function, which is used for Wi-Fi Settings Moving, may not be compatible, so connect the wireless LAN (Wi-Fi*) manually.

- You can confirm if the SSID is the SSID of the router you have used until now, by opening Quick Setting Web and going to [Wi-Fi Settings] - [Wi-Fi Access Point Settings (parent device)] - "Network Name (SSID)".

Space to stick the 「らくらくQRスタート」用QRコード"QR Code (sticker) for 'Rakuraku QR Start'"

You can stick the 「らくらくQRスタート」用QRコード"QR Code (sticker) for 'Rakuraku QR Start'" packaged with this product in the location described in the enclosed つなぎガイド "Setup Guide" (Japanese).

(Memo)

Frequency band	SSID	Encryption key (password)
2.4 GHz band		
5 GHz band		

* Write the items down in the location described in the enclosed つなぎガイド "Setup Guide" (Japanese).

Connecting to wireless LAN (Wi-Fi*) is complete. Open a web browser on a device that is connected to the product by wireless LAN (Wi-Fi*) and open a website to verify connection to the internet. If you want to change the administrator password in Quick Setting Web, go to STEP2.

Remove the au IC Card

- Disconnect the AC adapter and Ethernet cable, if they are connected to the product.
- Open the SIM cover on the back of the product. Use your finger (or fingernail, etc.) to hook the concave part along the right side of the SIM cover and pull it open.
- Slowly push the au IC card inward until it clicks, after you hear the click, bring the au IC card outward with your finger. This releases the lock and the au IC card comes out a little against your finger. Note that the au IC card may pop out if you press the card in forcefully and then quickly release your finger.
- Slowly extract the au IC card. Slowly extract the au IC card straight out. * Be careful that you do not pull the card out forcefully while it is still locked.
- Close the SIM cover. * Be careful not to lose the au IC card after you remove it.

Turn the Product Off

- Pull the power plug of the AC adapter straight out of the power outlet.
- Pull the DC plug of the AC adapter straight out of the product.

STEP 2 Doing the Initial Settings

You Can Also Do Initial Settings from Quick Setting Web

We recommend changing the password. (Initial password setting: "Web PW" on the label on the bottom of the product)

- Open a web browser on a wireless LAN (Wi-Fi*) device (such as a smartphone) that was connected to the product in STEP1.
- Open Quick Setting Web for the product. Type "http://192.168.179.1/" into the address bar in the web browser and either tap (実行 (Execute)) or (開く (Open)), or press the Enter key on the keyboard.

http://192.168.179.1/

<< Example of Google Chrome's screen for mobile phones >>
On the top page, click or tap (English) to switch the screens that follow the sign-in screen (step 4) to English screens.
- Tap or click (Advanced Settings Top) in the screen of Quick Setting Web.

Administrator Password Memo

Write it down in the location described in the enclosed つなぎガイド "Setup Guide" (Japanese).
- Type "admin" for the (Username), "Web PW" (*) for the (Password), and then tap (SIGN IN) or click (OK).

* Refer to the 「らくらくQRスタート」用QRコード"QR Code (sticker) for 'Rakuraku QR Start'" or to the label on the bottom of the product for the "Web PW".
- If you agree to the request in "We kindly ask for your cooperation", tap or click (YES).
- If the "About Strengthening Wi-Fi encryption" message appears, tap or click (YES). (If you select (YES), the Protected Management Frame function is turned off).

Using the "NEC WiMAX 2+ Tool" Application for Your Smartphone

Start up the "NEC WiMAX 2+ Tool" application for your smartphone to switch communication modes and check the version of your firmware.

* The "NEC WiMAX 2+ Tool" smartphone application has a Japanese user interface.

Do the following settings if you started the "NEC WiMAX 2+ Tool" application for the first time and connected to Wi-Fi* in some way other than a smartphone application in STEP1.

- Tap (はい (Yes)) in the "Wi-Fi暗号強化機能について (About Strengthening Wi-Fi encryption)" screen. Does not open if (いいえ (No)) has been selected in the Quick Setting Web.

If you selected (いいえ (No)) in step 1, use the method below to set your password. Tap (情報表示 (Information)) - (各種設定 (Various Settings)) - (ログイン管理 (Login Management)), enter your password, and then tap (保存 (Save)).
- In the "パスワードが入力されていません (No password has been input)" screen, tap (OK), and then in the "ログイン管理 (Login Management)" screen, enter the password, and then tap (保存 (Save)).

If you changed the password in Quick Setting Web, the "パスワードの認証に失敗しました (Failed to authenticate password)" message appears. Input a password (administrator password), and then tap (保存 (Save)).

When the "Wi-Fi暗号強化機能について (About Strengthening Wi-Fi encryption)" screen appears, tap (はい (Yes)). (Refer to STEP2 Doing the Initial Settings)

Connection is complete when the Wi-Fi icon appears in the status bar of the smartphone.

