



# GRATINA 4G

## Basic Manual

[Contents](#)

---

[Safety Precautions](#)

---

[Basic Operations](#)

---

[Character Input](#)

---

[Phone](#)

---

[Phone Book](#)

---

[Mail](#)

---

[LINE](#)

---

[Internet](#)

---

[Camera](#)

---

[TV\(1Seg\)](#)

---

[Settings](#)

---

[Appendix](#)

---

## Preface

Thank you for buying the "GRATINA 4G" (simply called the "product" from here on).

Before using the product, be sure to read the "Basic Manual" (this manual) and "Setting Guide" available on the au homepage to ensure correct use. After you have finished reading the manuals, be sure to keep them accessible. Also, store the printed manuals ("取扱説明書" (Basic Manual) and "設定ガイド" (Setting Guide)) in a safe place so that you can refer to them whenever you need them. If you lose them, contact an au shop or Customer Service Center.

## List of Packaged Items

Before you start using the product, make sure that you have all the following packaged items with the product.



Main unit

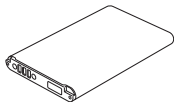

Battery Pack  
(KYF31UAA)

- 取扱説明書 (Basic Manual) (Japanese)
- 設定ガイド (Setting Guide) (Japanese)
- 本体保証書 (Warranty for the main unit) (Japanese)

The following items are not included in the package.

- Desktop holder (KYF31PUA)
- microSD memory card
- AC adapter
- Earphone
- 3.5mm microUSB conversion adapter 01 (0301QNA)
- microUSB cable



### memo

- Purchase a specified charger (sold separately).
- Illustrations of cell phones in this manual are only for reference. They may look different from the actual product.

## Operating Instructions

### ■ "取扱説明書" (Basic Manual) and "設定ガイド" (Setting Guide)

The "Basic Manual" (this manual) and "Setting Guide" available on the au homepage describe basic operations of major functions.

For detailed descriptions of various functions, refer to the "Full Instruction Manual" (Japanese) available on the au homepage:

<http://www.au.kddi.com/support/mobile/guide/manual/>

- Company names and product names referred to in this manual are trademarks or registered trademarks of the respective companies.

## When Using the Product

- Before you start using the product, be sure to read the "Safety Precautions" to ensure correct use.
  - Before you assume that the product is malfunctioning, check for possible remedies in the following au Customer Support site of au homepage:  
**<http://www.au.kddi.com/english/support/>**
  - Communication is not possible even inside the service area in places where the signal does not reach (e.g. tunnels and basements). Also, communication may not be possible in poor reception areas. Communication may be interrupted if you move into a poor reception areas during communications.
  - Since this product uses radio waves, the possibility of communication intercepts by third parties cannot be eliminated (though the LTE/GSM/UMTS system has highly secure confidential communication features).
  - VoLTE (LTE network) by au is used when connecting with emergency organizations within Japan. You cannot connect using 3G (circuit-switched network).
  - The product is compatible with the international roaming service. Each network service described in this manual varies depending on the area and service content.
  - Since the product is a radio station under the Radio Law, you may be asked to temporarily submit the product for inspection in accordance with the Radio Law.
  - The IMEI information of your cell phone is automatically sent to KDDI CORPORATION for maintenance and monitoring operational status of your cell phone.
  - If you are using the product overseas, check the relevant laws and regulations of the country/region you visit beforehand.
- The Company is not liable for any damages arising from earthquakes, lightning, storms, floods or other natural disasters, as well as fires, actions by third parties, other accidents, intentional or mistaken operation by the customer, or use under other unusual conditions outside the responsibility of the Company.
  - The Company is not liable for any incidental damages (change/disappearance of saved content, loss of business income, disruption of business, etc.) arising from use of or inability to use the product.
  - The Company is not liable for any damages arising from failure to observe the described content of this manual.
  - The Company is not liable for any damages arising, for example, from malfunction caused by combination with connected devices or software not related to the Company.
  - Captured photo data or downloaded data may sometimes be altered or lost due to faults, repair or other handling of the product. The Company is not liable for any damage or lost income resulting from recovery of these data.
  - It is recommended you keep a copy of important data on your PC's hard disk, etc. Whatever the cause of the defect or malfunction may be, the Company assumes no responsibility for alteration or loss of saved data.
  - Contents saved in the product, such as contacts, mails and favorites might be altered or lost by an accident, fault, repair or mishandling. Be sure to keep a copy of important contents. Note that the Company assumes no responsibility for any damages or lost profits resulting from altered or lost contents.
  - Note that content data (both charged or free content) saved on the product cannot be returned to the customer when the product is replaced for repair of a fault, for example.
  - The product uses liquid crystal for its main display. The main display response speed may become slow when the ambient temperature is low, which is due to the characteristics of liquid crystal and is not a malfunction. The main display response speed will return to normal at room temperature.

- Although the main display used on the product is made using high-precision technology, some pixels (dots) might be lit or out at all times. This is not a malfunction.
- You are recommended to store copies of individual data such as photos/movies you took and music in your PC by sending each file as mail attachment, etc. Note, however, that you may not be able to make copies of some copyrighted data even by the abovementioned means.
- Do not discard the product together with regular trash. Please cooperate in the collection of the product when it is no longer needed to protect the environment and effectively use resources. Old products are collected at au shops and other places.
- \* "The Company" as appears in this manual refers to the following companies:  
Sold by: KDDI CORPORATION, OKINAWA CELLULAR TELEPHONE COMPANY  
Manufactured by: KYOCERA Corporation



### memo

- Reproduction of the content of this manual in part or in whole is prohibited.
- The content of this manual is subject to change without notice.
- Every effort has been made in the preparation of this manual. Should you notice any unclear points, omissions, etc., feel free to contact us.

## Cell Phone Etiquette

### ■ Use of cell phones is not allowed in the following places!

- Do not listen to music, watch videos or TV (1Seg) while driving a car or motorbike, or riding a bicycle. Use of cell phones while driving a car or motorbike is prohibited by law. (Use of cell phones while riding a bicycle may also be punishable by law.) In addition, stay alert to the traffic around you even when walking. Surrounding sounds might not be heard clearly, and gazing at the screen may distract your attention causing a traffic accident. Be especially careful at railroad crossings, station platforms and pedestrian crossings.
- Since using the product on airplanes is restricted, follow the instructions given by the respective airlines.

### ■ Be considerate of people around you

- Do not make calls in theaters, museums, libraries, and other similar places. Turn power off or turn on manner mode so as not to disturb others around you with your ringtones.
- Do not use the cell phone outside in town where you might hinder other pedestrians.
- Viewing a cell phone screen while walking is a serious hazard. Do not suddenly stop to talk on/operate the cell phone or do so while walking.
- Move to areas where you will not inconvenience others on bullet trains, in hotel lobbies, etc.
- Refrain from talking in a loud voice.
- Be careful of sound leakage from earphones in trains or other places with many people around you.
- Obtain the permission of other people before you take their photos with the cell phone's camera.
- Some people close to you in crowded places such as packed trains may be using a cardiac pacemaker. Turn on "Airplane mode" or turn the cell phone off in such places.
- Abide by the rules of hospitals and other medical institutions where it is forbidden to use or carry cell phones.

## Illustrations and Descriptions in This Manual

### Note on Key Illustrations

In this manual, the key illustrations are simplified as shown below.

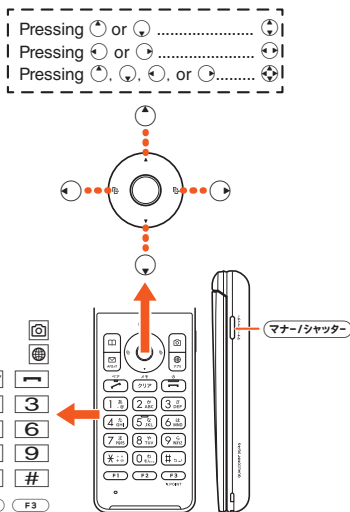

### Description of Operations for Selecting Item/Icon/Key etc.

In this manual, step descriptions for selecting a menu item/icon/on-screen button/etc. with or and then pressing (OK/Check/Set/Commit/Done) are abbreviated as [Operation].

**Example: To edit phone book contacts**

**1** When the standby screen is displayed, press → **Select contact to edit** → (Menu) → [Edit]

Indicates to select "Edit" with and commit with .

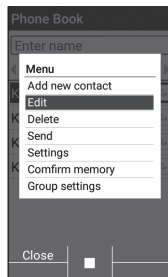

### memo

© For details on key operation, refer to "Learn Basic Key Operations" (▶P.49).







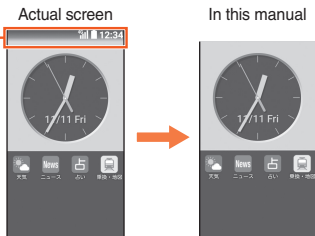

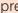

## ■ Notes on Screenshots

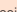
The illustrations and screenshots in this manual are simplified and may look different from the actual product or screens. Also, part of the screen etc. may be omitted.

In this manual, part of the screen such as icons are omitted.

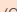

## memo

- This manual displays screens and describes operation assuming an au Nano IC Card 04 is installed.
- In this manual, keys, screenshots, and icons are described based on default settings of the product with the body color "GREEN". However, actual keys, screenshots, and icons may differ or be partially omitted.
- Content at the bottom of the screen that can be operated by pressing , , , , or  are indicated in parentheses, such as  (Menu).
  - \* However,  (OK),  (Check),  (Set),  (Commit), and  (Done) are abbreviated as  only.
- Menu items, layers and icons described in this manual may be different according to functions being used and conditions.
- In this manual, "microSD™ memory card" and "microSDHC™ memory card" are abbreviated as "microSD memory card" or "microSD".
- All of the indicated amounts exclude tax unless otherwise specified.

## Using au Disaster Countermeasure Application

au Disaster Countermeasure is an application in which you can use Disaster Message Board, Emergency Rapid Mail (Earthquake Early Warning, Disaster and Evacuation Information, and Tsunami Warning), Disaster Voice Messaging Service and Disaster Information.

### 1 When the standby screen is displayed, press → [Security/Safety] → [au災害対策 (au Disaster Countermeasure)]

The au Disaster Countermeasure menu is displayed.

When powering on the product for the first time, agreement to terms of use and an initial settings screen are displayed. Follow the on-screen instructions.

## Using Disaster Message Board

Disaster Message Board is a service to enable customers in disaster areas to register their safety information via LTE NET when large-scale disasters, such as an earthquake whose Japan seismic scale is approximately 6-lower or more, occur. The registered safety information can be checked by customers using au phones, and also from other-brand cell phones, PCs, etc.

For details, refer to "Disaster Message Board Service" on the au homepage.

### 1 From the au Disaster Countermeasure menu, [災害用伝言板 (Disaster Message Board)]

Follow the on-screen instructions for registration/confirmation.



## memo

- To register the safety information, an e-mail address (@ezweb.ne.jp) is required. Set the e-mail address in advance.
- Deletion of the safety information and configurations for Safety Notification Mail are not available during wireless LAN (Wi-Fi®) connection.
- The Company does not guarantee the quality of this service. The Company, regardless of the cause, shall not be liable for any problems related to registration of safety information due to the concentration of access to this service or equipment errors, any loss due to the damage, ruination, etc. of safety information or any loss arising from registered safety information.

## Using Emergency Rapid Mail

Emergency Rapid Mail is a service to collectively deliver Earthquake Early Warning and Tsunami Warning provided by the Japan Meteorological Agency, and Disaster and Evacuation Information provided by the national government or the local governments to au phones in the specified areas.

- At the time of purchase, receiving setting of Emergency Rapid Mail (Earthquake Early Warning, and Disaster and Evacuation Information) is set to "受信する" (Receive). You can receive Tsunami Warning by setting 災害・避難情報 (Disaster and Evacuation Information).

When receiving Earthquake Early Warning, secure your safety and act composedly according to the surrounding situations. When receiving Tsunami Warning, leave sea coasts immediately and evacuate to safe places such as hills and strongly-built tall buildings.

### 1 From the au Disaster Countermeasure menu, [緊急速報メール (Emergency Rapid Mail)]

The inbox is displayed.

Select a mail to check to display the details of the mail.

### 2 設定 (Settings)

緊急地震速報 (Earthquake Early Warning)	<b>受信設定 (Receive settings)</b> Set whether to receive Earthquake Early Warning/Disaster and Evacuation Information, and Tsunami Warning. <b>音量 (Volume)</b> Set the volume of the alert sounds.
災害・避難情報 (Disaster and Evacuation Information)	<b>マナー時の鳴動 (Alert in manner mode)</b> Set whether the product alerts you by manner mode settings when in manner mode. <b>バイブ (Vibrator)</b> Set whether the product vibrates when a warning/information is received.

- Press 確認 (Test) to check the alert tone and vibration.



### memo

- When you receive Emergency Rapid Mail, you will be notified by the dedicated alarm tone and the vibrator. The alarm tone cannot be changed.
  - \* When you receive Earthquake Early Warning, you will be notified by the alarm tone, voice ("地震です" (Jishin-desu) ("Earthquake!")) meaning that an earthquake has occurred and the vibrator.
  - \* When you receive Tsunami Warning, you will be notified by the alarm tone, voice ("津波です" (Tsunami-desu) ("Tsunami!")) meaning that a Tsunami is approaching and the vibrator.
- The alarm tone does not ring if Emergency Rapid Mail is received during a call.
- Earthquake Early Warning notifies areas where a strong shaking (Japan seismic scale 4 or more) is expected when an earthquake whose maximum Japan seismic scale is predicted of 5-lower or more has been detected.
- This service detects an earthquake (P-wave, preliminary tremors) near the seismic center immediately after the earthquake occurs and automatically calculates its location, scale and predicted strength of the shaking. After that, you will be notified of the earthquake as soon as possible within a few seconds to dozens of seconds before a strong shaking from the earthquake (S-wave, principal shock) occurs.
- In the vicinity of the seismic center, a strong shaking may reach you before Earthquake Early Warning.
- Tsunami Warning notifies areas including target sea coasts of Major Tsunami Warning and Tsunami Warning provided by the Japan Meteorological Agency.
- Disaster and Evacuation Information notifies information related to the safety of citizens, such as evacuation advisories, evacuation orders or various alarms delivered by the national government or the local governments.
- This service is available only in Japan (Not available overseas).



- ◎ Emergency Rapid Mail is free of both information charges and communication charges.
- ◎ As for this service, the Company shall not be liable for any damage incurred on the users resulted from failure or delay of information delivery due to communication disturbance or system failure, contents of the information or other problems that are not supposed to be blamed on the Company.
- ◎ For details on Earthquake Early Warning and Tsunami Warning provided by the Japan Meteorological Agency, refer to the agency's homepage.  
<http://www.jma.go.jp/jma/indexe.html>
- ◎ Emergency Rapid Mail cannot be received while the power is turned off.
- ◎ Emergency Rapid Mail may not be received when you are in a place where the signal cannot be received (e.g. tunnels and basements) or the signal is weak, even within the service area.
- ◎ Emergency Rapid Mail which failed to be received will not be able to be received again.
- ◎ The Earthquake Early Warning distribution system provided by this service is different from that provided by TV, radio and other communication media and thus the arriving time of Earthquake Early Warning may be different among those media.
- ◎ Information intended for the areas of other than your present location may be received.

## Using Disaster Voice Messaging Service

Disaster Voice Messaging Service is a service to record voices with a cell phone and deliver them as a voice message to people to whom you want to deliver the information that you are safe when large-scale disasters occur.

### 1 From the au Disaster Countermeasure menu, [災害用音声お届けサービス (Disaster Voice Messaging Service)]

Follow the on-screen instructions.

#### ■ Sending voices (Send)

Select "声をお届け" (Send voices) and then "あて先入力" (Enter recipient) → "声を録音" (Record voices to send).

\* You can also select the recipient from the phone book.

#### ■ Receiving voices (Receive)

You will be notified via a pop-up screen or an SMS that a voice message has been received. You can listen to the message by receiving (downloading) and playing the voice message.

- If the recipient's cell phone does not have an au災害対策 (au Disaster Countermeasure) application activated that supports 災害用音声お届けサービス (Disaster Voice Messaging Service), SMS is sent instead.
- If the receivers are notified via an SMS, the information will not be saved in the au Disaster Countermeasure application.



#### memo

- ◎ To use this service via Wi-Fi®, making initial settings via 4G (LTE) networks is required.
- ◎ Voice messages can be recorded for up to 30 seconds.
- ◎ Voice messages can be exchanged among au cell phones as well as other-brand cell phones and PHS devices.

- ⦿ Voices may not be heard when the media sound volume is set to low or the product is in manner mode.
- ⦿ When no free space is left on the internal memory, voice messages may not be saved or played.
- ⦿ Some cell phones cannot receive voice messages. For details, refer to the au homepage.

## Using Disaster Information

You can check histories of Disaster and Evacuation Information delivered by the local governments, disaster information portal, etc.

**1 From the au Disaster Countermeasure menu, [災害関連情報 (Disaster Information)]**

**2 Follow the on-screen instructions**

## Contents

Preface.....	ii
List of Packaged Items.....	ii
Operating Instructions.....	ii
When Using the Product.....	1
Cell Phone Etiquette.....	2
Illustrations and Descriptions in This Manual.....	3
Using au Disaster Countermeasure Application.....	5
Using Disaster Message Board.....	5
Using Emergency Rapid Mail.....	6
Using Disaster Voice Messaging Service.....	7
Using Disaster Information.....	8
<b>Contents.....</b>	<b>9</b>

## Safety Precautions..... 12

<b>Safety Precautions (Observe Strictly).....</b>	<b>12</b>
<b>Handling Precautions.....</b>	<b>21</b>
Available Security Codes.....	24
PIN.....	25
<b>Notes on Waterproof/Dustproof/Shockproof Properties.....</b>	<b>26</b>
Important Items to Remember before Use.....	26
Tips for Comfortable Use.....	27
<b>Notes on Using the Bluetooth®/</b>	
<b>Wireless LAN (Wi-Fi®) Function.....</b>	<b>32</b>
Cautions on Using the 2.4 GHz Band.....	32
<b>Notes on Packet Communication Charges.....</b>	<b>33</b>
<b>Notes on Applications.....</b>	<b>34</b>

## Basic Operations ..... 35

<b>Names and Functions of Parts.....</b>	<b>35</b>
Smart Sonic Receiver.....	37
<b>Using the Touch Pointer.....</b>	<b>38</b>
Touch Pointer Operations.....	39
<b>Switching the Display Language to English.....</b>	<b>40</b>
<b>Using the Standby Screen.....</b>	<b>41</b>
Using Shortcuts in the Standby Screen.....	41
Editing Widgets in the Standby Screen.....	41
<b>Using the Status Bar.....</b>	<b>42</b>
Icons.....	42
Using the Notification/Settings Panel.....	43
<b>Using the Sub-display.....</b>	<b>44</b>
<b>Using the Main Menu.....</b>	<b>44</b>
Using Applications/Services.....	47
Changing the Main Menu.....	48
Updating LINE.....	48
<b>Using the Custom Menu.....</b>	<b>48</b>
Registering Applications to the Custom Menu.....	48
Rearranging Applications.....	48
Deleting Applications.....	48
<b>Learn Common Operations.....</b>	<b>49</b>
Learn Basic Key Operations.....	49
Using Checkboxes.....	50
<b>Disabling Manner/Shutter Key Operation when the Product is</b>	
<b>    Folded.....</b>	<b>50</b>

## Character Input ..... 51

Learn How to Enter Characters.....	51
------------------------------------	----

<b>Phone</b> .....	<b>54</b>
<b>Making Calls</b> .....	<b>54</b>
Entering a Phone Number and Making a Call .....	54
Using Call Histories and Making a Call .....	55
Using Speed Dial and Making a Call.....	56
Calling Overseas from au Phones (au International Call Service).....	56
<b>Receiving Calls</b> .....	<b>57</b>
Answering an Incoming Call.....	57
Rejecting an Incoming Call.....	58
<b>Using au VoLTE</b> .....	<b>58</b>
Using Voice Party (Optional Service) .....	58
Using the Voice Party Menu .....	59
<b>Checking Your Phone Number</b> .....	<b>60</b>
Checking Your Profile.....	60
Editing Your Profile.....	60
<b>Phone Book</b> .....	<b>61</b>
<b>Registering to the Phone Book</b> .....	<b>61</b>
<b>Using the Contacts List</b> .....	<b>61</b>
Displaying the Contacts List.....	61
<b>Using Information Registered for Contacts</b> .....	<b>62</b>
<b>Mail</b> .....	<b>63</b>
<b>Checking E-Mail</b> .....	<b>63</b>
<b>Sending E-mail</b> .....	<b>66</b>
<b>Receiving E-mail</b> .....	<b>67</b>
<b>Inquiring for and Receiving New Mail</b> .....	<b>68</b>
<b>Sending SMS</b> .....	<b>68</b>
<b>Receiving SMS</b> .....	<b>70</b>

<b>LINE</b> .....	<b>71</b>
Using LINE.....	71
<b>Internet</b> .....	<b>72</b>
<b>Accessing the Internet</b> .....	<b>72</b>
<b>Using Packet Communication</b> .....	<b>72</b>
<b>Using the Browser</b> .....	<b>73</b>
Using the Browser Menu .....	73
Using the Touch Pointer.....	73
<b>Camera</b> .....	<b>74</b>
<b>Before Using the Camera</b> .....	<b>74</b>
<b>Viewfinder Layout</b> .....	<b>75</b>
<b>Capturing Still Pictures/Video</b> .....	<b>76</b>
<b>TV (1Seg)</b> .....	<b>77</b>
<b>TV (1Seg)</b> .....	<b>77</b>
<b>Making Initial TV Settings</b> .....	<b>78</b>
<b>Viewing TV Programs</b> .....	<b>78</b>
Viewing a TV Program .....	78
<b>Settings</b> .....	<b>80</b>
<b>Displaying the Settings Menu</b> .....	<b>80</b>
<b>Wireless LAN (Wi-Fi®) Function</b> .....	<b>80</b>
<b>Using the Wireless LAN (Wi-Fi®) Function</b> .....	<b>81</b>
Enabling the Wireless LAN (Wi-Fi®) Function .....	81
Connecting to a Wi-Fi® Network.....	81
Disconnecting from an Access Point.....	82



**Appendix ..... 83**

<b>Introduction of Peripheral Devices.....</b>	<b>83</b>
<b>Using an Optional Earphone.....</b>	<b>84</b>
<b>Using a microUSB Earphone .....</b>	<b>84</b>
Receiving a Call.....	85
<b>Troubleshooting .....</b>	<b>86</b>
<b>Updating Software .....</b>	<b>87</b>
Downloading and Updating Software.....	88
<b>Remotely Locking the Product with Anshin Lock Service .....</b>	<b>88</b>
<b>Using Keitai Sagasete Anshin (Keitai Search) Service .....</b>	<b>89</b>
<b>After-Sales Service .....</b>	<b>89</b>
<b>SIM-Unlocking the Product .....</b>	<b>92</b>
<b>Main Specifications .....</b>	<b>93</b>
<b>Specific Absorption Rate (SAR) of Cell Phones.....</b>	<b>94</b>
<b>FCC Notice.....</b>	<b>95</b>
<b>European RF Exposure Information.....</b>	<b>96</b>
<b>INSTRUCTION MANUAL FOR BATTERY PACK (KYF31UAA) ....</b>	<b>97</b>
<b>Declaration of Conformity .....</b>	<b>97</b>
<b>Intellectual Property Rights .....</b>	<b>98</b>
<b>OpenSSL License .....</b>	<b>101</b>

## Safety Precautions (Observe Strictly)

- **Before using the product, thoroughly read these safety precautions for proper use. After reading, store the precautions in a safe place.**
- These "Safety Precautions" describe instructions that should be observed to prevent damage to property or injury to the customer or others using the product.
- If the product is going to be used by a child, a parent or guardian should read the "Setting Guide" and "Basic Manual" (this manual) and provide instruction in proper use.
- These instructions are divided into the following categories.

### Explanation of Indications Used in This Manual







 <b>DANGER</b>	Indicates imminent risk of death or serious injury* <sup>1</sup> with improper handling.
 <b>WARNING</b>	Indicates risk of death or serious injury* <sup>1</sup> with improper handling.
 <b>CAUTION</b>	Indicates risk of minor injury* <sup>2</sup> and physical damage* <sup>3</sup> with improper handling.

\*1 Serious injury: This refers to loss of sight, injury, burns (high- and low-temperature), electric shock, broken bones, injuries with residual aftereffects from poisoning, etc., and injuries requiring hospital admission for treatment or long-term hospital attendance as an outpatient.

\*2 Minor injury: This refers to injuries, burns (high- and low-temperature), electric shock, etc. that do not require hospital admission for treatment or long-term hospital attendance as an outpatient.

\*3 Physical damage: This refers to extended damage to buildings, furniture, livestock or pets.

### Explanation of Graphic Symbols Used in This Manual

	Indicates an action that is not allowed.		Indicates that use in a place where the product is likely to get wet or allowing the product to get wet is not allowed.
	Indicates that handling with wet hands is not allowed.		Indicates an action that must be done.
	Indicates that disassembly is not allowed.		Indicates that the power plug must be disconnected from the power outlet.

■ **Precautions Common to the Main Unit, battery pack, back cover, Charger, au Nano IC Card 04, Peripheral Devices**



**DANGER**

**Be sure to read the following hazards before use.**



Be sure to use only the specified peripheral devices. Use of other peripheral devices might cause overheating, ignition, rupture, fault, or leakage of liquid.



Do not use, store or leave the product in hot places (e.g. by the fire, near a heater, under a kotatsu, in direct sunlight, in a car in the hot sun). Doing so might cause ignition, rupture, fault, fire or injury.



Do not put the product in a cooking apparatus such as microwave oven or a pressure vessel. Doing so might cause ignition, rupture, fault, fire or injury.



Do not throw the product into a fire or heat it. Doing so might cause ignition, rupture or fire.



The customer is not allowed to disassemble, modify or repair the product. Doing so might cause a fault, ignition, electric shock, or injury. The Company is not liable even in the event of any nonconformities arising on the product or peripheral devices as a result of modification, etc. Modification of the product is in violation of the Radio Law and Telecommunications Business Law.



**WARNING** **Be sure to read the following warnings before use.**



Before entering an area where flammable gas is generated such as a gas station, be sure to turn off the product. Do not charge the battery. Failure to observe these precautions might cause the gas to catch fire. In addition, when using Osaifu-Keitai® payment function at a gas station, be sure to turn off the power in advance. If Osaifu-Keitai® has been set, cancel the lock before turning off the power.



When wearing a metal accessory etc., do not allow the metal part to come in contact with the external connection terminal, charger terminal, or power outlet. Doing so might cause electric shock, ignition, injury or a fault.



Do not drop or subject to strong impact, such as throwing. Doing so might cause rupture, overheating, ignition or a fault.



Do not use outside when you can hear thunder. Doing so might risk lightning strikes and electric shock.



To prevent short-circuiting of the external connection terminal and charger terminal, do not allow your fingers or any other part of your body or conductive materials (metal, pencil lead, etc.) to come in contact with or enter these areas. Doing so might cause overheating, fire, a fault, electric shock, or burns.



If the product is damaged because it is dropped, etc. and its display is cracked or internal parts are exposed, do not touch the cracked display or exposed parts. Doing so might cause electric shock or injury from damaged parts.



Charging the product while wet might cause electric shock or short circuit/corrosion, causing fire due to overheating, a fault, or injury.



Although the product has waterproof capability, discontinue use if liquid such as water gets inside the product or other device from the external connection terminal cover, battery pack, etc. Continued use of the product in this state might cause overheating, ignition or a fault.



Do not use product while driving a car or riding a motorbike or bicycle or while walking. Doing so might cause a traffic accident or someone to fall or drop something. Use of a cell phone while driving a car or riding a motorbike is prohibited by law. Use of a cell phone while riding a bicycle may be punishable by some regulations.



If charging is not completed after the specified charging time, stop charging. Failure to do so might cause leakage of liquid, overheating, rupture or ignition.



Do not leave in places within the reach of small children. Small children might swallow small parts by mistake and choke on them, or might drop them by mistake and cause accidents or injury.



Do not cover or wrap the product with bedding, etc. while using or charging the product. Doing so might cause fire, fault or injury.



When using a charger or external device, insert/remove the connector straight to/from the jack. Inserting/removing in an incorrect orientation might cause overheating, fire, damage or a fault.



## CAUTION Be sure to read the following cautions before use.



When removing the back cover, do not apply excessive force. Doing so might cause injury or malfunction.



Do not expose the camera lens to direct sunlight for an extended period. Doing so might cause ignition, rupture, fire or a fault by the light-collecting mechanism of the lens.



Do not store the product in places subject to direct sunlight (e.g. in automobiles), places that get hot, places that get extremely cold, and in humid or dusty places. Doing so might cause overheating, deformation or a fault.



Do not place the product on top of a wobbly table or sloped surface, or charge when placed on an unstable location. Doing so may allow the product to fall and cause injury or damage. Be careful especially when the product is set to vibrate. Also use adequate caution with impact, etc. Failure to do so might cause a fault or injury.



The product may become hot when used for a long period or when connected to an external power supply. Avoid contact with the product and specified charger (sold separately) for long periods. Failure to do so may cause low-temperature burns. Do not cover with paper, clothing, bedding, etc. Doing so may cause fire, injury, or a fault.



When charging the product, do not exceed the ratings given for outlets and wiring. Exceeding ratings for power strips, etc. might cause overheating and result in fire.





Do not use with the back cover removed. Do not leave or store in that manner. Doing so may allow dust or other foreign matter to enter and cause a fault.



Do not place near corrosive chemicals or in places where corrosive gas is generated. Doing so might cause a fault or loss of internal data.



Stop use if there is smoke, abnormal odor or noise, excessive overheating, or other abnormalities. During charging, disconnect the specified charger (sold separately) from the power outlet, make sure that the product is not overheating before turning the power off, remove the battery pack and contact an au shop or Keitai Guarantee Service Center. Also, if you have dropped or damaged the product, do not continue to use it in that state, and contact an au shop or Keitai Guarantee Service Center.



When inserting an earphone, etc. into the product, adjust the volume to the proper level by increasing it gradually. Suddenly turning the sound on with the volume set too high, too loud a volume or using the earphone continuously for a long period of time might adversely affect your ears. Also, raising the volume too high might prevent you from hearing sounds around you, which might in turn lead to a traffic accident at a railroad crossing or pedestrian crossing.



When using handsfree call, take care to keep the speaker at a safe distance from your ears, as the speaker volume may be too loud.

## ■ Main Unit



### **WARNING** Be sure to read the following warnings before use.



Turn off the product or set it to Airplane mode before going aboard an airplane. Since using the product on airplanes is restricted, follow the instructions given by the respective airlines. If any functions are activated that power on the product automatically, deactivate them. Failure to do so might affect an airplane's electronic instrumentation. If you commit a prohibited act while using the product on an airplane, you might be punished by law.



Follow the instructions given by the respective medical institution regarding the use of the product in a hospital. Turn off the product in areas where the use of cell phones is prohibited. Failure to do so might cause interference with the operation of electronic devices and electronic medical devices.



Do not send data by infrared communication with the infrared port pointing toward eyes. Doing so might affect eyes. Also, sending data with the infrared port pointing toward some other infrared device might cause false operation, etc.



If using the photo light/flash light, do not hold it in front of someone's eyes, or point it at the eyes of someone driving a car or riding a motorbike or bicycle. If the photo light/flash light is lit, do not look directly into it. Eyesight may be affected. Be especially careful not to shoot small children from a very close distance.



Although rarely, some people demonstrate symptoms such as temporary muscle spasms, loss of consciousness, etc. by watching repeatedly flickering screens. Those with a past history of this should consult with a physician beforehand.



### CAUTION Be sure to read the following cautions before use.



Use of the main unit in an automobile might sometimes affect on-vehicle electronic devices, though this rarely happens. If this happens, do not use since this may impair safe travel.



If you feel any abnormality with your skin, immediately consult a dermatologist. Itching, rashes, eczema, etc. sometimes occurs depending on your physical constitution and condition.

The materials of parts used on the product are as follows.

#### ■ Main Unit (GRATINA 4G)

Part	Material	Surface treatment
Outer case (LCD case, key case)	PC + GF resin	UV cured acrylic coating
Outer case (hinge cover), back cover	PC resin	UV cured acrylic coating
Outer case (LCD rear plate)	SUS	UV cured acrylic coating
Infrared port, window panel (main display), camera (lens)	PMMA resin	Chemically cured

Part	Material	Surface treatment
Phone book key, camera key, mail key, browser key, cursor key, call/pair key, clear key, power/end call key, number keys, center key	PMMA resin	—
Key sheet	PET resin	UV cured acrylic coating
Cushion (under number keys)	UV cured resin	—
Window panel (sub-display), charging/notification indicator	PMMA resin	UV cured acrylic coating
Manner/shutter key	PC resin	—
External connection terminal cover	PC resin + TPE resin	UV cured acrylic coating
Charger terminal	Phosphor bronze	Gold plating (base: nickel)



Do not bring the product close to magnetized objects such as cash cards, floppy disks, credit cards, and prepaid cards. Doing so might result in loss of recorded information.



Do not allow liquids, metal objects, burnable items, and other foreign matter to get inside the external connection terminal, microSD card slot, or au Nano IC Card 04 slot. Doing so might cause fire, electric shock, a fault, or injury.



You should normally use the product with the external connection terminal cover closed. Using the product with the cover opened can allow dust, liquid, etc. to enter and cause malfunction.



Do not swing the product around by holding the strap, etc. Doing so might cause an accident or damage.



If you have a weak heart, be careful when setting the ringtone vibration and incoming volume to prevent adverse effects on your heart.



Pay attention to items becoming stuck to the product. The speaker uses magnets, and so thumbtacks, pins, craft knife blades, staples, and other metal objects sometimes become stuck to the main unit, and cause unexpected injury. Before using the product, always make sure there is nothing stuck to the speaker or other part.



Do not put the product directly on sand at a beach, etc. Sand or other small particles might get inside the microphone, speaker causing the volume to drop. If sand gets inside the product, it might cause overheating or a fault.

## Battery Pack



Li-ion00

**(The battery pack of the product is a lithium-ion battery.)**

The battery pack is not fully charged at the time of purchase. Charge the battery before using the product. Also charge the battery after long periods of disuse before using the product.



**DANGER**

**Be sure to read the following hazards before use.**



Do not short-circuit the plus (+) and minus (-) terminals on the battery pack.



Do not fail to connect the battery pack to the product in the correct orientation. Connecting in an incorrect orientation might cause rupture, fire or overheating. Do not try to forcibly connect the battery pack, instead thoroughly check the contact terminal before connection.



Do not puncture the battery pack with a nail, hit it with a hammer or step on it. Doing so might cause ignition, overheating, rupture or damage.



Do not allow metal objects (such as necklaces and hairpins) to come in contact with the contact terminal when carrying or storing the battery pack. Short-circuiting might cause overheating, ignition, fire, leakage, or malfunction.



Do not disassemble, modify or directly solder the battery pack. Doing so might cause battery fluid to spurt, causing blindness if entering eyes, etc. or causing overheating, ignition, rupture, or injury.



Do not use a battery pack that has been dropped, stepped on, damaged, or that is leaking battery fluid. Doing so might cause overheating, ignition, leakage, malfunction, or injury. Immediately move the battery pack away from fire if you notice leakage of fluid or unusual odor. Failure to do so might cause the leaked fluid to catch fire resulting in ignition or rupture.



Do not wet the battery pack with water, seawater, pet urine, etc. A wet battery pack might cause overheating, rupture, ignition, malfunction, or injury. If you drop the product into water by mistake, immediately turn off the power, remove the battery pack, and contact an au shop or the Keitai Guarantee Service Center. Never charge a wet battery pack.



Battery fluid on skin and clothes might cause injury; immediately rinse with water. Battery fluid in eyes can cause blindness; rinse with water without rubbing, and immediately seek medical attention. Wipe away battery fluid on the product without directly touching fluid.



The battery pack is a consumable item. If the performance of a battery pack does not recover (e.g. the usable time after each charge has become extremely short), the battery pack is at the end of service life, so stop use and buy a new one of the specified type. Failure to do so might cause overheating, ignition, rupture or leakage. Note that the length of service life varies depending on the usage condition, etc.



Be careful not to let a pet bite the battery pack. Letting it do so might cause leakage, overheating, rupture, ignition, fire, injury, etc.

## Charger



**WARNING** Be sure to read the following warnings before use.



Do not use at other voltages than the specified power supply voltage. Doing so might cause ignition, fire, overheating, electric shock or injury.

- Desktop holder (KYF31PUA) (sold separately): 5.0 V DC
- AC adapter (sold separately): 100 V AC to 240 V AC



Firmly insert the power plug of the specified charger (sold separately) into the power outlet down to the base of its pins. Incomplete insertion of the power plug might result in electric shock, overheating, ignition, fire, or injury. Do not use damaged specified charger (sold separately) or loose power outlets.



Do not damage, modify, twist, pull or place a heavy object on the cable of the specified charger (sold separately). Do not use a damaged cable. Doing so might cause electric shock, short circuit, fire, or injury.



If you hear thunder, do not touch the specified charger. Doing so might cause an electric shock as a result of a lightning strike.



Before cleaning the specified charger (sold separately), unplug its power plug from the outlet or cigarette lighter socket. If the plug remains plugged in when you clean the charger, it might cause short circuit.



Wipe off dust on the power plug. Failure to do so might cause fire, burns or electric shock.



When the charger is not to be used for a long time, disconnect the specified charger (sold separately)'s power plug from the power outlet. Failure to do so might cause fire or a fault.



Only use in places not subject to direct splashing with water, pet urine, etc. Not doing so might cause overheating, fire, electric shock, malfunction due to short-circuiting, or injury. In the event that a specified charger (sold separately) is splashed with liquid, immediately disconnect its power plug.



When not using the specified charger (sold separately), do not leave it plugged into an outlet. Do not wrap power cord of the specified charger (sold separately) around the charger. Doing so might cause electric shock, overheating, fire, a fault, or injury.



Do not forcibly bend the charger's plug or the connection between the connector and power cord. Doing so might cause electric shock, overheating, fire, a fault, or injury.



**CAUTION** Be sure to read the following cautions before use.



Do not use the specified charger (sold separately) in a bath room or other humid environment or plug it in or unplug it with wet hands. Doing so may cause electric shock, malfunction, or injury.



When unplugging the power plug of the specified charger (sold separately) from the outlet, hold the power plug to do so. If you pull the cable, it might be damaged.



Do not leave the specified charger (sold separately) connected to the product with the battery pack removed. Doing so might cause ignition, electric shock, or injury.

**■ au Nano IC Card 04****CAUTION**

**Be sure to read the following cautions before use.**



Be careful not to injure your hand or finger when attaching/removing the au Nano IC Card 04.



Do not subject the au Nano IC Card 04 to actions that can damage it (use in high-temperature conditions, throwing in a fire, allowing metal contacts to come in contact with foreign objects, subjecting to shock, bending or pressing, wetting, etc.). Doing so might erase data or cause a fault.



Do not store the au Nano IC Card 04 in places that get hot (places subject to direct sunlight, etc.) or in dusty places. Doing so might cause a fault.



Store the au Nano IC Card 04 out of reach of small children. Accidental swallow might cause asphyxiation, injury, etc.

**■ Use near Medical Instruments and Inside Medical Facilities****WARNING**

**Be sure to read the following warnings before use.**



When using the product near an implanted pacemaker, implanted cardioverter-defibrillator or other electronic medical device, radio waves might affect these units and devices. So, please observe the following.

1. Those with an implanted pacemaker or implanted cardioverter-defibrillator should carry or use the product at least 15 cm away from where the implant is.
2. Change to Airplane mode on the product beforehand or turn the product off before entering a place where it may not be possible to maintain a distance of 15 cm, such as where movement is restricted, since there may be people with a cardiac pacemaker or implanted cardioverter-defibrillator nearby.
3. When a medical institution has laid down designated areas where use of the product is prohibited or is not allowed to be brought in, abide by the instructions of that medical institution.
4. When using electronic medical devices other than an implanted pacemaker and implanted cardioverter-defibrillator outside a medical institution (e.g. home medical treatment), check individually with the manufacturer of the electronic medical device regarding the influence of radio waves.

## Handling Precautions

These precautions are provided to prevent product faults and to ensure that performance can be fully demonstrated.

Thoroughly read these precautions to ensure correct use.

### ■ Precautions common to the main unit, battery pack, back cover, charger, au Nano IC Card 04, peripheral devices

- Do not apply excessive force to the product during use. Be sure not to put the product into a tightly packed bag or place a heavy object on the product in a bag. Sitting on the product in your pocket might damage the display or internal circuit board resulting in a malfunction.

Keeping an external device connected to the external connection terminal might damage the connector resulting in a malfunction. Such damage and malfunction are not covered by the warranty, even if there is no external damage.

- To ensure waterproof property (equivalent to IPX5 and IPX8) of the product, use the product with the back cover and external connection terminal cover tightly closed.

Note that the waterproof property is not guaranteed in every usage condition.

Do not allow water to get inside the product or splash water on the battery pack, charger, or optional accessories. Do not open/close the back cover or external connection terminal cover in the rain or with any water on the surface of the product. Doing so might cause water intrusion resulting in internal corrosion. Malfunctions determined to be caused by such water intrusion are not covered by the warranty.

- Do not use the product in extremely hot, cold or humid places (Use within an ambient temperature range of 5°C to 35°C and humidity range of 35% to 85%).
  - Charger
  - Peripheral devices

- Do not use the product in extremely hot, cold or humid places. (Use within an ambient temperature range of 5°C to 35°C and humidity range of 35% to 85%. Temporary use at 36°C to 40°C is allowed.)
  - Main unit
  - Battery pack, au Nano IC Card 04 (attached to the main unit)
- Do not use in places subject to lots of dust or vibration.
- Clean the external connection terminal now and then with a dry cotton swab. Soiling may result in a poor connection. Avoid using excessive force, which can bend the external connection terminal.
- Clean the product with a soft dry cloth (such as the type used for eyeglasses). Forceful rubbing with a dry cloth may scratch the display. The display may be stained if splash or smear is left attached to the surface. Wiping the product using alcohol, thinner, benzene, detergent, etc. might erase the printing on the outer casing or cause discoloration.
- Use as far away as possible from fixed-line phones, TVs and radios. Use nearby might affect them.
- The product may become warm while charging or during other operations, depending on the situation, but this is not abnormal.
- Turn off the power of the product before removing the battery pack. If you remove the battery pack with the power on, saved data might be altered or lost.
- Do not adhere stickers on the product. Doing so may prevent sound from being audible or your voice from being audible to the other party.

### ■ Main unit

- Do not forcefully press, tap or intentionally subject the display to strong impact. Doing so might cause scratching or damage.
- Do not forcefully press your fingernails, sharp objects, or hard objects against keys or display surface. Doing so might cause scratching or damage.

- The product's keypad (touch area) can be operated with your fingers as a touchpad (Touch Pointer). However, in the following cases, the touch area may not respond to touch operation. These may also result in malfunction.
  - with gloves on
  - with fingernails
  - with another object placed on the operation area
  - with a protective film or sticker adhered
  - with any water or condensation on the touch area
  - with wet or sweaty fingers
  - under water
- Never use modified au cell phones. Use of a modified device violates the Radio Law and Telecommunications Business Law. The product has acquired such certification as conformity with technical regulations for a specified radio station based on the Radio Law and conformity with technical regulations for a terminal device based on the Telecommunications Business Law, and the "Technical Conformity Mark (㊞)" can be confirmed internally in the product.

When the standby screen is displayed, press  → [Settings] → [More settings] → [About phone] → [Compliance information]

If the product is disassembled and modifications are made to the internal components, the certifications of conformity with technical regulations will become invalid. Never use the product without these certifications valid. Doing so violates the Radio Law and Telecommunications Business Law.
- Take care not to place magnetized items such as magnetic cards, speakers and TV sets near the product, as it might cause malfunction.

Putting strong magnetism close to the product might cause false operation.
- When you put the product in your pocket or bag, take care so that the display does not come in contact with metal objects or other hard objects, as it might cause scratching or damage. Straps with metal or other hard parts that may come in contact with the display may cause scratching or breakage.
- When suddenly brought into a warm place from a cold place, or when in a humid location, or when used where temperature suddenly changes (e.g. near the air discharge port of an air conditioner), water drops (i.e. condensation) sometimes are formed inside the product. Note that when used under conditions such as this, humidity might cause corrosion or a fault.
- When wiping the display, wipe with a soft, dry cloth. Use of a moistened cloth, glass cleaner or other similar liquid might cause a fault.
- When connecting/disconnecting an external device to/from the external connection terminal make sure to insert/remove the connector of the external device straight to/from the terminal.
- Note that applying unnecessary force with an external device connected to the external connection terminal may cause damage.
- Do not exert excessive force when attaching/removing a microSD memory card. Doing so might injure your hands or fingers.
- While writing/reading data to/from a microSD memory card, do not subject the product to vibration or impact, remove the battery pack, or turn off the power. Doing so might cause loss of data or a fault.
- Do not remove the black sheet on the inside of the back cover. Doing so may prevent Osaifu-Keitai® from reading/writing properly.
- Covering the microphone with your fingers, etc. prevents your voice from being clearly heard by the other party.
- Covering the light sensor with your fingers, a sticker, etc. may prevent the light sensor from responding to the surroundings and operating properly.



### ■ Touch area

- Operate the touch area with your fingers. Do not use a ballpoint pen, pencil, or other sharp object. Not only does this prevent proper operation, it can also scratch or damage the touch area.
- Adhering stickers or films over the touch area may prevent the Touch Pointer from operating properly.
- Any soiling or wetness (sweat, water) on the touch area may cause misoperation. Wipe the touch area with a soft, dry cloth.

### ■ Battery pack

- Use in very hot or cold environments, for example, when left in an automobile with the windows closed in summer, will cause the battery capacity to drop and shorten the available battery usage time. This will also shorten the battery pack's service life. Try to use the battery pack as much as possible at room temperature.
- When the battery pack is not to be used for a long time, remove the back cover and then the battery pack from the main unit, and store it away from hot and humid places.
- Charge the product first if using the product for the first time or if you have not used the product for a long time.
- The battery pack is a consumable item. The battery is at the end of its service life if it no longer recharges. Purchase a specified battery pack. Service life depends on usage.
- Do not dispose of the battery pack with ordinary refuse. Cooperate with battery recycling programs to promote environmental conservation and better use of resources. Used battery packs are collected at au shops and other locations.
- Battery packs sometimes swell up as they approach the end of their service life depending on the usage condition. This is due to the properties of lithium-ion batteries, and is not a problem in terms of safety.

### ■ au Nano IC Card 04

- Do not forcibly remove or insert the au Nano IC Card 04. Be careful not to exert excessive force when inserting the card into your au cell phone.
- You are responsible for any damage caused by inserting your au Nano IC Card 04 into some other IC card reader/writer, etc.
- Keep the IC (metal) part of your au Nano IC Card 04 clean. Wipe the card with a dry, soft cloth (such as for cleaning eyeglasses) for cleaning.
- Do not put stickers, etc. on the au Nano IC Card 04.

### ■ Camera

- When using the camera, follow common rules of etiquette regarding camera use.
- When photographing important occasions (such as a wedding), take a trial shot and check the shot image to make sure it is correctly shot.
- Do not use the camera for recording commercially available books or information of which photographing is not allowed.

### ■ Copyrights and rights of portrait

- If the data you shot or recorded using the product or the data you downloaded from the Internet etc. is in part or in whole protected by the third party's copyright, you are not allowed to copy, distribute, publicly send, modify the data without consent of the copyright holder, except for personal use, under the copyright law. In addition, do not use or modify portraits or names of other individuals without their consent, as it may infringe on rights of portrait.  
Note that shooting and recording might be restricted at some live performances, shows and exhibitions even for personal use.
- Be careful about the copyright and portrait right when posting photos you shot, etc. on Internet homepages.

### ■ Back up content on the product

- Please back up important content recorded or downloaded to the product to an outside source. Content recorded to memory on the product sometimes disappears or is altered by unexpected factors, such as static electricity or a fault, or by repair, mishandling, etc.

### ■ FCC certification information

- This product is certified by the Federal Communications Commission (FCC).

The product's FCC ID is JOYDA28.

You can view this certification in the following way:

Display the settings menu → [More settings] → [About phone] → [Compliance information]

## Available Security Codes

The product has various security codes that you can use.

The available security codes are as follows. Do not forget the various security codes that are set as they are necessary for various operations and contracts.

Be sure to change the initial values to your own numbers you have chosen.

### ■ Security code

Example of usage	① To do remote operation of voice mail and call forwarding services from a landline phone ② To use Customer Service Center and to do various inquiries, applications, and modifications on the au homepage
Initial value	A four digit number chosen by the customer and noted on the application form

### ■ Lock No ("Osaifu-Keitai lock")

Example of usage	To use "Osaifu-Keitai lock"
Initial value	1234

Be sure to change the initial values to your own numbers you have chosen.

### ■ PIN code

Example of usage	To prevent unauthorized use of the au Nano IC Card 04 by third parties
Initial value	1234

Be sure to change the initial values to your own numbers you have chosen.

## PIN

### PIN Code

To prevent unauthorized use of the au Nano IC Card 04 by a third party, you can set the product to require PIN code entry every time the power is turned on. You also need to enter PIN code when setting whether PIN code entry is required.

If PIN code is incorrectly entered three times consecutively, the PIN code will be locked. You can unlock the PIN code using PUK code.

- At the time of purchase, the PIN code is "1234", and entry is not required. You can change the PIN code to any 4- to 8-digit number and the product to require entry if necessary.
- To use the product with a PIN code required, be sure to change the PIN code to your own number you have chosen.

### PUK Code

In case PIN code is locked, you can unlock it by entering PUK code.

- PUK code is an eight-digit number given at the time of purchase, which is printed on the back side of the plastic card on which your au Nano IC Card 04 is attached.
- After entering PUK code, you need to set a new PIN code.
- If PUK code is incorrectly entered ten times consecutively, contact an au shop, PiPit or Customer Service Center.
- PIN code is not reset by initializing the product.

## Notes on Waterproof/Dustproof/ Shockproof Properties

The product has a protection rating for water resistance equivalent to IPX5<sup>\*1</sup> and IPX8<sup>\*2</sup> and for dust resistance equivalent to IP5X<sup>\*3</sup> on the condition that the external connection terminal cover and back cover are completely attached. The product also achieves MIL-standard<sup>\*4</sup> shock resistance (based on testing by the Company). Specifically, you can talk on the product in the rain without an umbrella (with precipitation of 20 mm/hour or less), as well as use the product in where water is present (bathroom, kitchen, etc.)

Before using the product, thoroughly read "Important Items to Remember before Use" and "Tips for Comfortable Use" to ensure correct use. Failure to follow the contents described in these sections may cause the intrusion of water, sand or other foreign material, resulting in overheating, ignition, electric shock, injury or a fault.

- \*1 IPX5 equivalent means that the product will maintain its operability as a phone even if it is sprayed with water from a 6.3 mm diameter nozzle at a distance of about 3 meters for more than 3 minutes at a rate of about 12.5 liters per minute from any direction.
- \*2 IPX8 equivalent means that the product will maintain its operability as a phone with no water getting inside the main unit even if it is gently submerged in a tank of still tap water at room temperature to a depth of 1.5 meter for about 30 minutes.
- \*3 IP5X means that the product will have and safely maintain functionality as a phone after being removed from a test device filled with particles up to 75 μm in diameter and agitated for 8 hours.
- \*4 Drop test carried out according to MIL-STD-810G Method 516.7-Shock requirements as stipulated by the US Department of Defense (product dropped in 26 directions from height of 1.22 m). Product shock resistance assumes usage in daily situations; subjecting the product to excessive shock such as by throwing or causing/letting the product fall forcefully may break the product. Even if performance is not affected, being dropped can cause scratches, etc.

Since operation of the product on each usage scene was confirmed based on the above assumption, proper operation of the product in every possible condition during actual use is not guaranteed. Malfunctions determined to be caused by mishandling by the customer are not covered by the warranty.

## Important Items to Remember before Use

- Make sure the external connection terminal cover is closed firmly and the back cover is completely attached.
  - Water resistance is effective when completely sealed.
  - Any minute particles becoming lodged between contact surfaces (a single hair, grain of sand, etc.), no matter how small, can cause seepage.
  - Never open/close the external connection terminal cover or back cover when the product or your hands are wet.

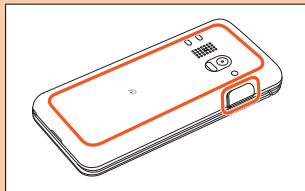

**Closing the external connection terminal cover**

First reinsert the hinge, and then push in the entire cover ① with the pad of your finger. Next, press with your finger along the direction of the arrow ② to close firmly and make sure there are no gaps in the cover.

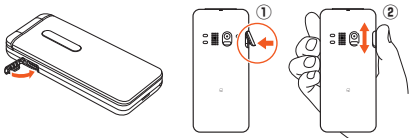
**Attaching the back cover**

Place the back cover on the product and attach. After attaching, work your way all around the back cover in direction ①, pressing firmly in direction ② to attach completely.

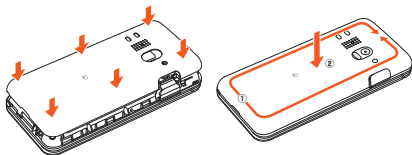

- Do not immerse the product in water with soap, detergent or bath salts in it.
- Do not immerse the product in seawater, a swimming pool or hot spring.
- Do not immerse the product in any liquid (alcohol, etc.) other than water.

- Do not place the product directly on sand at a beach, etc. Sand or other small particles might get inside the microphone or speaker, causing the volume to drop. If sand gets inside the product, it might cause overheating or a fault.
- Do not use the product underwater.
- Do not leave the product in a humid place such as a bathroom or kitchen for an extended period of time.



Soap/detergent/  
bath salts



Seawater



Swimming  
pool



Hot spring



Sand/mud

**Tips for Comfortable Use**

- Water may remain in gaps in the product after becoming wet. Shake well to drain. In particular, be sure to drain water from the back cover, keys, and charger terminal.
- Moisture may still remain after draining. While this will not affect use, you should not leave the product next to items you do not want to get wet. Product may wet clothing, inside of carry bag, etc.
- Drain any water in the microphone that may be affecting audibility.

**Notes on various usage scenes****<In the rain>**

You can talk on the product in the rain with wet hands and without an umbrella.

- Rain refers to "fairly strong rain" (20 mm or less per hour).
- Any water on the touch area may cause Touch Pointer misoperation.
- Never open/close the external connection terminal cover or back cover while exposed to rain or with wet hands.

**<In the shower>**

You can make calls holding the product with wet hands after a shower.

- Product is not designed to resist water pressure. Avoid using where exposed to high water pressure.

**<Washing>**

You can wash the product under a mild flow (up to 6 liters per minute) of tap water at room temperature (5°C to 35°C) at a distance of about 10 cm from the faucet or showerhead.

- Product is not designed to resist water pressure. Avoid exposing to high water pressure or submersing in water for a long period.
- When washing the product, wash by hand without using a brush or sponge, holding the back cover closed securely and not allowing the external connection terminal cover to open.
- Do not wash the product in a washing machine or ultrasound bath.
- Do not splash the product with or immerse it in soap water, detergent water, etc. other than tap water.

**<In the bath>**

You can use the product in a bathroom.

- While you can talk on the phone with wet hands, do not submerge the product in the tub. Product is not designed to be heat resistant.
- Avoid using in a bathroom for a long period. Product is not designed to resist humidity.
- Do not immerse the product in hot spring water, soap water, detergent water, or water with bath salts in it. Also, do not use the product underwater. Doing so might cause a fault.
- Extreme changes in temperature cause condensation. Wait until the product reaches room temperature before you bring the product from a cold place into a warm bathroom.
- If condensation occurs inside the display, leave the product at room temperature for a while until the condensation is cleared.
- To watch TV (1Seg), place the product on a stable surface.
- Do not splash with hot water. Product is not designed to be heat resistant.

- Do not bring a desktop holder (KYF31PUA) (sold separately) or AC charger (sold separately) into a bathroom.

**<At a poolside>**

- Do not immerse or drop the product in pool water. Also, do not use the product underwater.
- If the product gets splashed with pool water, immediately rinse it off with tap water\* in room temperature, because pool water contains chlorine for disinfection. To wash the product, do not use a brush, etc.

\* Mild flow (6 liters per minute or less)

**<In a kitchen>**

You can use the product in the kitchen and other places where water is used.

- Do not splash the product with or immerse it in soap water, detergent water, seasonings, juices, etc. other than tap water.
- Do not submerge in or splash with hot water. Product is not designed to be heat resistant.
- Do not place the product where it gets extremely hot or cold such as near a stove or in a refrigerator.
- To watch TV (1Seg), place the product on a stable surface.

## ■ Common precautions

### ■ External connection terminal cover & back cover

Close the external connection terminal cover firmly and make sure the back cover is completely attached. Any minute particles becoming lodged between contact surfaces (a single hair, grain of sand, etc.), no matter how small, can cause seepage.

Do not wear gloves while opening/closing the external connection terminal cover or removing/attaching the back cover. Any minute particles becoming lodged between contact surfaces (a single hair, grain of sand, etc.), no matter how small, can cause seepage. Before closing the covers, wipe any water, soiling, etc. with a dry, clean cloth, no matter how small.

Any deterioration or damage with the external connection terminal cover or back cover will affect water resistance. If there is any deterioration or damage, contact your nearest au shop.

### ■ If any liquid other than plain water gets on the product

If anything other than water (seawater, washing detergent, alcohol, etc.) gets on the product, immediately rinse with water.

You can wash the product under a mild flow (up to 6 liters per minute) of tap water at room temperature (5°C to 35°C) at a distance of about 10 cm from the faucet or showerhead.

If soiled, wash by hand without using a brush, etc., holding the product so that the back cover and external connection terminal cover do not open.

### ■ After the product gets wet

After becoming wet, drain water, and then without removing the back cover, wipe both the product and back cover with a dry, clean cloth.

In cold regions, any water on the product may freeze.

Using the product with frozen water may cause malfunction. Do not leave product with any water remaining (no special measures are taken with the product for condensation).

## ■ Rubber seals

The rubber seal around the external connection terminal cover and on the product body when the back cover is opened are important in maintaining water resistance. Do not scratch or remove them.

Be careful not to pinch the rubber seals when closing the external connection terminal cover or back cover. Trying to close the covers with a seal pinched can scratch the seal and affect water resistance. Any minute particles becoming lodged between contact surfaces (a single hair, grain of sand, etc.), no matter how small, can cause seepage.

Any liquid other than water (alcohol, etc.) on the product can affect product durability.

Do not insert pointed objects in the external connection terminal cover or back cover. Doing so may damage/deform the product or scratch the seals, allowing water seepage.

Parts used for maintaining water resistance should be replaced every 2 years regardless of their appearance. Contact your nearest au shop for replacement.

## ■ Charging

Never charge the product while wet.

Accessories and optional accessories are not water resistant.

## ■ Waterproof property

Do not use the product in places where it may be sprayed with high-pressure water (e.g. near a faucet or shower head) or submerge it in water for extended periods of time, as the product is not designed to withstand high water pressure. Also, do not expose the product to a strong flow of water running at the specified rate (6 liters per minute) or more - a flow of water that is strong enough to cause skin pain (for example, when running from a faucet or shower head). Doing so may cause the product to fail, although it has a waterproof property equivalent to IPX5. Do not wash the product in a washing machine or ultrasonic bath.

The product does not float on water.

**■ Heat resistance**

Do not use hot water, a sauna, or heated air (dryer, etc.). Product is not designed to be heat resistant.

**■ Shock**

Intentionally subjecting the product to extreme shock such as by throwing or causing/letting the product fall forcefully may break the product. Even if performance is not affected, being dropped can cause scratches, etc.

Do not poke the microphone, speaker, etc. with a cotton swab or other pointed object. Doing so may damage/deform the product body and allow seepage.

**■ Draining the product**

As some parts of the product are not watertight, if you use the product after it gets wet, water remaining in those parts might wet your clothes or bag, or the sound might become hard to hear.

Follow the steps below to drain water.

**1 Wipe the surface of the product well with a lint-free dry, clean cloth, etc.****2 Shake the product**

① Hold the product firmly and shake it in the direction of arrows until water does not come out.

\* When shaking the product, stay alert to your surroundings.

\* Be careful not to have the product pop out, and hold it firmly to drain water.

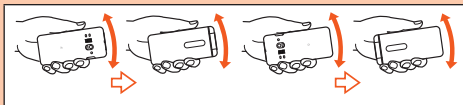

② Wipe away any drained water.

\* Water is particularly difficult to drain from the microphone, speaker, and charger terminal. Hold the product with each part facing downward and pat on a cloth.

③ Place the product on a dry towel or cloth and leave at room temperature.

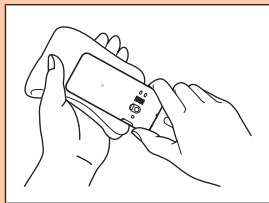
**3 Gently pat the product on a lint-free dry, clean cloth, etc. and wipe away any water in gaps in the microphone, speaker, hinges, external connection terminal, etc.**



#### **4 After adequately removing drained water from the product, leave to dry at room temperature for at least an hour**

Even after you take these procedures, water may remain on the product. Do not place the product near things that you do not want to wet.

Also, take care not to wet your clothes, bag, etc.

#### **■ Precautions on charging**

Accessories and optional accessories are not water/dust resistant.

Note the following before and after charging.

- Never charge the battery if the product is wet. Doing so might cause electric shock or short circuit resulting in fire, a fault or burns.
- Make sure the product is not wet. If charging after the product has gotten wet, first drain water well and wipe with a dry, clean cloth, etc., before placing in the desktop holder (KYF31PUA) (sold separately) or opening the external connection terminal cover.
- If you opened the external connection terminal cover to charge, close the cover firmly after charging. To prevent seepage from the external connection terminal cover, you should charge using the desktop holder (KYF31PUA) (sold separately).
- Do not touch the specified charging equipment (sold separately) with wet hands. Doing so may cause electric shock.
- Do not expose the specified charging equipment (sold separately) to water. Do not use it near water, such as in a bathroom, shower room, kitchen, or washroom. Doing so might cause fire, electric shock, injury or a fault. Do not bring it into a bathroom, etc. even when you are not charging with them. Doing so might cause fire, electric shock, injury or a fault.

## Notes on Using the Bluetooth®/ Wireless LAN (Wi-Fi®) Function

- The Bluetooth® function of the product conforms to domestic standards of Japan, FCC standards and EC directive, and has been certified.
- The Wireless LAN (Wi-Fi®) function of the product conforms to domestic standards of Japan, FCC standards and EC directive, and has been certified.
- The 2.4 GHz band used by Wireless LAN (Wi-Fi®) and Bluetooth® devices is operated by various other devices. For this reason, the communication speed and connectable range may be decreased, or disconnection may occur, due to interference from other devices.
- Do not use this product in places where electromagnetic waves are generated or near electric products, AV and OA equipment, or other magnetized devices.
- Subjecting this product to magnetic or electrical noise might increase noise and prevent it from performing communications. (This product is particularly susceptible to noise when it used near a microwave oven.)
- Using this product near a TV, radio or similar appliance might cause reception interference and disrupt TV images.
- The searching might not be successful if there are multiple Wireless LAN (Wi-Fi®) access points near to the product or the same channel is being used.
- Use of cell phones on board is restricted. Follow the instructions of each airline.
- The communication speed and connectable range vary depending on the distance between communication devices, obstacles and the devices used.

## Cautions on Using the 2.4 GHz Band

The frequencies used by the Bluetooth® and/or Wireless LAN (Wi-Fi®) function of this product are in the 2.4 GHz band. In this frequency band, other similar wireless stations, in-plant wireless stations for mobile unit identification that require a license to use, such as factory production lines, specific small power wireless stations that do not require licenses, amateur wireless stations (collectively called "other wireless stations" from here on) are operated in addition to home electrical appliances such as microwave ovens, devices for industrial, scientific and medical devices.

1. Before using the product, make sure that "other wireless stations" are not in operation nearby.
  2. In the event that instances of radio wave interference have occurred between the product and "other wireless stations", immediately either relocate the product or stop operation of the device (stop the emission of radio waves).
  3. If unsure or require assistance, contact an au shop or Customer Service Center.
- The connections between this product and all other Bluetooth® and Wireless LAN (Wi-Fi®) devices have not been confirmed. Therefore, connections with all Bluetooth® and Wireless LAN (Wi-Fi®) devices are not guaranteed.
  - This product supports security features for wireless communications that are compliant with the Bluetooth® and Wireless LAN (Wi-Fi®) standard specifications, but the security may not be sufficient depending on the usage environment and configuration. Be careful when making data communication using Bluetooth® or Wireless LAN function (Wi-Fi®).
  - Wireless LAN (Wi-Fi®) has the advantage that it can be freely connected anywhere within the radio wave range, as it uses radio waves for exchanging information. At the same time, there is a risk that a malicious third party may obtain unauthorized access if security settings have not been configured. You are recommended to configure security settings before use at your decision and responsibility.

- The Company assumes no responsibility for leakage of data or information that may occur during Bluetooth®/Wireless LAN (Wi-Fi®) communication.
- Since Bluetooth® and Wireless LAN (Wi-Fi®) functions use the same frequency band, using the both functions at the same may cause radio wave interference resulting in decreased communication speed or disconnection from the network. If connection fails, stop using either of the Bluetooth® and Wireless LAN (Wi-Fi®) functions. Bluetooth® and Wireless LAN (Wi-Fi®) functions of this product use frequencies in the 2.4 GHz band.
- Bluetooth® function: 2.4FH1/XX1



This product uses the 2.4 GHz band. FH-SS is used as the modulation scheme. The interference distance is about 10 m or less. Bands of mobile unit identification devices cannot be avoided.

- Wireless LAN (Wi-Fi®) function: 2.4DS4/OF4



This product uses the 2.4 GHz band. DS-SS and OFDM are used as the modulation schemes. The interference distance is about 40 m or less.

This means that all bandwidths are used, and that band of mobile unit identification devices can be avoided.

Available channels vary depending on countries.

For use in an airplane, check with the airline company in advance.

## Notes on Packet Communication Charges

- Since constant Internet connection is possible with the product, packet communication may be performed automatically by some applications, resulting in high packet communication charges. Therefore, subscription to a packet flat-rate service/packet communication charge discount service is recommended.
- Connection for browsing homepages, downloading applications, communication using applications, sending/receiving e-mails and configuring various settings is by the Internet, and packet communication charge applies.
  - \* Packet communication charge does not apply to wireless LAN (Wi-Fi®).





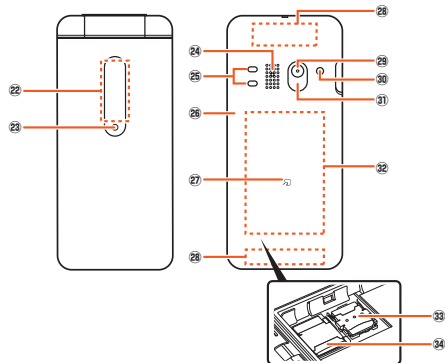
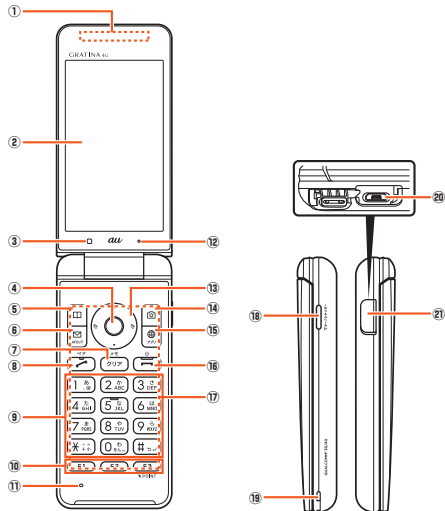

## Notes on Applications

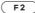
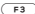

- To download applications, first set an au ID and download from au Smart Pass. For details on setting an au ID, refer to the "Setting Guide".  
This product does not permit use of Google Play™ or EZweb.
- Be sure to check the security of the application, then install it at your own risk. Some applications might cause virus infection, damage various data, and send out your location information, usage history or personal information stored in your cell phone via the Internet.
- The Company assumes no responsibility for any problems that might be caused by applications you have installed. In such case, you may be charged a repair fee even during the warranty period.
- The Company assumes no responsibility for any disadvantage brought to you or any third party by applications you have installed.
- Some applications require that a microSD memory card be inserted.
- Some applications keep the screen turned on while they are active, or rapidly drain the battery while running in the background.
- Changes to method of operation or to screen display may occur without notice due to version upgrades of applications pre-installed on the product or that were installed later. Note that there may be differences with descriptions in this manual.

## Names and Functions of Parts

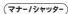

- ① **Receiver**  
Hear the other party's voice on call, play sound of Answering memo, etc. with the Smart Sonic Receiver. (▶P.37)
- ② **Main display**
- ③ **Light sensor**  
Detects brightness when "Brightness level" is set to "Auto".
- ④ **Center key**
- ⑤ **Phone book key**
- ⑥ **Mail key**
- ⑦ **クリア Clear key**
- ⑧ **Call/pair key**
- ⑨ **0 - 9, \*, # Number keys**

- 10  –  **Custom keys 1 – 3**  
Activate application assigned to each Custom key.  
Hold down each key for the following operations.  
 (hold down): display application history  
 (hold down): display notifications  
 (hold down): Touch Pointer on/off in Touch Pointer-capable function/application
- 11 **Microphone**  
Relays your voice to the other party. Also use to record audio. Take care not to cover with your fingers, etc.
- 12 **Air vent**  
As product is designed to be water/dust resistant, it has a high level of airtightness. An air vent is therefore provided.  
  - Air vent does not affect water/dust resistance.
  - Do not cover air vent with a protective film or sticker.
- 13  **Cursor key**  
  - ◀ **Left key/incoming call history**
  - ▶ **Right key/outgoing call history**
  - ⬆ **Up key**
  - ⬇ **Down key**
- 14  **Camera key**
- 15  **Browser key**  
Displays browser menu.
- 16  **Power/end call key**  
While using the product, ends call or function. Hold down to power product on/off.
- 17 **Touch area (Touch Pointer)**  
Use your fingers in the touch area to operate in the same way as a touchpad. (▶P.38)

- 18  **Manner/shutter key**  
In the standby screen, press to display the manner menu. In the standby screen or with the product closed, hold down to enter/exit manner mode.  
While the camera is activated, capture/save a photo.
- 19 **Strap eyelet**
- 20 **External connection terminal**  
Connecting a Common AC Adapter 05 (sold separately), microUSB cable 01 (sold separately), etc.
- 21 **External connection terminal cover**
- 22 **Sub-display**  
Notifies you with information when a call is arriving, new mail is received, an alarm sounds, etc.
- 23 **Charging/notification indicator**  
Lights red during charging.  
Flashes according to settings for new call or new mail.  
Flashes yellow when Keitai Sagasete Anshin (keitai search) service (▶P.89) is determining location.
- 24 **Speaker**  
Ringtones, alarms, etc. sound from here.
- 25 **Charger terminal**  
Terminal for charging with the desktop holder (KYF31PUA) (sold separately).
- 26 **Back cover**
- 27  **mark**  
Hold it over a reader/writer when using Osaifu-Keitai®.
- 28 **Internal antennas\***  
Used for calls, Internet, TV (1Seg), GPS, Bluetooth®, 4G (LTE), etc.
- 29 **Camera lens**
- 30 **Photo light/Flash light**  
Lights when using the photo light/flash light.

③ Infrared port

Transfer data by infrared communication.

④ NFC/FeliCa antenna\*

⑤ au Nano IC Card 04 slot

⑥ microSD memory card slot

\* Do not cover antennas with your hand or put stickers etc. It might affect communication quality.

## Smart Sonic Receiver

The product features a Smart Sonic Receiver, which relays sound by vibrating the display. The receiver does not have any holes, but can be used in a usual manner.

### Holding the product up to your ear

Hold the receiver area up to your ear as shown so that your ear is covered, blocking surrounding sound and increasing audibility. Move the product up and down, left and right to suit your hearing and surroundings.

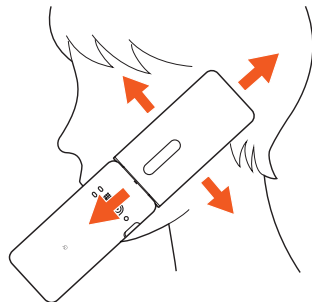





## memo

- Take care not to cover the microphone with your fingers, etc. during a call.
- If an earphone (commercially available) is connected, sound is output from the earphone instead of the Smart Sonic Receiver.
- Do not cover the display with stickers or films. Doing so may affect audibility.
- Audibility depends on the individual.
- Audibility also depends on surroundings.

## Using the Touch Pointer

Use your fingers in the touch area to operate in the same way as a touchpad (Touch Pointer). Activate a Touch Pointer-capable function/application and turn the Touch Pointer on to use the on-screen pointer.

### 1 Activate a Touch Pointer-capable function/application

" (off) / " (on) is displayed in the status bar, and when the Touch Pointer is on, " (pointer) is displayed.

- If the Touch Pointer is off, refer to "Turn on the Touch Pointer" (▶P.38).
- If a confirmation screen is displayed, confirm the content and select "Close this screen". Checkmark "Don't ask again" to no longer display the confirmation screen when next activating the Touch Pointer.

### Turn on the Touch Pointer

#### 1 Hold down

This toggles the Touch Pointer on/off.

- Key operation is still possible when the Touch Pointer is on (except some applications).



## Touch Pointer Operations

When using the browser, LINE, etc., the on-screen pointer can be operated like a touchpad.

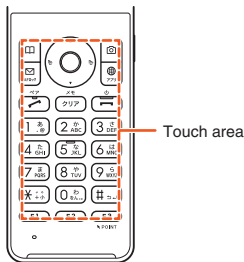

### Tap/Double-Tap

Gently tap the touch area. To double-tap, tap the same position twice.

- By moving the pointer above an item and tapping, the item is confirmed (okayed).



### Long-Touch

Keep gently touching the touch area. After tapping the touch area, the indication returns to the pointer.



### Slide

While gently touching the touch area, slide in the desired direction or to the desired position. The pointer moves in the slid direction.

- By long-touching the touch area, the pointer changes to the slide cursor, and you can slide to scroll the screen.
- With the pointer at the edge of the screen, slide toward off the screen to scroll in the slid direction.

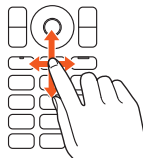

### Flick

Flick your finger on the touch area up, down, left, or right. The pointer moves in the flicked direction.

- By long-touching the touch area, the pointer changes to the flick cursor, and you can flick to scroll the screen.
- With the pointer at the edge of the screen, flick toward off the screen to scroll in the flicked direction.

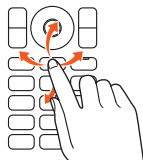

## Zoom in/Zoom out

While touching the touch area with two fingers, widen (zoom in) or close (zoom out) your fingers.

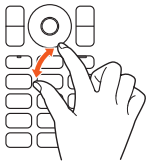

### memo

- The touch area is designed to be touched gently. Avoid pressing forcefully or using sharp objects (ballpen, pin, etc.).
- The touch area might not respond to the following types of operation, and may also cause malfunction.
  - with gloves on
  - with fingernails
  - with another object placed on the operation area
  - with a sticker adhered
  - with any water or condensation on the touch area
  - with wet or sweaty fingers
  - under water

## Switching the Display Language to English

You can switch the display language for function names and other items to English.

- 1** When the standby screen is displayed, press  → [設定 (Settings)]
- 2** [その他の設定 (More settings)] → [言語と入力 (Language & input)] → [言語 (Language)]
- 3** [English] → [はい (Yes)]

## Using the Standby Screen

Check the status of the product in the standby screen.

### ■ Viewing the Standby Screen

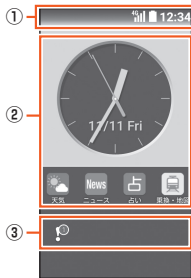

《Standby Screen》

① **Status bar**

② **Widget area**

Use widgets and applications.

③ **Indicators**

Indicators for missed calls, unread e-mail/SMS, and notifications are displayed.

## Using Shortcuts in the Standby Screen

You can use the widgets and indicators in the standby screen as shortcuts.

**1** When the standby screen is displayed, press → **Select item** →

- Selecting an indicator displays its content in a balloon.

## Editing Widgets in the Standby Screen

Edit widgets displayed in the standby screen.

**1** When the standby screen is displayed, press → **[Settings]** → **[Wallpaper/Display]** → **[Idle screen]** → **[Edit widgets]**

**2** Select an open space/widget in the widget area  
→

<b>3</b> Add	Adds a widget to the selected open space. Select the widget you want to add from "Widget" or "Application".
Sort	Sorts selected widgets. To sort, move a widget you want to move to a new position → .
Delete	Deletes a selected widget.

## Using the Status Bar

### Icons

Notification icons for missed calls, new mail, and running operations are displayed on the left of the status bar, and status icons for product status are displayed on the right.

### Main Notification Icons

Icon	Description
	Missed call
	New e-mail message
	New SMS message
	Scheduled TV (1Seg) viewing started
	Call in progress, call arriving
	Answering memo
	Internal memory low
	Software update available
	Icons collected

### Main Status Icons

Icon	Description
	Time
	Battery level 100%/  empty/  charging
	Airplane mode is set
	Signal strength (Receiving electric field) : level 4 : out of range : in communication <ul style="list-style-type: none"> <li>An icon for the network is displayed.</li> <li>: 4G (LTE) available : Roaming</li> </ul>
	au Nano IC Card 04 uninserted
	Manner mode status : Manner mode : Drive mode : Silent mode : Original mode
	During a call using hands-free
	Ringtone volume at "0"
	In-call microphone is "OFF"
	Wi-Fi® signal strength : Level display : in communication
	Answering memo set : set/ : full

## Using the Notification/Settings Panel

In the notification panel, you can check notifications and activate applications.

In the settings panel, you can quickly toggle Wi-Fi®, Bluetooth®, and other applications on/off.

### 1 Hold down **F2**

The notification/settings panel is displayed.

- When the standby screen is displayed, you can also press → select the status bar → to display the notification/settings panel.

### Viewing the Notification/Settings Panel

Press to toggle between the notification panel and settings panel.

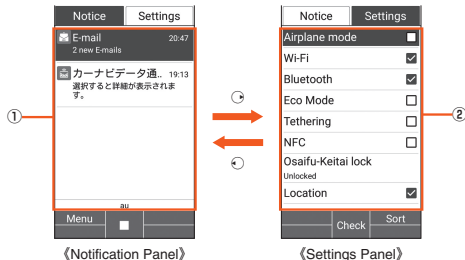

#### ① Notification area

Check product status and notification content.

#### ② Settings menu

Set frequently-used functions on/off.

## Using the Notification Panel

### 1 Select notification you want to use in the notification panel →

You can activate the application corresponding to a notification.

### Deleting Notifications

### 1 Select notification you want to delete in the notification panel → (Menu) → [Delete one] → [YES] → [OK]

Select "Delete all" to delete all notifications. Some notifications, such as for battery level, cannot be deleted.

## Using the Settings Panel

Example: To toggle Wi-Fi® on/off

### 1 In the settings panel, [Wi-Fi]

Press to toggle Wi-Fi® on/off.



#### memo

- Press / while the notification/settings panel is displayed to hide the notification/settings panel.

## Using the Sub-display

The sub-display displays device status such as the manner mode and battery level, the date and time, caller name, and other information.

The sub-display lights when you press (マナー/サイヤウ) while the product is closed or after you close the product.

### ■ Viewing the Sub-display



### ■ Main Icons

Icon	Description
	Signal strength (received field strength) Strong/  Fair/  Weak/  Faint/ Out of range/  Airplane mode is set
	Battery level 100%/  empty/  charging
	Manner mode status : Manner mode       : Drive mode : Silent mode       : Original mode
	Missed call
	New e-mail
	New SMS

## Using the Main Menu

### 1 When the standby screen is displayed, press

The main menu is displayed.

### 2 Select menu →

Menu items correspond to the number keys (0 - 9, \*, #). Press a key to select a menu item.

### ■ Viewing the Main Menu

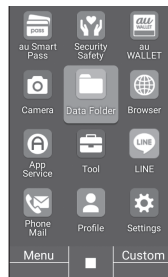

《Main Menu》

## ■ Main Menu Application List

Menu	Description
au Smart Pass	You can enjoy as many applications as you want from among over 500 apps. Also coupons, presents, data storage and security apps are available. Please enjoy your safety and comfortable smartphone life.
Security/Safety	
au お客さまサポート (au Customer Support)	You can check the subscriber contents or monthly usage of your au phones etc. with this application. You can change your rate plan, apply for optional services and so on at au Customer Support website.
au 災害対策 (au Disaster Countermeasure)	This is an application in which you can use Disaster Message Board, Emergency Rapid Mail (Earthquake Early Warning and Disaster and evacuation Information and Tsunami Warning ) and Disaster Voice Messaging Service. (▶P.5)
Data Storage App	You can back up various data in your smartphone to "au Smart Pass" (cloud storage) or SD card. You can also migrate your data between your phones with this app.
リモートサポート (Remote support)	Call for technical supports on the phone operations by sharing the screen that you are watching with au operators.

Menu	Description
Security/Safety	
Safety Access	This is an application which limits the access to the inappropriate applications and web pages so that your child can use a smartphone safely.
au WALLET	This is an application for a more effective use of au WALLET CARD. You can charge your au WALLET CARD, check the card balance, the point balance, the privilege and so on conveniently, through the screen optimized for smartphone.
Camera	Capture photos/movies. (▶P.76)
Data Folder	View captured photos/movies, downloaded files, etc.
Browser	View webpages in the same way as a computer. (▶P.73) The browser is a Touch Pointer-capable application.
App/Service*	
LISMO	With LISMO application, you can enjoy music, find hot music information, try and purchase songs.
LISMO Store	Find many new and popular songs, albums, videoclips, enjoy previewing and shopping them easily.
au WALLET Market	au Wallet Market is a new service that is designed to help you fulfill your living needs and well-being through purchasing "little fine products" via e-commerce and au shops. You can check your purchased items, and also change your orders at your nearest au shops or e-commerce(LUXA).

Menu	Description
App/Service*	
ウイルスバスター for au (VirusBuster for au)	Blocks improper applications and sites in order to protect young people.
Uta Pass	Music streaming service that all-you-can-listen. Enjoy varieties of over 400 channels from 60's to now.
au ショッピングモール (au Shopping Mall)	This is an official application of "au Shopping Mall" where you can enjoy online shopping for Smartphone Accessories, Foodies, Apparels, and More.
au 助手席ナビ (au joshu-seki navi)	Joshuseki-Navi (passenger seat navigation) is a car navigation service to be used by those sitting in the passenger seat.
au ナビウォーク (au navi walk)	Helps you navigate route combining public transportation and walk.
モバオク (Mobaoku)	Connect to the Mobaoku auction site.
モバイル Suica (Mobile Suica)	Suica and smartphones have become one, more convenient mobile Suica.

Menu	Description
Tool	
Alarm	Use an alarm.
Calendar	Use a calendar.
Notepad	Use a notepad.
Calculator	Use a calculator.
Infrared	Exchange data between the product and an infrared-capable device.
Osaifu-Keitai	Use Osaifu-Keitai® services.
TV	View digital terrestrial broadcast service (1Seg) for mobile devices. (▶P.77)
Flashlight	Use a flash light.
Sound Recorder	Use a sound recorder.
Barcode Reader	Use a barcode reader.
Eco Mode	Use Eco Mode.
Countdown Timer	Use a countdown timer.
Stopwatch	Use a stopwatch.
au Wi-Fi接続ツール (au Wi-Fi connection tool)	You can easily set up Wi-Fi connection with the private access points such as "HOME SPOT CUBE." You can use the all au's public Wi-Fi spots. You can also find the location/venue information to provide au Wi-Fi.
Mimamori support	Use 安心ナビ (anshin navi), mamorino/miraie navi, and mamorino Watch navi.
auシェアリンク (au share link)	This application allows you to enjoy the convenience of having both a cell phone and tablet. View notifications for new calls and e-mail (@ezweb.ne.jp) to your cell phone on a tablet, as well as be able to operate your cell phone from a tablet screen.



Menu	Description
Tool	
GLOBAL PASSPORT	Check applicable charges, how to make settings, and how to make calls while abroad according to your destination.
Kanji Check	Use a kanji checker.
OfficeSuite	View Word, Excel, and other files. OfficeSuite is a Touch Pointer-capable application.
LINE	LINE is a new communication application which allows you to make free voice calls and send free messages whenever and wherever. (▶P.71) LINE is a Touch Pointer-capable application.
Phone/Mail	
Call Log	View incoming and outgoing histories as well as call frequency. (▶P.55)
Phone Book	Register contacts to the phone book and use registered information. (▶P.61)
Call Settings	Make call settings.
Speed dial	Display the speed dial list. (▶P.56)
Voice Party	Call with up to 30 people. (▶P.58)
E-mail	Exchange mail using an e-mail (@ezweb.ne.jp) address. (▶P.66)
SMS	Exchange SMS with phone number destinations. (▶P.68)
Profile	Check and edit your profile. (▶P.60)
Settings	Set and manage functions from a settings menu. (▶P.80)

\* Downloaded and added applications appear in "Free" (▶P.47).



## memo

- Some functions used with activated functions may incur communication charges.
- After application version upgrades, etc., the appearance of applications and icons on the product may differ from as shown in this manual.
- Preinstalled applications are not deleted even after performing an all reset.

## Using Applications/Services

Use installed applications and download additional applications with "App/Service".

### 1 When the standby screen is displayed, press → [App/Service]

The App/Service screen is displayed.

- When the standby screen is displayed, you can also hold down to display the App/Service screen.
- Press to toggle tabs.

### 2 Select the application →

## Searching for applications





### 1 When the App/Service screen is displayed,

- Display the Free tab.

### 2 (Get app)



The au Smart Pass site is displayed. Follow the on-screen instructions to search for and download the application.

## Changing the Main Menu

- 1 When the standby screen is displayed, press  →  (Menu)
- 2 [Change] →   to select a menu item → 



## Updating LINE

Update the LINE application.



- 1 When the standby screen is displayed, press  → Select "LINE" →  (Menu)
- 2 [Update]  
Continue by following the on-screen instructions.

## Using the Custom Menu



Register preferred applications to the custom menu for quick access.

- 1 When the standby screen is displayed, press  →  (Custom)  
The custom menu is displayed.
- 2 Select an application → 





## Registering Applications to the Custom Menu

- 1 In the custom menu, select where you want to register an application →  (Menu)
- 2 [Add] → Select an application → 

## Rearranging Applications

- 1 In the custom menu, select the application you want to rearrange →  (Menu)
- 2 [Sort] → Select the location where you want to rearrange the application → 

## Deleting Applications

- 1 In the custom menu,  (Menu)
- 2 [Delete] → Checkmark the application you want to delete →  (Delete)
  - The checkmarked application is deleted.
  - You can select all with , and delete all with .

## Learn Common Operations

### Learn Basic Key Operations

#### Using Functions that Appear at the Bottom of the Screen

Press the key corresponding to a function that appears at the bottom of the screen.



- ① For "HF ON", press
- ② For "Menu", press
- ③ For "Mic OFF", press
- ④ For "Setting", press
- ⑤ For "Profile", press

#### To Select Items

To select a displayed item, select the item using or and press .

#### To Return to Previous Screen

You can press to go back one screen.

#### To Return to the Standby Screen

To return to the standby screen from any function, press .

- After a certain period of no key operation, the product may return to the standby screen automatically.
- If activating a function while in a call, the call may be interrupted.
- The function or application being used is ended.

#### To Enter Numbers

You can press to to enter numbers.

If "▲" and "▼" are displayed above and below the number entry field, you can press to increase or decrease the number.

#### To Move to Previous or Next Data

While displaying mail, etc., you can press to move to the next data or to move to the previous data.

#### To Scroll the Page

When browsing a webpage or displaying a mail list, message, data list, etc., you can press to scroll up or to scroll down.

## Using Checkboxes

If a checkbox is displayed next to a setting item, you can select the item or the checkbox to enable or disable the item.

When performing operations on data such as "Copy multiple" or "Delete multiple", you can select checkboxes to select or deselect items.

Icon example	Description
<input checked="" type="checkbox"/>	Setting is enabled or item is selected.
<input type="checkbox"/>	Setting is disabled or item is not selected.

## Disabling Manner/Shutter Key Operation when the Product is Folded

### 1 When the standby screen is displayed, hold down

 → [OK]

After closing the product,  is disabled.

Hold down  again to enable.

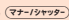
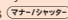

### memo

- Even if you disable  and close the product, you can press  to stop alarms, mail ringtone, and other notification tones.

# Learn How to Enter Characters

## ■ Key Assignments for Character Entry





Character type	Hiragana/kanji	2-byte alphabet	Numbers (2-byte/1-byte)
1	▶ あいうえおあいうえお	▶ @_ / : ~ ? , ' ! 1	1
	Katakana (2-byte/1-byte)	1-byte alphabet	Dial entry
	▶ アイウエオアイウエオ	▶ @- / : ? , ! 1	1
2	▶ かきくけこ	▶ a b c A B C 2	2
	Katakana (2-byte/1-byte)	1-byte alphabet	Dial entry
	▶ カキクケコ	▶ abcABC2	2
3	▶ さしすせそ	▶ d e f D E F 3	3
	Katakana (2-byte/1-byte)	1-byte alphabet	Dial entry
	▶ サシスセソ	▶ defDEF3	3
4	▶ たちつてとっ	▶ g h i G H I 4	4
	Katakana (2-byte/1-byte)	1-byte alphabet	Dial entry
	▶ タチツテトッ	▶ ghiGHI4	4



Character type	Hiragana/kanji	2-byte alphabet	Numbers (2-byte/1-byte)
5	▶ なにぬねの	▶ j k l J K L 5	5
	Katakana (2-byte/1-byte)	1-byte alphabet	Dial entry
	▶ ナニヌネノ	▶ jklJKL5	5
6	▶ はひふへほ	▶ m n o M N O 6	6
	Katakana (2-byte/1-byte)	1-byte alphabet	Dial entry
	▶ ハヒフヘホ	▶ mnoMNO6	6
7	▶ まみむめも	▶ p q r s P Q R S 7	7
	Katakana (2-byte/1-byte)	1-byte alphabet	Dial entry
	▶ マミムメモ	▶ pqrsPQRS7	7
8	▶ やゆよやゆよ	▶ t u v T U V 8	8
	Katakana (2-byte/1-byte)	1-byte alphabet	Dial entry
	▶ ヤユヨヤユヨ	▶ tuvTUV8	8
9	▶ りりるれろ	▶ w x y z W X Y Z 9	9
	Katakana (2-byte/1-byte)	1-byte alphabet	Dial entry
	▶ ラリルレロ	▶ wxyzWXYZ9	9

Character type	Hiragana/kanji	2-byte alphabet	Numbers (2-byte/1-byte)
○			0
	Katakana (2-byte/1-byte)	1-byte alphabet	Dial entry
			0

\* When entering at the start of a line, a capital letter is displayed first.

Character type	Hiragana/kanji	Katakana (2-byte/1-byte)	Alphabet (2-byte/1-byte)	Numbers (2-byte/1-byte)	Dial entry
✖	Toggle large/small (where characters allow) Add * (ten-ten) or ° (maru) (where characters allow)		Toggle large/small (where characters allow) When characters finalized,	*	Short press ... ✖ Hold down ... + (plus)
Character type	Hiragana/kanji	Katakana (2-byte/1-byte)	Alphabet (2-byte/1-byte)	Numbers (2-byte/1-byte)	Dial entry
#	When entering text, display one character before (back function) When characters finalized, linebreak			#	Short press ... # Hold down ... ; (pause)
Character type	Hiragana/kanji	Katakana (2-byte/1-byte)	Alphabet (2-byte/1-byte)	Numbers (2-byte/1-byte)	Dial entry
☰	Display function quoting, useful phrases, etc. from menu Toggle normal conversion and prediction conversion (when character type is *あ漢*)				—
Character type	Hiragana/kanji	Katakana (2-byte/1-byte)	Alphabet (2-byte/1-byte)	Numbers (2-byte/1-byte)	Dial entry
@	When entering text, display list of Emoji, DEmoji, (^_^)(facemarks), or Symbol Toggle Emoji, DEmoji, (^_^)(facemarks), and Symbol lists				—

Character type	Hiragana/ kanji	Katakana (2-byte/1-byte)	Alphabet (2-byte/1-byte)	Numbers (2-byte/1-byte)	Dial entry
	Toggle character type Toggle page/category (when Emoji, DEmoji, (^_^)(facemarks), Symbol, or conversion candidates selected)				—
Character type	Hiragana/ kanji	Katakana (2-byte/1-byte)	Alphabet (2-byte/1-byte)	Numbers (2-byte/1-byte)	Dial entry
	Undo finalized characters Toggle page/category (when Emoji, DEmoji, (^_^)(facemarks), Symbol, or conversion candidates selected)				—
Character type	Hiragana/ kanji	Katakana (2-byte/1-byte)	Alphabet (2-byte/1-byte)	Numbers (2-byte/1-byte)	Dial entry
	Move cursor left Select conversion candidate During prediction conversion, shorten selected range				—
Character type	Hiragana/ kanji	Katakana (2-byte/1-byte)	Alphabet (2-byte/1-byte)	Numbers (2-byte/1-byte)	Dial entry
	Move cursor right Select conversion candidate During prediction conversion, shorten selected range When cursor at end of text string, enter 1-byte space				—
Character type	Hiragana/ kanji	Katakana (2-byte/1-byte)	Alphabet (2-byte/1-byte)	Numbers (2-byte/1-byte)	Dial entry
	Move cursor up a line Select conversion candidate				—

Character type	Hiragana/ kanji	Katakana (2-byte/1-byte)	Alphabet (2-byte/1-byte)	Numbers (2-byte/1-byte)	Dial entry
	Move cursor down a line Select conversion candidate When cursor at end of text string, linebreak				—
Character type	Hiragana/ kanji	Katakana (2-byte/1-byte)	Alphabet (2-byte/1-byte)	Numbers (2-byte/1-byte)	Dial entry
	Short press . . . Delete 1 character to right of cursor If no character to right of cursor, delete 1 character to left When selecting conversion candidate, stop conversion and delete 1 character				Short press . . . Delete 1 place
	Hold down . . . Delete all characters to right of cursor When cursor is at start or end of text string, delete all characters				Hold down . . . Delete all

## Making Calls

### Entering a Phone Number and Making a Call

#### 1 When the standby screen is displayed, enter phone number

The dial screen is displayed and the number is entered.

: Move cursor position

: Delete one number place

 (Hold down): Return to standby screen

 (Register): Register an entered number to the phone book.  
(▶P.61)

#### 2 → Talk

 (HF ON/HF OFF): Hands-free call on/off

 (Setting): Adjust how the other party sounds.

 (Mic OFF/Mic ON): Mute on/off

 (Profile): Display profile

: Adjust call volume (volume of other party's voice)

: Place call on hold

: Voice memo

#### 3

- You can also fold the product to end a call.

#### memo

- Call charges for calls made with "1401" added are subtracted from the registered balance on an au prepaid card that you have bought.
- Note that even if you cover the microphone, sound can be conveyed to the other party.
- Even if "Airplane mode" is set, you can call emergency numbers (110, 119, 118).

### Emergency Call Location Notification

The product supports "Emergency call location notification" so that if you make an emergency call to Police, Fire and Ambulance or Regional Coast Guard Headquarters, your current location (GPS information) will be transmitted to the agency receiving the emergency call.

#### memo

- VoLTE (LTE network) by au is used when connecting with emergency organizations within Japan. You cannot connect using 3G (circuit-switched network).
- In this section, Police (110), Fire and Ambulance (119) and Regional Coast Guard Headquarters (118) are collectively referred to as the emergency call receiving agency.
- This feature may not yet be available at some emergency call receiving agencies.
- If you add "184" before the Japan emergency call number 110/119/118, the emergency call responding agency will not be notified of your location, the same as your phone number.
- In places where signal reception from GPS satellites or a base station is relatively poor, such as in an underground mall, inside a building or behind a tall building, the emergency call receiving agency may be notified of some other place different from your actual location.
- When GPS cannot be used to notify of your location, base station signal is used instead.
- When making an emergency call to Police, Fire and Ambulance or Regional Coast Guard Headquarters, always confirm where you are, and tell them your exact location on the phone. Note that depending on the area where you are calling, your call may not be connected to the agency having jurisdiction over that area.



- Ⓞ If the emergency call receiving agency determines that human lives and health are in danger, they will be able to acquire the caller's location information during the call or within a certain period of time after the call.

## ■ Using ; (Pause) Dialing and Making a Call

Enter the push signals to send beforehand and then press  during the call to send the push signals. This is a convenient feature when using information services and automatic reservation services.

**Example: To dial "03-0001-XXXX (bank phone number)" and send the branch "22X" and the account "123XX"**

### 1 Enter phone number → Hold down

The first ; (pause) is entered.

### 2 Enter push signals to send

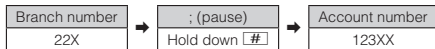

The second ; (pause) is entered.

\* Enter a ; (pause) between several push signals to send them linked together.

### 3 → [Yes] → [Yes]

After dialing, a confirmation screen is displayed. Confirm that the destination has answered the call and then select "Yes". A push signal is sent each time you select "Yes" and press .



## memo

- Ⓞ Pause dialing may not be sent correctly if transmission signal is poor.

## Using Call Histories and Making a Call

### 1 When the standby screen is displayed, press (Outgoing history)/ (Incoming history)

The outgoing history/incoming history screen is displayed.

In addition to outgoing and incoming histories, you can also check outgoing call frequency.

- Press  to toggle the outgoing history, incoming history, and call frequency screens.

: Incoming call

: Incoming call (Answering memo)

: Missed call

: Missed call (Answering memo)

: Missed call (one-ring phone scam\*)

: Call rejected

: Outgoing call

\* Missed calls of less than 3 seconds are deemed to be one-ring phone scam calls. These may be calls to get the customer to call back and connect them to a malicious pay-for program. Use caution.

### 2 Select contact to call from history →

Place a call to the selected person.

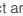
- Select an entry in the outgoing history/incoming history screen →  and the outgoing history/incoming history details screen is displayed. Details cannot be displayed from the call frequency screen.

## Using Speed Dial and Making a Call

You can make calls quickly to contacts registered to speed dial.

### Registering to Speed Dial

- 1 When the standby screen is displayed, press → [Phone/Mail] → [Speed dial]
- 2 Select <Not Registered> for the number to register → (Edit)
  - If a number is selected with a destination already registered, operations such as dialing are available.
- 3 Select the destination to register →

### Dialing with Speed Dial

- 1 When the standby screen is displayed, enter the speed dial number (0 to 99)
  - 2
- You can also press (Call) to make a call.

## Calling Overseas from au Phones (au International Call Service)

You can make international calls without any special procedure from the product.

**Example: To call "212-123-XXXX" in the USA from the product**

- 1 Enter the international access code "010"  
Holding down in the dial screen enters a "+" and adds "010" when the number is dialed.
- 2 Enter the country code of the USA "1"
- 3 Enter the area code "212"  
If the area code starts with "0", dial it without including the "0"  
(There are some exceptions such as fixed-line phones in some countries or regions including Italy and Moscow).
- 4 Enter the phone number of the other party  
"123XXXX" →



### memo

- You can also press (Call) → [Add Special No.] → [Intl Call] to enter the country code when entering a phone number.
- The monthly limit fee is set for the au International Call Service. The au International Call Service is unavailable from when the limit fee is confirmed to be exceeded until the end of the same month.
- Even if you cannot use the service by exceeding the limit fee, you can use from the first day of the next month. Also, you can use the domestic call as usual while the service is stopped.
- International call charges are billed together with monthly local call charges.

- If you do not wish to use the service, you can set not to use the au International Call Service.  
For au International Call Service:  
From au phones **157** (area code not required) (toll free)  
From fixed-line phones  **0077-7-111** (toll free)  
Open 9:00 to 20:00 (everyday)

## Receiving Calls

### Answering an Incoming Call

#### 1 When a call is arriving, / (Answer)

The call starts.

#### 2 Talk →

#### Screen when a Call Arrives

The following is displayed when a call arrives.

- If the other party's number is sent, it is displayed. If the number is registered in the phone book, their name and other information is also displayed.
- If the other party's number is not sent, the reason is displayed.  
"ID Unsent" "Pay Phone" "Not Support"  
\* The other party is calling from a phone unable to send the number.





#### memo

- If you are not subscribed to LTE NET or LTE NET for DATA, set "Cellular data" in "Data usage" off.

#### If you did not answer a call

- \* is displayed in the status bar.

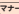
#### To turn the ringtone off or adjust it as a call is arriving

- Press  as a call is arriving to turn the ringtone off.
- Press  as a call is arriving to change the volume of the ringtone.

#### If a call arrives while you are using another function

- If you are using the phone book or other function when a call arrives, the call takes priority.
- If you were recording a movie, recording stops and recorded data is saved.

## Rejecting an Incoming Call

### 1 When a call is arriving, (Reject)

The ringtone stops and the incoming call is disconnected. The other party will hear voice guidance.

- As a call is arriving, you can also press  to reject the call.

## Using au VoLTE

### Using Voice Party (Optional Service)

Voice party is a voice service that allows up to 30 people including the caller to call at the same time, regardless of the type of device the other parties may have.

#### 1 When the standby screen is displayed, press → [Phone/Mail] → [Voice Party]

If a confirmation screen is displayed, confirm the content and follow the on-screen instructions.

#### 2 (Add)

Phone Book	Add phone number in phone book to members.
Direct Input	Directly enter phone number or enter from the history to add to members. You can also set a number from the outgoing/incoming call history by selecting "History".

#### 4 → Talk

Select member who has not answered yet/you are talking with →  (End) to end call.

Select a non-present member →  (Call) to place a call to the member.

#### 5



## memo

- Voice party requires a subscription.
- Call charges to the caller are according to the number of callees (number of people).
- Calls with this feature cannot be made to emergency responders (110, 119, 118) or time information (117) and other special numbers.
- When placing a call with Voice party, your phone number is sent regardless of the "Accept Caller ID" setting.
- After the call is initiated, no answer from any of the callees within 20 seconds causes Voice party to end.
- The caller and callees cannot make a three-party call with Voice party at the same time.
- The caller and callees cannot use call waiting during Voice party.
- The caller and callees cannot send push-tones during Voice party.
- Callees using call answering or call forwarding cannot participate in Voice party.
- A device supporting au VoLTE and receiving a Voice party call cannot answer with Answering memo.
- Callees can only see the name and phone number of the caller, and cannot see those of other members.

## Using the Voice Party Menu



**1** When the standby screen is displayed, press → [Phone/Mail] → [Voice Party]

**2** (Menu)





<b>3</b> Delete	Delete 1 or selected Voice Party members.
Call settings	Make call settings.

## Checking Your Phone Number

### Checking Your Profile

- 1 When the standby screen is displayed, press  → [Profile]**  
The profile screen is displayed.
  - When the standby screen is displayed, you can also press  →  to check.

### Editing Your Profile

- 1 When the profile screen is displayed, press  (Menu) → [Edit]**  
The profile edit screen is displayed.
- 2 Enter required items**
  - During editing, you can add items by pressing  (Menu) → [Add another field] → checkmark the item to add →  (Add).
- 3  (Set) → [OK]**



#### memo

- Items to note when editing your profile are the same as for editing the phone book. For details, refer to "Registering to the Phone Book" (▶ P.61).
- When the profile screen is displayed, you can reset your profile by pressing  (Menu) → [Reset] → [Yes] → [OK].

## Registering to the Phone Book

You can register contact information including phone number and e-mail address. You can also set ringtone, vibration, etc. individually for contacts.

### 1 When the standby screen is displayed, press **[M]** (hold down)

The phone book edit screen is displayed.

### 2 Set required items

- During editing, you can add items by pressing **[M]** (Menu) → [Add another field] → checkmark the item to add → **[A]** (Add).

### 3 **[S]** (Set) → **[OK]**



#### memo

- If the number is a landline number, enter the area code first.
- If the name includes 1-byte alphabet and numbers, it may be displayed in the order of given name, family name.
- If a caller's number is withheld, "Incoming settings" does not operate.
- Numbers and names registered in the phone book can become erased due to accident or malfunction. Keeping a separate copy of numbers and other important information is recommended. The Company is not liable for any damages or lost profits whatsoever due to alteration or loss of contact information resulting from accident or malfunction.
- To not usually display a certain contact, set "Secret Setting" to ON. To display a secret contact, change the setting with "Settings".

## Using the Contacts List

### Displaying the Contacts List

#### 1 When the standby screen is displayed, press **[M]**

When the contacts list is in "Group" view, a list of groups is displayed. Selecting a group displays a contacts list for that group.

#### Viewing the Contacts List

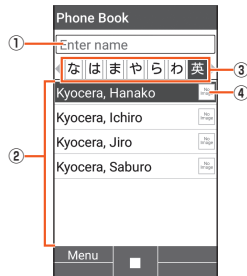

《Contacts List (Name Order)》

#### 1 Search by number keys

You can search for contacts by pressing the number keys in the contacts list and entering yomigana readings. Pressing the **[DEL]** key deletes yomigana and ends search.

#### 2 Contacts

Contacts are displayed for the selected tab.

#### 3 Tabs

#### ④ Image

An image is displayed if registered.



memo

○ Press to switch tabs.

## Using Information Registered for Contacts

- 1 When the standby screen is displayed, press →  
Select the contact →

## ■ Viewing Phone Book Details

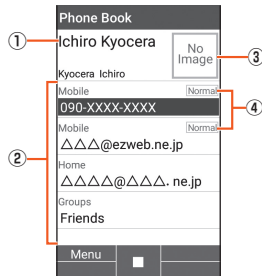

《Phone Book Details》

- ① Name
- ② Registered information
- ③ Image
- ④ Normally used phone number/normally used e-mail address



memo

- You can make calls, create e-mail, etc. by selecting registered information and pressing .
- You can set a normally used phone number/e-mail address by selecting a phone number/e-mail address and pressing → [Default phone No.].
- You can press (Menu) → [Edit] to edit registered information.



## Checking E-Mail

Received e-mail is saved in the "Inbox". Sent e-mail is saved in the "Outbox". Received and sent e-mail that meets filtering criteria is saved in a designated folder.

E-mail that was saved without being sent and send-failed e-mail is saved in the "Unsent" box.

### 1 When the standby screen is displayed, press

The folder list is displayed.



### 2 [Inbox] / [Outbox] / [Unsent] / Select folder →

The e-mail list is displayed.

-  (3Line/2Line): Switch mail list views.

### 3 Select e-mail →

The e-mail message is displayed.

-  (Prev): View previous e-mail
-  (Next): View next e-mail



## memo

- Once the capacity of the "Inbox" is exceeded, oldest read e-mail is automatically deleted. E-mail that is unread, protected, or for which the text body is unreceived is not deleted.
- New e-mail cannot be received if the "Inbox" is full and it contains all unread e-mail.
- Once the capacities of the "Outbox" and "Unsent" box are exceeded, oldest sent e-mail is automatically deleted. If there is no sent e-mail that can be deleted, send-failed e-mail is deleted, followed by unsent e-mail. Protected e-mail is not deleted.

## Viewing the Folder List

In the folder list, the "Inbox", "Outbox", folders, etc. are displayed. Folders created by selecting "Create new folder" are displayed.

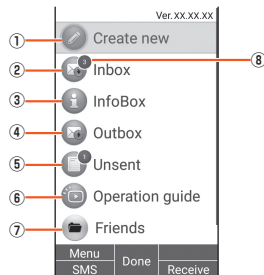

《Folder List》

- 1 Create new
- 2 Inbox
- 3 InfoBox  
View InfoBox mail.
- 4 Outbox
- 5 Unsent
- 6 Operation guide
- 7 Folder
- 8 Number of unread/unsent e-mail

## ■ Viewing the E-mail List



《Received E-mail List》

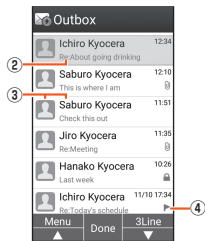

《Sent E-mail List》

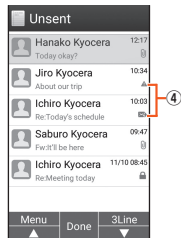

《Unsent E-mail List》

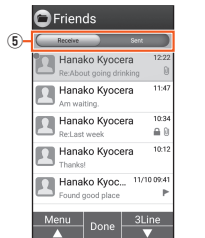

《E-mail List (Folders)》

- ① ● : Unread e-mail  
○ : E-mail with unreceived text body

② **Subject**

③ **Recipient's/sender's name or e-mail address**

The registered image/name is displayed if the e-mail address is registered in the contacts. If the e-mail address is unregistered, the e-mail address is displayed.

If a sender designation is set for the received e-mail, the set name is displayed.

- If the e-mail address is registered in the contacts, the registered name takes priority.

④ **Icons**

- ← : Replied-to e-mail
- ➡ : E-mail that has been forwarded
- ↩ : Replied-to e-mail/e-mail that has been forwarded
- 📎 : Electronic file attached
- 🔒 : Protected mail
- 🚩 : Flagged e-mail
- ⚠ : Send failure mail
- 🔄 : Auto-resend e-mail
- 🚫 : E-mail text unreceivable due to no mail on server

⑤ **Received/sent slider**

Switch between received and sent e-mail lists in a folder.

## ■ Viewing an E-mail Message

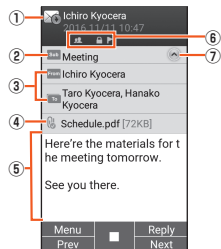

《Received E-mail Message》

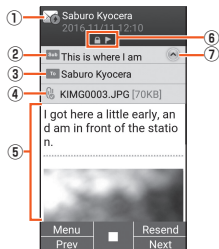

《Sent E-mail Message》

### ① Recipient's/sender's name or e-mail address

### ② **Subject**

### ③ **From** : Sender's name or e-mail address

**To** / **CC** / **BCC** : Recipient's names or e-mail addresses

### ④ Electronic file

- : Saved electronic file
- : Save-failed electronic file
- : Saved inline electronic file
- : Unreceived electronic file
- : Receive-failed electronic file

### ⑤ Mail text

### ⑥ Icons

- : Replied-to e-mail
- : E-mail that has been forwarded
- : Replied-to e-mail/e-mail that has been forwarded
- : Multiple recipients
- : E-mail received with BCC recipients
- : E-mail waiting to be automatically resent
- : Send-failed e-mail
- : Protected mail
- : Flagged e-mail

### ⑦ : Show/hide details

## Sending E-mail

- 1** When the standby screen is displayed, press  → **[Create new]**

The e-mail create screen is displayed.

- 2** Select "" for the address entry field → 

You can also enter the recipient directly in the address entry field.

<b>3</b> Address book	Enter e-mail address from contacts as a recipient.
Address group	Enter all e-mail addresses registered to a contacts group as the recipients. If the number of e-mail addresses in the group exceeds the limit available for recipients, addresses are entered up to the limit.
Receive history	Select and enter an e-mail address from the received e-mail history/sent e-mail history.
Send history	Select and enter an e-mail address from the received e-mail history/sent e-mail history.
Profile	Enter own e-mail address as recipient.
Paste	Paste copied e-mail address.

\* Items displayed depend on conditions.

- 4** Select subject field →  → **Enter subject**

- 5** Select text field →  → **Enter text**

- 6**  **(Send)** → **[Send]**



## memo

- You can press  (Save) in the e-mail create screen to save e-mail that is being created to the "Unsent" box.
- デコレーションアニメ (decoration anime) is not supported.
- In the subject or text, you cannot enter 1-byte katakana or 1-byte Japanese symbols (— \* ° · [ ]).
- Up to 1000 e-mails as the total for all recipients can be sent in one day.
- One e-mail can be sent to up to 30 recipients (including To, Cc, Bcc, up to 64 1-byte characters per e-mail) at a time.
- Emoji sent to an other-brand cell phone, PC, etc. may sometimes be converted to the other-brand emoji or may not be displayed properly. Emoji sent to another au phone may sometimes be converted to an older-version au emoji.
- The confirmation screen when sending an e-mail can be disabled with "Confirmation dialog before sending".
- By setting "Automatic resend" to ON, you can have failed e-mail automatically sent again later.
- You can insert up to 20 (totaling up to 100 KB) DEmoji in the mail text.  
\* A same entered DEmoji can be entered repeatedly any number of times.

## ■ Adding/Deleting Recipients

### ■ Adding a recipient

- 1 E-mail create screen** → Select "✚" for empty address entry field → ●

A menu for selecting a recipient entry method is displayed. Refer to step **3** of "Sending E-mail".  
You can also add recipients by entering them directly in the address entry field.

### ■ Deleting a recipient

- 1 E-mail create screen** → Select "✕" for recipient to delete → ● → [Delete]



#### memo

- You can change the recipient type by selecting "To" → ● You cannot change the recipient type for the topmost recipient.

## Receiving E-mail

### 1 Receive E-mail

Once an e-mail is received, you are notified of the new mail in the following ways.

- "✉" is displayed in the status bar, and the ringtone sounds.
- The e-mail address, name, and subject are displayed in the status bar. If a sender designation is set for the received e-mail, the set name is displayed. If the e-mail address is registered in the contacts, the registered name takes priority.
- The charging/notification indicator flashes.
- If the product is folded, "✉" is displayed in the sub-display. The e-mail address (or name registered in the phone book if the e-mail address is registered there) is displayed.

- 2 When the standby screen is displayed, press**  → [Inbox]

The e-mail list is displayed.

- 3 Select a received e-mail** → ●

The e-mail message is displayed.



#### memo

- E-mail is received in the background even while using e-mail or other functions. "✉" is displayed in the status bar and a ringtone sounds. However, e-mail is not received in the background if "Auto-recvie" is set to OFF.
- If "Auto-recvie" is set to OFF or there is a receive failure, a ringtone sounds and "✉" is displayed. Use "Receive" to receive the e-mail.
- Packet fees may be incurred even if mail is not properly received due to reception conditions or the data being received.

- The maximum size of mail text that can be received is 1 MB per e-mail. If a mail text exceeds that, a message appears at the end of the received portion indicating that it is truncated.
- Received e-mail may not be correctly displayed depending on the content of the mail.

## Inquiring for and Receiving New Mail

You can inquire for and receive new mail if "Auto-receive" is set to OFF or there was an e-mail receive failure.

### 1 When the standby screen is displayed, press

The folder list is displayed.



### 2 (Receive)

Confirm whether there is new e-mail.

## Sending SMS

Send messages (mail text body) with kanji, hiragana, katakana, alphabet and numbers, symbol, Emoji, and (^\_^)(facemarks).

### 1 When the standby screen is displayed, press (hold down)

Alternatively, to access the screen from the standby screen,  →  (SMS).

A thread list grouped by contact is displayed.

### 2 (New Msg)

The SMS create screen is displayed.

- When sending to a contact you have exchanged SMS with before, you can also select the thread to create SMS. In this instance, proceed to step **4**.

### 3 Select the recipient entry field → Enter the contact's phone number

Alternatively, select "" to specify a recipient from the phone book.

Before sending SMS overseas, enter "010" and the "country code" at the start of the phone number for the recipient.

"010" + "country code" + "phone number for recipient"

- \* If quoting the cell phone number for the recipient from the phone book, etc., select the recipient entry field again and enter "010" and the "country code".
- \* If the cell phone number for the recipient starts with a "0", enter the number without the "0".

### 4 Select text field → Enter text

You can enter up to 70 2-byte/160 1-byte characters in the mail text.

## 5 (Send)

Select a sent message →  (Menu) → [Result Delivery Report] to check the send result.



### memo

- Before step 5, you can press  to display "Draft" in the thread list and save mail without sending it.
- The SMS center holds SMS as follows.

Time holdable (accumulated)	Up to 72 hours * SMS that has accumulated for more than 72 hours is erased.
Number holdable	Unlimited * It may not be possible for the SMS center to hold SMS depending on conditions of the receiving customer's phone/service use or the sending customer's phone model.

- Accumulated SMS is delivered at the following times.

Delivered soon after accumulating	All SMS held at the SMS center is delivered each time new SMS accumulates.
Delivery by retry function	If SMS could not be delivered soon after accumulating, such as when the other party was in poor signal conditions or your product was powered off, SMS is repeatedly sent to them by the retry function.
Delivery after completion of call	If SMS could not be delivered soon after accumulating, all SMS held at the SMS center is delivered once you complete a call on the product.

\* The time that SMS is delivered may differ with international SMS.

- SMS cannot be sent without displaying the number of the sender.

- Emoji sent to an other-brand cell phone may sometimes be converted to the other-brand emoji or may not be displayed properly. Emoji sent to another au cell phone may sometimes be converted to an older-version au emoji.
- A "▲" may be displayed, although rarely, for a sent message that was sent successfully but where signal was weak, etc.
- For details on international SMS, refer to the au homepage.  
<http://www.au.kddi.com/mobile/service/global/sms/>

## Receiving SMS

### 1 Receive an SMS

Once an SMS is received, you are notified of the new mail in the following ways.

- A new SMS icon is displayed in the standby screen, "SMS" in the status bar, and a mail ringtone sounds.
- If the product is folded, "SMS" is displayed in the sub-display.
- The charging/notification indicator flashes.

### 2 When the standby screen is displayed, press (hold down)

The SMS thread list is displayed.

"" is displayed for threads with unread SMS.

### 3 Select the thread for the contact to check →

The content of the thread that includes the received SMS is displayed.



#### memo

- Receiving SMS is free.
- You can confirm the phone number of the sender with received SMS.
- Received SMS may not be correctly displayed depending on the content of the mail.
- While data is being backed up or restored with the Data Storage App, do not exit the SMS app. This may prevent data from being properly received.



## Using LINE

LINE is a new communication application which allows you to make free voice calls and send free messages whenever and wherever.

- Updating the application and registration of an account is required for using LINE. For details on using LINE, visit the LINE website, or from the LINE screen → [ ] → [Settings] → [Help] and refer to the help.
- LINE is a Touch Pointer-capable application.

### 1 When the standby screen is displayed, press → [LINE]

The LINE top page is displayed.

The first time using LINE, update the application, and a login screen will appear. Terms of use, etc. appear when registering a new account. Confirm the content and follow the on-screen instructions.



#### memo

- Games and some other functions cannot be used on the product.

## Accessing the Internet

You can access the Internet by packet communication or the wireless LAN (Wi-Fi®) function.



### memo

- ◎ Packet communication is available only with subscription to LTE NET or LTE NET for DATA.

## Using Packet Communication

This product provides easy access to the Internet for packet communication with use of "LTE NET" or "LTE NET for DATA". Settings for connecting to the Internet with LTE NET are pre-installed on the product, and activating an application that requires an Internet connection automatically connects the product to the Internet. To access the Internet with LTE NET for DATA, in the standby screen, ● → [Settings] → [Wireless/Network] → [Cellular networks] → [Access Point Names] → [LTE NET for DATA].



### memo

- ◎ Subscription to LTEフラット (LTE flat) or other packet communication flat-rate/discount service allows you to use an Internet connection with flat-rate charges. For details on LTE NET, LTE NET for DATA, and packet communication flat-rate/discount services, refer to the latest au総合カタログ (au general catalog)/the au homepage.

## Precautions when Using Packet Communication

- Using large-volume data communication, such as browsing websites containing images, downloading video and other data, and using applications that use data communication, results in high packet communication charges. Therefore, subscription to a flat-rate/discount service for packet communication charges is recommended.
- To prevent excessive burdens on the network, communication speed is sometimes reduced due to continued large-volume data transfers, busy network conditions, etc.

## How to Confirm Your Packet Communication Charges

You can confirm your packet communication charges at the following URL.

<https://cs.kddi.com/> (auお客さまサポート (au Customer Support))

- Subscription required for first-time use.

## Using the Browser

You can use the browser to view webpages the same as with a PC.

- When a webpage is displayed for the first time, a permission screen is displayed. Confirm the content and follow the on-screen instructions.
- The browser is a Touch Pointer-capable application.
- Some webpages cannot be optimally displayed on the product's screen.

## Using the Browser Menu

### 1 When the standby screen is displayed, press

The browser menu is displayed.

2	Homepage	Connect to the Internet and view webpages.
	auお客さまサポート (au Customer Support)	Display the au Customer Support webpage.
	Favorites	Use and manage registered bookmarks.
	Web Search	Enter a URL directly to display a site. You can also enter keywords to search for information on webpages.
	History	Display the browsing history.
	Download	Display the download history.
	Browser Settings	Change browser settings.

## Using the Touch Pointer

You can use the Touch Pointer's features to smoothly browse webpages.

For details on the Touch Pointer, refer to "Using the Touch Pointer" (▶P. 38).

### 1 Use the Touch Pointer to operate the browser

Tap: Select or finalize items.

Flick: Long-touch the touch area to display "⬆️" and then scroll up or down on the touch area.

- With the pointer at the edge of the screen, slide/flick toward off the screen to scroll.

Double-tap: Zoom out or in on images.

## Before Using the Camera

- Fingerprints and smudges on the lens may cause images to appear unclear. Before capturing images, wipe the lens with a soft cloth such as for eyeglasses. Rubbing forcefully may scratch the lens.
- Avoid fingers, hair, strap, etc. from covering the lens during image capture. Hold the strap if it interferes with capture.
- Take precautions for hand-held shake. The product moving may cause blurry images, so hold product firmly or use the self-timer. Especially indoors and in other low-light conditions, hand-held shake can occur more easily.  
Blurry images also occur more easily when the subject moves.
- Release the shutter after confirming that the subject is properly displayed in the display. Moving the camera while releasing the shutter may cause images to be blurry.
- When recording movies, avoid covering the microphone with fingers. Loudness of voices and surroundings during recording may affect the sound quality of the microphone.
- Focusing may not be possible for the following types of subjects.
  - Low-contrast subjects such as plain walls
  - Subjects with strong backlighting
  - Shiny subjects that reflect light brightly
  - Subjects with a pattern that repeats horizontally such as blinds
  - Several subjects with differing distances from the camera
  - Subjects in dark conditions
  - Fast-moving subjects
- Do not shine the photo light near eyes. Do not look directly into shining photo light. Do not shine photo light at other persons' eyes. Doing so may affect vision or cause other impairment.
- Even in manner mode, the shutter clicks for photos. Also during movie shooting, start and stop beeps sound. The volume cannot be adjusted.
- When using the self-timer for image capture and the product is placed on an unstable surface, the product vibrating such as when a call arrives or other conditions may cause the product to fall.

- You should refrain from any activity which may infringe copyrights when duplicating, editing, etc. images taken or recorded with the product, as well as any activity which may infringe portrait rights such as use or modification of other person's portraits without permission. Photography or recording of live performances, entertainment, exhibits, etc. may also be prohibited even if intended only for personal enjoyment.
- Creating a public nuisance with use of the product camera may be punishable by law.
- Photos with location information appended and uploaded to the Internet can allow third parties to obtain the location information.

## Viewfinder Layout

### 1 When the standby screen is displayed, press

- When the standby screen is displayed, you can also press  → [Camera] to activate the camera.

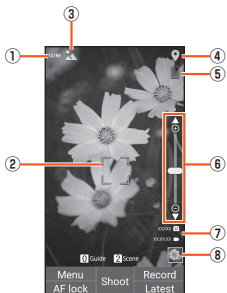

#### ① Capture mode icons

A mode icon is displayed when the capture mode is "Continuous", "Scene", "Effect", or "Time-lapse".



- Depending on the set effect, an adjustment bar is displayed for adjusting the setting.

#### ② Focus frame

#### ③ Capture scene icon/seconds icon

- When the capture mode is "Scene", an icon is displayed for the set scene.
- When the capture mode is "Time-lapse", an icon for the number of seconds is displayed.

#### ④ Determining location/add location information

-  (Determining location)  (Determined)
-  (Could not determine)

#### ⑤ Battery level

Displayed when battery low.

#### ⑥ Zoom

Press  to display a zoom bar and adjust the zoom.

#### ⑦ Capture shots/time remaining

Displayed when storage is low where captured data is stored.

#### ⑧ Preceding shot/recorded data

Display thumbnail of preceding shot/recorded data.

## Capturing Still Pictures/Video

### 1 When the standby screen is displayed, press

The monitor screen is displayed.

### ■ Shooting a photo

### 2 (Shoot) or

The camera focuses and the shot is taken. Captured data is automatically saved.

### ■ Recording a movie

### 2 (Record)

Recording starts.

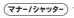
During recording, press  (Shoot) or  to capture a photo.

### 3 (Stop)

Recording stops. Recorded data is automatically saved.



### memo

- Closing the product during recording stops recording.
- Although the product features continuous AF for maintaining continuous autofocus, it may take time for the camera to focus depending on the subject.
- You can set Smile shutter to "ON" and use self-timer shooting to have the camera take one shot after the countdown, and then take another once it detects a smile.
- During recording, recording is only by the microphone.

## TV (1Seg)

TV (1Seg) is a digital terrestrial TV broadcast service for mobile devices, and allows reception of image and audio as well as data broadcast.

For details on the "1Seg" service, refer to the below website.  
The Association for Promotion of Digital Broadcasting  
<http://www.dpa.or.jp/english/index.html>

### ■ Precautions when Using TV (1Seg)

- No communication charges or packet communication charges are incurred for using TV (1Seg). However, packet communication charges are incurred for use of additional services associated with data broadcast that use data transmission. Regarding NHK reception fees, inquire with NHK.
- While displaying the TV (1Seg) screen, the product may become warm and cause low-temperature burns, etc. if used in contact with the skin for an extended period.
- Listening at a volume that is loud to the ears continuously for an extended period may affect hearing.
- TV (1Seg) is for digital terrestrial TV broadcast 1Seg in Japan only.
- Overseas, 1Seg cannot be used due to differing broadcast formats and frequencies. Also, BS and 110-degree CS digital broadcasts cannot be viewed.
- Do not use TV (1Seg) while operating a vehicle or riding a bicycle, motorcycle, etc. or while walking. Doing so may prevent surrounding sound from being heard and may distract you, causing a traffic accident.

### ■ Signal

Signal may be weak in the following places and may affect picture/sound quality or prevent reception.

- Areas that are distant from or extremely close to the broadcast station
- In a moving train/car, underground shopping district, tunnel, indoors, etc.
- In a valley or shade of a building
- Near high-power lines, neon lighting, a radio station, railway track, highway, etc.
- Other places where interfering signals are strong or signals are blocked

To improve signal reception, try the following.

- When viewing indoors, view near a window for better reception.

### ■ TV Antenna

The product has a built-in antenna.

### ■ Operation at Low Battery Level or High Temperature

TV (1Seg) cannot be used when the battery is low or the product is at a high temperature. TV (1Seg) also cannot be activated with a low battery.

## Making Initial TV Settings

Set an area for viewing the first time activating TV. Once settings are complete, you can view TV programs.

**1** When the standby screen is displayed, press **●** → [Tool] → [TV]

**2** Select the area → **●**

**3** Select the prefecture → **●**

**4** Select the locality → **●**

The product searches for available channels, and a channel list is displayed.

**5** Confirm the channel list → **●** → [OK]

The TV screen is displayed.

## Viewing TV Programs

### Viewing a TV Program

**1** When the standby screen is displayed, press **●** → [Tool] → [TV]

The TV screen is displayed.

### Viewing the TV Screen

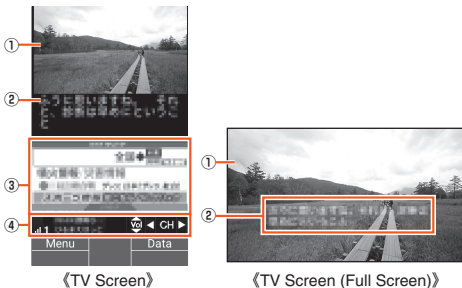



## ■ Key Operation while Viewing TV

⏮: Adjust volume (volume at 15 levels or mute)

⏪: Switch channels

0 - 9, ✖, #: Change to assigned channel

Press @ (Data) to use data broadcast.

⏮: Move cursor, scroll

●: Select item

@ (Vol/Ch) / [2007]: Switch to TV viewing operation



### memo

- When activating TV (1Seg) or changing channels, it may take time to obtain data for data broadcast and TV image due to digital broadcasting characteristics.
- Image and sound may be disrupted or stop due to signal conditions.
- You can turn the product sideways to view in full screen.
- No communication charges or packet communication charges are incurred for viewing data broadcast. However, packet communication charges are incurred for accessing related sites in information obtained from data broadcast or obtaining additional information.

## Displaying the Settings Menu

Set and manage functions from the settings menu.

- 1 When the standby screen is displayed, press  → [Settings]

Item	Description
au ID Setting	Set an au ID.
Wallpaper/Display	Set wallpaper and display brightness, change font size, etc.
Sound/Notification	Change manner mode settings, volume and sound of ringtone, vibration pattern, etc.
Lock	Make product lock settings.
Wireless/Network	Make settings for Wi-Fi®, Bluetooth®, NFC, Osaifu-Keitai®, mobile networks, tethering, VPN or other network, etc.
Eco/Battery	Set Eco Mode and check battery usage.
All reset	Initialize the product.
More Settings	Set the custom keys, Touch Pointer, security, storage, applications, location information, accounts, language and input, date and time, user accessibility, device information, etc.

## Wireless LAN (Wi-Fi®) Function

You can use a household wireless LAN (Wi-Fi®) environment or a public wireless LAN environment when outside to connect to an Internet service.



### memo

- For use at home, make sure you have an Internet connection and a wireless LAN (Wi-Fi®) base set (Wi-Fi® network).
- Before using out on the go, first check the Wi-Fi® network connection, the homepage of the public wireless LAN service provider, etc. where you will be using the product. A separate subscription may be required for service.



- ◎ Connection with all public wireless LAN services is not guaranteed.
- ◎ Since the wireless LAN (Wi-Fi®) function uses radio signals for information exchange, it provides the benefit of being able to connect freely within range of a good signal. However, not making security settings allows the risk of malicious use by third parties. While at the customer's discretion and responsibility, it is recommended that you make security settings before using the product.

## Using the Wireless LAN (Wi-Fi®) Function

### Enabling the Wireless LAN (Wi-Fi®) Function

- 1 When the standby screen is displayed, press  → [Settings] → [Wireless/Network] → [Wi-Fi]**  
The Wi-Fi® settings screen is displayed.
- 2 [Wi-Fi]**  
Wi-Fi® switches on.

### Connecting to a Wi-Fi® Network



- 1 When the standby screen is displayed, press  → [Settings] → [Wireless/Network] → [Wi-Fi]**  
When Wi-Fi® is activated, a list of connectable access points is displayed in the Wi-Fi® settings screen.
- 2 Select an access point → **
- 3 Enter the password →  (Connect)**  
You can set "Show password" to ON to display a password as you enter it.



#### memo

- ◎ Some access points do not require a password.
- ◎ Depending on your environment, transmission speed may drop or a connection may be unavailable.

## Disconnecting from an Access Point

- 1 When the standby screen is displayed, press  → [Settings] → [Wireless/Network] → [Wi-Fi]
- 2 Select the connected access point →  →  (Forget)



### memo

- ◎ After disconnecting from an access point, a password may be required to reconnect.

## Introduction of Peripheral Devices

- Battery Pack (KYF31UAA)
- Desktop holder (KYF31PUA) (sold separately)
- Back cover (KYF31TGA, KYF31TPA, KYF31TWA, KYF31TKA)
- au Carrying Case F Black (0105FCA) (sold separately)
- au Carrying Case G Black (0106FCA) (sold separately)
- au Carrying Case H Black (0107FCA) (sold separately)

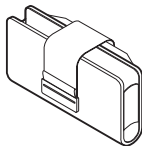

au Carrying Case F Black

- Common AC Adapter 03 (0301PQA) (sold separately)
- Common AC Adapter 03 Navy (0301PBA) (sold separately)
- Common AC Adapter 03 Green (0301PGA) (sold separately)
- Common AC Adapter 03 Pink (0301PPA) (sold separately)
- Common AC Adapter 03 Blue (0301PLA) (sold separately)
- Common AC Adapter 05 (0501PWA) (sold separately)
- AC Adapter JUPITRIS (White) (L02P001W) (sold separately)
- AC Adapter JUPITRIS (Red) (L02P001R) (sold separately)
- AC Adapter JUPITRIS (Blue) (L02P001L) (sold separately)
- AC Adapter JUPITRIS (Pink) (L02P001P) (sold separately)
- AC Adapter JUPITRIS (Champagne) (L02P001N) (sold separately)
- Portable charger 02 (0301PFA) (sold separately)
- microUSB cable 01 (0301HVA) (sold separately)
- microUSB cable 01 Navy (0301HBA) (sold separately)
- microUSB cable 01 Green (0301HGA) (sold separately)
- microUSB cable 01 Pink (0301HPA) (sold separately)
- microUSB cable 01 Blue (0301HLA) (sold separately)
- Flat microUSB conversion adapter 01 (0301QXA) (sold separately)
- 3.5mm microUSB conversion adapter 01 (0301QNA) (sold separately)
- microUSB monaural earphone 01 (0301QLA) (sold separately)
- microUSB stereo earphone conversion adapter 01 (0301QVA) (sold separately)

**memo**

- For the latest information about available peripheral devices, check the au homepage (<http://www.au.kddi.com/english/>) or contact Customer Service Center.
- The above-mentioned peripheral devices can be purchased from au Online Shop. You may not be able to purchase one depending on the stock status.  
<http://auonlineshop.kddi.com/>

**Using an Optional Earphone**

An earphone (sold separately) can be used by connecting a 3.5mm microUSB conversion adapter 01 (sold separately).

- 1 Connect the earphone (sold separately) and 3.5mm microUSB conversion adapter 01 (sold separately)**
- 2 Insert the 3.5mm microUSB conversion adapter 01 (sold separately) in the product**

Open the external connection terminal cover, check the orientation of the microUSB plug of the 3.5mm microUSB conversion adapter 01 (sold separately), and insert in the external connection terminal without bending.

**memo**

- Do not pull the external connection terminal cover forcefully. Especially when removing an earphone, the cover may be pulled with excessive force if pulled together.
- Pulling the external connection terminal cover forcefully may damage the cover by deforming it or pulling it out of the product.
- Some earphones (sold separately) cannot be connected to a 3.5mm microUSB conversion adapter 01 (sold separately).

**Using a microUSB Earphone**

- Using an Earphone (Commercially Available) with a microUSB Stereo Earphone Conversion Adapter 01 (Sold Separately)**

If you connect an earphone (commercially available) to a microUSB stereo earphone conversion adapter 01 (sold separately), you can talk on the phone via the earphone using the adapter switch.

**1 Connect the earphone (commercially available) and microUSB stereo earphone conversion adapter 01 (sold separately)**

**2 Insert the microUSB stereo earphone conversion adapter 01 (sold separately) in the product**

Open the external connection terminal cover, check the orientation of the microUSB plug of the microUSB stereo earphone conversion adapter 01 (sold separately), and insert in the external connection terminal without bending.

**Using a microUSB Monaural Earphone 01 (Sold Separately)**

If a microUSB monaural earphone 01 (sold separately) is connected directly to the product, you can talk on the phone via the earphone using the earphone switch.

**1 Connect the microUSB monaural earphone 01 (sold separately) to the product**

Open the external connection terminal cover, check the orientation of the microUSB plug of the microUSB monaural earphone 01 (sold separately), and insert in the external connection terminal without bending.



**memo**

- ⊙ Do not pull the external connection terminal cover forcefully. Especially when removing a microUSB monaural earphone 01 (sold separately) / microUSB stereo earphone conversion adapter 01 (sold separately), the cover may be pulled with excessive force if pulled together.
- ⊙ Pulling the external connection terminal cover forcefully may damage the cover by deforming it or pulling it out of the product.

- ⊙ Depending on the earphone (commercially available), you may not be able to connect it to the microUSB stereo earphone conversion adapter 01 (sold separately).
- ⊙ For inquiries regarding the microUSB monaural earphone 01 (sold separately), visit the au homepage (<http://www.au.kddi.com/english/>).

**Receiving a Call**



**1 As a call is arriving, press the switch on the microUSB stereo earphone conversion adapter 01 (sold separately) / microUSB monaural earphone 01 (sold separately)**

- As a call is arriving, hold the switch down on the microUSB stereo earphone conversion adapter 01 (sold separately) / microUSB monaural earphone 01 (sold separately) to reject the call.
- During a call, press the switch on the microUSB stereo earphone conversion adapter 01 (sold separately) / microUSB monaural earphone 01 (sold separately) to toggle the mute on/off.

**2 To end the call, hold the switch down on the microUSB stereo earphone conversion adapter 01 (sold separately) / microUSB monaural earphone 01 (sold separately)**

## Troubleshooting

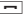
Before you assume that the product is malfunctioning, check the following:

Trouble	Detail	Page
Cannot operate/The screen does not respond/ Cannot turn off the power.	You can force the product to power off and reboot by holding down  and  at the same time for at least 11 seconds.	—
The power is turned off automatically.	Is the battery adequately charged?	—
The power is turned off while the wake-up logo is displayed.	Is the battery adequately charged?	—
Cannot make calls.	Is the power turned on?	—
	Is an au Nano IC Card 04 inserted?	P.37
	Was the number entered correctly? (Was the area code entered?)	P.54
	Did you press  after entering the number?	P.54
	Is "Airplane mode" still set?	P.42

Trouble	Detail	Page
Cannot receive calls.	Is the signal good enough?	P.42
	Is the product within the service area?	P.42
	Is the power turned on?	—
	Is an au Nano IC Card 04 inserted?	P.37
	Is "Incoming Reject" still set?	—
	Is "Airplane mode" still set?	P.42
	Is "Call forwarding services" still set?	—
"No signal" (out of service area) is displayed.	Is the product within the service area or where signal is good enough?	P.42
	Are your fingers, etc. off the area around the internal antennas?	P.36
	Is the card inserted an au Nano IC Card 04?	P.37
Cannot operate the keys panel.	Is the power turned on?	—
	Is the product still locked?	—
	Turn off the power and then turn it on again.	—
The Touch Pointer does not move as intended.	Check the correct way for using the Touch Pointer.	P.38
	Close the product and then open it again.	—
	Turn off the power and then turn it on again.	—
A message indicating that charging is necessary is displayed.	The battery is almost empty.	P.42
The product answers calls when it shouldn't.	Is Answering memo set?	P.42



Trouble	Detail	Page
The battery pack can only be used a short time.	Is it adequately charged? • Charge until the red charging/notification indicator goes out.	—
	Does the battery pack have adequate service life remaining?	P.23
	Is "x" (out of service area) not usually shown where you use the product?	P.42
When making a call, there is a busy signal and the call does not connect.	Is the product within the service area or where signal is good enough?	P.42
	The line traffic is busy or the other party is in a call. Dial again.	—
There is no TV (1Seg) display / picture stops / audio stops / picture is snowy.	Is the battery low?	P.42
	Is the digital terrestrial TV broadcast signal adequate?	P.77
	Does the location where you are watching match the selected region?	P.78
	Is the product at a normal temperature? The product may stop functioning if at a high temperature.	P.21
Camera does not operate.	Is the battery low?	P.42
	Is the product at a normal temperature? The product may stop functioning if at a high temperature.	P.21

If symptoms do not improve after checking each of the above, information is provided through au Customer Support on the au homepage below.

<http://www.au.kddi.com/english/support/>

## Updating Software

You can update the product to the most recent software for optimal performance and to get the latest enhancements.

### ■ Notes on Software Update

- When software update is necessary, you will be informed on au homepage, etc. For details, contact an au shop or Customer Service Center (call toll-free 157). In addition, users of the product will receive a notice from au, when software update is necessary to improve the functionality of the product.
- It is recommended to back up your data before updating software.
- Fully charge before update. If the update is started with the battery power low or battery power becomes low during update, software update cannot be done.
- Check out the signal reception status. The software update may fail if the product is in a place with bad signal reception status.
- Any operations are not available during software update. Calling 110 (Police), 119 (Fire/Ambulance), 118 (Maritime rescue) is not available. Alarm does not work, either.
- If software update has failed or stopped, perform the same procedure again.
- Update is unavailable during international roaming.
- If the software update fails, it may become impossible to operate the product. If this happens, bring it to an au shop or PiPit (not accepted by some shops).

## Downloading and Updating Software

The product supports the software update.

**1** When the standby screen is displayed, press  → [Settings] → [More settings] → [About phone] → [Software update]

**2** [Software update]

From here on, follow the on-screen instructions.



### memo

- © After a software update, the product cannot revert to the previous version software.

## Remotely Locking the Product with Anshin Lock Service

Even if you have not set remote locking beforehand, you can call the Customer Service Center and have the screen, Osaifu-Keitai®, etc. remotely locked.

Anshin Lock Service is available at no charge.

### Calling the Customer Service Center and Remotely Locking/Unlocking the Product

From a fixed-line phone,  0077-7-113 (toll free)

From an au cell phone, **113** without area code (toll free)

Business hours: 24 hours (7 days a week)

- Follow voice guidance to complete procedure.



### memo

- © For detailed descriptions, refer to the "Full Instruction Manual" (Japanese) available on the au homepage.

## Using Keitai Sagasete Anshin (Keitai Search) Service

You can use the Keitai Sagasete Anshin (keitai search) service to have the Customer Service Center find your au phone's approximate location if misplaced or lost.

The locating setting on the product is preset to "Allow" to allow it to be found.



### memo

- For detailed descriptions, refer to the "Full Instruction Manual" (Japanese) available on the au homepage.

## After-Sales Service

### ■ When Asking for Repair

For repair, contact Keitai Guarantee Service Center.

During the warranty period	Repairs will be done based on the Company's terms of services of the free-of-charge repair warranty described on the warranty card.
Outside the warranty period	We shall repair the product for a charge as requested by the customer if repair renders it usable.



### memo

- Before handing in the product for repair, make a backup of the contents of memory since they may disappear during repair. Note that the Company shall not be liable for any damages and loss of income should the contents of memory be altered or lost.
- Recycled parts that meet the Company's quality standards are sometimes used for repair.
- au cell phones collected by Replacement cell phone delivery service which you used before are recycled to cell phones for replacement after repairs. Also parts replaced by au after-sales service are collected and recycled by the Company. They are not returned to customers.
- Instances where the product has been changed, modified, or analyzed (including software modification or analysis (including rooting, etc.) reverse-engineered, reverse-compiled, or reverse-assembled) or has been repaired at a location other than an authorized repair location designated by the Company may not be covered by warranty or may prevent the product from being accepted for repairs.

## ■ Performance Parts for Repair

The Company retains performance parts for repair of the product main unit and its peripherals for 4 years after discontinuation of production. "Performance parts for repair" refers to parts required for maintaining the functions of the product.

## ■ Warranty Card

At the store of purchase, thoroughly check and read the name of the retailer, date of purchase and other necessary details filled in on the warranty card, and be sure to keep it in a safe place.

## ■ Keitai Guarantee Service Plus LTE

An after-sales service membership program on a monthly basis called "Keitai Guarantee Service Plus LTE" (monthly fee: 380 yen, tax excluded) is available for using your au cell phone for a long time without worries. This service expands coverage for many troubles including malfunction, theft and loss. For details of this service, check on the au homepage or contact Keitai Guarantee Service Center.



### memo

- You can apply for membership only at the time of purchasing your au cell phone.
- Once you cancel the membership, you cannot reapply for it until you purchase an au cell phone next time.
- Note that when changing the model or purchasing an extra cell phone, this service only covers the most recently purchased au cell phone.
- When an au cell phone is handed over to you or someone else, the "Keitai Guarantee Service Plus LTE" membership is also handed over to the successor of the cell phone.

- When you get a new au cell phone by changing the model, purchasing an extra cell phone, etc., the "Keitai Guarantee Service Plus" or "Keitai Guarantee Service Plus LTE" membership for the old au cell phone is automatically canceled.
- Service contents are subject to change without notice.

## ■ au Nano IC Card 04

The au Nano IC Card 04 is lent to you by au. In case of loss or damage, the card will be replaced at your expense. When malfunction is suspected, or in case of theft or loss, contact an au shop or PiPit.

## ■ After-Sales Service

If you are unsure about anything regarding after-sales service, contact the following service counter.

### Customer Service Center (service cancelation procedure in case of loss or theft)

From a fixed-line phone,  **0077-7-113** (toll free)  
 From an au cell phone, **113** without area code (toll free)  
 Business hours: 24 hours (7 days a week)

### Keitai Guarantee Service Center (for loss, theft or damage)

From a fixed-line phone/an au cell phone,  
 **0120-925-919** (toll free)  
 Business hours 9:00 to 20:00 (7 days a week)

### Replacement requests online (24 hours)

- \* From the product, PCs and smartphones only  
[https://cs.kddi.com/support/n\\_login.html](https://cs.kddi.com/support/n_login.html)
- Applications for servicing can be made via the Internet for "damage", "water seepage", "theft", or "loss". Naturally-occurring malfunction (power does not turn on, the screen is frozen, etc. due to causes other than damage or water seepage) require consultation by telephone.
- Applications via the Internet require that you provide your e-mail address.



## ■ au After-Sales Service Information

Service contents			Keitai Guarantee Service Plus LTE		
			Member	Non-member	
Replacement cell phone delivery service	Spontaneous failure	1st year	Free	N/A	
		2nd year and later	Customer charge 1st: 5,000 yen 2nd: 8,000 yen Long-term-use customers receive ¥2,000 discount* <sup>1</sup>		
Holding over and repair	Partial damage	1st year	Free		Free
		2nd year and later	Free (three-year warranty)		Actual cost
	Water soak and irreparable damage	Customer charge Upper limit 5,000 yen			
		Customer charge 10,000 yen			
Theft and loss		N/A		N/A (By model replacement)	

\* Charge amounts are all tax excluded.

\*<sup>1</sup> Customers in 3rd year (25 months) of subscription or all subscription lines in a family discount plan to which the customer belongs are eligible. Customers using a data communication device or tablet are eligible if they are subscribing to a set discount plan (WIN Single Set Discount Service or Smartphone Set Discount) and the subscription for the line covered under the set discount is in its 3rd year.



## memo

### Replacement cell phone delivery service

- ◎ When you have trouble with your au cell phone, you can have a cell phone for replacement (same model and color\* as your old one, new battery) delivered to any destination that you specify by calling us. Please return your old faulty au cell phone within 14 days after the cell phone for replacement is delivered to you.
  - \* If a same-model/color cell phone cannot be provided, a cell phone for replacement will be provided in a model and color that we specify.
- ◎ You can use this service up to twice within one year starting from the day when you first use this service. If you have not used this service over the past one year at the time of your application for this service, the application will be regarded as your first time. If you have, the application will be regarded as your second time.
  - \* For details, check on the au homepage.

### Holding over and repair

- ◎ Damages and malfunctions intentionally caused by the customer as well as those due to modification (e.g. disassembly, change of parts, painting, etc.) by the customer are not covered by this service.
- ◎ You cannot receive a refund for replacement of the outer casing due to stains, scratches, paint removal, etc. on the outer casing.

## SIM-Unlocking the Product

This product can be SIM-unlocked. SIM-unlocking the product allows other-carrier SIM cards to be used with it.

- Requests can be made for SIM-unlocking on the au homepage or at an au shop.
- Some services, functions, etc. may have restrictions when an other-carrier SIM card is used. The Company does not guarantee operation whatsoever.
- To make settings after SIM-unlocking the product, when the standby screen is displayed, press → [Settings] → [More settings] → [About phone] → [SIM card status].
- For details, refer to the au homepage.

<https://cs.kddi.com/support/simcard/>

## Main Specifications

Main display	Approx. 3.4 inches, approx. 16.77 million colors, Transparent TFT 854×480 (FWVGA)	
Sub-display	Approx. 0.93 inches, 1 color, OEL display	
Weight	Approx. 130 g (including the battery pack)	
Charging times (estimate)	Common AC Adapter 05 (sold separately)	Approx. 120 min.
Continuous talk time	In Japan	Approx. 530 min.
	Overseas (GSM)	Approx. 380 min.
Continuous standby time	In Japan	Approx. 530 hours
	Overseas (GSM)	Approx. 560 hours
Continuous tethering time	Approx. 410 min.	
Maximum Wi-Fi tethered connections	10 devices	
Dimensions (W x H x D)	Approx. 51 mm×113 mm×16.7 mm (thickest part approx. 17.7 mm)	
Internal memory	ROM: Approx. 8 GB RAM: Approx. 1 GB	
Effective camera pixels	Approx. 8 million pixels	
Camera imaging element	CMOS	
Wireless LAN (Wi-Fi®) function	IEEE802.11b/g/n compatible	

Bluetooth® function	Compatible version	Bluetooth® standards Ver.4.1 compatible*1
	Output	Class1
	Communication range*2	10m
	Supported Bluetooth profile*3	GATT (Generic Attribute Profile) SPP (Serial Port Profile) A2DP (Advanced Audio Distribution Profile) AVRCP (Audio/Video Remote Control Profile) HSP (Headset Profile) HFP (Hands-Free Profile) OPP (Object Push Profile) PBAP (Phone Book Access Profile) PAN (Personal Area Networking Profile) PAN-NAP (Personal Area Networking-Network Access Point) PAN USER (Personal Area Networking-User) SCMS-T (Serial Copy Management System-T) DUN (Dial-Up Networking Profile)*4
	Frequency bands	2.4GHz band
1Seg continuous watching time		Approx. 6 hours and 30 min.

\*1 It is confirmed that the product and all Bluetooth® devices are compliant with Bluetooth® standards designated by Bluetooth SIG, and they are authenticated. However, procedures may differ or data transfer may not be possible depending on the device's characteristics or specifications.

\*2 It changes according to objects obstructing devices and signal reception.

- \*3 This is the specification provided in Bluetooth® standards for making communication between Bluetooth® compatible devices in accordance with their intended use.
- \*4 Supported for some car navigation systems only. See the au homepage for usage.



### memo

- The continuous talk time and continuous standby time may drop to less than half depending on the battery charging status, usage environment such as temperature, reception condition at the location where the product is used, and the function settings.

## Specific Absorption Rate (SAR) of Cell Phones

This model KYF31 cell phone complies with Japanese technical regulations for exposure to radio waves and international guidelines on radio wave protection.

This cell phone has been designed in observance of the Japanese technical regulations regarding exposure to radio waves\* and limits to exposure to radio waves recommended by equivalent international guidelines.

These international guidelines were set out by the International Commission on Non-Ionizing Radiation Protection (ICNIRP), which is in collaboration with the World Health Organization (WHO), and the permissible limits include a substantial safety margin designed to assure the safety of all persons, regardless of age and health condition. The Japanese technical regulations and international guidelines define the limits using a unit of measurement known as the Specific Absorption Rate (SAR), which represents the average amount of radio frequency energy absorbed by the human body. The SAR limit for cell phones is 2.0 W/kg. The highest SAR value for this cell phone when tested for use at the ear is 0.385 W/kg, and when worn on the body, is 0.498 W/kg. There may be slight differences in SAR levels among individual products, but they all satisfy the limit.

The actual SAR of this cell phone while talking on the phone can be well below that indicated above. This is due to the cell phone being designed to only output the minimum power required to communicate with a base station. Therefore in general, the closer you are to a base station, the lower the power output of the cell phone.

This cell phone can be used in positions other than against your ear. Use a carrying case or similar accessory that holds the phone at least 1.5 cm separated from the body and ensure no metal parts are located between you and the cell phone. Under these conditions, this cell phone satisfies Japanese technical regulations and international guidelines for radio wave protection.



The World Health Organization has stated that "a large number of studies have been performed over the last two decades to assess whether mobile phones pose a potential health risk. To date, no adverse health effects have been established as being caused by mobile phone use".

If you would like to know more detailed information, please refer to the WHO website.

[http://www.who.int/docstore/peh-emf/publications/facts\\_press/fact\\_english.htm](http://www.who.int/docstore/peh-emf/publications/facts_press/fact_english.htm)

Please refer to the websites listed below if you would like to know more detailed information regarding SAR.

- 
- Ministry of Internal Affairs and Communications website  
<http://www.tele.soumu.go.jp/e/sys/ele/index.htm>
  - Association of Radio Industries and Businesses website  
<http://www.arib-emf.org/01denpa/denpa02-02.html>
  - au homepage  
<http://www.au.kddi.com/english/>
- 

\* Technical regulations are defined by the Ministerial Ordinance Related to the Radio Law (Article 14-2 of Radio Equipment Regulations).

## FCC Notice

This device complies with part 15 of the FCC Rules. Operation is subject to the following two conditions: (1) This device may not cause harmful interference, and (2) this device must accept any interference received, including interference that may cause undesired operation.



Note:

This equipment has been tested and found to comply with the limits for a Class B digital device, pursuant to part 15 of the FCC Rules. These limits are designed to provide reasonable protection against harmful interference in a residential installation. This equipment generates, uses, and can radiate radio frequency energy and, if not installed and used in accordance with the instructions, may cause harmful interference to radio communications.

However, there is no guarantee that interference will not occur in a particular installation. If this equipment does cause harmful interference to radio or television reception, which can be determined by turning the equipment off and on, the user is encouraged to try to correct the interference by one or more of the following measures:

- Reorient or relocate the receiving antenna.
- Increase the separation between the equipment and receiver.
- Connect the equipment into an outlet different from that to which the receiver is connected.
- Consult the dealer or an experienced radio/TV technician for help and for additional suggestions.

### Warning

The user is cautioned that changes or modifications not expressly approved by the manufacturer could void the user's authority to operate the equipment.



### FCC RF EXPOSURE INFORMATION

Warning! Read this information before using your phone.

Warning! Read this information before using your phone. In August 1996, the Federal Communications Commission (FCC) of the United States, with its action in Report and Order FCC 96-326, adopted an updated safety standard for human to radio frequency electromagnetic energy emitted by FCC regulated transmitters. Those guidelines are consistent with the safety standard previously set by both U.S. and international standards bodies. The design of this phone complies with the FCC guidelines and these international standards.

#### Body-worn Operation

This device was tested for typical body-worn operations with the back of the phone kept 0.39 inches (1.0 cm) from the body. To comply with FCC RF exposure requirements, a minimum separation distance of 0.39 inches (1.0 cm) must be maintained between the user's body and the back of the phone, including the antenna. All beltclips, holsters and similar accessories used by this device must not contain any metallic components. Body-worn accessories that do not meet these requirements may not comply with FCC RF exposure limits and should be avoided. This device is not intended to be used with a lanyard or strap on the body. The device contains a mounting point that may be used to attach the device to equipment, a backpack or tool belt, etc.

#### Turn off your phone before flying

You should turn off your phone when boarding any aircraft. To prevent possible interference with aircraft systems, U.S. Federal Aviation Administration (FAA) regulations require you to have permission from a crew member to use your phone while the plane is on the ground. To prevent any risk of interference, FCC regulations prohibit using your phone while the plane is in the air.

## European RF Exposure Information

Your mobile device is both a radio transmitter and receiver, and is designed not to exceed limits for exposure to radio waves recommended by international guidelines. These guidelines were produced by independent scientific organization, ICNIRP, and include safety margins designed to protect all persons, regardless of age and condition of health.

The guidelines apply a unit of measurement known as the Specific Absorption Rate (SAR). The SAR limit for mobile devices is 2 W/kg, and the highest SAR value for this device was 0.756 W/kg\*. As testing measures SAR at the highest transmitting power of a device, actual SAR tends to be lower during ordinary operation. Lower SAR levels are typical during ordinary operation as automatic changes are made within the device to ensure the network can be reached with minimal power.

The World Health Organization (WHO) has stated that present scientific information does not indicate the need for any special precautions to be adopted when using mobile devices. WHO also notes that those wishing to reduce exposure may do so by limiting call length and by using a 'hands-free' device to distance the phone from the head and body. For further information, please see the WHO website: <http://www.who.int/peh-emf/en/>

\* Note that tests are also carried out in accordance with international testing guidelines.

## INSTRUCTION MANUAL FOR BATTERY PACK (KYF31UAA)

### Caution

- Do not open, crush, disassemble and dispose of in fire heat above (60°C): may cause burn, fire and explosion by mishandling.
- Follow Manufacturer's Instructions.
- Risk of explosion if battery is replaced by an incorrect type.
- Dispose of used batteries according to local ordinances and/or regulations.
- Replace only with same KYOCERA Corporation type KYF31UAA battery pack.

### Charging Information

Nominal Specifications		
Item	Specification	Remark
Charging Current (Max.)	1.5A	-
Charging Voltage	4.35V	-
Charging Time (Std.)	3 hours	-
Ambient (Charge)	0 - 45°C	-

Charge Limits		
Battery Pack Model	Maximum Charge Current, A	Maximum Charge Voltage, V
KYF31UAA	1.5A	4.35V

## Declaration of Conformity

Product is declared to conform with the essential requirements of European Union Directive 1999/5/EC Radio and Telecommunications Terminal Equipment Directive 3.1 (a), 3.1 (b) and 3.2.

### Safety Information

To prevent possible hearing damage, do not listen at high volume levels for long periods.



## Intellectual Property Rights

### Trademarks

The company names and product names appearing in this manual are trademarks or registered trademarks of their respective holders.



TRENDMICRO and VirusBuster are registered trademarks of Trend Micro.

Microsoft®, Windows®, and Windows Vista®/Windows® 7/Windows® 8/Windows® 8.1/Windows® 10 are registered trademarks of Microsoft Corporation in the U.S.A. and other countries.

The official name for Microsoft® Windows® is Microsoft® Windows® Operating System.

Microsoft®, Microsoft® Excel®, Microsoft® PowerPoint®, Windows Media®, and Exchange® are trademarks or registered trademarks of Microsoft Corporation in the United States and other countries. Microsoft® Word and Microsoft® Office are product names of Microsoft Corporation in the U.S.A.

QR code is a registered trademark of DENSO WAVE INCORPORATED.

The microSD and microSDHC logos are trademarks of SD-3C, LLC.

The Bluetooth® word mark and logo are registered trademarks owned by the Bluetooth SIG, Inc., and KYOCERA Corporation is licensed to use these trademarks.

Wi-Fi®, WPA®, Wi-Fi CERTIFIED logo, and Wi-Fi Protected Setup logo are registered trademarks of Wi-Fi Alliance.

Wi-Fi CERTIFIED™ and Wi-Fi Protected Setup are trademarks of Wi-Fi Alliance.

FeliCa is a contactless IC card technology developed by Sony Corporation.

FeliCa is a registered trademark of Sony Corporation.

☞ is a registered trademark of FeliCa Networks, Inc.

LINE is a trademark or registered trademark of LINE Corporation.

iWnn of OMRON SOFTWARE Co., Ltd. is used for conversion methods for Japanese language, and for phrase prediction methods for English.

iWnn IME©OMRON SOFTWARE Co., Ltd. 2009-2016 All Rights Reserved.

THIS PRODUCT IS LICENSED UNDER THE MPEG-4 VISUAL PATENT PORTFOLIO LICENSE FOR THE PERSONAL AND NON-COMMERCIAL USE OF A CONSUMER FOR (i) ENCODING VIDEO IN COMPLIANCE WITH THE MPEG-4 VISUAL STANDARD ("MPEG-4 VIDEO") AND/OR (ii) DECODING MPEG-4 VIDEO THAT WAS ENCODED BY A CONSUMER ENGAGED IN A PERSONAL AND NONCOMMERCIAL ACTIVITY AND/OR WAS OBTAINED FROM A VIDEO PROVIDER LICENSED BY MPEG LA TO PROVIDE MPEG-4 VIDEO. NO LICENSE IS GRANTED OR SHALL BE IMPLIED FOR ANY OTHER USE. ADDITIONAL INFORMATION INCLUDING THAT RELATING TO PROMOTIONAL, INTERNAL AND COMMERCIAL USES AND LICENSING MAY BE OBTAINED FROM MPEG LA, LLC. SEE [HTTP://WWW.MPEGLA.COM](http://www.mpegla.com).

- (1) ACCESS, the ACCESS logo, and NetFront are registered trademarks or trademarks of ACCESS CO., LTD. in the United States, Japan and/or other countries.
- (2) This software is based in part on the work of the Independent JPEG Group.

The product is equipped with DeepCore® 3.0 Plus by E-Globaledge Corporation as infrared communication function.

Copyright © 2013 E-Globaledge Corp. All Rights Reserved.

"SMART SONIC RECEIVER" is a registered trademark of KYOCERA Corporation.

The product includes pictograms licensed by NTT DOCOMO, INC.

The product contains fonts provided by LIM Corporation LTD.

"PhotoSolid", the function to avoid blurring still images, is a product of Morpho, Inc. "PhotoSolid" is a registered trade mark of Morpho, Inc.

"MovieSolid", the function to avoid blurring videos, is a product of Morpho, Inc. "MovieSolid" is a registered trade mark of Morpho, Inc.

"Morpho Rapid Effect", the image effect technology, is a product of Morpho, Inc. "Morpho Rapid Effect" is a registered trademark of Morpho, Inc.

Morpho HDR is adopted for HDR (High Dynamic Range) technology.

"Morpho HDR" is a trade mark of Morpho, Inc.

"Suica" and "Mobile Suica" are registered trademarks of East Japan Railway Company.

Morpho HDR is adopted for HDR (High Dynamic Range) technology. "Morpho HDR" is a trade mark of Morpho, Inc.

"Suica" and "Mobile Suica" are registered trademarks of East Japan Railway Company.

All other company names and product names are trademarks or registered trademarks of respective companies referred to in this manual.

## ■ Regarding Windows notations

The names of operating systems (Japanese versions) used in this manual are as follows.

- Windows 10 is the abbreviation for Microsoft® Windows® 10 (Home, Pro, Enterprise, Education).
- Windows 8 is the abbreviation for Microsoft® Windows® 8, Microsoft® Windows® 8 Pro, Microsoft® Windows® 8 Enterprise.
- Windows 7 is the abbreviation for Microsoft® Windows® 7 (Starter, Home Basic, Home Premium, Professional, Enterprise, Ultimate).
- Windows Vista is the abbreviation for Microsoft® Windows Vista® (Home Basic, Home Premium, Business, Enterprise, Ultimate).

Users of the product are authorized to use software installed into the product described in this instruction manual. Pay attention to the following points when using the software.

- (a) The software installed on this product or part of it may not be altered, delivered, modified, analyzed, reverse-engineered, derived, and any such actions are prohibited.
- (b) Illegally importing the software or a part of it is prohibited.
- (c) This Software is provided without implied warranties of merchantability, fitness for a particular purpose and noninfringement of third party rights.

Note that the existing license agreement takes priority for usage of GNU General Public License (GPL), GNU Library/Lesser General Public License (LGPL) included in software, software based on other open source software license and software that KYOCERA Corporation is licensed.

For information on the Open source software, refer to "Open source software" as follows;

### ■ Open Source Software

Note that the existing license agreement takes priority for usage of GNU General Public License (GPL), GNU Library/Lesser General Public License (LGPL) included in software, software based on other open source software license and software that KYOCERA Corporation is licensed. The exact terms of GPL, LGPL and some other licenses are reproduced in "About phone" in this product. For details, refer to Kyocera homepage.

This product includes software copyrighted by KYOCERA Corporation and licensed software.

Copyright of the software designed and developed complying with the open source software standard belongs to KYOCERA Corporation or the third parties, distribution, reproduction, transformation and transmission over public lines without consent of KYOCERA Corporation are prohibited, unless you are authorized or permitted by Copyright Law.

### ■ Export Administration Regulations

This product and its accessories may be subject to the Japan Export Administration Regulations ("Foreign Exchange and Foreign Trade Law" and its related laws).

In addition, U.S. Re-export Regulations (Export Administration Regulations and the related laws and regulations), regulations in other countries may apply to this product and its accessories. To export and re-export this product and its accessories, directly or indirectly, take the required measures on your responsibility and at your expenses.

For details on the procedures, contact the Ministry of Economy, Trade and Industry, the U.S. Department of Commerce, or authority concerned.

### ■ Recording diagnosis and usage condition data

KYOCERA Corporation asks for users' cooperation in order to improve the quality of products and services. KYOCERA Corporation records and saves data of failure diagnosis and the usage conditions (application usage by users, log related to error, detail information of application usage by users (specified functions, usage frequency, memory/battery status)) in the product in order to track and cope with diagnosis events such as unexpected shutdown or system error for the purpose of improvement of quality and services. Those information may be collected upon repair request by user after obtaining the user agreement.

## OpenSSL License

### 【OpenSSL License】

Copyright © 1998-2011 The OpenSSL Project. All rights reserved.

This product includes software developed by the OpenSSL Project for use in the OpenSSL Toolkit. (<http://www.openssl.org/>)

THIS SOFTWARE IS PROVIDED BY THE OpenSSL PROJECT "AS IS" AND ANY EXPRESSED OR IMPLIED WARRANTIES, INCLUDING, BUT NOT LIMITED TO, THE IMPLIED WARRANTIES OF MERCHANTABILITY AND FITNESS FOR A PARTICULAR PURPOSE ARE DISCLAIMED. IN NO EVENT SHALL THE OpenSSL PROJECT OR ITS CONTRIBUTORS BE LIABLE FOR ANY DIRECT, INDIRECT, INCIDENTAL, SPECIAL, EXEMPLARY, OR CONSEQUENTIAL DAMAGES (INCLUDING, BUT NOT LIMITED TO, PROCUREMENT OF SUBSTITUTE GOODS OR SERVICES; LOSS OF USE, DATA, OR PROFITS; OR BUSINESS INTERRUPTION) HOWEVER CAUSED AND ON ANY THEORY OF LIABILITY, WHETHER IN CONTRACT, STRICT LIABILITY, OR TORT (INCLUDING NEGLIGENCE OR OTHERWISE) ARISING IN ANY WAY OUT OF THE USE OF THIS SOFTWARE, EVEN IF ADVISED OF THE POSSIBILITY OF SUCH DAMAGE.

### 【Original SSLeay License】

Copyright © 1995-1998 Eric Young (eay@cryptsoft.com) All rights reserved.

This product includes cryptographic software written by Eric Young (eay@cryptsoft.com)

THIS SOFTWARE IS PROVIDED BY ERIC YOUNG "AS IS" AND ANY EXPRESS OR IMPLIED WARRANTIES, INCLUDING, BUT NOT LIMITED TO, THE IMPLIED WARRANTIES OF MERCHANTABILITY AND FITNESS FOR A PARTICULAR PURPOSE ARE DISCLAIMED. IN NO EVENT SHALL THE AUTHOR OR CONTRIBUTORS BE LIABLE FOR ANY DIRECT, INDIRECT, INCIDENTAL, SPECIAL, EXEMPLARY, OR CONSEQUENTIAL DAMAGES (INCLUDING, BUT NOT LIMITED TO, PROCUREMENT OF SUBSTITUTE GOODS OR SERVICES; LOSS OF USE, DATA, OR PROFITS; OR BUSINESS INTERRUPTION) HOWEVER CAUSED AND ON ANY THEORY OF LIABILITY, WHETHER IN CONTRACT, STRICT LIABILITY, OR TORT (INCLUDING NEGLIGENCE OR OTHERWISE) ARISING IN ANY WAY OUT OF THE USE OF THIS SOFTWARE, EVEN IF ADVISED OF THE POSSIBILITY OF SUCH DAMAGE.

# For inquiries, call:

## Customer Service Center

For general information, charges,  
and operation assistance (toll free)

Business hours: 9:00 to 20:00 (7 days a week)

From fixed-line phones: | From au cell phones:  
 0077-7-111 | 157 area code not required

Pressing "zero" will connect you to an operator,  
after calling "157" on your au cellphone .

---

## For service cancelation procedure in case of loss or theft (toll free)

Business hours: 24 hours (7 days a week)

From fixed-line phones: | From au cell phones:  
 0077-7-113 | 113 area code not required

In case above numbers are not available, call toll-free:

 0120-977-033 (except Okinawa)

 0120-977-699 (Okinawa)

## Keitai Guarantee Service Center

For loss, theft or damage (toll free)

Business hours: 9:00 to 20:00 (7 days a week)

From fixed-line phones/au cell phones:

 0120-925-919



有害サイトから  
子供を守る!



濡れた状態での充電は、  
異常な発熱・焼損などの原因となり  
大変危険です。



モバイル・リサイクル・ネットワーク  
2016年10月10日現在

Cell phone and PHS operators collect and recycle  
unused telephones, batteries and battery  
chargers at stores bearing the ♻️ logo regardless  
of brand and manufacturer to protect the  
environment and reuse valuable resources.

May 2017, 4th Edition

Sales: KDDI CORPORATION・OKINAWA CELLULAR TELEPHONE COMPANY

Manufactured by: KYOCERA Corporation