

Preface

Thank you for buying the ARROWS Tab FJT21 (simply called the "FJT21" or "product" from here on). Before using the product, be sure to read the "FJT21 Setting Guide", "Basic Manual" (this manual) to ensure correct use. After you have finished reading this manual, be sure to store it in a safe place so that you can retrieve it whenever needed.

About Operating Instructions

Handles only basic operations for main features. For detailed descriptions of various functions, refer to the "取扱説明書 (Instruction Manual)" (Japanese) application that can be used on your FJT21 or "取扱説明書詳細版 (Full Instruction Manual)" (Japanese) on the au homepage. <http://www.au.kddi.com/support/mobile/guide/manual/>

■ "取扱説明書 (Instruction Manual)" (Japanese) Application

You can use the "取扱説明書 (Instruction Manual)" application on the FJT21 to confirm detailed operational procedures. Certain functions can be directly activated from the application screens on which their operations are described. In the home screen, → 取扱説明書 (Instruction Manual)

■ Downloading Manuals

You can download the "Basic Manual" (this manual), "取扱説明書 (Instruction Manual)" (Accessory) (Japanese) and "取扱説明書詳細版 (Full Instruction Manual)" (Japanese) in PDF format from the au homepage.

Download URL:
<http://www.au.kddi.com/support/mobile/guide/manual/>

Safety precautions

Before you start using the product, be sure to read the "Safety Precautions" to ensure correct use. Before you assume that the product is malfunctioning, check for possible remedies in the following au Customer Support site of au homepage:
<http://www.au.kddi.com/support/mobile/trouble/repair>

When using the product

- Communication is not possible even inside the service area in places where the signal does not reach (e.g. tunnels and basements). Also, communication is sometimes not possible in poor reception areas. Communication is sometimes interrupted if you move into a poor reception areas during communications.
- Since this product uses radio waves, the possibility of communication intercepts by third parties cannot be eliminated. (Though LTE/CDMA/GSM/UMTS system has highly secure confidential communication features.)
- Since this product is a radio station under the Radio Law, you may be asked to temporarily submit the product for inspection in accordance with the Radio Law.
- IMEI information of your device is automatically sent to KDDI CORPORATION for maintenance and monitoring operational status of this product.
- Take care not to inconvenience people around you when you use the product in a public place.
- When the product is used by a child, parents or guardians should thoroughly read the "Instruction Manual" and teach the child how to use it.
- The FJT21 is compatible with the international roaming service. Each network service varies depending on the area and service content.

- To use the product overseas, check the condition such as regulations of the country/region beforehand.
- As with PCs, some user-installed applications may disrupt the stability of the FJT21 performance, or unexpectedly transmit information via the Internet causing improper use of your location information as well as personal information recorded on the FJT21. Therefore, verify the supplier and operating conditions of the applications to be used before using them.

Etiquette

This product always emits weak radio waves when power is on. Use the product in an enjoyable and safe manner without forgetting to be considerate of others around you.

- Use of the product is not allowed in some places
- Do not use the product while driving a car or riding a motorbike or bicycle. It may cause a traffic accident. Use of the product while driving a car or motorbike is prohibited by law. Use of the product while riding a bicycle may be punishable by some regulations.
- Do not use this product while you are aboard an airplane. Use of electric devices transmitting radio waves in airplane is prohibited by law. Some airline companies, however, allow their passengers to use the product. For details, contact the airline company you use.

Basic package and main peripheral equipment

Before your start using the product, make sure that you have all the following packaged with the product.

- ⑩ microSD card slot
- ⑪ au Micro IC Card (LTE) slot
- ⑫ Volume key
- ⑬ Stereo earphone terminal
- ⑭ External connection terminal

memo

- Do not put a sheet (peep prevention sheet etc.) or decoration seal on the RGB sensor/built-in antenna/GPS antenna.
- Covering the RGB sensor may hinder the sensor from detecting the ambient brightness correctly.
- Touching or covering the built-in antenna with your fingers or metal objects while holding the FJT21 may lower the receiving sensitivity.
- Do not cover the microphone with hand etc. when recording.

au Micro IC Card (LTE)

Your phone number etc. is recorded in the au Micro IC Card (LTE). If the au Micro IC Card (LTE) is not correctly attached to the FJT21, sending and receiving mails etc. cannot be operated. Besides, other functions using your phone number etc. may not be used. The FJT21 supports only au Micro IC Card (LTE). You cannot use the product replacing the au IC-Card or micro au IC-Card used on an au cell phone or au smartphone.



Main unit

FJT21

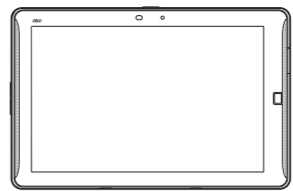

Accessories

Desktop Holder (Rapid charging desktop holder: FJT21PUA)

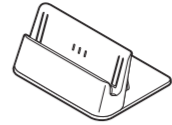

AC adapter (AC adapter for Desktop Holder: FJL22PQA)

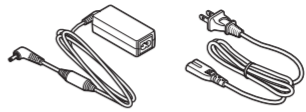

FJT21 TV antenna input to microUSB cable (FJT21HKA)



- FJT21 設定ガイド (Setting Guide) (Japanese)
- 取扱説明書 (Instruction Manual) (Japanese)
- 安全上のご注意 (Safety Precautions) (Japanese)
- FCC noticeなどについて (About FCC notice etc.) (Japanese)
- 本体保証書 (FJT21 Warranty) (Japanese)
- 卓上ホルダ専用ACアダプタ保証書 (Warranty of AC adapter for Desktop Holder) (Japanese)

The following items are not included in the package.

- microSD card
- Stereo earphone
- microUSB cable

• Illustrations in this manual are only for reference. They may look different from the actual product.

Regarding notations used in this document

Keys used in this manual

In this manual, keys are represented by simplified illustrations as shown below.

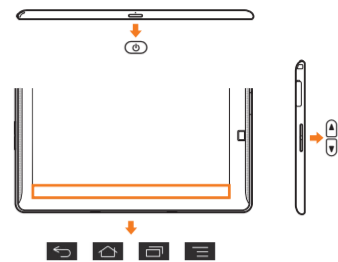

Removing au Micro IC Card (LTE)

- 1 Put the display side down and open the slot cover
- 2 Pull straight out the tray hooking your finger by the tab on the tray to take the au Micro IC Card (LTE) out

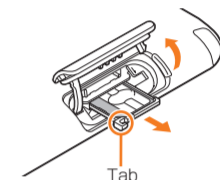

- 3 Push the tray in, and then close the slot cover ensuring that the cover is not partially open

memo

- Note the following points, otherwise handling the au Micro IC Card (LTE) may cause malfunction or damage.
 - Do not touch the IC (metal) part of the au Micro IC Card (LTE) or the IC card terminal inside the FJT21.
 - Insert in the correct direction.
 - Do not use force to attach or remove.
- When an au Micro IC Card (LTE) is not attached properly or au Micro IC Card (LTE) is abnormal, an error message appears.
- Do not lose the au Micro IC Card (LTE) after it has been removed.
- Do not insert an au Nano IC Card (LTE) which a conversion adapter is attached. Doing so might cause a fault.

Indications used for the operation of selecting items/icons/buttons, etc.

Notations used for operation procedures in this manual are as follows.

Tapping is to select a button or icon displayed on the screen by lightly tapping it with your finger (▶P.19).

Description	Explanation
In the home screen, Tap at the bottom of the home screen and tap from the displayed menu.	Tap → "Settings"
Tap from the displayed option menu. Tap "Settings".	Tap → "Settings"

* If not clearly indicated in the operation procedures of this manual, start the operation from the home screen.

Screen displayed used in this manual

Screen illustrations shown in this manual may look different from the actual screens. In some cases, upper or lower part of a screen may be omitted.

memo

- Explanations of this manual (wallpaper, icons, etc.) are based on the case when the Set Family use is set to Standard mode. Keys and screens may be different from the actual ones. In some cases, minor details or a part of a screen may be omitted. Also illustrations may be different.
- In this manual, "microSD™ memory card (commercially available)", "microSDHC™ memory card (commercially available)" and "microSDXC™ memory card (commercially available)" are abbreviated as "microSD card".
- In this manual, operations to enter secret code or password, etc. or to authenticate with fingerprint or face are described as "authenticate".

— 1 —

Getting Ready

Names and functions of parts

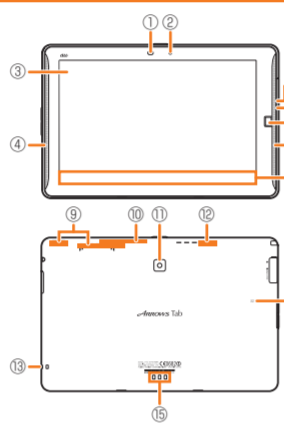

— 2 —

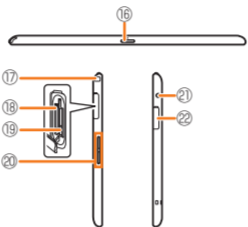

- 1 RGB sensor
- 2 In-camera
- 3 Display (Touch panel)
- 4 Speaker
- 5 Microphone
- 6 Notification LED
- 7 Fingerprint sensor
- 8 Navigation bar
- 9 Built-in antenna
- 10 GPS antenna
- 11 Out-camera
- 12 Bluetooth®/Wi-Fi® antenna
- 13 Strap hole
- 14 mark
- 15 Desktop holder charging terminal
- 16 Power key
- 17 TV antenna

— 8 —

— 6 —

Charging

The battery is not fully charged when purchased. Make sure to charge the battery before use. The internal battery is a consumable item. A time available with each charging decreases bit by bit.

Charging with the desktop holder and AC adapter (supplied)

- 1 Insert the power cable to the AC adapter (supplied)
- 2 Insert the connector of the AC adapter (supplied) to the power terminal of the desktop holder
- 3 Install to the desktop holder matching concaves of the FJT21 to its convex parts
- 4 Insert the power plug of the power cable to an outlet
- 5 Make sure the notification LED of the FJT21 turns in red
 - When charging ends, the LED turns off.
- 6 When charging is finished, remove the power plug of the power cable from the outlet and then remove the FJT21 from the desktop holder
- 7 Remove the connector of the AC adapter (supplied) main unit from the desktop holder

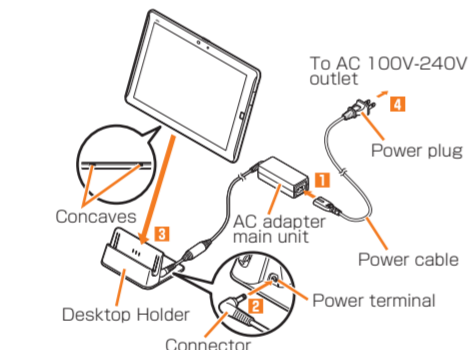

memo

- The FJT21 with a commercially available cover attached may not be charged by the desktop holder.
- Make sure that the charging terminal is clean before charging with the desktop holder. When it is dirty, clean the charging terminal with dry cotton swabs, etc.

— 7 —

Charging with specified AC Adapter (sold separately)

Charging with the Common AC Adapter O4 (sold separately) is explained. (Note that your AC adapter may be different from this illustration.)

- 1 Open the external connection terminal cover (1-1) of the FJT21, and then insert the microUSB plug of the Common AC Adapter O4 (sold separately) to the external connection terminal (1-2)
- microUSB plug has orientation. Face convex part (▲) of the plug terminal down and then insert it into the external connection terminal straight. Connecting the microUSB plug with an incorrect orientation might cause failure of external connection terminal of FJT21.
- 2 Insert the power plug of Common AC Adapter O4 (sold separately) into an outlet (100V-240V AC)
- 3 Make sure the notification LED turns in red
 - When charging ends, the LED turns off.
- 4 Remove the power plug of the Common AC Adapter O4 (sold separately) from the outlet after charging is complete
- 5 Hold microUSB plug and pull it out straight

— 8 —

— 9 —

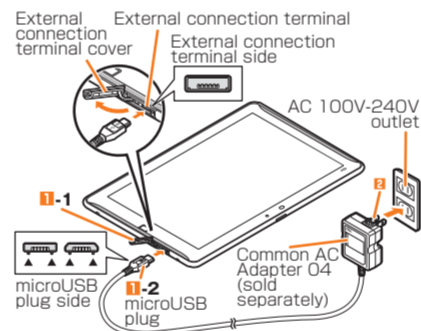

memo

- Alternatively, you can connect the FJT21 and a PC with a microUSB cable O1 (sold separately) to charge. When a screen for "新しいハードウェアの検索プログラムの開始 (new hardware detection)" appears on the PC, select "キャンセル (Cancel)".

Turning the power on/off

Turning the power on

- 1 Press for over 2 seconds
- 2 Slide to any direction on the lock screen

— 9 —

— 10 —

memo

- Do not touch the fingerprint sensor before the lock screen appears after pressing . The fingerprint sensor function becomes unavailable. If a warning message prompting you for rebooting appears, reboot the product.
- "au^ようこそ (Welcome to au)" screen appears for the first time you turned the power on.
- When you tap for the first time, a guide for operations appears.

Turning the power off

- 1 Press and hold until the tablet options menu appears
- 2 "Power off" → "OK"
 - Press and hold for over 8 seconds to turn the power off forcibly.

Switching the display language to English

Default language is Japanese. Press to skip the Japanese initial setting screen, then switch language to English according to the following steps.

- 1 In the home screen, Tap → "言語と入力 (Language & input)"
- 2 "Language" → "English"

— 10 —

— 12 —

memo

- Some items can be set/changed later.
- Other initial settings
 - Make the following settings as required.
 - E-mail (@ezweb.ne.jp) initial settings
 - Account setting for PC-mail
 - Wireless LAN (Wi-Fi) function setting

If screen turns off or lock screen appears

Canceling sleep mode

When no operation has been made on the FJT21 for a certain period, the screen automatically turns off according to "Sleep/Lit when held" setting.

- 1 In sleep mode, Tap
- Sleep mode is canceled.
- Pressing during operation lets the screen into sleep mode.

Unlocking screen

- 1 Slide to any direction
- The screen is unlocked.

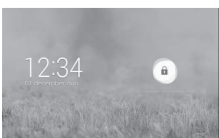

— 10 —

— 13 —

memo

- Unlock the screen by authenticating depending on the Security unlock preference you set.

Unlocking with fingerprint sensor

Press the fingerprint sensor to cancel sleep mode, then slide your finger to cancel the screen lock.

- 1 In sleep mode, press the fingerprint sensor
- Slide your finger on the fingerprint sensor

memo

- To unlock the lock screen by fingerprint authentication, set "Security unlock preference" to "Fingerprint".

Basic Operation

The basic operations of the FJT21 is described here.

Using the touch panel

The display on the FJT21 is a touch panel operated by touching it with your finger.

- If display is dirty or wet with sweat or water drops, the touch panel might operate incorrectly. Wipe off the display surface thoroughly.

— 8 —

Tap/Double-tap

Lightly touch an item or icon on the screen with your finger to select. Double tap: Tap the same position twice.

Long-touch

Keep touching an item or icon on the screen with your finger. Use for displaying pop-up menu etc.

Flick

When there are multiple pages or data such as in the home screen, Gallery, etc., quickly flick off the screen up/down/left/right to switch the screens.



Drag

Keep touching and move an item or icon on the screen with your finger.

Slide

Touch to move the screen to show the hidden part if the entire view does not fit into a screen when displaying the setting menu, web page, PDF file, zoomed still image, etc.

Pinch

While Web page or a still image is displayed, widen the distance of two fingers on the screen (pinch-out) to zoom in, or narrow down the distance between the two fingers (pinch-in) to zoom out.



— 9 —

Screen

Understanding icons

Icons indicating the status of the FJT21 appear in the status bar at the top of the screen.



Main notification icons

Main status icons

* For more icons, see "取扱説明書詳細版 (Full Instruction Manual)" (Japanese).

— 9 —

Notification panel

When a notification icon appears, open the notification panel to check the notification. Also you can use various functions with it.

- 1 Drag the status bar downward



- 1 Status panel switch
- 2 Clear
- 3 Clear notifications in the notification panel.
- 4 Settings
- 5 Close the notification panel

Using the home screen

The home screen is the starting point for all operations on the FJT21. By tapping , you can return from anywhere. In the home screen of NX!Home, you can use the following convenient functions.

Easy folder creation: Just overlap icons to create a folder. It is convenient for managing icons because stored icons are displayed.

Dock customize: Set up to 8 application icons freely. You can set a folder, too.

Home settings: Edit pages of the home screen and change wallpaper, icons, etc. from the menu displayed by tapping in the home screen.



- 1 Search widget (Quick search box)
- 2 Screen display position
- 3 Dock menu
- 4 Capture & Draw button
- 5 Customize area

— 10 —

— 11 —

Initial settings

After switching the display language to English, turn the power off and on again. "Welcome to au" screen appears. Follow the onscreen instructions to make settings. After au Easy Setting completes, ARROWS Getting started screen appears. Follow the onscreen instructions to set up.

- 1 In the Welcome to au screen, "Next"
- 2 In "au ID Setting", "Registration"
- 3 Set "Setting of data handover" → "Next"
- 4 Set "Setting of backup" → "Mark service to use" → "Agree, and next"
- 5 Set "au Widget Settings" → "Mark service to use" → "Agree, and next"
- 6 Set "Setup for emergency" → "Mark service to use" → "Agree, and next"
- 7 "Finish"
- 8 Set "Google account"
- 9 Set "Set Family use"
- 10 "Complete then go next" → "Start right now"

— 10 —

— 18 —

— 19 —

— 20 —

— 21 —

— 22 —

— 23 —

