



# BASIO

Contents

.....

Getting Ready

.....

Basic Operation

.....

au Disaster  
Countermeasure

.....

Safety Precautions

.....

Appendix

.....

## Preface

Thank you for buying the "BASIO" (simply called the "product" or "main unit" from here on).

Before using the product, be sure to read the "Basic Manual" (this manual) to ensure correct use.

After you have finished reading this PDF and the printed manuals, be sure to store them in safe places so that you can retrieve them whenever needed. If you lose the printed manuals (Accessories), contact an au shop or Customer Service Center.

## About Operating Instructions

### "Basic Manual" (This manual)

Handles only basic operations for main features.

For detailed descriptions on various functions, refer to the "Instruction Manual" app installed on the product or "取扱説明書詳細版 (Full Instruction Manual)" (Japanese) available on the au homepage.

<http://www.au.kddi.com/support/mobile/guide/manual/>

- Company names and product names referred to in this manual are trademarks or registered trademarks of respective companies.

### "Instruction Manual" App

You can use the "Instruction Manual" app on the product to confirm detailed operational procedures.

Certain functions can be directly activated from the application screens on which their operations are described.

**Slide/Flick Home screen left or right**→[サポート (Support)]→[取扱説明書 (Instruction manual)]

- When you activate for the first time, follow the onscreen instructions to download and install app.

## Safety Precautions

Before you start using the product, make sure to read the "Safety Precautions" to ensure correct use.

Before you assume that the product is malfunctioning, check for possible remedies in the following au Customer Support site of au homepage:

<http://www.au.kddi.com/english/support/>

## When using the product

- Communication is not possible even inside the service area in places where the signal does not reach (e.g. tunnels and basements). Also, communication is sometimes not possible in poor reception areas. Communication is sometimes interrupted if you move into a poor reception areas during communications.
- Since this product uses radio waves, the possibility of communication intercepts by third parties cannot be eliminated. (Though LTE/WiMAX 2+/GSM/UMTS system has highly secure confidential communication features.)
- When connecting to emergency services in Japan, use au VoLTE (LTE network). You cannot connect through 3G (circuit switching network).
- This product is compatible with the international roaming service. Each network service described in this manual varies depending on the area and service content.
- Since this product is a radio station under the Radio Law, you may be asked to temporarily submit the product for inspection in accordance with the Radio Law.
- IMEI information of your cell phone is automatically sent to KDDI CORPORATION for maintenance and monitoring operational status of your cell phone.
- The battery is built into the product and it is not user replaceable. For the exchanging battery, contact an au shop or Customer Service Center.

- Take care not to inconvenience people around you when you use the product in a public place.
- Before you start using the product overseas, check the relevant laws and regulations of the country/region you visit.
- When the product is used by a child, parents or guardians should thoroughly read the "Basic Manual" (this manual) and teach the child how to use it.

## Cell Phone Etiquette

### ■ Use of the product is not allowed in the following places!

- Do not use a cell phone while driving a car or riding a motorbike or bicycle. It might cause a traffic accident. Use of a cell phone while driving a car or motorbike is prohibited by law. Use of a cell phone while riding a bicycle may be punishable by some regulations.
- Use of cell phones on board is restricted. Follow the instructions of each airline.

### ■ Pay attention to the place of use and volume of your voice!

- To prevent ringtone from bothering other people, not only refrain from making a call but also power off or use Silent mode at a movie theater, theater, museum, library, etc.

- In a city area, use in a place where you do not bother people walking.
- It is extremely dangerous to walk while looking at the screen of the cell phone. Do not make calls or operate a cell phone while walking or by stopping suddenly.
- Move to a place where you do not disturb others while you are in shinkansen, a hotel lobby, etc.
- Be careful not to be loud while talking.
- Ask permission if you take photos with your cell phone camera.

### ■ Consider people around you!

- There may be a person with a cardiac pacemaker nearby at a place filled with people such as in a crowded train. Set "Airplane mode" or turn off beforehand.
- When a medical institution has laid down designated areas where use of the product is prohibited or is not allowed to be brought in, abide by the instructions of that medical institution.

## List of Packaged Items

Before you start using the product, make sure that you have all the following packaged with the product.

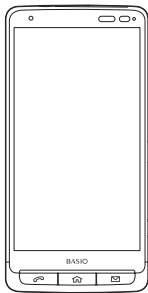

**Main unit**

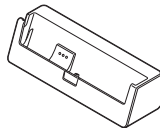

### **Desktop Holder (KYV32PUA)**

\* Desktop Holder (KYV32PUA) is not waterproof/dustproof.

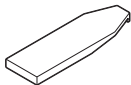

IC Card Tray Ejecting Tool for  
BASIO (sample)

- かんたんマニュアル (Kantan Manual) (Japanese)
- ご利用にあたっての注意事項 (Notes on usage) (Japanese)
- 本体保証書 (Warranty for the main unit) (Japanese)

The following items are not included in the package.

- |                 |                      |
|-----------------|----------------------|
| ・AC adapter     | ・microSD memory card |
| ・microUSB cable | ・Earphones           |



## memo

- Please purchase the specified charging equipment (sold separately).
- The illustrations of cell phone in the manual are used only for explaining. They may differ from the actual product.
- The battery is built into the product.

## Regarding notations used in this document

### Note on key illustrations

In this manual, keys are represented by simplified illustrations as shown below.

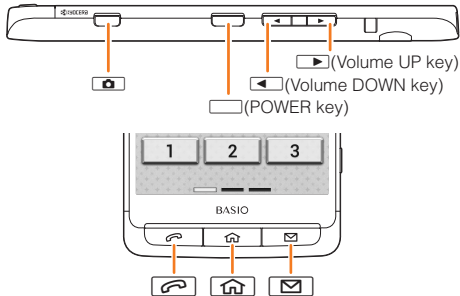

### Description of Operations for Selecting Item/Icon/Key etc.

The notations used for operation procedures in this manual are as follows.

Tapping is to select a key or icon displayed on the screen by lightly tapping it with your finger.

Description	Explanation
→ [1][4] [1] → [Call]	Press . And tap "" , "" , "" , then tap "" (Call) at the end.
In sleep mode,	In sleep mode, press .

## Notes on illustrations/Screenshots

Screen illustrations shown in this manual may look different from the actual screens.

In some cases, minor details or a part of a screen may be omitted.

In this manual, some icons on a screen are omitted.

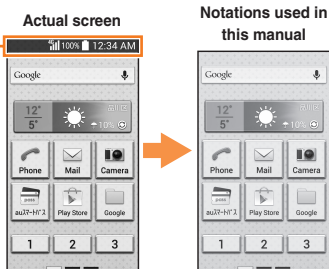

## memo

- ◎ Operations from the vertical display are mainly described. Menu items/icons/keys on a screen may be different from the ones in the horizontal display.
- ◎ Menu items/layers/icons may be different depending on functions, conditions, etc.
- ◎ In this manual, screenshots for body color "Gold" are provided as examples.
- ◎ In this manual, "microSD™ memory card", "microSDHC™ memory card" and "microSDXC™ memory card" are abbreviated as "microSD memory card" or "microSD".
- ◎ All of the indicated amounts exclude tax unless otherwise specified.

# Contents

Preface.....	ii
About Operating Instructions .....	ii
Safety Precautions .....	ii
When using the product .....	1
Cell Phone Etiquette .....	1
List of Packaged Items .....	2
Regarding notations used in this document.....	3

## Contents .....5

## Getting Ready .....7

Names and functions of parts .....	7
Attaching/Removing au Nano IC Card 04 .....	10
Attaching/Removing microSD memory card .....	13
Charging .....	14
Turning the power on/off.....	18
Making initial settings .....	19
Setting E-mail.....	20

## Basic Operation .....21

Using touch panel .....	21
Home screen .....	22
Using Home screen.....	22
Monitoring the product's status .....	24
Checking your own phone number .....	25

Setting Silent mode.....	25
Setting Airplane mode .....	25
Setting Direct button .....	25
Making a call .....	26
Receiving a call .....	27
Displaying menu.....	27

## au Disaster Countermeasure .....28

Using Disaster Message Board.....	28
Using Emergency Rapid Mail.....	28
Using Disaster Voice Messaging Service.....	30
Using Disaster information .....	31

## Safety Precautions.....32

Exemptions .....	32
Safety Precautions (Observe Strictly).....	32
Handling precautions .....	42
Notes on waterproof, dustproof and shock-resistant properties .....	50
Notes on using Bluetooth®/Wireless LAN (Wi-Fi®) function .....	57
Notes on packet communication charge .....	59
Notes on applications.....	59

## Appendix.....60

Introduction of related accessories .....	60
Using earphones .....	61
Troubleshooting .....	61
Updating Software or OS.....	63

After-sales service .....	64
Main specifications .....	67
Specific Absorption Rate of Mobile Phone .....	69
Intellectual property rights .....	70







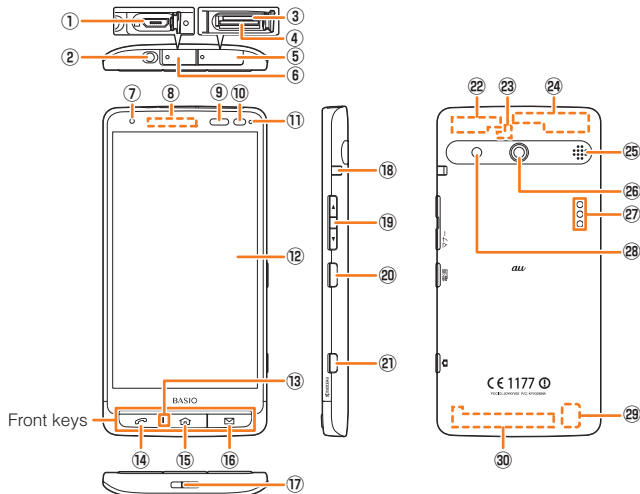

# Getting Ready

## Names and functions of parts



- ① **External connection terminal**  
Used for connecting Common AC Adapter 05 (sold separately), microUSB cable 01 (sold separately), etc.
- ② **Earphone microphone terminal**
- ③ **microSD memory card slot**
- ④ **au Nano IC Card 04 slot**
- ⑤ **Card slot cover**
- ⑥ **External connection terminal cover**
- ⑦ **In camera (lens)**
- ⑧ **Receiver**  
With Smart sonic receiver (▶P.9), hear the other party's voice on call, play sound of answer memo, etc.
- ⑨ **Infrared port**  
Send or receive data via infrared communication.
- ⑩ **Proximity sensor/Light sensor**  
Proximity sensor prevents from erroneous operation of touch panel during a call.  
Light sensor detects the ambient light level to adjust the display brightness.
- ⑪ **Incoming (Charging) light**  
Lights in red while charging.  
Blinks according to the settings for incoming call/mail.
- ⑫ **Display**
- ⑬ **Microphone**  
Transmits your voice to the other party during a call. Or used for recording the voice sound. Take care not to cover the microphone with your fingers during a call or recording a video.

- ⑭  **PHONE key**  
Make calls, use call history, or answer calls. Blinks when there is an incoming call or missed call.
- ⑮  **HOME key**  
Display the Home screen or use for canceling sleep mode. Press and hold to activate "Google".
- ⑯  **MAIL key**  
Use E-mail/SMS. Blinks when an e-mail is received.
- ⑰ **Strap eyelet**
- ⑱ **TV antenna**  
Extend to watch TV (1Seg). Even when the antenna is extended during a call or while using the browser, calling or data communication is not affected.
- ⑲  **Volume DOWN/UP key**  
Adjusts sound volume. Press and hold  (Volume DOWN key) to set "Silent mode".
- ⑳  **Power key**  
Power ON/OFF, activate/deactivate Sleep mode, etc.
- ㉑  **Camera key**  
Activate camera or use as autofocus/shutter of still image shooting.
- ㉒ **Built-in GPS/Bluetooth®/Wi-Fi® antenna\***
- ㉓ **Built-in Wi-Fi® antenna\***
- ㉔ **Built-in sub antenna\***
- ㉕ **Speaker**  
Ringtone or alarm sound can be heard from here.

## 26 Out camera (lens)

## 27 Charging terminal

It is a terminal for using Desktop Holder (KYV32PUA) when charging.

## 28 Photo light/Simple light

## 29 Built-in WiMAX 2+ antenna\*

## 30 Built-in main antenna\*

\* Do not cover antennas with your hand or put stickers etc. It might affect call/communication quality.



### memo

- The back cover of the product is not removal. Removing the back cover with force may cause damage or malfunction.
- The battery is built into the product and it is not user replaceable. For force shutdown and restarting, see "Forcing shut down and restarting" (▶ P.18).

## Front keys

Press each key in sleep mode to show the following screen.



: Dial pad screen or incoming/outgoing call history



: Start screen





: Mail menu

## Lighting/blinking front key

Blinking  indicates an incoming/missed call. Press



to answer the call or check the call history.

Blinking  indicates new e-mail/SMS. Press  while blinking then tap [E-mail]/[SMS] to view the received mail.

## About Smart sonic receiver

The product is equipped with Smart Sonic Receiver, which transmits sound by vibrating the display. Although there is not receiver hole, you can use as usual.

## Touching to your ear

Touch receiver part of the product to your ear as follows. By covering your ear to shut out surrounding noise, voice sound will be heard more easily. Move position of the product up/down/left/right to adjust according to your hearing condition or an immediate environment.

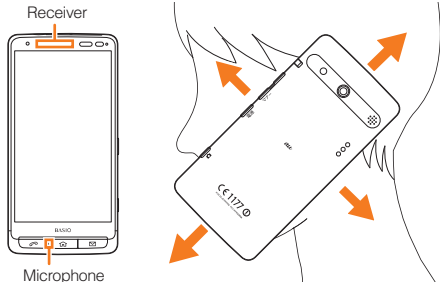

- Take care not to cover the microphone with your fingers during a call.
- When the earphones (sold separately) are connected, voice sound can be switched to the one via earphones not using Smart sonic receiver.
- Do not put stickers, etc. on the display. May make receiver sound to be heard hard.
- There may be differences in the hearing easiness among individuals.
- Depending on environment, the hearing effect differs.

## Attaching/Removing au Nano IC Card 04

Your phone number etc. is recorded on au Nano IC Card 04.

The product is compatible with au Nano IC Card 04 only. You cannot use the product with an IC card other than au Nano IC Card 04.

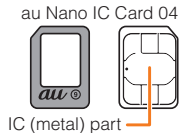

- Note the following points, otherwise handling the au Nano IC Card 04 tray or the product may cause malfunction or damage.
  - Do not touch the IC (metal) part of the au Nano IC Card 04 or the IC card terminal inside the product.
  - Insert in the correct direction.
  - Do not use force to attach or remove.
- Before removing au Nano IC Card 04, be sure to remove a power plug of specified AC adapter etc. from the product.
- When the au Nano IC Card 04 is not attached properly or the au Nano IC Card 04 is abnormal, an error message appears.
- Do not lose the au Nano IC Card 04 after it has been removed.

## ■ When au Nano IC Card 04 is not inserted

You cannot use the product with an IC card other than au Nano IC Card 04.

The following operations<sup>\*1</sup> cannot be performed when the product is powered on without au Nano IC Card 04 inserted. And  appears on the status bar.

- Making<sup>\*2</sup>/receiving calls
- Sending/receiving SMS
- Making initial settings and sending/receiving mails for E-mail (@ezweb.ne.jp)
- UIM card lock setting
- Checking own phone number/email address

\*1 Other than the above, functions using your phone number may not be available.

\*2 Making emergency calls such as 110 (Police), 119 (Fire/Ambulance), 118 (Maritime rescue) is not available.

## ■ Setting restrictions by PIN code

To protect your important personal information when using au Nano IC Card 04, change PIN code or use UIM card lock to restrict the product use by others (▶ P.49 "PIN code").

## ■ Attaching au Nano IC Card 04

- When installing au Nano IC Card 04, be sure to use the supplied IC Card Tray Ejecting Tool for BASIO (sample).

**1 Turn the power off and open the card slot cover**

**2 Hook the IC Card Tray Ejecting Tool for BASIO (sample) on the edge of the tray and pull it out**

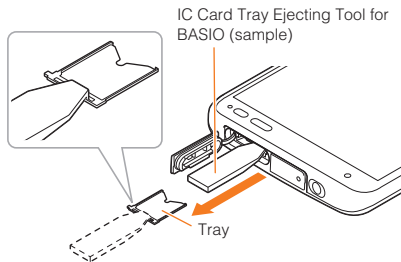

- 3 Check the orientation of the notch of the au Nano IC Card 04 and put it on the tray. Then insert the tray straight into the au Nano IC Card 04 slot (upper)**

After the tray is inserted, hook the IC Card Tray Ejecting Tool for BASIO (sample) on the edge of the tray and press it all the way.

- Take care so that the au Nano IC Card 04 does not get over the edge of the tray. Do not apply excessive force and insert it all the way straight into the slot. If the tray does not fit into the slot, do not press it with force. Pull the tray out and insert it again with the front edge raised. If the au Nano IC Card 04 gets over the tray, the product might not recognize the au Nano IC Card 04.

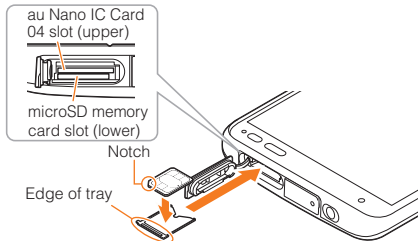

- 4 Close the card slot cover**

## Removing au Nano IC Card 04

- When removing au Nano IC Card 04, be sure to use the supplied IC Card Tray Ejecting Tool for BASIO (sample).
- Before removing the au Nano IC Card 04, make sure to remove a microSD memory card.

- 1 Turn the power off and open the card slot cover**

- 2 Hook the IC Card Tray Ejecting Tool for BASIO (sample) on the edge of the tray and pull it out**

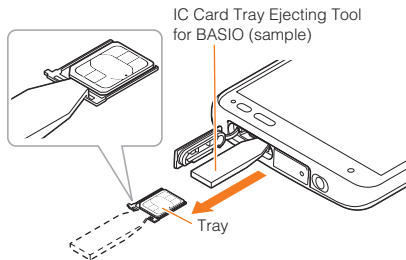

- 3** Remove the au Nano IC Card 04, then insert the tray straight into the au Nano IC Card 04 slot (upper) (upper)

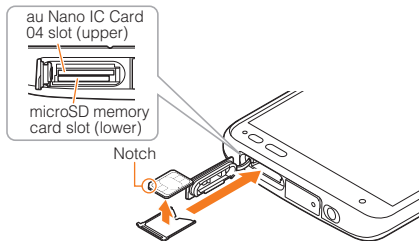

- 4** Close the card slot cover

## Attaching/Removing microSD memory card

### Attaching microSD memory card

- 1** Open the card slot cover

- 2** Confirm the direction of the microSD memory card and slowly insert it into the slot until it clicks

Insert a microSD memory card until you hear a click and confirm it is locked. Releasing the microSD memory card before it is locked may cause it to pop out.

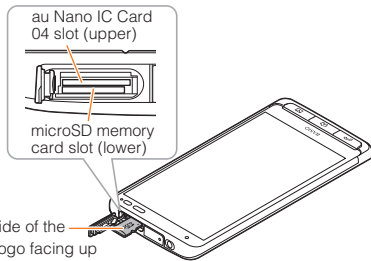

- 3** Close the card slot cover



#### memo

- ◎ Insert a microSD memory card with the right side up in the appropriate direction. Inserting a microSD memory card forcefully into the slot could result in failure to remove the microSD memory card or damage to the microSD memory card.

## Removing microSD memory card

- 1 Home screen→[Settings]→[Other settings]→[Storage]→[Unmount SD card]→[OK]
- 2 Open the card slot cover
- 3 Slowly push the microSD memory card toward the slot until it clicks

When a click sound is heard, pull your finger with the microSD memory card touched. Keep putting your finger on the microSD memory card until it comes out a little. Releasing the microSD memory card when pushed hard may cause it to pop-out.

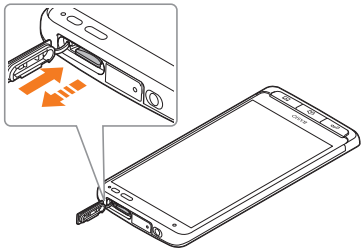

- 4 Slowly remove the microSD memory card

Slowly pull the microSD memory card straight out. Some microSD memory cards cannot be unlocked and do not come out smoothly. In such case, pull it out with your finger.

- 5 Close the card slot cover



### memo

- ⊙ Do not touch the terminal part of microSD memory card.
- ⊙ Do not remove the microSD memory card forcefully. It may result in damage to the microSD memory card or the data loss.
- ⊙ The microSD memory card may be warm after a long time use. It is normal.
- ⊙ When removing the microSD memory card, be sure to unmount to prevent data from loss (deletion).

## Charging

When you purchase your product, the internal battery is not fully charged. Make sure to charge the battery pack before use. When the charging light in red turns off, charging is complete.



### memo

- ⊙ The product may become warm while charging, depending on the situation, but this is not abnormal.
- ⊙ Charging while using camera etc. may take longer.

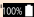

- ⦿ When you operate the product with the specified charger connected, the product may repeat short-time charging/ discharging resulting in short battery life.
- ⦿ When temperature of environment or the product becomes extremely high or low, charging may be stopped. Try to charge the battery as far as possible at room temperature.
- ⦿ If the charging light blinks in red, check if the product is correctly connected. If the light keeps blinking, stop charging and then contact an au shop or Keitai Guarantee Service Center.
- ⦿ Clean the charging terminal with dry cotton swabs etc. When it is dirty, the battery may not be charged normally.
- ⦿ Firmly close the external connection terminal cover after charging to prevent water or dust from getting in. And do not pull strongly or twist the cover.
- ⦿ If charging is stopped while the charging light is still turned on, the battery may not be fully charged even with  (Full) displayed. In that case, available time will be short.
- ⦿ When charging with Desktop Holder (KYV32PUA), do not use the external connection terminal to charge. Doing so may not charge properly, and may cause a malfunction.
- ⦿ Do not allow conductive foreign objects (metal fragments, pencil leads, etc.) to come into contact with or get inside the connection terminals.

## Charging with Desktop Holder (KYV32PUA)

Charging with supplied Desktop Holder (KYV32PUA) and Common AC Adapter 05 (sold separately) is explained.

- 1 Check the orientation of the microUSB plug of Common AC Adapter 05 (sold separately) and insert it straight into the external connection terminal of Desktop Holder (KYV32PUA)**
- 2 Connect the power plug of Common AC Adapter 05 to an outlet (100V - 240V AC)**
- 3 Install the product into Desktop Holder (KYV32PUA)**

Check that the charging light on the product lights in red. When charging ends, the charging light turns off.

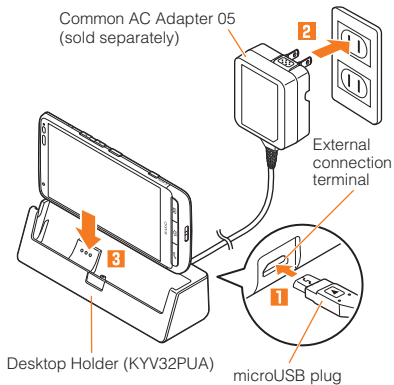

- 4** When charging ends, remove the product from Desktop Holder (KYV32PUA)
- 5** Unplug the power plug of Common AC Adapter 05 (sold separately) from the outlet

## Charging with specified AC Adapter (sold separately)/DC Adapter (sold separately)

Charging with Common AC Adapter 05 (sold separately)/Common DC Adapter 03 (sold separately) is explained. For information on the specified Common AC Adapter (sold separately)/Common DC Adapter (sold separately), see "Introduction of related accessories" (▶P.60).

- 1** Open the external connection terminal cover of the product
- 2** Check the orientation of the microUSB plug of Common AC Adapter 05 (sold separately)/Common DC Adapter 03 (sold separately) and insert it straight into the external connection terminal

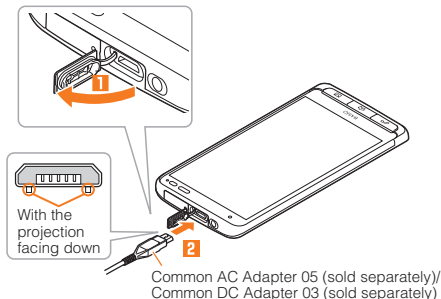

- 3** Insert the power plug of Common AC Adapter 05 (sold separately) into an outlet (100 VAC to 240 VAC)/Insert the plug of Common DC Adapter 03 (sold separately) into a cigarette lighter socket

Check that the charging light on the product lights in red. When the battery power turns on, **B** appears on the status bar.

When charging ends, the charging light turns off.

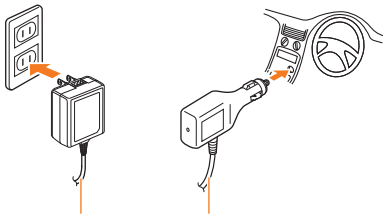

Common AC Adapter 05  
(sold separately)

Common DC Adapter 03  
(sold separately)

- 4** When charging ends, pull out the microUSB plug of Common AC Adapter 05 (sold separately)/Common DC Adapter 03 (sold separately) straight from the external connection terminal

- 5** Close the external connection terminal cover
- 6** Pull out the power plug of Common AC Adapter 05 (sold separately) from the outlet/ Pull out the plug of Common DC Adapter 03 (sold separately) from the cigarette lighter socket



#### memo

- ⊙ Note that applying unnecessary force with the external connection terminal connected to the external device might cause damage.
- ⊙ When charging starts with the battery empty, the charging light may not light immediately. But charging has started.

## Turning the power on/off

### Turning the power on

- 1 Press and hold  (POWER key) until the incoming light turns on

When the start screen appears, slide left the lower part of screen to cancel security.

- The first time the product turns ON, the initial settings such as "au Easy Setting" activate. Make the settings as required (▶P.19).



- While logos are displayed after the power is on, initial settings for touch panel are in process. Do not touch the screen. The touch panel may not work properly.
- "au Easy Setting" can be set up later even though it is skipped.
- If the charging light blinks in yellow when you turn the power on, the remaining battery is not sufficient for activating the product. Charge the battery before use.

## Turning the power off

- 1  (POWER key) (press and hold for at least one second)
- 2 [Power off]→[OK]

## Forcing shutdown and restarting

Force shutdown and restart the product when the screen freezes or the power cannot be turned off.

- 1  (POWER key) (press and hold for at least 11 seconds)



- If the product is forced shutdown and restarted, unsaved data will be erased. Do not force shutdown except when the product becomes inoperative.

## Making initial settings

When you turn on the product for the first time after purchasing the product, follow the onscreen instructions to set language, functions and services.

### 1 Slide "日本語" up to select "English", and [▶]

### 2 Select a Wi-Fi® network

- To skip the setting, tap [Skip].
- When a warning screen appears, follow onscreen instructions.
- To use Automatic setup (WPS), on the "Select Wi-Fi" screen, [⋮]→[Automatic setup (WPS)] and then follow the onscreen instructions.

### 3 Set up Google account, and [▶]

### 4 Set up "au Easy Setting" as required

- For setting au ID, see "Setting au ID" (P.19)



#### memo

◎ To change language from Japanese display, operate from Home screen→[設定 (Settings)]→[その他の設定 (Other settings)]→[言語と入力 (Language & input)]→[言語 (Language)] →"English".

## Setting au ID

By setting au ID, you can use various services provided by au such as "au Simple Payment Service" which allows you to purchase applications from the au スマートパス (au Smart Pass) or Google Play.

Use "au Easy Setting" to set au ID, update applications, etc.

### 1 Home screen→[サポート (Support)]→[au Easy Setting]

- To set in the initial settings, operate from step 2.

### 2 [Next]→[Register "au ID"]→[Next]→[au IDの設定・保存 (Set/save au ID)]

Authentication starts.

### 3 Enter the security code→[OK]

- Default value is a four-digit number written at subscription.
- To cancel the setting, tap [キャンセル (Cancel)].

### 4 Set au ID パスワード (au ID password)

- Enter 8 – 32 characters with alphabets and numbers combined.
- If you already obtain au ID, set your au ID to the product.

### 5 [設定 (Set)]→[終了 (Exit)]

### 6 Follow onscreen instructions to update applications

- 7 On Restoration of Backups screen, select whether to restore data→[Next]
- 8 On Automatic Backup Setting screen, select a service to use→[Next]
- 9 On **アプリの復元 (Restore applications)** screen, select applications→[次へ (Next)]
- 10 On **おすすめアプリ (Recommended applications)** screen, select applications to install→[次へ (Next)]→[OK]
- 11 After that, follow the onscreen instructions to finish the settings



#### memo

◎ To set au ID only, from Home screen→[サポート (Support)]→[au ID Setting].

## Setting E-mail

### Initial settings

To use E-mail (@ezweb.ne.jp), subscription to LTE NET is required. If you did not subscribe it when you purchased the product, contact an au shop or Customer Service Center. When activating E-mail for the first time, the initial setting screen appears. Follow onscreen instructions to make the settings. Your E-mail address is determined automatically after initial setting. You can change the E-mail address later.

### Changing your e-mail address

- 1  →[E-mail]
- 2 [MENU]→[E-mail settings]→[Other settings]
- 3 [接続する (Connect)]→[Eメールアドレスの変更へ (To Change E-mail address)]
- 4 Tap the security code entry field and enter the security code→[送信 (Send)]
- 5 Confirm "アドレス変更前の注意 (Notes before changing e-mail address)" and tap [承諾する (I accept)]
- 6 Tap e-mail address field and enter an e-mail address→[送信 (Send)]→[OK]

## Basic Operation

### Using touch panel

Operate directly touching display with your finger.

#### ■ Tap/Double-tap

Gently touch a screen and then immediately release your finger. "Double-tap" is an operation of tapping the same position twice consecutively.



#### ■ Long-touch

Keep touching an item or key.

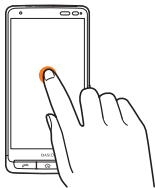

#### ■ Slide

While your finger is gently touching the screen, trace it to the desired direction to move over.

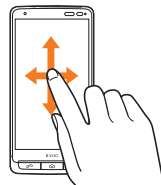

#### ■ Flick

Quickly move (flicking) your finger up, down, right, or left.

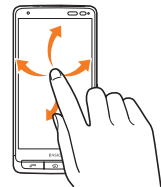

#### ■ Zoom-out/Zoom-in

Gently touch a screen with two fingers and widen or narrow the fingers' distance.

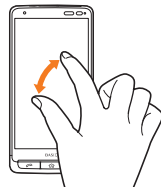

## Drag

Keep touching an item or icon, trace it to the desired direction to move.

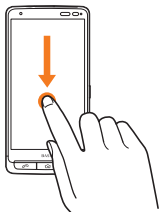

## Home screen

Home screen consists of multiple screens. Slide/flick left or right to switch them.

Or press  to switch to the main home screen.

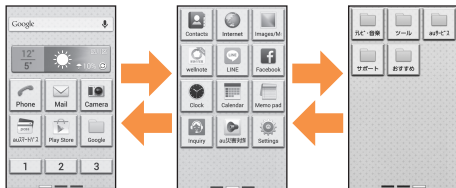

(Main home screen)

## Using Home screen

Three Home screen layout patterns are provided on the product. You can choose from default icon-layout, "Phone and mail", and " Customizable".

By default, the below icon-layout pattern is set.

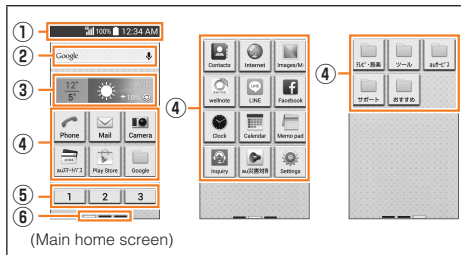

(Main home screen)

《Home screen》(Default)

- 1 **Status bar**
- 2 **Search widget**
- 3 **Weather widget**
- 4 **Applications/folders**

Icons/folders for pre-installed applications are displayed.

- 5 **Direct buttons 1 - 3**
- 6 **Indicator**



 memo

- In this manual, operations from the default Home screen layout are explained.
- Downloaded applications will be added to the Home screen.
- When there are new/unread E-mails or PC-mails, total number of them appears on the upper right of the icon.

**Folders**

- Icon with multiple applications stored is called "folder". Tap a folder to select a stored application. To close a folder, tap [Close].

## Using Weather widget

Check weather information.

### 1 Home screen→Tap Weather widget

Weather widget screen appears.

### 2 Check the details of the weather on Weather widget screen

 memo

- To check weather information on other areas, tap [Settings] on Weather widget screen→[地域を選択 (Select area)]

## Changing Home screen layout pattern

### 1 Home screen→[Settings]→[Home screen settings]→[Select layout pattern]

A home layout pattern selection screen appears.

2 Phone and mail	Phone, E-mail and frequently-used applications are preferentially allocated
Customizable	Applications area allocated for customizing freely
Default	Applications are allocated by categories.







### 3 [OK]

## Monitoring the product's status

### Icons













Notification icons appear on the left of the status bar, showing missed calls, new mail, operations in progress, etc., and status icons appear on the right, showing the status of the product.

### Examples of main notification icon

Icon	Description
	Missed call
	New mail message (SMS)
	New mail message (E-Mail)
	New mail message (PC-mail)
	New mail message (Gmail)
	Energy save mode is enabled

### Examples of main status icon

Icon	Description
	Battery level
	100%/ empty/ charging

Icon	Description
	Signal strength/Signal condition (LTE/WiMAX 2+)  level 4/  out of range/  in communication  LTE/WiMAX 2+ available*/  in roaming (A communication method corresponding to a network is also displayed.)
	Airplane mode is activated
	Wi-Fi <sup>®</sup> signal strength  level 4/  level 0
	Silent mode (Vibrate) set
	Silent mode (Mute) set
	Silent mode (Drive) set

\* You can use two networks of "LTE" and "WiMAX 2+" in Japan. In any case, "4G" is displayed. The terminal is connected to a network the Company judges to be less congestion according to network congestion etc.

### Notification panel

Slide down the status bar to display the notification panel. You can check details of notification icons or start corresponding apps. Also, you can set frequently-used functions, add shortcuts and activate apps from shortcuts.

## memo

- ◎ You can also hide the notification panel by tapping the top area of the screen, where date, time and battery icon are displayed.

## Checking your own phone number

### 1 Home screen → [Settings] → [Profile]

Profile screen appears.

## Setting Silent mode

Set the silent mode not to inconvenience people around you in a public place.

### 1 (POWER key) (press and hold for at least one second) → / / /

 : Drive

 : Vibrate

 : Mute

 : Silent mode off

## Setting Airplane mode

When Airplane mode is set, wireless functions are disabled (telephone, packet transmission, wireless LAN (Wi-Fi®).

### 1 (POWER key) (press and hold for at least one second) → [Airplane mode]

When Airplane mode is set,  appears on the status bar.

## Setting Direct button

Register frequently-used contacts to the direct buttons to make calls or send mails with simple operations. Add contacts to Contacts before setting the Direct buttons (▶P.26).

### 1 Home screen → Direct button [ 1 ]/[ 2 ]/[ 3 ]

### 2 Tap a contact to register

The contact is set to the direct button on the Home screen.

## memo

- ◎ Alternatively, from Settings → [Home screen settings] → [Direct button settings] → [Add] of Direct button 1/2/3 → Tap a contact to register.



## Using Direct button

### 1 Home screen → Tap a registered direct button

A contact screen appear.

### 2 [Phone]/[SMS]

Tap [Phone] to dial

- Tapping  or  switches displayed items of the contact.

Tap [Show details] to display the detail screen.

## Adding a contact to Contacts

### 1 Home screen → [Contacts]

Contacts list appears.

- When no contacts is saved in Contacts, tap [Create a new contact] → [Keep local], and then go to step 3.

### 2 [Create contact]

- When "Save contact to" screen appears, select an account.
- When no account is registered, a screen asking for adding an account appears. Follow onscreen instructions.

### 3 Enter required items

- For saving fixed-line phone number, enter from the city code.

### 4 Tap [OK]

Saved contact screen appears.

## Making a call

### 1

The phone number entry screen appears.

- If the outgoing/incoming call history screen appears, tap "Phone" tab.
- Alternatively, tap [Phone] to display the dialpad.

### 2 Enter a phone number

When calling to a fixed-line phone, enter the phone number starting with the area code even if you are in the same area.

### 3 [Call] → Call → [End call]

Press   (Volume DOWN/UP key) during a call to adjust volume of the other party's voice.



#### memo

- If you cover the screen by your face etc. while dialing/calling, the display turns off for preventing false operation.
- Note that even if you cover the microphone, the sound can be conveyed to the other party.

## Making an international call (au international call service)

You can make international calls without any special procedure for your product.

### 1 → International access code, country code, city code, the other party's phone number → [Call]

- If the city code begins with "0", omit "0". However "0" may be required to dial to some country or area such as Italy, Moscow.





#### memo

- International call charges are billed together with monthly local call charges.
- For more information on au International Call Service, dial either of the following numbers:  
From au cell phones (toll-free): 157 (area code not required)  
From fixed-line phones (toll-free): 0077-7-111  
(Open 9:00 to 20:00 every day)

## Receiving a call

### 1

Alternatively, on incoming call screen, slide  right to  to answer a call.

### 2 Call → [End]

## Displaying menu

There are two types of methods to display a menu screen; by tapping [] or [Menu] and by long-touching entry field or item.

## au Disaster Countermeasure

au災害対策 (au Disaster Countermeasure) is an application with which you can use 災害用伝言板 (Disaster Message Board), 緊急速報メール (Emergency Rapid Mail) (緊急地震速報 (Earthquake Early Warning), 災害・避難情報 (Disaster and Evacuation Information), 津波警報 (Tsunami Warning)) and 災害用音声お届けサービス (Disaster Voice Messaging Service).

### 1 Home screen → [au災害対策 (au Disaster Countermeasure)]

au災害対策 (au Disaster Countermeasure) menu appears.

When you activate for the first time, terms and conditions etc. appear. Verify the content, follow the onscreen instructions.

## Using Disaster Message Board

Disaster Message Board service enables you to register information of well-being from an area of distress via LTE NET in case of large-scale disaster such as earthquake with a seismic intensity of over 6 lower. Registered information can be viewed on any cell phones and PCs besides by au cell phone users.

For details, refer to "Disaster Message Board" of au homepage.

### 1 au災害対策 (au Disaster Countermeasure) menu screen → [災害用伝言板 (Disaster Message Board)]

Follow the onscreen instructions to register/confirm.



#### memo

- ◎ To register information of well-being, E-mail address (~ezweb.ne.jp) is required. Set up E-mail address beforehand.
- ◎ Deleting or changing the setting for information of well-being is unavailable during Wireless LAN (Wi-Fi®) connection.
- ◎ The Company makes no guarantees about the quality of this service. The Company is not liable in the event of any nonconformities about registration of well-being information or damages by loss of well-being information arising from intense access to this service or equipment failure or damages caused by registered well-being information.

## Using Emergency Rapid Mail

Emergency Rapid Mail is a service that distributes Earthquake Early Warning or Tsunami Warning delivered from the meteorological bureau or Disaster and Evacuation Information delivered from the government or local public organization to all au cell phones in specified areas simultaneously. When you purchase the product, "受信設定 (Receive options)" of the Emergency Rapid Mail is set to "受信する (Receive)". Reception setting of Tsunami Warning is available in the settings of Disaster and Evacuation Information.

When you receive Earthquake Early Warning, ensure your safety and take proper action according to the situation around you. When you receive a Tsunami Warning, draw away from sea coast immediately and evacuate to safe place such as upland or well-built high building.

## 1 au災害対策 (au Disaster Countermeasure) menu→[緊急速報メール (Emergency Rapid Mail)]

Inbox appears.

Select a mail you want to view to check the detail.



### memo

- The service is available only in Japan (it cannot be used overseas).
- No information fee or communication charge is required for receiving Emergency Rapid Mail.
- When you receive Emergency Rapid Mail during a call, the warning tone does not sound.
- You cannot receive Emergency Rapid Mail when your cell phone is turned off.
- Emergency Rapid Mail may not be received if you are in a place where signal does not reach even in the service area (e.g. in a tunnel, basement) or in a place with a poor reception.
- You cannot receive Emergency Rapid Mail that the reception is failed.

○ Reception of Emergency Rapid Mail is notified by a special warning tone and vibration. It is not possible to change the warning tone.

\* Reception of Earthquake Early Warning is notified by a special warning tone, voice ("地震です" (Jishin-desu)) and vibration.

- Information from someplace other than your current location may be received.
- KDDI is not liable for damages suffered by customers resulting from the service's information, lack or delay in the information caused by transmission or system breakdowns, or other events that are outside the responsibility of KDDI.
- Refer to the Japan Meteorological Agency web page for details about distribution of Earthquake Early Warning.  
<http://www.jma.go.jp/>

### Earthquake Early Warning

- Earthquake Early Warning is sent to areas where strong quakes (over 4 degrees) are expected when the earthquake whose the maximum seismic intensity 5 lower is anticipated occurs.
- Immediately after an earthquake occurs, quakes (P waves and initial tremors) near the epicenter are detected and position, scale, and expected strength are automatically calculated and notification is sent as soon as possible within a few seconds to tens of seconds before the strong quakes (S waves and major tremors) caused by the earthquake start.
- Earthquake Early Warning may not arrive before strong tremors in arrears near the epicenter.

- ◎ This delivery system is different from Earthquake Early Warning provided through TV, radio, or other communication procedures, which means that the time the Earthquake Early Warning arrives may vary.

### Tsunami Warning

- ◎ Tsunami Warning is a notification delivered from the meteorological bureau (major tidal wave, seismic sea wave) to the area including target coast.

### Disaster and Evacuation Information

- ◎ Disaster and Evacuation Information is a service that distributes bulletins concerning residents' safety including evacuation advisories, evacuation orders and other warnings issued by the national and local governments.

## Using Disaster Voice Messaging Service

Disaster Voice Messaging Service is a service which allows you to record your voice and send someone you want to inform your well-being in case of a large-scale disaster.

### 1 au災害対策 (au Disaster Countermeasure) menu screen → [災害用音声お届けサービス (Disaster Voice Messaging Service)]

Follow the onscreen instructions to register.

### ■ Sending voice (sending)

Select "声をお届け (Sending voice)", [①お届け先を選択 (Select delivery)\*] → [②お届けしたい声を録音 (Record voice)]

\* Alternatively, delivery address can be selected in Phonebook.

### ■ Receiving voice (receiving)

Receiving voice messages is notified on a pop-up screen or SMS. To listen to voice messages, receive (download) and play it.

- When recipient uses a smartphone without au災害対策 (au Disaster Countermeasure) activated or au cell phone, SMS is sent.
- In case of receiving SMS, the information is not saved on au災害対策 (au Disaster Countermeasure).





## memo

- For use over Wi-Fi®, it is necessary to carry out initial setting over 4G (LTE/WiMAX 2+) network.
- Voice message can be recorded for up to 30 seconds.
- Messages can be sent and received to or from au cell phones, other network operators' cell phones and PHS.
- Voice message may be difficult to hear if the media volume is low or Silent mode is set.
- Saving or playing Voice messages may fail if a phone does not have available memory.
- Some cell phones do not support receiving voice messages. For details, refer to au homepage.

## Using Disaster information

You can check history of Disaster and Evacuation Information delivered by local government, disaster information portal, etc.

**1 au災害対策 (au Disaster Countermeasure) menu→[災害情報 (Disaster information)]**

**2 Follow the onscreen instructions**

# Safety Precautions

## Exemptions

- The Company is not liable for any damages arising from earthquakes, lightning, storms, floods or other natural disasters, as well as fires, actions by third parties, other accidents, intentional or mistaken misoperation by the customer, or use under other unusual conditions outside the responsibility of the Company.
- The Company is not liable for any incidental damages (change/disappearance of described content, loss of business income, disruption of business, etc.) arising from use or inability to use the product.
- The Company is not liable for any damages arising from failure to observe the described content of this manual.
- The Company is not liable for any damages arising, for example, from malfunction caused by combination with connected devices or software not related to the Company.
- Captured image data or downloaded data may sometimes be altered or lost due to faults, repair or other handling of the product. The Company is not liable for any damage or lost income resulting from recovery of these data.
- It is recommended you keep a copy of important data on your PC's hard disk, etc. Whatever the cause of the defect or malfunction may be, the Company assumes no responsibility for alteration or loss of saved data.

\* The Company\* as appears in this manual refers to the following companies:  
Sold by: KDDI CORPORATION, OKINAWA CELLULAR TELEPHONE COMPANY



Manufactured by: KYOCERA Corporation

- Reproduction of the content of this manual in part or in whole is prohibited.
- The content of this manual is subject to change without notice.
- Every effort has been made in the preparation of this manual. Should you notice any unclear points, omissions, etc., feel free to contact us.

## Safety Precautions (Observe Strictly)

- **Before using this product, thoroughly read these safety precautions for proper use. After reading, store the precautions in a safe place.**
- These "Safety Precautions" describe instructions that should be observed to prevent damage to property or injury to the customer or others using the product.
- These instructions are divided into the following categories.

### Explanation of indications used in this manual







 <b>DANGER</b>	This symbol indicates the potential and imminent danger of death or serious injury <sup>(1)</sup> to a person.
 <b>WARNING</b>	This symbol indicates the possibility of death or serious injury <sup>(1)</sup> to a person.
 <b>CAUTION</b>	This symbol indicates the possibility of personal minor injury <sup>(2)</sup> to a person or physical damage <sup>(3)</sup> .

\*1 Serious injury: This refers to loss of sight, injury, burns (high- and low-temperature), electric shock, broken bones, injuries with residual aftereffects from poisoning, etc., and injuries requiring hospital admission for treatment or long term hospital attendance as an outpatient.

\*2 Minor injury: This refers to injuries, burns (high- and low-temperature), electric shock, etc. that do not require hospital admission for treatment or long-term hospital attendance as an outpatient.

\*3 Physical damage: This refers to extended damage to buildings, furniture, livestock, or pets.

## ■ Explanation of graphic symbols used in this manual

	Indicates an action that is not allowed.		Indicates that use in a place where the product is likely to get wet or allowing the product to get wet is not allowed.
	Indicates that handling with wet hands is not allowed.		Indicates an action that must be done.
	Indicates that disassembly is not allowed.		Indicates that the power plug must be disconnected from the power outlet.

## ■ Precautions common to the main unit, internal battery, charging equipment, au Nano IC Card 04, peripheral devices



**DANGER**

**Be sure to read the following hazards before use.**



Be sure to use only the specified peripheral devices. Use of other devices might cause overheating, ignition, rupture, fault, or leakage of liquid.



Do not use, store or leave the product in hot places (e.g. by the fire, near a heater, under a kotatsu, in direct sunlight, in a car in the hot sun). Doing so might cause ignition, rupture, fault, fire or injury.



Before entering an area where flammable gas is generated such as a gas station, be sure to turn off the product. Do not charge the battery. Failure to observe these precautions might cause the gas to catch fire.



Do not put the product in a cooking apparatus such as microwave oven or a pressure vessel. Doing so might cause ignition, rupture, fault, fire or injury.



Do not throw the product into a fire or heat it. Doing so might cause fire, rupture or fire.



Do not short-circuit the connection terminal, earphone microphone terminal, etc. Do not allow conductive foreign objects (metal fragments, pencil leads, etc.) to come into contact with or get inside the connection terminal, earphone microphone terminal, etc. Doing so might cause a fire, burns, a fault due to heat generation.



When using a metal accessory etc., make sure not to allow the metal part come in contact with the connection terminal, earphone microphone terminal or power outlet. Doing so might cause electric shock, ignition, injury or a fault.



Do not expose the camera lens to direct sunlight for an extended period. Doing so might cause ignition, rupture or fire by the light-collecting mechanism of the lens.



The customer is not allowed to disassemble, modify or repair the product. Doing so might cause a fault, ignition, electric shock, or injury. The Company is not liable even in the event of any nonconformities arising on the product or peripheral devices as a result of modification, etc. Modification of the product is in violation of the Wireless Telegraphy Act.

**WARNING**

**Be sure to read the following warnings before use.**



Do not drop or subject to strong impact, such as throwing. Doing so might cause rupture, overheating, ignition, or a fault.



Do not use outside when you can hear thunder. Doing so might risk lightning strikes and electric shock.



Do not let your hands, fingers and other parts of the body touch the connection terminals. Doing so might cause electric shock, injury or a fault.



If the product is damaged because it is dropped or something, and its display is cracked or internal parts are exposed, do not touch the cracked display or exposed parts with your hands. Doing so might cause electric shock or injury from damaged parts. Contact an au shop or Keitai Guarantee Service Center.



If the wet product is charged, electric shock, short circuit, or corrosion may occur and overheating may cause fire, malfunction or burns.



Although this product model has waterproof property, stop use if liquid such as water gets inside the product from the external connection terminal cover or the card slot cover. Continued use of the product in this state might cause overheating, fire or a fault.



Do not operate the product while driving an automobile or motorized bicycle, riding a bicycle or walking. Doing so may compromise traffic safety and cause an accident.



If charging is not completed after the specified charging time, stop charging. Failure to do so might cause leakage of liquid, overheating, rupture or ignition.



Do not leave in places within the reach of small children. Small children might swallow small parts, etc. by mistake and choke on them, or might drop them by mistake and cause accidents or injury.



## CAUTION

**Be sure to read the following cautions before use.**



Do not store the product in places subject to direct sunlight (e.g. in automobiles), places that get hot, places that get extremely cold, and in humid or dusty places. Doing so might cause overheating, fire, deformation or a fault.



Do not leave on unstable places such as rocky stands or tilting surfaces. Dropping the product may cause injury or damage. Pay careful attention while vibrator is set. Also, pay sufficient attention to impact, etc.



Do not cover or wrap the product with bedding, etc. while using or charging the product. Doing so might cause fire, fault or injury.



Do not touch the product or specified charger for a long time while power is being supplied from an external source. Doing so might cause low-temperature burns.



The product may become hot by prolonged use especially in high-temperature environment. Be careful when using the product touching your skin for a long time, as it might cause low-temperature burns.



Do not use power outlets or wiring apparatus beyond its rating. Also, exceeding rating, for example, by connecting multiple devices to a single power strip might cause overheating and fire.



Do not place near corrosive chemicals or in places where corrosive gas is generated. Doing so might cause a fault or loss of internal data.



Do not use if there is smoke, abnormal odor or noise, excessive overheating, or other abnormalities. If an abnormality occurs, disconnect the specified charger from the power outlet or socket if you are charging the battery, make sure that the product is not overheating before turning the power off, and contact an au shop or Keitai Guarantee Service Center. Also, if you have dropped or damaged the product, do not continue to use it in that state, and contact an au shop or Keitai Guarantee Service Center.



When inserting an earphone, etc. into the product, adjust the volume to the proper level. Setting too loud a volume or using the earphone continuously for a long period of time might adversely affect your ears. Also, raising the volume too high might prevent you from hearing sounds around you, which might in turn lead to a traffic accident at a railroad crossing or pedestrian crossing.



When adjusting the volume with an earphone, etc. inserted into the product, raise the volume a little at a time. If you raise the volume too much from the outset, sudden loud noise from the earphone, etc. might adversely affect your ears.



When using an AC adapter or external device, insert/remove the connector straight to/from the terminal. Make sure the orientation of the connector. Unless it's correct, it may cause damage or a fault.

## ■ Main unit



### **DANGER**

**Be sure to read the following hazards before use.**



Do not puncture the product with a nail, hit with a hammer or step on the product. Doing so might cause fire or damage.



Be careful not to have the product bitten by your pet. It might cause leakage, overheating, rupture, ignition of the internal battery, fire or injury.



### **WARNING**

**Be sure to read the following warnings before use.**



Do not use a cell phone while driving a car or riding a motorbike or bicycle. It might cause a traffic accident. Use of a cell phone while driving a car or motorbike is prohibited by law. Use of a cell phone while riding a bicycle may be punishable by some regulations.



Follow the instructions of each medical facility for the use of cell phones on their premises. Power off the product in a place where the use is prohibited. Failure to do so may affect electronic equipment and electronic medical equipment.



Turn off the product or put it in Airplane mode before boarding an airplane. Use of cell phones on board is restricted. Follow the instructions of each airline. Failure to do so may adversely affect on-board electronic equipment. Prohibited acts related to cell phone usage on an airplane may be punished by law.



When using the product near an implanted pacemaker, implanted cardioverter-defibrillator or other electronic medical device, radio waves might affect these units and devices. So, please observe the following.

1. Those with an implanted pacemaker or implanted cardioverter-defibrillator should carry or use the product at least 15cm away from the pacemaker or cardioverter-defibrillator.
2. Turn the product off or set "Airplane mode" when it may be difficult to keep at least 15cm away such as in a situation you cannot move freely, since there may be people with a cardiac pacemaker or implanted cardioverter-defibrillator nearby.
3. When a medical institution has laid down designated areas where use of the product is prohibited or is not allowed to be brought in, abide by the instructions of that medical institution.
4. When using electronic medical devices other than an implanted pacemaker and implanted cardioverter-defibrillator outside a medical institution (e.g. home medical treatment), check individually with the manufacturer of the electronic medical device regarding the influence of radio waves.



Stay alert to your surroundings when calling, messaging, browsing the Internet, shooting photos, playing games, watching TV (1Seg) or listening to music. Failure to do so might cause a fall or traffic accident.



Do not send data by infrared communication with the infrared port pointing toward eyes. Doing so might affect eyes. Also, sending data with the infrared port pointing toward some other infrared device might cause false operation, etc.



Do not light the photo light/simple light in front of a person's eyes. Do not gaze at the photo light/simple light emitting part when the photo light is lighted. Doing so might cause impairment of eyesight, etc. Be especially careful not to shoot small children from a very close distance.



Do not light the photo light/simple light toward a driver of a car, motorbike or bicycle. If dazzled by the light, the driver might become unable to drive and cause an accident.



Sometimes, very rarely some people demonstrate symptoms such as temporary muscle spasms, loss of consciousness, etc. by watching repeatedly flickering screens. Those with a past history of this should consult with a physician beforehand.



Chemical hardened glass is used for the display of the product. In case it is broken, do not touch the broken part. Doing so might cause injury by the broken part. Contact an au shop or Keitai Guarantee Service Center.



## CAUTION

**Be sure to read the following cautions before use.**













Use of the main unit in an automobile sometimes affects on-vehicle electronic devices, though this rarely happens. If this happens, stop use since this may impair safe travel.



If you feel any abnormality with your skin, immediately consult a dermatologist. Itching, rashes, eczema, etc. sometimes occurs depending on your physical constitution and condition.  
The materials of parts used on the product are as follows.

### ■ Main unit of BASIO

Part	Material	Surface treatment
Exterior case (Display side)	PA resin	Acrylic UV hard coating
Exterior case (bottom, back),  /  /  , external connection terminal cover, card slot cover,   ,  , antenna top, camera periphery	PC resin	Acrylic UV hard coating
 (POWER key)	PMMA resin	-
Display	Chemical hardened glass	Antifouling treatment
Lens for the camera	PMMA resin	Hard coating

Part	Material	Surface treatment
Antenna shaft	SUS	-
Charging terminal	Copper alloy	Gold plating (first nickel plating)
Earphone microphone terminal	PA resin	-
Camera light/ simple light,  /  /  top light	PC resin	-

#### ■ IC Card Tray Ejecting Tool for BASIO (sample)

Part	Material	Surface treatment
Outer cover	POM resin	-



Do not bring the product close to magnetized objects such as cash cards, floppy disks, credit cards, and prepaid cards. Doing so might result in loss of recorded information.



Do not allow liquids, metal objects, burnable items, and other foreign matter to get inside the earphone microphone terminal, the external connection terminal, the microSD memory card slot or the au Nano IC Card 04 slot. Failure to do so might cause fire, electric shock, injure or a fault.



Do not swing the product around by holding the earphone or the hand strap, etc. Doing so might cause an accident or damage.



Use the product with the external connection terminal cover, the card slot cover, etc. closed. If the covers are open, dirt or water may get inside causing a fault.



Stow the TV antenna when not watching TV (1Seg). If you operate the product for calling, etc. with the antenna extended, it might cause unexpected injury by hitting your face, etc.



If you have a weak heart, be careful when setting the incoming vibration and ringtone volume to prevent adverse effects on your heart.



Do not place the product directly on sand at a beach, etc. Sand or other small particles might get inside the microphone or speaker, causing the volume to drop. If sand gets inside the product, it might cause overheating or a fault.



When using the product for calling or data communication, be careful not to keep the product in direct contact with your skin for a prolonged period, or not to cover the product with paper, cloth, bedding, etc. The main unit might get hot, causing fire, injure, burns or a fault.



## Internal battery



Li-ion 00

**(The internal battery of this product is a lithium-ion battery)**

The internal battery is not fully charged at the time of purchase. Charge the battery before using the product.



**DANGER**

**Be sure to read the following hazards before use.**



If the leaked liquid gets on your skin or clothes, immediately rinse it off with water to avoid injury. If the liquid gets into your eyes, do not rub, but after wash your eyes with water, and immediately consult a doctor to avoid the risk of losing your eyesight. If the liquid gets on a device, wipe it off without touching it.



The internal battery is a consumable item. If the performance of the internal battery does not recover (e.g. the usable time after each charge has become extremely short), the battery is at the end of service life, so stop use. Failure to do so might cause overheating, fire, rupture or leakage. Since the battery is built into the product, we keep your product and replace the battery for a fee. You may not use the product for a certain period. The life time of the internal battery depends on the usage etc.

## Charging equipment



**WARNING**

**Be sure to read the following warnings before use.**



Do not use at other voltages than the specified power supply voltage. Doing so might cause ignition, fire, overheating, electric shock or injury.

- AC adapter (sold separately) that can be charged overseas: 100 VAC to 240 VAC
- Common DC Adapter 03 (sold separately): 12/24 VDC (for negative grounded vehicles only)



Firmly insert a power plug of specified charger into the power outlet or cigarette lighter socket down to the base of its pins. Incomplete insertion of the power plug might result in electric shock, overheating, ignition, fire or injury. Do not use when a specified charger is damaged, or a power outlet or a cigarette lighter socket is loose.



If the fuse in the common DC Adapter 03 (sold separately) blows, replace it with a fuse of the specified type (250 V, 1 A). Replacing with a different type of fuse might cause overheating or ignition. (For information about fuse replacement, carefully read the manual for the common DC Adapter 03 (sold separately).)



Do not damage, modify, twist, pull or place a heavy object on the cable of the specified charger. Do not use a damaged cable. Doing so might cause an electric shock, short circuit, fire or injury.



Do not let your hands, fingers and other parts of the body touch the connection terminals or the earphone microphone terminal. Doing so might cause electric shock, injury or a fault.



If you hear thunder, do not touch the power plug. Doing so might cause an electric shock as a result of a lightning strike.



Before cleaning the charging equipment, unplug its power plug of the specified charger from the outlet or cigarette lighter socket. If the plug remains plugged in when you clean the equipment, it might cause a short circuit. Also, wipe off the dust on the charging equipment's power plug. If the plug is left covered with dust, it might cause a fire.



Wipe off dust on the power plug. Failure to do so might cause fire, burns or electric shock.



Install and position in-car devices where they do not hinder driving or safety equipment such as airbags. It might cause a traffic accident. Install in-car devices following the instructions of their manuals.



When the AC adapter is not to be used for a long time, disconnect the specified charger's power plug from the power outlet. Doing so might cause fire or a fault.



Do not use in places subject to direct splashing with water, pet urine or other liquids. Doing so might result in faults and injury resulting from overheating, fire, electric shock, or short-circuiting of electronic circuits. In the event that the product is splashed with liquid, immediately disconnect the specified charger's power plug.



## CAUTION

**Be sure to read the following cautions before use.**



Do not use in humid places such as bath areas, or connect/disconnect the specified charger with wet hands. Doing so might cause electric shock, injury or a fault.



Charge the battery in a stable place. If placed on an inclined surface or wobbly stand, the product might fall causing injury or damage. Pay careful attention while vibrator is set. In addition, do not cover or wrap the product with a cloth or bedding. Doing so might cause a fire, injury or a fault.



When unplugging the specified charging equipment's power plug from the outlet or cigarette lighter socket, hold and pull the power plug. If you pull the cable, the cable might be damaged.



Do not use the common DC Adapter 03 (sold separately) with the car engine stopped. Doing so might result in draining of the car battery.



If you feel any abnormality with your skin, immediately consult a dermatologist. Itching, rashes, eczema, etc. sometimes occurs depending on your physical constitution and condition.

The materials of parts used on the Desktop Holder (KYV32PUA) are as follows.

#### ■ Desktop Holder (KYV32PUA)

Part	Material	Surface treatment
Exterior case	ABS resin	-
Lever, Knob	POM resin	-
Charging terminal	Brass	Gold plating (first nickel plating)
Rubber foot	Urethane foam	-

## ■ au Nano IC Card 04



### WARNING

**Be sure to read the following warnings before use.**



Do not put the au Nano IC Card 04 in a cooking apparatus such as a microwave oven or a pressure vessel. Doing so might cause melting, overheating, fuming, loss of data or a fault.



### CAUTION

**Be sure to read the following cautions before use.**



Be careful when attaching/removing the au Nano IC Card 04. Doing so might injure your hands or fingers.



Use only the devices specified by the Company to insert the au Nano IC Card 04 in. Using a device not specified by the Company might cause loss of data or a fault.  
For the specified devices, contact an au shop or Customer Service Center.



Do not disassemble or modify the au Nano IC Card 04. Doing so might cause loss of data or a fault.



Do not use or leave the au Nano IC Card 04 in hot places such as by the fire or a heater. Doing so might cause melting, overheating, fuming, loss of data or a fault.



Do not throw the au Nano IC Card 04 into a fire or heat it. Doing so might cause melting, overheating, fuming, loss of data or a fault.



Do not touch the IC (metal) part of the au Nano IC Card 04 or short-circuit it. Doing so might cause loss of data or a fault.



Do not drop the au Nano IC Card 04 or subject it to strong impact. Doing so might cause a fault.



Do not fold, bend or place a heavy object on the au Nano IC Card 04. Doing so might cause a fault.



Do not wet the au Nano IC Card 04. Doing so might cause a fault.



Do not scratch the IC (metal) part of the au Nano IC Card 04. Doing so might cause a fault.



Do not store the au Nano IC Card 04 in dusty places. Doing so might cause a fault.



Do not store the au Nano IC Card 04 in places exposed to direct sunlight or hot and humid places. Doing so might cause a fault.



Store the au Nano IC Card 04 out of reach of small children. Failure to do so might cause injury, etc. if they accidentally swallow and choke on it.

## Handling precautions

These precautions are provided to ensure that performance can be fully demonstrated. Thoroughly read these precautions to ensure correct use.

### ■ Precautions common to the main unit, internal battery, charging equipment, au Nano IC Card 04, peripheral devices

- Do not apply excessive force to the product during use. Be sure not to put the product into a tightly packed bag or place a heavy object on the product in a bag. Sitting on the product in your pocket might damage the display or internal circuit board resulting in a malfunction. Keeping an external device connected to the external connection terminal or earphone microphone terminal might damage the connector resulting in a malfunction. Such damage and malfunction are not covered by the warranty, even if there is no external damage.
- To ensure waterproof property (equivalent to IPX5 and IPX8) of this product, use the product with the external connection terminal cover and the card slot cover securely for use. Note that the waterproof property is not guaranteed in every usage condition. Do not allow water to get inside the product or splash water on the charging equipment or optional accessories. Do not open/close the external connection terminal cover or the card slot cover in the rain or with waterdrops on the surface of the product. Doing so might cause water intrusion resulting in internal corrosion. Malfunctions determined to be caused by water intrusion are not covered by the warranty.

- 
- Do not use the product in extremely hot, cold or humid places. (Use within an ambient temperature range of 5°C to 35°C and humidity range of 35% to 85%).
    - Charging equipment
    - Peripheral devices
- 
- Do not use the product in extremely hot, cold or humid places. (Use within an ambient temperature range of 5°C to 35°C and humidity range of 35% to 90%. Temporary use at 36°C to 40°C is allowed.)
    - Main unit
    - au Nano IC Card 04 (attached to the main unit)
- 
- Do not use in places subject to lots of dust or vibration.
- 
- Clean the connection terminals and earphone microphone terminal with dry cotton swabs, etc. every now and then. Soiled terminals might cause poor connection. Do not exert a strong force to clean the connection terminals or earphone microphone terminal to prevent deformation.
- 
- Clean the product with a dry soft cloth (such as the type used for eyeglasses). Do not rub it roughly with a dry cloth. The display may be damaged. Drops of water or dirt left on the display may cause stains. Wiping the product using alcohol, thinner, benzine, detergent, etc. might erase the printing on the outer casing or cause discoloration.
- 
- Use as far away as possible from land-line phones, TVs and radios. Use nearby might affect them.
- 
- The product may become warm while charging or during other operations, depending on the situation, but this is not abnormal.
- 

- 
- When the product is used by a child, parents or guardians should thoroughly read the "Basic Manual" (this manual) and teach the child how to use it.
- 
- Do not put stickers on the product. Sound may not be emitted or voice sound may not be delivered to the party.
- 

## ■ Main unit

- 
- Do not forcefully press, tap or intentionally subject the display to strong impact. Doing so might cause scratching or damage.
- 
- Do not forcefully press your fingernails, sharp objects or hard objects against keys or display surface. Doing so might cause scratching or damage. The touch panel is designed to be lightly touched by fingers. Do not apply strong pressure with your fingers or sharp-pointed objects (such as fingernails, ballpoint pens and pins) on the touch panel. Touching the panel may not work in the following cases. Note that it may cause malfunction.
    - Operation with gloved hands
    - Operation with fingernails
    - Operation with foreign object on the screen
    - Operation with protective sheet or seal on the screen
    - Operation with a water drops or dew condensation attached on the touch panel
    - Operation with wet or sweaty fingers
    - Operation under water
-

- Never use modified au cell phones. Use of a modified device violates the Radio Law.  
This product has acquired the certification of conformity with technical regulations for the specified radio station based on the Radio Law, and the "Technical Conformity Mark" is checkable on the product as a certificate.  
Home screen → [Settings] → [Other settings] → [About phone] → [Compliance information]  
If the screws of the product are removed and modifications are made to the internal components, the certification of conformity with technical regulations will become invalid.  
Do not use the product with the certification invalid, as it is a violation of the Radio Law.
- To prevent unlawful modification, the product has been designed so that it cannot be easily disassembled. Modifying the product is prohibited by the Radio Law.
- Contents saved in the product, such as contacts, mails and favorites, might be altered or lost in an accident, fault, repair or mishandling. Be sure to keep a copy of important contents. Note that Company assumes no responsibility for any damages or lost profits resulting from altered or lost contents.
- Note that content data (both charged or free content) saved with the product cannot be returned to the customer when the product is replaced for repair of a fault, for example.
- The product uses liquid crystal for its display. The display response speed may become slow when the ambient temperature is low, which is due to the property of liquid crystal and not a malfunction. Display response speed will return to normal at room temperature.

- Although the display used on the product is made using high-precision technology, some pixels (dots) might be lit or out at all times. This is not a malfunction.
- Take care not to inconvenience people around you when you use the product in a public place.
- You are recommended to store copies of individual data such as photos you took, videos and music on your PC by sending each file as mail attachment, etc. Note, however, that you may not be able to make copies of any copyrighted data even by the above-mentioned means.
- Take care not to place magnetized items such as magnetic cards, speakers and TV sets near the product, as it might cause malfunction. Putting a strong magnetism close to the product might cause false operation.
- Although the earphone microphone terminal is waterproof, you may not be able to use it by inserting a plug when water remains. Swing the product to remove water so that water does not remain in the earphone microphone terminal, then dry it before using.
- When you put the product in your pocket or bag, take care so that the display does not come in contact with metal objects or other hard objects. Doing so might cause scratching or damage. Also, be careful not to scratch or damage the display by using a strap whose metal or other hard part comes in contact with the display.

- When suddenly brought into a warm place from a cold place, or when in a humid location, or when used where temperature suddenly changes (e.g. near the air discharge port of an air conditioner), water droplets (i.e. condensation) sometimes are formed inside the product. Note that when used under conditions such as this, the humidity might cause corrosion or a fault.
- When wiping the display, wipe with a soft, dry cloth. Use of a moistened cloth, glass cleaner or other similar liquid might cause a fault.
- When connecting/disconnecting the external device to/from the external connection terminal or the earphone microphone terminal, make sure that the connector or plug of external device is straight with the external connection terminal.
- Note that applying unnecessary force with the external connection terminal or the earphone microphone terminal connected to the external device might cause damage.
- Do not discard the product together with regular trash. Please cooperate in the collection of the product when it is no longer needed to protect the environment and effectively use resources. Old product is collected at au shops and other places.
- Insert only a microSD memory card into the memory card slot on the product.
- Do not exert excessive force when attaching/removing a microSD memory card. Doing so might injure your hands or fingers.

- While writing/reading data to/from a microSD memory card, do not subject the product to vibration or impact, or turn off the power. Doing so might cause loss of data or a fault.
- Take care not to cover the microphone with your fingers during a call. The other party may not be able to hear your voice clearly.
- When using handsfree call, note that the speaker may emit loud sound. Take care to keep the speaker at a safe distance from your ears.
- Do not cover the sensor with your finger or put a sticker on it. Doing so may hinder the sensor for detecting the ambient light level and functioning correctly.
- Do not put a sticker, etc. on the proximity sensor. Doing so may cause the sensor to malfunction and make the display always turned off while receiving a call or during a call.

#### ■ Touch panel

- Use your finger to operate the touch panel. Do not use ballpoint pens, pencils or other sharp-pointed objects. Using such objects does not only hinder correct operation of the touch panel, but also might cause scratching or damage to the display.
- Do not put stickers or sheets (e.g. commercially available protective films, peep prevention sheets) on the display. Doing so might hinder correct operation of the touch panel.
- Do not operate the touch panel with fingernails. Doing so might result in split nails or jammed fingers.

- If the display surface is dirty or wet with sweat or water, it may not function correctly. In such case, wipe the display surface with a dry, soft cloth.
- When carrying the product in your pocket or bag, take care not to put the touch panel close to metals or other conductive materials, as it might cause false operation of the touch panel.

### ■ Internal battery

- Use in very hot or cold environments, for example, when left in an automobile with the windows closed in summer, will cause the internal battery capacity to drop and shorten the available battery usage time. This will also shorten the internal battery's service life. Try to use the product as far as possible at room temperature.
- After the internal battery is charged, battery power decreases bit by bit even if the product is not used. The internal battery may be discharged if the product is not used for a long time. We recommend to charge the product before use.
- To avoid lowering the battery performance or decreasing battery life, do not store the product in the following conditions:
  - With fully charged (right after charging)
  - With the empty battery (too low to turn the product on)
  - In a hot and humid place
- Charge the battery before using the product for the first time after purchase, or if you have not used the product for a long time.

- The internal battery is a consumable item. If the performance of the internal battery does not recover, the battery is at the end of service life, so stop use. Since the battery is built into the product, we keep your product and replace the battery for a fee. You may not use the product for a certain period. What you should check The life time of the internal battery depends on the usage etc.

### ■ Charging equipment

- When the charging equipment is not to be used, unplug the power plug of the specified charger from the outlet or cigarette lighter socket.
- Do not wrap the power cord of specified charger around the adapter unit. Doing so might cause electric shock, fault, injure, overheating or fire.
- Do not forcibly bend the charging equipment's plug or the connection between the connector and power cord. Doing so might cause electric shock, fault, injure, overheating or fire.

### ■ au Nano IC Card 04

- The au Nano IC Card 04 is lent to you by au. In case of loss or damage, the card will be replaced at your expense. When a malfunction is suspected, or in case of theft or loss, contact an au shop or PiPi.
- Do not forcibly remove or insert the au Nano IC Card 04. Be careful not to exert excessive force when inserting the card into your au cell phone.



---

● You are responsible for any damage caused by inserting your au Nano IC Card 04 into some other IC card reader, etc.

---

● Keep the IC (metal) part of your au Nano IC Card 04 clean. Wipe the card with a dry, soft cloth (such as for cleaning eyeglasses) for cleaning.

---

● Do not put stickers, etc. on the au Nano IC Card 04.

### ■ Camera

---

● When using the camera, follow common rules of etiquette regarding camera use.

---

● Image data might be altered or lost due to malfunction, repair or mishandling of this product. The Company takes no responsibility for recovery of altered or lost data, damages resulting from altered or lost data, and lost profits.

---

● When photographing important occasions (such as a wedding), take a trial shot and check the shot image to make sure it is correctly shot.

---

● Do not use the camera for recording commercially available books or information of which photographing is not allowed.

---

● Do not leave the camera lens exposed to direct sunlight. Imaging elements might be discolored or burnt.

### ■ Music, videos and TV (1Seg)

---

● Do not listen to music or watch videos or TV (1Seg) while driving a car or motorbike, or riding a bicycle. Use of cell phones while driving a car or motorbike is prohibited by law. (Use of cell phones while riding a bicycle may also be punishable by law.) In addition, stay alert to the traffic around you even when walking. Surrounding sounds may not be heard clearly, and gazing at the screen might distract your attention causing a traffic accident. Be especially careful at railroad crossings, on a platform, and at pedestrian crossings.

---

● Take care not to listen at ear-splitting volume for a long time, as it might affect hearing.

---

● Be careful of sound leakage from earphones in trains or other places with many people around you.

## ■ Copyrights and rights of portrait

- You are not allowed to copy, distribute, publish, modify or edit the data you shot, recorded or downloaded using this product without the consent of the copyright holder, except for personal use, under the copyright law.  
In addition, do not use or modify portraits or names of other individuals without their consent, as it might infringe on rights of portrait.  
Note that shooting and recording may be restricted at some live performances, shows and exhibitions even for personal use.
- Be careful about the copyright and portrait right when posting photos you shot, etc. on Internet homepages.

## ■ Backup content on the product

- Please back up important content registered to the product or downloaded for the product from an outside source. Content recorded to memory on the product sometimes disappears or is altered by unexpected factors, such as static electricity or a fault, repair, mishandling, etc.  
\* How to make backups: Store important data such as contacts data, music, shot photos and videos on microSD memory cards. You can also send files as mail attachment or transfer to your PC. Note, however, that there are some data that cannot be copied by using these means.

## Available Security Codes

The product has various security codes that you can use. The available security codes are as follows. Do not forget the various security codes that are set as they are necessary for various operations and contracts.

### ● Security code

Example of usage	① To do remote operation of voice mail and call forwarding services from a landline phone
	② To use Customer Service Center and to do various inquiries, applications, and modifications on the au homepage
Initial value	A four digit number chosen by the customer and noted on the application form

### ● Security setting on the start screen

Example of usage	To set and disable security
Initial value	Slide

### ● PIN code

Example of usage	To prevent unauthorized use of the au Nano IC Card 04 by third parties
Initial value	1234

## PIN code

### PIN code

To prevent unauthorized use of the au Nano IC Card 04 by a third party, you can set the product to require PIN code entry every time the power is turned on. You also need to enter PIN code when setting whether the PIN code entry is required.

If the PIN code is incorrectly entered three times consecutively, the PIN code will be locked. You can unlock the PIN code using PUK code.

- PIN code is "1234" and PIN code entry was set to not be required at the time of purchase. You can change PIN code to any four- to eight-digit number, and set the PIN code entry to be required as necessary.

### PUK code

In case the PIN code is locked, you can unlock it by entering the PUK code.

- PUK code is an eight-digit number given at the time of purchase, which is printed on the back side of the plastic card on which your au Nano IC Card 04 is attached.
- After entering the PUK code, you need to set a new PIN code.

- If the PUK code is incorrectly entered ten times consecutively, contact an au shop, PiPit or Customer Service Center.
- PIN code is not reset by initializing the product.

**<Please copy this section and use>**

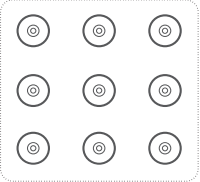
<b>[Password entry field]</b>	
Google account ID	Security (start screen) Lock: Lock No.
<input type="text" value="@gmail.com"/>	<input type="text"/>
Google account password	Security (start screen) Lock: Password
<input type="text"/>	<input type="text"/>
au ID account ID	Security (start screen) Lock: Pattern
<input type="text"/>	
au ID account password	
<input type="text"/>	
Facebook account ID	
<input type="text"/>	
Facebook account password	
<input type="text"/>	

## Notes on waterproof, dustproof and shock-resistant properties

This product has a waterproof property equivalent to IPX5<sup>1</sup> and IPX8<sup>2</sup>, as well as a dustproof property equivalent to IP5X<sup>3</sup> on the condition that the external connection terminal cover and the card slot cover are securely attached. This product has a shock-resistant property conforming to the MIL standard<sup>4</sup> (based on in-house testing).

Specifically, you can make calls holding the product with wet hands in the rain (less than 20 mm per hour) without an umbrella, as well as use the product in a place with water such as a bathroom or kitchen.

Before using the product, thoroughly read "Important items to remember before use" and "Tips for comfortable use" to ensure correct use. Failure to follow the contents described in these sections may cause the intrusion of water, sand or other foreign material, resulting in overheating, ignition, electric shock, injury or a fault.

- \*1 IPX5 equivalent means that the product will maintain its operability as a phone even if it is sprayed with water from a 6.3 mm diameter nozzle at a distance of about 3 meters for more than 3 minutes at a rate of about 12.5 liters per minute from any direction.
- \*2 IPX8 equivalent means that the product will maintain its operability as a phone with no water getting inside the main unit even if it is gently submerged in a tank of still tap water at room temperature to a depth of 1.5 meter for about 30 minutes.
- \*3 IP5X equivalent means that the product will securely maintain its operability as a phone even after it has been placed in an apparatus with grit and dust of diameters of 75  $\mu\text{m}$  or less and shaken for 8 hours.

- \*4 MIL standard conformity: Drop testing (in which the product is dropped in 26 directions from a height of 1.22 m) was conducted in accordance with MIL-STD-810G Method 516.6-Shock defined by the U.S. Department of Defense. Shock-resistant property of this product is based on the assumption that it is used in everyday life. Therefore, the product might break if it receives an excessive impact such as being thrown or dropped forcibly. Note also that the product gets scratches, etc. by falling impact even though its functionality of the main unit remains intact.

Since operation of the product on each usage scene was confirmed based on the above assumption, proper operation of the product in every possible condition during actual use is not guaranteed. Malfunctions determined to be caused by mishandling by the customer are not covered by the warranty.

### Important items to remember before use

- Make sure that the external connection terminal cover and the card slot cover are firmly closed.
  - Waterproofness is only effective when the covers are securely closed.
  - Just a small particle (a hair, a grain of sand, etc.) on the seals can cause water leak.

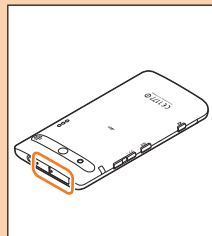

- Do not open/close the external connection terminal cover or the card slot cover if the product or your hands are wet. Do not insert an earphone (sold separately) when water remains in the earphone microphone terminal.

#### How to close the external connection terminal cover and the card slot cover

After stowing the cover hinge, press on the cover ① evenly with the flat part of your finger. Rub your finger over the cover in the direction of arrow ② to ensure that the cover is not partially open.

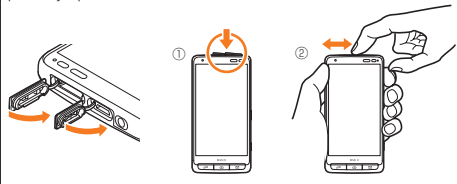

- Do not immerse the product in water with soap, detergent or bath salts in it.
- Do not immerse the product in seawater, a swimming pool or hot spring.
- Do not immerse the product in any liquid (alcohol, etc.) other than water.
- Do not place the product directly on the sand at a beach, etc. Sand or other small particles might get inside the microphone or speaker, causing the volume to drop. If sand gets inside the product, it might cause overheating or a fault.
- Do not use the product underwater.
- Do not leave the product in a humid place such as a bathroom or kitchen for an extended period of time.



Soap/detergent/  
bath salts



Seawater



Swimming pool



Hot spring



Sand/mud

## Tips for comfortable use

- Once the product gets wet, water may remain in gaps on the product. Shake the product well to drain water. Especially make sure to drain water remaining in the key parts, charging terminal and earphone microphone terminal.
- Even after the water is drained, the inner parts might be still wet. Although you can use the product, do not place it near things that must not get wet. Take care not to wet your clothes, bag or contents of the bag.
- Drain water if it becomes temporarily hard to hear the sound due to water remaining in the microphone.

## Notes on various usage scenes

### <In the rain>

You can make calls holding the product with wet hands in the rain without an umbrella.

- The rain in this case means a moderately-heavy rain (less than 20 mm per hour).
- Water drops on the display might cause errors in the touch panel operation.
- Never open/close the external connection terminal cover or card slot cover if the product is exposed to rain, or your hands are wet.

### <In the shower>

You can make calls holding the product with wet hands after a shower.

- Avoid spraying the product with high-pressure water, as the product is not designed to withstand high water pressure.

### <Washing>

You can wash the product under a mild flow (up to 6 liters per minute) of tap water at room temperature (5°C to 35°C) at a distance of about 10 cm from the faucet or showerhead.

- Do not spray the product with high-pressure water or submerge it in water for extended periods of time, as the product is not designed to withstand high water pressure.
- Make sure that holding the external connection terminal cover and the card slot cover so that they do not open, wash the product with your hands. Do not use a brush or sponge.
- Do not wash the product in a washing machine or ultrasound bath.
- Do not splash the product with or immerse it in soap water, detergent water, etc. other than tap water.

### <In the bath>

You can use the product in a bathroom.

- Although you can make calls with wet hands, do not immerse the product into a bathtub. The product is not resistant to hot temperatures.
- Do not use the product in a bathroom for an extended period of time. The product is not moistureproof.
- Do not immerse the product in hot spring water, soap water, detergent water, or water with bath salts in it. Also, do not use the product underwater. Doing so might cause a fault.

- Extreme changes in temperature cause condensation. Wait until the product reaches room temperature before you bring the product from a cold place into a warm bathroom.
- If condensation occurs inside the display, leave the product at room temperature for a while until the condensation is cleared.
- When viewing TV (1Seg), place the product on a stable surface.
- Do not splash the product with hot water. The product is not resistant to hot temperatures.
- Do not bring the Desktop Holder (KYV32PUA) into a bathroom.

#### <At a poolside>

- Do not immerse or drop the product in pool water. Also, do not use the product underwater.
- If the product gets splashed with pool water, immediately rinse it off with tap water in room temperature, because pool water contains chlorine for disinfection. To wash the product, do not use a brush, etc.

\*Mild flow (6 liters per minute or less)

#### <In a kitchen>

You can use the product in the kitchen and other places where water is used.

- Do not splash the product with or immerse it in soap water, detergent water, seasonings, juices, etc. other than tap water.
- Do not immerse the product in or splash it with boiling water. The product is not resistant to hot temperatures.
- Do not place the product where it gets extremely hot or cold such as near a stove or in a refrigerator.

- When viewing TV (1Seg), place the product on a stable surface.

## ■ Common precautions

### External connection terminal cover, card slot cover

Make sure that the external connection terminal cover and the card slot cover are firmly closed. Just a small particle (a hair, a grain of sand, etc.) on the seals can cause water leak.

Do not open/close the external connection terminal cover and the card slot cover with gloved hands. Just a small particle (a hair, a grain of sand, etc.) on the seals can cause water leak.

Wipe off any minuscule droplets of water or dirt with a clean dry cloth before closing the covers.

If the external connection terminal cover or the card slot cover is deteriorated or damaged, the waterproof property becomes ineffective. In such case, contact an au shop near you.

### If any liquid other than plain water gets on the product

If any liquid other than plain water (e.g. seawater, detergent, alcohol) gets on the product, immediately rinse it with plain water.

You can wash the product under a mild flow (up to 6 liters per minute) of tap water at room temperature (5°C to 35°C) at a distance of about 10 cm from the faucet or showerhead.

If the product gets dirty, wash it with your hands holding the external connection terminal cover or the card slot cover so that they do not open.

**After the product gets wet**

After the product gets wet, drain water, and wipe the main unit with a clean dry cloth.

In cold climates, water on the product may turn to frost. Using the product with frost may cause a fault. Do not leave the product without wiping off the water. (No special measures against condensation have been implemented in this product.)

**Rubber seals**

The rubber seal around the external connection terminal cover and the card slot cover is important to maintain waterproof property. Do not damage or remove the rubber seals.

When closing the external connection terminal cover or the card slot cover, take care not to get the rubber seals caught. Forcibly closing the cover with the rubber seals caught may damage them resulting in loss of waterproof property. Just a small particle (a hair, a grain of sand, etc.) on the seals can cause water leak.

If any liquid other than plain water (e.g. alcohol) gets on the rubber seals, it may cause deterioration in durability.

Do not insert sharp objects into gaps around the external connection terminal cover and the card slot cover. Doing so might damage or deform the product or damage the rubber seals, causing water leak.

It is recommended to replace the parts for maintaining waterproof property once every two years regardless of whether any abnormality is present. For information on part replacement, contact an au shop near you.

**Charging**

Never charge the battery if the product is wet.

The supplied and optional accessories are not waterproof.

**Waterproof property**

Do not use the product in places where it may be sprayed with high-pressure water (e.g. near a faucet or showerhead) or submerge it in water for extended periods of time, as the product is not designed to withstand high water pressure.

Also, do not expose the product to a water flow stronger than the specified flow rate (i.e. 6 liters per minute from a faucet or showerhead, at which you might even feel pain in the skin).

Doing so might cause a fault, even though the product has a waterproof property equivalent to IPX5. Do not wash the product in a washing machine or ultrasound bath.

The product does not float on water.

**Heat resistance**

Do not use the product in places where boiling water may splash on it, in saunas or near hot air (e.g. hairdryer). The product is not resistant to hot temperatures.



## ■ Draining water after wetting the product

As some parts of this product are not watertight, if you use the product after it gets wet, water remaining in those parts might wet your clothes or bag, or the sound might become hard to hear.

Follow the steps below to drain water.

### 1 Wipe water thoroughly on the surface of the product with a clean dry cloth without waste textiles

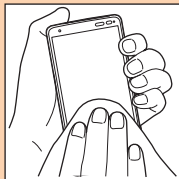

### 2 Shaking the product

- ① Hold the product firmly and shake it in the direction of arrows until water does not come out.
  - \* When shaking the product, stay alert to your surroundings.
  - \* Be careful not to have the product pop out, and hold it firmly to drain water.

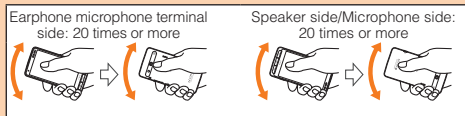

### ② Wipe drained water.

- \* The microphone, the speaker, the charging terminal and the earphone microphone terminal are particularly hard to drain water. Face those parts down and press to wipe off.

### ③ Place the product on a dry towel or cloth and leave it at room temperature.

### 3 Press the product gently to clean dry cloth without waste textiles, and wipe off water remained in the gaps in the microphone, speaker, external connection terminal, earphone microphone terminal, etc.

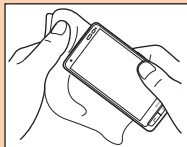

### 4 Leave the product for one hour or more at room temperature to dry after removing drained water thoroughly

Even after you take these procedures, water may remain on the product. Do not place the product near things that you do not want to wet.

Also, take care not to wet your clothes, bag, etc.

## ■ Precautions on charging

The supplied and optional accessories are not waterproof/dustproof. Be sure to check the following points before and after charging.

- Never charge the battery if the product is wet. Doing so might cause electric shock or short circuit resulting in a fire, burns or a fault.
- Check that the main unit is not wet. If you are charging the battery just after the product gets wet, drain water well and wipe the remaining water off with a clean dry cloth before placing it in the Desktop Holder (KYV32PUA) or opening the external connection terminal cover.
- If you charge the battery with the external connection terminal cover open, be sure to tightly close the cover when charging is finished. We recommend using the Desktop Holder (KYV32PUA) to charge the battery to prevent water from entering from the external connection terminal.
- Do not touch the specified charging equipment with wet hands. Doing so might cause electric shock.
- Do not splash water over the specified charging equipment. Do not use it near water, such as in a bathroom, shower room, kitchen or washroom. Doing so might cause fire, electric shock, injure or a fault. Do not bring it into a bathroom, etc. even when you are not charging with them. Doing so might cause fire, electric shock, injure or a fault.

## Notes on using Bluetooth® / Wireless LAN (Wi-Fi®) function

- The Bluetooth® function of the product conforms to domestic standards of Japan, FCC standards and EC directive, and has been certified.
- The Wireless LAN (Wi-Fi®) function of the product conforms to domestic standards of Japan, FCC standards and EC directive, and has been certified.
- The 2.4 GHz band used by Wireless LAN (Wi-Fi®) and Bluetooth® devices is operated by various other devices. For this reason, the communication speed and connectable range may be decreased, or disconnection may occur, due to interference from other devices.
- Do not use this product in places where electromagnetic waves are generated or near electric products, AV and OA equipment, or other magnetized devices.
- Subjecting this product to magnetic or electrical noise might increase noise and prevent it from performing communications. (This product is particularly susceptible to noise when it used near a microwave oven.)
- Using this product near a TV, radio or similar appliance might cause reception interference and disrupt TV images.
- The searching might not be successful if there are multiple Wireless LAN (Wi-Fi®) access points near to the product or the same channel is being used.

- Use of cell phones on board is restricted. Follow the instructions of each airline.
- The communication speed and connectable range vary depending on the distance between communication devices, obstacles and the devices used.

## Cautions on using 2.4 GHz band

The frequencies used by the Bluetooth® and/or Wireless LAN (Wi-Fi®) function of this product are in the 2.4 GHz band. In this frequency band, other similar wireless stations, in-plant wireless stations for mobile unit identification that require a license to use, such as factory production lines, specific small power wireless stations that do not require licenses, amateur wireless stations (collectively called "other wireless stations" from here on) are operated in addition to home electrical appliances such as microwave ovens, devices for industrial, scientific and medical devices.

1. Before using the product, make sure that "other wireless stations" are not in operation nearby.
2. In the event that instances of radio wave interference have occurred between the product and "other wireless stations", immediately either relocate the product or stop operation of the device (stop the emission of radio waves).
3. If you are unclear on any points or are troubled by anything, contact an au shop or Customer Service Center.

- The connections between this product and all other Bluetooth® and Wireless LAN (Wi-Fi®) devices have not been confirmed. Therefore, connections with all Bluetooth® and Wireless LAN (Wi-Fi®) devices are not guaranteed.
- This product supports security features for wireless communications that are compliant with the Bluetooth® and Wireless LAN (Wi-Fi®) standard specifications, but the security may not be sufficient depending on the usage environment and configuration. Be careful when making data communication using Bluetooth® or Wireless LAN function (Wi-Fi®).
- Wireless LAN (Wi-Fi®) has the advantage that it can be freely connected anywhere within the radio wave range, as it uses radio waves for exchanging information. At the same time, there is a risk that a malicious third party may obtain unauthorized access if security settings have not been configured. You are recommended to configure security settings before use at your decision and responsibility.
- The Company assumes no responsibility for leakage of data or information that may occur during Bluetooth®/ Wireless LAN (Wi-Fi®) communication.

- Since Bluetooth® and Wireless LAN (Wi-Fi®) functions use the same frequency band, using the both functions at the same may cause radio wave interference resulting in decreased communication speed or disconnection from the network. If connection fails, stop using either of the Bluetooth® and Wireless LAN (Wi-Fi®) functions.

Bluetooth® and Wireless LAN (Wi-Fi®) functions of this product use frequencies in the 2.4 GHz band.

2.4FH1/XX1



- **Bluetooth® function: 2.4FH1/XX1**

This product uses the 2.4 GHz band. FH-SS is used as the modulation scheme. The interference distance is about 10 m or less.

Bands of mobile unit identification devices cannot be avoided.

2.4DS4/OF4



- **Wireless LAN (Wi-Fi®) function: 2.4DS4/OF4**

This product uses the 2.4 GHz band. DS-SS and OFDM are used as the modulation schemes. The interference distance is about 40 m or less.

This means that all bandwidths are used, and that band of mobile unit identification devices can be avoided. Available channels vary depending on countries. For use in an airplane, check with the airline company in advance.

## Cautions on using 5 GHz band

Wireless LAN (Wi-Fi®) function of this product uses 5 GHz band. Using the 5.2 GHz band and 5.3 GHz band outdoors is prohibited by the Radio Law.

The channels used on the product are as follows.

W52 (5.2 GHz band/36, 38, 40, 42, 44, 46, 48 ch)

W53 (5.3 GHz band/52, 54, 56, 58, 60, 62, 64 ch)

W56 (5.6 GHz band/100, 102, 104, 106, 108, 110, 112, 116, 118, 120, 122, 124, 126, 128, 132, 134, 136, 140 ch)

**IEEE802.11b/g/n**

**IEEE802.11a/n/ac**

**W52 | W53 | W56**

## Notes on packet communication charge

- Since a constant Internet connection is possible with this product, packet communication may be performed automatically by some apps, resulting in high packet communication charges. Therefore, subscription to a packet flat-rate service/packet communication charge discount service is recommended.
- To browse homepages, download apps, communicate using apps, send/receive e-mails and configure various settings, connection to the Internet is required, to which packet communication charge applies.

\* Packet communication charge does not apply to Wireless LAN (Wi-Fi®) connection.

## Notes on applications

- Be sure to check the security of the app, then install it at your own risk. Some apps might cause virus infection, damage various data, and send out your location information, usage history or personal information stored in your cell phone via the Internet.
- The Company assumes no responsibility for any failures that might be caused by apps you have installed. Repair costs in this case may be charged even during the warranty period.
- The Company assumes no responsibility for any disadvantage brought to you or any third party by the apps you have installed.
- Insertion of a microSD memory card is necessary to use some apps.
- Some apps prohibit the product from entering sleep mode while they are active, or rapidly drain the battery while running in the background.
- Operational procedures and screen appearances of the apps preinstalled in this product and those installed by you are subject to change without notice as a result of version upgrade. In addition, operating procedures described in this manual may differ from the actual procedures.

## Appendix

### Introduction of related accessories

- Desktop Holder (KYV32PUA)
- Common AC Adapter 05 (0501PWA) (sold separately)
- Common AC Adapter 03 (0301PQA) (sold separately)
- Common AC Adapter 03 Navy (0301PBA) (sold separately)
- Common AC Adapter 03 Green (0301PGA) (sold separately)
- Common AD Adapter 03 Pink (0301PPA) (sold separately)
- Common AC Adapter 03 Blue (0301PLA) (sold separately)
- AC Adapter JUPITRIS (White) (L02P001W) (sold separately)
- AC Adapter JUPITRIS (Red) (L02P001R) (sold separately)
- AC Adapter JUPITRIS (Blue) (L02P001L) (sold separately)
- AC Adapter JUPITRIS (Pink) (L02P001P) (sold separately)
- AC Adapter JUPITRIS (Champagne) (L02P001N) (sold separately)

- Common DC Adapter 03 (0301PEA) (sold separately)

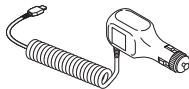

- au Carrying Case F Black (0105FCA) (sold separately)
- au Carrying Case G Black (0106FCA) (sold separately)

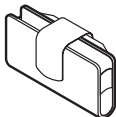

- au Carrying Case H Black (0107FCA) (sold separately)
- Portable charger 02 (0301PFA) (sold separately)
- microUSB cable 01 (0301HVA) (sold separately)
- microUSB cable 01 Navy (0301HBA) (sold separately)
- microUSB cable 01 Green (0301HGA) (sold separately)
- microUSB cable 01 Pink (0301HPA) (sold separately)
- microUSB cable 01 Blue (0301HLA) (sold separately)

 **memo**

- For the latest information on accessories, visit the au homepage (<http://www.au.kddi.com/english>) or contact the Customer Service Center.
- Accessories on this page can be purchased from au online shop. Some accessories may not be purchased due to the availability. <http://auonlineshop.kddi.com/>
- Charging may not be performed sufficiently with Portable charger 02 (sold separately).

## Using earphones

Connect an earphone (sold separately) earphone microphone (sold separately), stereo earphone with microphone (sold separately) to use.



### 1 Connect an earphone (sold separately) to the earphone microphone terminal of the product

 **memo**

- Earphone microphone (sold separately) may not be available depending on the type.

## Troubleshooting

Before you assume that the product is malfunctioning, check the following:

Symptom	What you should check	Page
Cannot turn on power	Is the internal battery charged?	P.14
	Is  pressed and held?	P.18
	Is the charging lump blinking yellow?	P.18
Cannot charge the internal battery	Is the charger connected correctly?	P.16
	Is the temperature of the product or internal battery high or low? Charging may stop due to the temperature of the product or internal battery.	P.15
	Are the specified accessories (adapter, etc.) used to charge?	P.16
Cannot operate/ The screen freezes/Cannot turn off power	Press and hold  for 11 seconds or longer to force shutdown and restart.	P.18
The power goes off	Is the internal battery fully charged?	P.14
The power is going off while the activation logo is displaying	Is the internal battery fully charged?	P.14

Symptom	What you should check	Page
Cannot make calls	Is the power turned on?	P.18
	Is your au Nano IC Card 04 inserted?	P.11
	Is the phone number correct? (Do you enter the number from a city code?)	P.26
	Do you tap "Call" after a phone number is entered?	P.26
Cannot receive calls	Is signal strong enough?	P.24
	Is the product out of the service area?	P.24
	Is the power turned on?	P.18
	Is your au Nano IC Card 04 inserted?	P.10
"No signal" (out of service area) appears	Is the product out of the service area or in an area where the signal is weak?	P.24
	Is the built-in antenna covered with finger etc.?	P.9
	Is an IC card other than au Nano IC Card 04 inserted?	P.10
Cannot operate key/touch panel	Is the power turned on?	P.18
	Turn off the power and then turn it on again.	P.18
"No service" appears	Is your au Nano IC Card 04 inserted?	P.11
A message such as charge the battery appears	The battery is almost dead.	P.14

Symptom	What you should check	Page
Battery usage time is short	Is the product fully charged? • Charge the product until the red charging light goes off.	P.14
	Is the internal battery end-of-life?	P.39
	Is the product left in the place for a long period where "No signal" (out of service area) appears?	P.24
	End/Stop the apps or functions which are not used.	—
	Cannot connect to the party and the phone beeps even though a call is made	Is the product out of the service area or in an area where the signal is weak? The line is extremely busy or the party is calling. Retry later.
The display is dark	Is the temperature of the product or battery pack high? The display may become dark depending on the temperature of the product.	—
Cannot hear/Hard to hear the other party	Place your ear hole to the receiver.	P.8 P.9
Cannot use a microphone of earphone microphone	Is the connector inserted correctly? Insert it to the earphone microphone terminal all the way.	P.61
Settings made for specified contacts do not work	Is the caller ID notified? If the caller does not notify the caller ID, ringtone setting in Contacts is not effective. Group ringtone settings in Contacts is not effective, either.	—



Symptom	What you should check	Page
Memory card is not recognized	Is the microSD memory card attached properly?	P.13

If you cannot find the solution to your problem in the above items, refer to the au homepage or au Customer Support on the website shown below.

<http://www.au.kddi.com/english/support/>

## Updating Software or OS

You can update the product to the most recent software for optimal performance and to get the latest enhancements. There are several methods to update software.

- Downloading software into the product to update
- Downloading software via Wi-Fi® into the product to update

### Notes

- You are charged for data communication when connecting to the Internet from the product using packet communication.
- When software update is necessary, you will be informed on au homepage, etc. For details, contact an au shop or Customer Service Center (call toll-free 157). In addition, users of the product will receive a notice from au, when software update is necessary to improve the functionality of the product.

- You are recommended to back up your data before updating software.
- Fully charge before update. If the update is started with the battery power low or battery power becomes low during update, software update cannot be done.
- Check the radio wave condition. Software update may fail in poor reception area.
- Any operations are not available during software update. Calling 110 (Police), 119 (Fire/Ambulance), 118 (Maritime rescue) is not available. Alarm does not work, either.
- If software update has failed or stopped, perform the same procedure again.
- Update is unavailable during international roaming.
- If you fail to update software, it may become impossible to operate the product. If this happens, bring it to an au shop or PiPit (not accepted by some shops).

## Downloading and updating software or OS

Update files can be downloaded from the Internet web site into the product directly.

Selecting "Start major update" downloads the OS for the product.

- 1 Home screen → [Settings] → [Other settings] → [About phone] → [Software update]

## 2 [Start updating software]/[Start major update]

From here on, follow the onscreen instructions.

### memo

- Note that charges may be applied depending on your service subscription since the product automatically searches available network.
- After updating software/major update, older version cannot be reverted back.

## After-sales service

### When asking for repair

For repair, contact Keitai Guarantee Service Center.

During the warranty period	Repairs will be done based on the terms of services of the free-of-charge repair warranty described on the warranty card.
Outside the warranty period	We shall repair the product for a charge as requested by the customer if repair renders it usable.

### memo

- Before handing in the product for repair, make a backup of the contents of memory since they may disappear during repair. Note that the Company shall not be liable for any damages and loss of income should the contents of memory be altered or lost.
- Recycled parts that meet the Company's quality standards are sometimes used for repair.
- Collected au cell phones by Replacement cell phone delivery service which you used before are recycled to cell phones for replacement after repairs. Also replaced parts by au after-sales service are collected and recycled by KDDI. They are not returned to customers.

## ■ Performance parts for repair

The Company retains performance parts for repair of the product main unit and its peripherals for four years after discontinuation of production. "Performance parts for repair" refers to parts required for maintaining the functions of the product.

## ■ Warranty card

At the store of purchase, thoroughly check and read the name of the retailer, date of purchase and other necessary details filled in on the warranty card, and be sure to keep it in a safe place.

## ■ Keitai Guarantee Service Plus LTE

An after-sales service membership program on a monthly basis called "Keitai Guarantee Service Plus LTE" (monthly fee: 380 yen, tax excluded) is available for using your au cell phone for a long time without worries. This service expands coverage for many troubles including malfunction, theft and loss. For details of this service, refer to au homepage or contact Keitai Guarantee Service Center.



## memo

- ◎ You can apply for membership only at the time of purchasing your au cell phone.
- ◎ Once you cancel the membership, you cannot reapply for it until you purchase an au cell phone next time.
- ◎ Note that when changing the model or purchasing an extra cell phone, this service only covers the most recently purchased au cell phone.
- ◎ When an au cell phone is handed over to you or someone else, the "Keitai Guarantee Service Plus LTE" membership is also handed over to the successor of the cell phone.
- ◎ When you get a new au cell phone by changing the model or purchasing an extra cell phone, the "Keitai Guarantee Service Plus"/"Keitai Guarantee Service Plus LTE" membership for the old au cell phone is automatically canceled.
- ◎ Service contents are subject to change without notice.

## ■ au Nano IC Card 04

The au Nano IC Card 04 is lent to you by au. In case of loss or damage, the card will be replaced at your expense. When a malfunction is suspected, or in case of theft or loss, contact an au shop or PiPit.

## ■ After-sales service

If you are unsure about anything regarding after-sales service, contact the following service contact.

### Customer Service Center (for service canceling procedure in case of loss or theft)

From a land-line phone, ☎️ **0077-7-113** (toll free)

From an au cell phone, **113** without area code (toll free)

Business hours 24-hour (7 days a week)

### Keitai Guarantee Service Center (for loss, theft, damage)

From a land-line phone/an au cell phone,

☎️ **0120-925-919** (toll free)

Business hours 9:00 - 21:00 (7 days a week)

### Online Repair Desk (24 hours a day over the Internet)

[https://cs.kddi.com/support/n\\_login.html](https://cs.kddi.com/support/n_login.html)



- The Application for the Internet acceptance, if "damage", "wet", "theft" and "loss" are eligible. In the case of spontaneous failure (not the cause damage, such as water wet, but does not power on, the screen does not function or other), it will be accepted by phone for interview is required.
- To apply for the Internet, you need the e-mail address.

## au after-sales service information

Service			Keitai Guarantee Service Plus LTE	
			Members	Others
Replacement cell phone delivery service	Spontaneous failure	1st year	Free of charge	No recompense
		2nd year or later	Customer charge 1st: 5,000 yen 2nd: 8,000 yen	
	Partially damage, water soak, irreparable damage, theft or loss			
Holding over and repair	Spontaneous failure	1st year	Free of charge	Free of charge
		2nd year or later	Free of charge (three-year warranty)	
	Partially damage		Customer charge Upper limit: 5,000 yen	Actual cost
	Water soak, irreparable damage		Customer charge 10,000 yen	
Theft, loss		No recompense	No recompense (model change)	

\* Charge amounts are all tax excluded.

### Replacement cell phone delivery service

- When you have trouble with your au cell phone, replacement cell phone (same model, same color) is delivered by calling to. Return your damaged cell phone within 14 days after the replacement cell phone is delivered.
  - Available up to twice in a year from the day you use this service as a start day. If you do not use this service in the past year for the subscription to this service, it will be 1st and if you use, it will be the 2nd.
- \* For details, refer to au homepage.

### Holding over and repair

- Damages and malfunctions intentionally caused by the customer as well as those due to modification (e.g. disassembly, change of parts, painting, etc.) by the customer are not covered by this service.
- You cannot receive a refund for replacement of the outer casing due to stains, scratches, paint removal, etc. on the outer casing.

## Main specifications

Display	Approx. 5.0 inches, Approx. 16,770,000 colors, Transparent TFT	
	1920×1080 dots (FHD)	
Weight	Approx. 152 g	
Charging times (estimate)	Common AC Adapter 05 (sold separately)	Approx. 140 minutes
	Common DC Adapter 03 (sold separately)	Approx. 390 minutes
Continuous call time	In Japan	Approx. 1,530 minutes
	Overseas (GSM/UMTS/LTE)	Approx. 910 minutes
Continuous stand-by time	In Japan	Approx. 750 hours
	Overseas (GSM/UMTS/LTE)	Approx. 840 hours
Continuous tethering time	Approx. 880 minutes	
Maximum number of Wi-Fi tethering connection devices	10	

Dimensions (W x H x D)	Approx. 70mm × 142mm × 10.4mm	
Internal memory <sup>*1</sup>	ROM: Approx. 16GB	RAM: Approx. 2GB
Number of effective pixels: Out-camera	Approx. 13,000,000 pixels, CMOS	
Number of effective pixels: In-camera	Approx. 970,000 pixels, CMOS	
Wireless LAN (Wi-Fi <sup>®</sup> ) function	IEEE802.11a/b/g/n/ac compatible	

Bluetooth <sup>®</sup> function	Compatible version	Bluetooth <sup>®</sup> standard Ver.4.0 compatible <sup>*2</sup>
	Output	Bluetooth <sup>®</sup> standard Class 1
	Communication range <sup>*3</sup>	Within 10 m with no obstacles in the range
	Supported Bluetooth profile <sup>*4</sup>	SPP (Serial Port Profile) A2DP (Advanced Audio Distribution Profile) AVRCP (Audio/Video Remote Control Profile) HSP (Headset Profile) HFP (Hands-Free Profile) OPP (Object Push Profile) PBAP (Phone Book Access Profile) HID (Human Interface Device Profile) PAN (Personal Area Networking Profile) PAN-NAP (Personal Area Networking-Network Access Point) PAN USER (Personal Area Networking-User) HOGP (HID over GATT Profile) MAP (Message Access Profile) SCMS-T (Serial Copy Management System-T) DUN (Dial-Up Networking Profile) <sup>*5</sup>
	Frequency bands	2.4 GHz band

Continuous 1Seg watching time	Approx. 10 hours
--	------------------

- \*1 Since the storage is shared by data and applications, storage space may be reduced depending on the usage of applications.
- \*2 It is confirmed that the product and all Bluetooth® devices are compliant with Bluetooth® standards designated by Bluetooth SIG, and they are authenticated. However, procedures may differ or data transfer may not be possible depending on the device's characteristics or specifications.
- \*3 Changes according to objects obstructing devices and signal reception.
- \*4 Specifications provided in Bluetooth® standards for making communication between Bluetooth®-compatible devices in accordance with their intended use.
- \*5 The profile supports part of car navigation systems. Refer to the au homepage for use.



### memo

- ◎ The continuous talk time and continuous standby time may drop to less than half depending on the battery charging status, usage environment such as temperature, reception condition at the location where the product is used, and the function settings.

## Specific Absorption Rate of Mobile Phone

This model BASIO mobile phone complies with Japanese technical regulations and international guidelines regarding exposure to radio waves. This mobile phone has been

designed in observance of the Japanese technical regulations regarding exposure to radio waves\* and limits to exposure to radio waves recommended by equivalent international guidelines.

These international guidelines were set out by the International Commission on Non-Ionizing Radiation Protection (ICNIRP), which is in collaboration with the World Health Organization (WHO), and the permissible limits include a substantial safety margin designed to assure the safety of all persons, regardless of age and health condition. The Japanese technical regulations and international guidelines define the limits using a unit of measurement known as the Specific Absorption Rate (SAR), which represents the average amount of radio frequency energy absorbed by the human. The SAR limit for mobile phones is 2.0 W/kg. The highest SAR value for this mobile phone when tested for use at the ear is 0.770 W/kg. The highest SAR value for this mobile phone when tested for use on the body is 0.674 W/kg. The actual SAR of this mobile phone while talking on the phone can be well below that indicated above. This is due to automatic changes in the power level of the mobile phone to ensure it only outputs the minimum power required to communicate with a base station. Therefore in general, the closer you are to a base station, the lower the power output of the mobile phone.

This mobile phone can be used in positions other than against your ear.

Use an accessory such as a carrying case, etc. so that you can hold the product at least 1.5 cm away from your body and also do not contain metal parts between the product and your body. By doing this, this mobile phone complies with Japanese technical regulations and international guidelines regarding exposure to radio waves. The World Health Organization has stated that present scientific information does not indicate the use of mobile devices has any harmful effects on the human body. They recommend that if you are still worried about your exposure then you can limit your talk time or use a handsfree kit to keep the mobile phone away from your head and body. If you would like to know more detailed information, please refer to the WHO website.

[http://www.who.int/docstore/peh-emf/publications/facts\\_press/fact\\_english.htm](http://www.who.int/docstore/peh-emf/publications/facts_press/fact_english.htm)

Please refer to the websites listed below if you would like to know more detailed information regarding SAR.

- Ministry of Internal Affairs and Communications website  
<http://www.tele.soumu.go.jp/e/sys/ele/index.htm>
- Association of Radio Industries and Businesses website  
<http://www.arib-emf.org/index02.html> (in Japanese only)
- au homepage:  
<http://www.au.kddi.com/english>

\* Technical regulations are defined by the Ministerial Ordinance Related to Radio Law (Article 14-2 of Radio Equipment Regulations).

For the following content, refer to the "取扱説明書詳細版 (Full Instruction Manual)" (Japanese) available on the au homepage or "Instruction Manual" app installed on the product.

- \* OpenSSL License
- \* FCC Notice
- \* European RF Exposure Information
- \* Declaration of Conformity

From your PC:

<http://www.au.kddi.com/support/mobile/guide/manual/>

## Intellectual property rights

### Trademarks

Company names and product names referred to in this manual are trademarks or registered trademarks of respective companies.





Google and Google logo, Android and Android logo, Google Play and Google Play logo, Play Music, Play Music logo, Play Movies, Play Movies logo, Gmail and Gmail logo, Google Maps and Google Maps logo, Hangouts and Hangouts logo, Google Maps Navigation and Google Maps Navigation logo, Google Chrome, Google Chrome logo, Google Voice Search and Google Voice Search logo, and YouTube and YouTube logo are trademarks or registered trademarks of Google, Inc.

Microsoft<sup>®</sup>, Windows<sup>®</sup> and Windows Vista<sup>®</sup>/Windows<sup>®</sup>7/Windows<sup>®</sup>8 are registered trademarks of Microsoft Corporation in the U.S.A. and other countries. The official name for Microsoft<sup>®</sup> Windows<sup>®</sup> is Microsoft<sup>®</sup> Windows<sup>®</sup> Operating System.

Microsoft<sup>®</sup>, Microsoft<sup>®</sup> Excel<sup>®</sup>, Microsoft<sup>®</sup> PowerPoint<sup>®</sup>, Windows Media<sup>®</sup>, and Exchange<sup>®</sup> are trademarks or registered trademarks of Microsoft Corporation in the United States and other countries.

Microsoft<sup>®</sup> Word and Microsoft<sup>®</sup> Office are product name of Microsoft Corporation in the United States.

QR code is a trademark of DENSO WAVE INCORPORATED.

Rovi, G-GUIDE, G-GUIDE MOBILE and G-Guide related logos are trademarks or registered trademarks of Rovi Corporation and/or its subsidiaries in Japan.

microSD, microSDHC and microSDXC logos are trademarks of SD-3C, LLC.

Bluetooth<sup>®</sup> and logo are registered trademarks owned by the Bluetooth SIG, Inc., and KYOCERA Corporation is licensed to use those trademarks.

WiMAX is a trademark of WiMAX Forum.

Wi-Fi<sup>®</sup>, WPA<sup>®</sup>, Wi-Fi CERTIFIED logo and Wi-Fi Protected Setup logo are registered trademarks of Wi-Fi Alliance. Wi-Fi CERTIFIED<sup>™</sup> and Wi-Fi Protected Setup are trademarks of Wi-Fi Alliance.

Facebook and Facebook logo are trademarks or registered trademarks of Facebook, Inc.

Twitter and Twitter logo are trademarks of Twitter, Inc., and are used under license.

GREE and the GREE logo are registered trademarks of GREE, Inc. in Japan. All other trademarks are the property of their respective owners.

The product is equipped with "airCube for Android", 1Seg total solution, developed by System Engineering Consultants Co., LTD. "airCube" is a registered trademark of System Engineering Consultants Co., LTD.

iWnn of OMRON SOFTWARE Co., Ltd. is used for conversion methods for Japanese language, and for phrase prediction methods for English.

iWnn IME@OMRON SOFTWARE Co., Ltd. 2009-2012 All Rights Reserved.

©2014 Comic Communication Co., Ltd. All rights reserved.

THIS PRODUCT IS LICENSED UNDER THE MPEG-4 VISUAL PATENT PORTFOLIO LICENSE FOR THE PERSONAL AND NON-COMMERCIAL USE OF A CONSUMER FOR (i) ENCODING VIDEO IN COMPLIANCE WITH THE MPEG-4 VISUAL STANDARD ("MPEG-4 VIDEO") AND/OR (ii) DECODING MPEG-4 VIDEO THAT WAS ENCODED BY A CONSUMER ENGAGED IN A PERSONAL AND NONCOMMERCIAL ACTIVITY AND/OR WAS OBTAINED FROM A VIDEO PROVIDER LICENSED BY MPEG LA TO PROVIDE MPEG-4 VIDEO. NO LICENSE IS GRANTED OR SHALL BE IMPLIED FOR ANY OTHER USE. ADDITIONAL INFORMATION INCLUDING THAT RELATING TO PROMOTIONAL, INTERNAL AND COMMERCIAL USES AND LICENSING MAY BE OBTAINED FROM MPEG LA, LLC. SEE [HTTP://WWW.MPEGLA.COM](http://www.mpegla.com).

- (1) ACCESS, the ACCESS logo, and NetFront are registered trademarks or trademarks of ACCESS CO., LTD. in the United States, Japan and/or other countries.
- (2) This software is based in part on the work of the Independent JPEG Group.

"インテリジェントWi-Fi" and "SMART SONIC RECEIVER" are registered trademarks of KYOCERA Corporation.

"もじチェン" by LIM Corporation LTD. is used for switching font. "もじチェン" is a registered trademark of LIM Corporation LTD. The product contains fonts provided by LIM Corporation LTD. The product contains fonts provided by Morisawa Inc.

The product includes pictograms licensed by NTT DOCOMO, INC.

The product is equipped with DeepCore® 3.0 Plus for Android by E-Globaledge Corporation as infrared communication function. Copyright© 2012 E-Globaledge Corp. All Rights Reserved.

"PhotoSolid", the function to avoid blurring still images, is a product of Morpho, Inc. "PhotoSolid" is a registered trade mark of Morpho, Inc.

"MovieSolid", the function to avoid blurring videos, is a product of Morpho, Inc. "MovieSolid" is a registered trade mark of Morpho, Inc.

"PhotoScouter" is a registered trade mark of Morpho, Inc.

All other company names and product names are trademarks or registered trademarks of respective companies referred to in this manual.

Users of the product are authorized to use software installed into the mobile phone described in this instruction manual. Pay attention to the following points when using the software.

- (a) The software installed on this product or part of it may not be altered, delivered, modified, analyzed, reverse-engineered, derived, and any such actions are prohibited.
- (b) Illegally importing the software or a part of it is prohibited.
- (c) This Software is provided without implied warranties of merchantability, fitness for a particular purpose and noninfringement of third party rights.

Note that the existing license agreement takes priority for usage of GNU General Public License (GPL), GNU Library/Lesser General Public License (LGPL) included in software, software based on other open source software license and software that KYOCERA Corporation is licensed.

For information on the Open source software, refer to "Open source software" as follows;

## ■ About Open Source Software

This product includes software originating from third parties that is subject to the GNU General Public License (GPL), GNU Library/Lesser General Public License (LGPL) and different and additional copyright licenses, disclaimers and notices. The exact terms of GPL, LGPL and some other licenses, disclaimers and notices are reproduced in "About phone" in this product. For details, refer to Kyocera homepage. This product includes software copyrighted by KYOCERA Corporation and licensed software.

Copyright of the software designed and developed complying with the open source software standard belongs to KYOCERA Corporation or the third parties, distribution, reproduction, transformation and transmission over public lines without consent of KYOCERA Corporation are prohibited, unless you are authorized or permitted by Copyright Law.

## ■ Export Administration Regulations

This product and its accessories may be subject to the Japan Export Administration Regulations ("Foreign Exchange and Foreign Trade Law" and its related laws).

In addition, U.S. Re-export Regulations (Export Administration Regulations and the related laws and regulations), regulations in other countries may apply to this product and its accessories. To export and re-export this product and its accessories, directly or indirectly, take the required measures on your responsibility and at your expenses. For details on the procedures, contact the Ministry of Economy, Trade and Industry, the U.S. Department of Commerce, or authority concerned.

## ■ Regarding Windows notations

The names of operating systems (Japanese versions) used in this manual are as follows.

- Windows 8 is the abbreviation for Microsoft® Windows® 8, Microsoft® Windows® 8 Pro, Microsoft® Windows® 8 Enterprise.
- Windows 7 is the abbreviation for Microsoft® Windows® 7 (Starter, Home Basic, Home Premium, Professional, Enterprise, Ultimate).
- Windows Vista is the abbreviation for Microsoft® Windows Vista® (Home Basic, Home Premium, Business, Enterprise, Ultimate).

For inquiries, call: Customer Service Center

For general, charge, operations (toll free)

Business hours 9:00~20:00 (7 days a week)

From fixed-line phones:

 0077-7-111

From au cell phones:

157 area code not required

PRESSING ZERO WILL CONNECT YOU TO AN OPERATOR  
AFTER CALLING 157 ON YOUR au CELL PHONE

For service canceling procedure in case of loss or theft  
(toll free)

Business hours 24-hour (7 days a week)

From fixed-line phones:

 0077-7-113

From au cell phones:

113 area code not required

In case above numbers are not available,

 0120-977-033 (except Okinawa)

 0120-977-699 (Okinawa)

Keitai Guarantee Service Center

For loss, theft or damage (toll free)

From fixed-line phones/au cell phones,

 0120-925-919

Business hours 9:00 - 21:00 (7 days a week)



やめましょう、  
歩きスマホ。



モバイル・リサイクル・ネットワーク  
携帯電話・PHSのリサイクルにご協力。

Cell phone and PHS operators collect and recycle unused telephones, batteries and battery chargers at stores bearing the  logo regardless of brand and manufacturer to protect the environment and reuse valuable resources.

January 2015, 1st Edition

Sales: KDDI CORPORATION・OKINAWA CELLULAR TELEPHONE COMPANY  
Manufactured by: KYOCERA Corporation