



Basic Manual

TORQUE[®] G04

Safety Precautions

Getting Ready

Basic Operations

Telephone

Appendix

This manual is based on the contents of Android™ 9 Pie.
For the latest version of the manual, refer to the "Online Manual" (Japanese) or
"取扱説明書 詳細版 (Full Instruction Manual)" (Japanese) on the au website.
<https://www.au.com/support/service/mobile/guide/manual/>

Preface

Thank you for purchasing the "TORQUE GO4" (simply called the "product" or "main unit" from here on).

Before using the product, be sure to read "Basic Manual" (this manual) to ensure correct use. After you have finished reading this manual, store it in a safe place so you can retrieve it whenever you need it.

List of Packaged Items

Before you start using the product, make sure that you have all the following packaged items with the product.

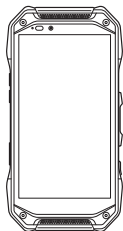

Main unit

* Sheet pasted on front screen



Back cover (KYV46TLA, KYV46TRA, KYV46TKA)

* Installed on back of main unit

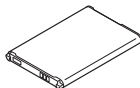

Battery pack (KYV46UAA)



LOCK Rotating Tool (Sample)



Hexagon Wrench (Sample)

- 取扱説明書 (Basic Manual) (Japanese)
- 設定ガイド* (Setting Guide) (Japanese)

The following items are not included in the package.

- | | |
|------------------------|--------------------------------------|
| ・AC adapter | ・KYOCERA 3.5ΦType-C conversion cable |
| ・USB Type-C cable | (O401QNA) |
| ・Wireless Charging Pad | ・microSD memory card |
| | ・Earphone |



memo

- Purchase a specified charger (sold separately).
- Illustrations of cell phones in this manual are only for reference. They may look different from the actual product.

Operating Instructions

■ "Setting Guide" and "Basic Manual" (This manual)

Handles only basic operations for main features.

■ "Online Manual" (Japanese)

For detailed descriptions of various functions, refer to the "Online Manual" (Japanese) available on au homepage:

Home screen → [☰] → [サポート (Support)] → [取扱説明書 (Online Manual)]



For detailed descriptions of various functions, refer to the "Online Manual" (Japanese) available on the au homepage:

<https://www.au.com/online-manual/kyv46/>

■ "取扱説明書 詳細版 (Full Instruction Manual)" (Japanese)

For detailed descriptions of various functions, refer to the "取扱説明書 詳細版 (Full Instruction Manual)" (Japanese) available on the au homepage:

<https://www.au.com/support/service/mobile/guide/manual/>



■ TORQUE Special Site

<https://www.kyocera.co.jp/prdct/telecom/torque/> (Japanese)

■ TORQUE Product Information

<https://www.kyocera.co.jp/prdct/telecom/consumer/lineup/g04/> (Japanese)

Illustrations and Descriptions in This Manual

■ Note on Button Illustrations

In this manual, the button illustrations are simplified as shown below.



■ Description of Operations for Selecting Item/Icon/Button, etc.

Notations used for operation procedures in this manual are as follows.

Description	Explanation
Home screen → [📞] → "DIALPAD" tab → [1] [4] [1] → [📞]	Tap "📞" at the bottom of the home screen. And after tapping "DIALPAD" tab, tap "1", "4", and "1", then tap "📞" at the end
Home screen → [⚙️] → [Settings]	Tap "⚙️" at the bottom of the home screen. And tap "Settings" on the displayed apps list.
In sleep mode, [🔌] (Power button)	In sleep mode, press [🔌] (Power button).

- Tapping is to select a button or icon displayed on the display by lightly tapping it with your finger.

■ Notes on Illustrations/Screenshots

In this manual, screenshots and operations for the product with au Nano IC Card O4 attached are described.

The illustrations and screenshots in this manual may look different from the actual product or screens. In some cases, minor details or a part of a screen may be omitted.

Some icons etc. are omitted in this manual.

Actual screen



Example in this manual



- ◎ In this manual, screenshots for body color "Blue" are provided as examples.
- ◎ In this manual, the operations with vertically oriented screens are provided as examples. With horizontally oriented screens, descriptions for menu item/icon/onscreen button may be different.
- ◎ In this manual, "au Nano IC Card 04" is abbreviated as "au IC card".
- ◎ In this manual, "microSD™ memory card (commercially available)", "microSDHC™ memory card (commercially available)" and "microSDXC™ memory card (commercially available)" are abbreviated as "microSD memory card" or "microSD".
- ◎ All of the indicated amounts exclude tax unless otherwise specified.
- ◎ Company names and product names referred to in this manual are trademarks or registered trademarks of the respective companies. TM or ® may be omitted in this manual.
- ◎ Menu items, layers and icons described in this manual may be different according to functions and conditions to use.

Contents

Preface.....	1
List of Packaged Items.....	1
Operating Instructions.....	2
Illustrations and Descriptions in This Manual....	3
Contents	6
Safety Precautions.....	7
When Using the Product.....	7
Safety Precautions (Observe Strictly).....	10
Material List.....	23
Handling Precautions	24
Notes on Water, Dust, Seawater, and Shock Resistance.....	33
Notes on Using Bluetooth®/Wireless LAN (Wi-Fi®) Function.....	44
Security Code/PIN Code.....	46
Notes on Data Communication Charges	48
Notes on Applications.....	49
Setting the App Permissions	49
Cell Phone Etiquette	50
Getting Ready	52
Names and Functions of Parts	52
Attaching/Removing the Front Cover	55
Attaching/Removing the Battery Pack.....	56
au IC Card (SIM Card)	60
Attaching/Removing au IC Card.....	61
Attaching/Removing microSD Memory Card....	63
Charging	64
Turning the Power On/Off	69
Switching to English Display	70
Start Screen	71

Basic Operations	72
Using the Home Screen	72
Activating the Apps.....	72
Switching the Home App	72
Monitoring the Product's Status.....	73
Setting Silent Mode.....	75
Setting Airplane Mode.....	76
Checking Your Phone Number.....	77
Using the Fingerprint Function.....	77
Registering Fingerprints	77
Authenticating with Fingerprints	78
Displaying Menu	78
Setting Home Screen	78
Saving Battery Consumption	79
Charging Other Mobile Devices.....	79
Telephone	81
Making a Call	81
Receiving a Call	81
Making a Call from Contacts.....	81
Appendix	82
Updating Software.....	82
Troubleshooting.....	83
After-Sales Service.....	87
SIM Unlock.....	90
Related Accessories.....	91
Using Earphones	92
Main Specifications	93
Specific Absorption Rate (SAR) of Cell Phones	95
FCC Notice	96
Export Administration Regulations	98
Intellectual Property Rights.....	99

Safety Precautions

When Using the Product

- Before you start using the product, be sure to read "Safety Precautions" in this manual to ensure correct use.
- Before you assume that the product is malfunctioning, check for possible remedies in "クイック診断 (Quick check)" and "トラブル診断 (Trouble check)" on "故障紛失サポート (Repair and Delivery Support)" app.

■ Quick check

Home screen → [📶] → [サポート (Support)] → [故障紛失サポート (Repair and Delivery Support)] → [クイック診断してみる (Try quick check)]
(Displayed language is Japanese only)

■ Trouble check

Home screen → [📶] → [サポート (Support)] → [故障紛失サポート (Repair and Delivery Support)] → [便利な機能 (Useful functions)] → [トラブル診断を試す (Try trouble check)] (Displayed language is Japanese only)

Also available on the following au home page.
<https://www.au.com/trouble-check/> (Japanese)



- Communication is not possible even inside the service area in places where the signal does not reach (e.g. tunnels and basements). Also, communication may not be possible in poor reception areas. Communication may be interrupted if you move into poor reception areas during communications.
- Since this product uses radio waves, the possibility of communication intercepts by third parties cannot be eliminated (though the LTE/WiMAX 2+/GSM/UMTS system has highly secure confidential communication features).
- VoLTE (LTE network) by au is used when connecting with emergency call receiving agencies within Japan. You cannot connect using 3G (circuit-switched network).
- The product is compatible with au World Service. Each network service described in this manual varies depending on the area and service content.
- Since the product is a radio station under the Radio Law, you may be asked to temporarily submit the product for inspection in accordance with the Radio Law.

- The IMEI information of your cell phone is automatically sent to KDDI CORPORATION for maintenance and monitoring operational status of your cell phone.
 - If you are using the product overseas, check the relevant laws and regulations of the country/region you visit beforehand.
 - The Company is not liable for any damages arising from earthquakes, lightning, storms, floods or other natural disasters, as well as fires, actions by third parties, other accidents, intentional or mistaken operation by the customer, or use under other unusual conditions outside the responsibility of the Company.
 - The Company is not liable for any incidental damages (change/disappearance of saved content, loss of business income, disruption of business, etc.) arising from use of or inability to use the product.
 - The Company is not liable for any damages arising from failure to observe the described content of this manual.
 - The Company is not liable for any damages arising, for example, from malfunction caused by combination with connected devices or software not related to the Company.
- Captured image data or downloaded data may sometimes be altered or lost due to faults, repair or other handling of the product. The Company is not liable for any damage or lost income resulting from recovery of these data.
 - It is recommended you keep a copy of important data on your PC's hard disk, etc. Whatever the cause of the defect or malfunction may be, the Company assumes no responsibility for alteration or loss of saved data.
 - Contents saved in the product, such as contacts, mails and favorites might be altered or lost by an accident, fault, repair or mishandling. Be sure to keep a copy of important contents. Note that the Company assumes no responsibility for any damages or lost profits resulting from altered or lost contents.
 - Note that content data (both charged or free of charge) saved on the product cannot be returned to the customer when the product is replaced for repair of a fault, for example.
 - The product uses liquid crystal for its main display. The main display response speed may become slow when the ambient temperature is low, which is due to the characteristics of liquid crystal and is not a malfunction. The main display response speed will return to normal at room temperature.

- Although the display used on the product is made using high-precision technology, some pixels (dots) might be lit or out at all times. This is not a malfunction.
 - You are recommended to store copies of individual data such as photos/movies you took and music in your PC by sending each file as mail attachment, etc. Note, however, that you may not be able to make copies of some copyrighted data even by the above-mentioned means.
 - Do not discard the old product together with regular trash. Please cooperate in the collection of the product (including optional parts) when it is no longer needed to protect the environment and effectively use resources. Old products are collected at au shops and other places.
- * "The Company" as appears in this manual refers to the following companies:
Sold by: KDDI CORPORATION, OKINAWA CELLULAR
TELEPHONE COMPANY
Manufactured by: KYOCERA Corporation





memo

- ◎ Reproduction of the content of this manual in part or in whole is prohibited.
- ◎ The content of this manual is subject to change without notice.
- ◎ Due to the specification changes of the operating system or termination of the services, some features become unavailable.
- ◎ Every effort has been made in the preparation of this manual. Should you notice any unclear points, omissions, etc., feel free to contact us.

Safety Precautions (Observe Strictly)

- Before using the product, thoroughly read this "Safety Precautions" for proper use. Please keep this manual carefully after reading it.
- These precautions describe instructions that should be observed to prevent injury to the customer and others, or damage to property using the product.
- The signs below differentiate between the levels of danger that can occur if the product is not used within the specified guidelines.







 DANGER	This sign denotes that "death or serious injury" ^{*1} may directly result from improper use".
 WARNING	This sign denotes that "death or serious injury" ^{*1} may result from improper use".
 CAUTION	This sign denotes that "minor injury" ^{*2} or damage to property ^{*3} may result from improper use".

^{*1} Serious injury: This refers to loss of sight, injury, burns (high- and low-temperature), electric shock, broken bones, injuries with residual aftereffects from poisoning, etc., and injuries requiring hospital admission for treatment or long-term hospital attendance as an outpatient.

^{*2} Minor injury: This refers to injuries, burns (high- and low-temperature), electric shock, etc. that do not require hospital admission for treatment or long-term hospital attendance as an outpatient.

^{*3} Physical damage: This refers to extended damage to buildings, furniture, livestock or pets.

Explanation of Graphic Symbols Used in This Manual

	Indicates an action that is not allowed.		Indicates that handling with wet hands is not allowed.
	Indicates that disassembly is not allowed.		Indicates an action based on instructions that must be done.
	Indicates that use in a place where the product is likely to get wet or allowing the product to get wet is not allowed.		Indicates that the power plug must be disconnected from the power outlet.

■ Precautions Common to the Main Unit, Battery Pack, Charger, au IC Card, LOCK Rotating Tool (Sample), Hexagon Wrench (Sample), Peripheral Devices

DANGER



Do not use, store or leave the product in hot places (e.g. by the fire, near a heater, under a kotatsu or futon, in direct sunlight, in a car in the hot sun).

Doing so may cause fire, burns, injuries, or electric shock.



Do not put the product into or near a heating cooking device such as a microwave oven or IH cooker, or high-pressure container such as a pressure cooker.

Doing so may cause fire, burns, injuries, or electric shock.



Do not put sand, dirt, or mud on the product or put it on them directly. Do not touch the product with hands to which sand or others adhere.

Doing so may cause fire, burns, injuries, or electric shock.

For details on water/dust resistance, refer to the following.

►P.33 "Notes on Water, Dust, Seawater, and Shock Resistance"



Do not charge when the product is wet with water (drinking water, perspiration, seawater, urine of pet animals, etc.).

Do not use it near water, such as in a bathroom.

Doing so may cause fire, burns, injuries, or electric shock.

For details on water resistance, refer to the following.

►P.33 "Notes on Water, Dust, Seawater, and Shock Resistance"



Do not subject the product to strong pressure or break the product. Especially when bringing the product putting in a pocket of clothes, do not let the product hit against surroundings or being put between the objects.

Doing so may cause fire, burns, or injury due to battery damage.

* Examples to avoid

- Sitting or squatting with the product put in a pocket of trousers or skirt
- Putting the product in a pocket of outer wear and catching them in a door or a door of car
- Stepping on the product on a soft object such as a sofa, bed, or bedding, or on a floor



Do not disassemble or modify.

Doing so may cause fire, burns, injuries, or electric shock.



Do not let the product get wet with water (drinking water, perspiration, seawater, urine of pet animals, etc.).

Doing so may cause fire, burns, injuries, or electric shock.

For details on water resistance, refer to the following.

► P.33 "Notes on Water, Dust, Seawater, and Shock Resistance"



Do not put water (drinking water, perspiration, seawater, urine of pet animals, etc.) into the charging terminal or the external connection terminal.

Doing so may cause fire, burns, injuries, or electric shock.

For details on water resistance, refer to the following.

► P.33 "Notes on Water, Dust, Seawater, and Shock Resistance"



Use the optional products specified by au.

Not doing so may cause fire, burns, injuries, or electric shock.



WARNING



Do not drop, trample, or throw the product or give a strong force or vibration to it.

Doing so may cause fire, burns, injuries, or electric shock.



Do not allow conductive materials (metal pieces, pencil lead, etc.) to come in contact with the charging terminal or the external connection terminal, and do not allow dust to get inside.

Doing so may cause fire, burns, injuries, or electric shock.



Do not cover or wrap the product with bedding, etc. while using or charging the product.

Doing so may cause fire or burns.



Do not adhere anything metal (stickers, etc. containing metal) between a wireless charger product (sold separately) and the back of the product, or the back cover or battery cover.

Doing so may cause fire, burns, or injuries.



Do not place anything metal (straps, clips, etc. containing metal) between a wireless charger product (sold separately) and the back of the product.

Doing so may cause fire, burns, or injuries.



Before charging with a wireless charger product (sold separately), first remove any commercially available cover, etc. attached to the product.

The material and thickness of the cover or any foreign matter such as dirt caught between the product and the cover may prevent normal charging and cause fire, burns, or injuries.

**Turn the product off near precision control and faint-signal electronic devices.**

Radio waves may cause malfunctioning or otherwise affect the electronic devices.

*Examples of electronic devices to be careful of hearing aids, implanted cardiac pacemakers and implanted defibrillators, other medical electrical devices, other automatic control devices, etc. Those who use an implanted cardiac pacemaker, implanted defibrillator, or other medical electrical device should check with the manufacturer of the medical electrical device or where they purchased the device with regard to how it may be affected by radio waves.

**If charging is not completed after the specified charging time, stop charging.**

Overcharging may cause fire, burns, or injuries.

**Make sure to turn off or stop charging the product before you get close to places where a flammable gas or dust can be generated.**

Using the product in places where a flammable gas can be generated may cause an explosion or fire.

**Follow the instructions given by the respective institution regarding the use of the product in a gas station.**

Do not charge the product in a gas station. Be careful not to drop the product in a place like a gas station, especially when you put gas into a vehicle.

Using the product in places where a flammable gas can be generated may cause an explosion or fire.

**Perform the following operations while using, charging, or keeping the product if there are odors, noise, smoke, overheating, discoloring, deformation, or other abnormalities.**

- Remove the power plug from the wall outlet.
- Turn the product off.
- Remove the battery pack from the product. Not doing so may cause fires, burns, bodily injury, electric shock, etc.

**CAUTION****Do not use the damaged product.**

Doing so may cause fire, burns, or injuries.

**Do not leave the product on unstable or sloping surfaces. Be careful especially when the product is set to vibrate.**

The product may fall and cause injuries.



Do not use or store the product in humid or dusty places, or places that get hot.

Doing so may cause fire, burns, or electric shock.

For details on water/dust resistance, refer to the following.

►P.33 "Notes on Water, Dust, Seawater, and Shock Resistance"



When children use the product, do not let them use incorrectly without instruction by an adult for proper use.

Doing so may cause injuries.



Do not store the product within the reach of small children.

Be careful especially when you store the small parts such as a LOCK Rotating Tool (sample) or a hexagon wrench (sample).

Not doing so may cause accidental swallow, injuries, or electric shock.



Be careful when using the product continuously or charging as it gets hot. Also, avoid touching the product continuously while putting the product in a pocket of clothes or falling asleep unintentionally.

The product or specified charger (sold separately) may become hot when using applications, calling, doing data communication, watching videos continuously, or while charging. Depending on your physical predisposition and physical condition, contacting with a high temperature part continuously may cause skin redness, itching, rash, or low-temperature burns.

■ Main Unit



DANGER



Do not throw the main unit into fire or apply heat.

Doing so may cause fire, burns, or injuries.



Do not apply excessive force such as sticking a sharp-edged tool (nail, etc.) into the product, hitting it with a hard tool (hammer, etc.), or stepping on it.

Doing so may cause fire, burns, or injuries.



If the substance inside the main unit comes into contact with your eyes or mouth, immediately rinse the area with clean water, and then see a doctor right away.

Not doing so may cause loss of sight or poor physical condition due to the influence of the substance, etc. inside the main unit.

WARNING



Do not lighten or flash the lighting part of the light close to person's eye. Be especially careful to keep a sufficient distance from small children.

Not doing so may cause vision disturbance. Also, it may cause an accident such as injuries due to dizziness or shocks.



Do not lighten or flash the light to point at the eyes of someone driving a car, etc.

Doing so may interfere with driving and cause an accident.



Do not watch a repeatedly flickering screen for a long time.

Doing so may cause muscle spasms or loss of consciousness, etc.



Do not allow water or other liquids (drinking water, perspiration, seawater, urine of pet animals, etc.), metal pieces, flammable material or foreign object into the au IC card/microSD card slot on the product.

Do not mistake the place and direction of the au IC card or the microSD memory card.

Doing so may cause fire, burns, injuries, or electric shock.



Do not expose the camera lens to direct sunlight for an extended period.

Doing so may cause fire, burns, or injuries by the light-collecting mechanism of the lens.



When sounding the buzzer, do not sound it close to your ear.

Doing so may cause hearing impairment or other difficulty.



Turn off the product or set it to Airplane mode before going aboard an airplane.

Since using the product on airplanes is restricted, follow the instructions given by the respective airlines.

The product's signals may adversely affect on-board electronic equipment.

If you commit a prohibited act while using the product on an airplane, you might be punished by law.



Follow the instructions given by the respective medical institution regarding the use of the product in a hospital.

Turn off the product in areas where the use of the product is prohibited.

The product's signals may affect electronic equipment and electronic medical equipment.



When using the handsfree call, ringtone is ringing loudly, or in the standby mode, be sure to keep the product off of the ears. Also, when playing games, video, or music with an earphone microphone connected to the product, adjust the volume to the proper level.

When using the handsfree call, note that the speaker may emit loud sound. Ringtone or alarm sound can be heard even in the standby mode. Turning the sound on with the volume set too loud or using the product continuously for a long time may adversely affect your ears. Doing so may prevent surrounding sound from being heard, causing an accident.



If you have a weak heart, be careful when setting the ringtone vibration and incoming volume.

Sudden ringtone vibration and ringtone surprise you, and it may cause harmful effect on heart.



To use electronic medical equipment, check with electronic medical equipment manufacturer or vendor to determine how devices are affected by radio waves before using.

Radio waves may affect the performance of electronic medical equipment.



When the display or camera lens is accidentally broken, be careful of broken glass or exposed internal parts of the product.

Not doing so may cause burns, injuries, or electric shock with damaged parts or exposed parts.



Prevent a pet from biting the product.

Not doing so may cause fire, burns, or injuries due to battery ignition, rupture, overheat, or leak.



CAUTION



Do not swing the product around by holding strap, etc.

Doing so may cause an accident.



Before calibrating the Compass, check for safety around you, hold the product firmly, and do not wave the product more than necessary.

Doing so may cause an accident.



If the display breaks and the fluid, etc. leaks out from inside, do not let the fluid contact with the skin on your face or hands or clothes.

Doing so may cause eye or skin problems. If the internal matter comes into contact with your eyes, mouth, skin or clothes, immediately rinse the contacted area with clean water. If the fluid enters your eyes, mouth etc., immediately see a doctor after rinsing.



Do not forcibly remove the back cover.
This can damage the back cover and may cause injuries.



Be careful not to get your finger or a part of your body caught when installing the back cover.

Doing so may cause injuries.



Do not use the product without the back cover.

Doing so may cause burns, injuries, or electric shock.



To remove the back cover, always use the LOCK Rotating Tool (sample) to unlock the cover before removing it.

►P.56 "Attaching the Battery Pack"



To use the product in car, check with automobile manufacturer or dealer to determine how vehicle devices are affected by radio waves before using.

In rare cases, using the phone in some vehicle models can cause the vehicles electronic equipment to malfunction. In that case, stop using the product immediately.



If you develop skin problems, stop using the product immediately, and see a doctor.

Itching, rashes, eczema, etc. sometimes occurs depending on your physical constitution and condition.

For material of each part ►P.23 "Material List"



Make sure that there is no adhered metal pieces (cutter blade, staples, etc.) as the speaker or camera part of this product generates magnetism.

Not doing so may cause injuries with adhered metal pieces.



Use the product in a well-lighted area and put some distance between you and the display when watching the display.

Using the product in dark places or near eyes may affect your vision.

■ Battery Pack



DANGER



Do not allow metal fragments (necklace, hairpin) or conductive materials to come into contact with the battery pack. Do not bring or store the battery pack either with these materials.

Doing so may cause fire, burns, or injuries.



Do not forcibly install the battery pack when attaching the battery pack. Do not forcibly remove the battery pack when removing the battery pack.

Doing so may cause fire, burns, or injuries. For details on installing/removing the battery pack, refer to the following.

►P.56 "Attaching the Battery Pack"

►P.59 "Removing the Battery Pack"



Do not throw the battery pack into fire or apply heat.

Doing so may cause fire, burns, or injuries.



Do not apply excessive force such as sticking a sharp-edged tool (nail, etc.) into the product, hitting it with a hard tool (hammer, etc.), or stepping on it.

Doing so may cause fire, burns, or injuries.



Check the orientation of the battery pack when installing the battery pack into the product.

Not doing so may cause fire, burns, or injuries due to battery pack ignition, rupture, overheating, or leak.

For details on installing the battery pack, refer to the following.

►P.56 "Attaching the Battery Pack"



If the substance inside the battery pack comes into contact with your eyes or mouth, immediately rinse the area with clean water, and then see a doctor right away.

Not doing so may cause loss of sight or poor physical condition due to the influence of the substance, etc. inside the battery pack.



WARNING



Do not use the product if there are odors, noise, smoke, overheating, discoloring, deformation, or other abnormalities.

Doing so may cause fire, burns, or injuries.



Do not touch the battery pack with wet hands.
Doing so may cause burns or electric shock.



Stop using the product immediately and move the battery pack away from fire if you notice unusual odor or leakage of fluids inside the battery pack.

The battery fluid is flammable and could ignite, causing a fire, explosion, etc.



Prevent a pet from biting the battery pack.

Not doing so may cause fire, burns, or injuries due to battery pack ignition, rupture, overheating, or leak.



CAUTION



If fluid, etc. leaks out from the battery pack, do not let the fluid contact with the skin on your face or hands or clothes.

Doing so may cause eye or skin problems.

If the internal matter comes into contact with your eyes, mouth, skin or clothes, immediately rinse the contacted area with clean water.

If the fluid enters your eyes, mouth etc., immediately see a doctor after rinsing.



Do not discard the old battery pack together with regular trash.

Doing so may cause fire, burns, or injuries. May damage the environment. After insulating the battery pack no longer needed with tapes, etc. on the connection terminal of the battery pack, and bring the battery pack to a sales outlet such as au Shop. Alternatively, if your local municipality has a battery recycling program, dispose of it as provided for.



Do not use or charge the product with the battery pack is wet.

Doing so may cause fire, burns, or injuries.

■ Charger



WARNING



Do not use if the cord of the specified charger (sold separately) is damaged.

Doing so may cause fire, burns, or electric shock.



Do not use the specified charger (sold separately) in a humid place such as a bathroom.

Doing so may cause fire, burns, or electric shock.



Do not touch the specified charger (sold separately) if you hear thunder.

Doing so may cause electric shock.



Do not short the charging terminal while it is connected to an outlet. Do not allow any part of your body such as your hands or fingers to come into contact with the charging terminal.

Doing so may cause fire, burns, or electric shock.



Do not place heavy objects on the cord of the specified charger (sold separately), or do not pull the cord with excessive force.

Doing so may cause fire, burns, or electric shock.



When you plug/unplug the specified charger (sold separately) into/from the outlet, do not contact metal straps or other metal objects with the jack.

Doing so may cause fire, burns, or electric shock.



Do not connect a transformer for overseas travel (travel converter) to the specified charger (sold separately).

Doing so may cause ignition, overheating, or electric shock.



Do not apply excessive force on the connection part with the specified charger (sold separately) connected to the product.

Doing so may cause fire, burns, injuries, or electric shock.



Do not charge anything that has gotten wet with water or other liquid (beverage, sweat, seawater, pet urine, etc.) with a wireless charger product (sold separately).

Doing so may cause fire, burns, injuries, or electric shock.



Do not touch the cord, charging terminal or power plug of the specified charger (sold separately) with wet hands.

Doing so may cause fire, burns, or electric shock.



Use the product at the specified power supply voltage.

When charging the product overseas, use the specified charger (sold separately) for global use.

Incorrect power supply voltage may cause fire, burns, or electric shock.

AC adapter: 100 VAC (Connect to an AC outlet for internal household use)

AC adapter for global use: 100 VAC to 240 VAC (Connect to an AC outlet for internal household use)



Wipe off dust on the power plug.

Not doing so may cause fire, burns, or electric shock.



Fully plug the specified charger (sold separately) into the outlet.

Not doing so may cause fire, burns, or electric shock.



When you disconnect the power plug from an outlet, do not pull the cord of the specified charger (sold separately) with excessive force. Instead, grasp the adapter to disconnect.

Pulling the cord of the specified charger (sold separately) may damage the cord and cause fires, burns, electric shock, etc.



If wearing an implanted cardiac pacemaker, implanted defibrillator, or other medical electric device, consult carefully with a doctor before using a wireless charger product (sold separately).

Radio waves may affect the performance of electronic medical equipment.



When plugging/unplugging the specified charger (sold separately) into/from the product, do not pull the cord with excessive force. Instead, plug/unplug it straightly toward the jack to connect.

Not doing so may cause fire, burns, injuries, or electric shock.



Stop using the charger immediately if you notice deformation of the charging terminal. Also, stop using the charger after recovering the original form of the terminal.

Short-circuiting of the charging terminal may cause fire, burns, injuries, or electric shock.



When the charger is not to be used for a long time, disconnect the power plug from the outlet.

Leaving it plugged in may cause fires, burns, or electric shock, etc.



Immediately remove the power plug from the outlet if water or other fluids (drinking water, perspiration, seawater, urine of pet animals, etc.) get on the adapter.

Short-circuiting due to the fluid may cause fire, burns, or electric shock.



Always remove the power plug from an outlet when cleaning the equipment.

Not doing so may cause fire, burns, or electric shock.

CAUTION



Do not keep touching continuously the specified charger (sold separately) when it is connected to an outlet.

Doing so may cause burns.

■ au IC Card



CAUTION



Be careful of the cut surface when handling the au IC card as it may damage a part of your body such as fingers, etc.

The cut surface may cause injuries with adhered metal pieces.

■ LOCK Rotating Tool (Sample), Hexagon Wrench (Sample)

WARNING



The hexagon wrench (sample) has a sharp point. Do not use pointed at yourself or others. Doing so may allow it to strike yourself or others, causing injuries or blindness.

CAUTION



If using the LOCK Rotating Tool (sample) or hexagon wrench (sample) causes any skin abnormality, immediately discontinue use and see a doctor. Itching, rashes, eczema, etc. sometimes occurs depending on your physical constitution and condition.

For material of each part ►P.23 "Material List"



Store out of reach of infants and young children.

They may accidentally swallow it, causing choking or injury.

■ Use near Medical Instruments and Inside Medical Facilities

WARNING



Wearers of medical equipment such as implanted pacemakers or defibrillators must carry and use the product at least 15 cm away from the implanted device.

Radio waves may affect the performance of electronic medical equipment.



When using electronic medical devices as home medical treatment other than an implanted pacemaker and an implanted cardioverter-defibrillator outside medical facilities, check individually with the manufacturer of the electronic medical equipment regarding the influence of radio waves.

Radio waves may affect the performance of electronic medical equipment.



Make sure that the product will not emit any signals (turn off power, put it in Airplane mode, etc.) if within 15 cm of those around you, such as where crowded and you cannot move freely.

There may be people with an implanted pacemaker or an implanted cardioverter-defibrillator nearby. Radio waves may affect the performance of electronic medical equipment.



When using the product in medical facilities, be sure to observe the regulations of the facility.

Radio waves may affect the performance of electronic medical equipment.

Material List

■ TORQUE G04 main unit

Part	Material	Surface Treatment
Exterior case (display side)	PA resin	UV-cured acrylic coating
Exterior case (front cover)	PA resin/ PET	UV-cured acrylic coating/hard coating
Exterior case (back, side), volume up/down button, Direct button, USB cover	PC resin	UV-cured acrylic coating
Power button	Epoxy resin	Acrylic thermal cure coating
Exterior case (top/bottom bump protectors)	TPU	-
Display, wide-angle camera lens, out-camera lens	Chemically strengthened glass	Antifouling

Part	Material	Surface Treatment
Mobile light lens	PMMA resin	-
Camera lens periphery, camera button	Aluminum	Anodizing
Case screws	SWCH	Baking finish
Lock knob	SUS	Ni-plated coating

■ Battery pack

Part	Material	Surface Treatment
Exterior	PC resin	-
Seal	PET	-
Terminal	Copper	Gold-plated (Ni-plated undercoating)

■ LOCK Rotating Tool (sample)

Part	Material	Surface Treatment
Exterior	PA resin	-

■ Hexagon wrench (sample)

Part	Material	Surface Treatment
Exterior	Palladium steel	Electroless nickel plating

■ Front screen

Part	Material	Surface Treatment
Exterior	Acrylic resin (silicon resin (adherend))	-

Handling Precautions

These precautions are provided to prevent product faults and to ensure that performance can be fully demonstrated. Thoroughly read these precautions to ensure correct use.

■ Precautions Common to the Main Unit, Battery Pack, Charger, au IC Card, LOCK Rotating Tool (Sample), Hexagon Wrench (Sample), Peripheral Devices

- Do not apply excessive force to the product during use. Be sure not to put the product into a tightly packed bag or place a heavy object on the product in a bag. Sitting on the product in your pocket might damage the display or internal circuit board resulting in a damage or malfunction. Keeping an external connection device connected to the external connection terminal might damage the connector resulting in a malfunction. Such damage and malfunction are not covered by the warranty, even if there is no external damage.

- To ensure the waterproof property (equivalent to IPX5 and IPX8) or the dustproof property (IP6X) of the product, use the product with the back cover or USB cover attached.

Note that the waterproof property is not guaranteed in every usage condition. Do not allow water to get inside the product, or splash water on a specified charger (sold separately) or optional accessories. Do not attach/remove the back cover, or open/close the USB cover in the rain or with any water on the surface of the product. Doing so may cause water intrusion resulting in internal corrosion.

Malfunctions determined to be caused by such water intrusion are not covered by the warranty.

- Do not use the product in extremely hot, cold or humid places.
(Use within an ambient temperature range of 5°C to 35°C and humidity range of 35% to 90%. Temporary use at -21°C to 50°C is allowed.)
 - Main unit
 - Battery pack, au IC card (attached to the main unit)
- Do not use the product in extremely hot, cold or humid places.
(Use within an ambient temperature range of 5°C to 35°C and humidity range of 35% to 85%.)
 - Charger
 - Related Accessories
- Do not use in places subject to lots of dust or vibration. Doing so may cause malfunction.

-
- Clean the external connection terminal, wireless charging antenna connection, and charging connection area with dry cotton swabs, etc. every now and then. Soiling may result in a poor connection. Do not exert a strong force to clean the respective connection terminals to prevent deformation.
-
- Clean the product with a soft dry cloth (such as the type used for eyeglasses). Forceful rubbing with a dry cloth may scratch the display. The display may be stained if splash or smear is left attached to the surface. Wiping the product using alcohol, thinner, benzene, detergent, etc. might erase the printing on the outer cover or cause malfunction.
-
- Use as far away as possible from fixed-line phones, TVs and radios. Use nearby might affect them.
-
- The product may become warm while charging, depending on the situation, but this is not abnormal.
-
- Remove the battery pack after turning off the product. Data stored in the product may sometimes be altered or lost by removing the battery pack before turning off the product.
-
- Do not place near corrosive chemicals or in places where corrosive gas is generated. Doing so may cause malfunction.
-
- Do not use outside when you can hear thunder. Doing so might risk lightning strikes and electric shock.
-
-
- Be sure to use only the specified peripheral devices. Use of other peripheral devices might cause malfunction.
-
- Do not put the product in a cooking apparatus such as microwave oven or a pressure vessel. Doing so may cause malfunction.
-
- The customer is not allowed to disassemble, modify or repair the product. Doing so may cause malfunction. Modification of the product is in violation of the Radio Law and Telecommunications Business Law.
-
- To prevent short-circuiting of the connection terminal, do not allow your fingers or any other part of your body or conductive materials (metal, pencil lead, etc.) to come in contact with or enter these areas. Doing so may cause malfunction.
-
- In the event that the product gets wet while charging, immediately disconnect the power plug of the specified charger (sold separately).
-
- Do not use the product while driving a car or riding a motorbike or bicycle or while walking. Use of a mobile device while driving a car or motorbike is prohibited by law. Use of a cell phone while riding a bicycle may be punishable by some regulations.
-
- Using or charging the product in a bag or while it is covered with bedding might cause malfunction.
-

- When using a specified charger (sold separately) or external device, insert/remove the connector straight to/from the terminal. Improper connection may cause a fault.
- Do not expose the camera lens to direct sunlight for an extended period. Doing so may cause malfunction.
- Do not store the product in places subject to direct sunlight (e.g. in a car), places that get hot, places that get extremely cold, and in humid or dusty places. Doing so may cause malfunction.
- Do not leave the product on unstable or sloping surfaces. Be careful especially when the product is charging or set to vibrate. The product may fall and cause malfunction.
- For charging the product, do not exceed the rating of an outlet or wiring device by overloading an electrical circuit, etc.

■ Main Unit

- Do not forcefully press, tap or intentionally subject the display to strong impact. Doing so may cause scratching or damage.
- The display surface of this product is protected by the hybrid shield. Do not use the hybrid shield without the sheet on its surface of the front screen because it may affect the functionality of the product.
- Do not forcefully press your fingernails, sharp objects, or hard objects against buttons or display surface. Doing so may cause scratching or damage.
- The touch panel is designed to be lightly touched by fingers. Avoid pressing forcefully or using sharp objects (fingernail, ballpoint pen, pin, etc.). The touch panel might not respond to the following types of operation. These may also result in malfunction.
 - with fingernails
 - with another object placed on the operation area
 - with the display covered with a sticker or sheet (commercially available protective film or privacy protector)

- Never use the modified product. Use of a modified device violates the Radio Law and Telecommunications Business Law.
The product has acquired such certification as conformity with technical regulations for a specified radio station based on the Radio Law and conformity with technical regulations for a terminal device based on the Telecommunications Business Law, and the "Technical Conformity Mark" can be confirmed internally in the product.
From the home screen → [Settings] → [System] → [Compliance information]
If modifications are made to the internal components, the certifications of conformity with technical regulations will become invalid. Never use the product without these certifications valid. Doing so violates the Radio Law and Telecommunications Business Law.
- Take care not to place magnetized items such as magnetic cards, speakers and TV sets near the product, as it might cause malfunction. Putting strong magnetism close to the product might cause false operation.
- Do not bring magnetized cards such as cash cards, credit cards and prepaid cards closer to the product. Doing so may result in loss of recorded information.

- When you put the product in your pocket or bag, take care so that the display does not come in contact with metal objects or other hard objects. Not doing so may cause scratching or damage. Be aware that any metal or other hard cell phone strap that comes into contact with the display may scratch or damage them.
- When suddenly brought into a warm place from a cold place, or when in a humid location, or when used where temperature suddenly changes (e.g. near the air discharge port of an air conditioner), water drops (i.e. condensation) sometimes are formed inside the product. Note that when used under conditions such as this, humidity might cause corrosion or a fault.
- Camera lens or inside of the display may mist over (dew formation) because of usage environment such as temperature or humidity. This is not malfunctioning or abnormal.
- Environment for easily generating dew formation on the camera lens or inside of the display
In the following cases, such as large temperature change or high humidity, camera lens or inside of the display mist over because of usage environment.
 - Bring the product from a high temperature land into a low temperature water.
 - Bring the product from a cold place into a warm place such as an indoor.
 - Open/Close the USB cover of the product in a high humidity environment.

- How to reduce condensation
Do not use the product in places that get hot and humid, and sandy or dusty places. Leave the product with USB cover opened for a while until the condensation is cleared when the ambient temperature is held constant.
 - While writing/reading data to/from a microSD memory card, do not subject the product to vibration or impact, removing the battery pack, or turn off the power. Doing so may cause data loss or malfunction.
 - Do not remove the wireless charging antenna on the back side of the back cover. Removing the wireless charging antenna will prevent wireless charging.
 - Do not cover the light sensor with your finger or put a sticker on it. May hinder the sensor from detecting the ambient light level and functioning correctly.
 - Do not put a sticker, etc. on the proximity sensor. May cause the sensor to malfunction and make the display always turned off while receiving a call or during a call.
 - Any soiling on the proximity sensor may cause misoperation. Wipe the sensor with a soft, dry cloth.
- Do not use the product with the back cover or front cover removed. Do not leave or store the product in this condition. Doing so may allow dust or other foreign matter to enter product and cause malfunction.
 - Keep the USB cover, etc. closed when using the product. Using the product with the covers opened can allow dust, water, etc. to enter and cause malfunction.
 - Do not allow liquids, metal objects, or other foreign objects to get inside of the au IC card or microSD memory card slot. Doing so may cause malfunction.
 - Product speaker uses magnetic parts; be careful not to allow anything metal (cutter blades, staples, etc.) adhere to product when the front cover is removed. Attaching the front cover with anything adhering can cause malfunction.
 - Do not give strong impact on the product such as dropping, throwing, stomping. Doing so may cause malfunction.
 - Do not place the product directly on sand at a beach, etc. If sand or other small particles get inside the microphone or speaker, etc., it may cause the volume to drop or malfunction.

■ Touch Panel

- Any soiling on the display surface may cause false operation. Wipe the display with a soft, dry cloth.
- Putting stickers or sheets (e.g. commercially available protective films, peep prevention sheets) on the display might cause incorrect operation of the touch panel.
- When carrying the product in your pocket or bag, take care not to put the touch panel close to metals or other conductive materials, as it might cause false operation of the touch panel.
- Touching operation with gloved hands is available, but touching the panel may not work properly depending on the thickness and material of gloves.
 - Wipe off any water droplets on gloves if you cannot operate the product with water drops attached to gloves.
 - If you cannot operate with gloved hands after operating with bare hands, try entering the sleep mode and canceling the sleep mode. If "Glove touch mode" is set to "Always ON", operation with gloved hands is available even after operating with bare hands. To set "Glove touch mode" to "Always ON", from the home screen →  → [Settings] → [Display] → [Glove touch mode] → [Always ON] → [OK]
 - If you cannot operate with gloves which does not fit your finger, try pressing the display with the flat part of your finger.

- Priority is given to operation with a bare hand if operating with a gloved hand and bare hand at the same time.

■ Battery Pack



Li-ion 00

(The battery pack of the product is a lithium-ion battery.)

The battery pack is not fully charged at the time of purchase. Charge the battery before using the product. Also charge the battery after long periods of disuse before using the product.

- Use in very hot or cold environments, for example, when left in an automobile with the windows closed in summer, will cause the battery capacity to drop and shorten the available battery usage time. This will also shorten the battery pack's service life. Try to use the battery as much as possible at room temperature.
- When the battery pack is not to be used for a long time, remove the battery pack from the main unit, and store it away from hot and humid places.
- The battery pack is a consumable item. If the performance of a battery pack does not recover (e.g. the usable time after each charge has become extremely short), the battery is at the end of service life, so stop use and buy a new one of the specified type. Note that the length of service life varies depending on the usage condition, etc.

- Battery packs sometimes swell up as they approach the end of their service life depending on the usage condition. This is due to the properties of lithium-ion batteries, and is not a problem in terms of safety.
- Do not use a battery pack that has been damaged or that is leaking battery fluid. Doing so may cause malfunction.
- Do not wet the battery pack with water, etc. A wet battery pack may cause malfunction. If you drop the product into water by mistake, immediately turn off the power, remove the battery pack, and contact an au shop or Repair and Delivery Support Center. Never charge a wet battery pack.

■ Charger

- Do not wrap power cords of the specified charger (sold separately) around the charger. Do not forcibly bend the specified charger's (sold separately) plug or the connection between the connector and power cord. Do not place heavy objects on the cord of the specified charger (sold separately) or USB connection cable, or do not pull the cord with excessive force. Doing so may cause malfunction.
- When unplugging the power plug of the specified charger (sold separately) from the power outlet, hold and pull the power plug. If you pull the cable, it might be damaged.

■ Wireless Charging

- Do not adhere anything metal (stickers, etc. containing metal) on Wireless Charger Pad (sold separately) or the back of the product. Doing so may cause malfunction.
- The indicator LEDs on the Wireless Charging Pad (sold separately) remains on after charging completes, but this is not abnormal.
- Charging may stop just before phone is completely charged.
- If charging stops just before phone is completely charged, charging may not immediately resume.
- Some Qi-specification products may experience repeated starting/stopping of charging. Charge with a specified au product.
- Above a certain temperature, the charging function may stop or charging may take a long time, but this is not abnormal. Wait for the temperature to cool.
- Charging is controlled at a reduced rate during wireless charging to prolong the life of the battery pack.
- Place the Wireless Charging Pad (sold separately) on a flat, stable surface before charging.
- Turn the phone's vibration function off before wireless charging. Vibrating of the phone may cause it to move, preventing charging from completing or causing it to fall.

- Before charging, remove any case, cover, stickers or sheets (commercially available protective film or privacy protector) attached to the product.
- Make sure that the Wireless Charging Pad (sold separately) and the main unit are not wet.
- Do not wirelessly charge while a separately-sold AC adapter or USB Type-C cable is connected to the main unit.
- Keep any other wireless chargeable device other than the product you are charging away from the product. The au product you are charging may not be detected and prevent charging.
- If a TV, radio, etc. experience noise, charge as far away from the TV, radio, etc. as possible.
- Depending on the Qi-specification product, calls may not be received during charging. Charge with a specified au product.
- Some Qi-specification products may experience interference with the Osaifu-Keitai® function, preventing charging from starting. Charge with a specified au product.
- Activating of apps, etc. during wireless charging may prevent charging from completing.
- The main unit may become warm while on Wireless Charging Pad (sold separately), but this is not abnormal.

- Reception (quality of data communication, etc.) may be affected while charging on Wireless Charging Pad (sold separately).
- Do not move the Wireless Charging Pad (sold separately) or the main unit while charging.
- Battery may deplete if the main unit is left unused for a long period even after completing charging.
- Do not let a credit card, contactless IC card, etc. between the product and the Wireless Charging Pad (sold separately) when charging wirelessly. Doing so may prevent charging, or heat during charging resulting in the product or card malfunctioning or being damaged.

■ au IC Card

- Do not forcibly remove or insert the au IC card. Be careful not to exert excessive force when inserting the card into your au cell phone.
- You are responsible for any damage caused by inserting your au IC card into some other IC card reader/writer, etc.
- Do not put stickers, etc. on the au IC card.
- Do not insert your au IC card with a conversion adapter attached. Doing so may cause malfunction.
- Do not damage the card (use in a hot place, throw into fire, contact the metal part with foreign object, give an impact, bend, apply a load, moisten, etc.). Doing so may cause data loss or malfunction.

■ LOCK Rotating Tool (Sample), Hexagon Wrench (Sample)

- Do not apply excessive force to the LOCK Rotating Tool (sample) or hexagon wrench (sample). Doing so may cause malfunction or damage.
- The LOCK Rotating Tool (sample) and hexagon wrench (sample) are not covered by the free-of-charge repair warranty.

■ Camera

- When photographing important occasions, take a trial shot and check the shot image to make sure it is correctly shot.
- Do not shoot in areas where shooting is prohibited.

■ Copyrights and Rights of Portrait

- You are not allowed to copy, distribute, publish, modify or edit the data you shot, recorded or downloaded using the product without consent of the copyright holder, except for personal use, under the copyright law.
In addition, do not use or modify portraits or names of other individuals without their consent, as it may infringe on rights of portrait.
Note that shooting and recording might be restricted at some live performances, shows and exhibitions even for personal use.
- Be careful about the copyright and portrait right when posting images you shot, etc. on Internet/website.

■ Backup Content On the Product

- Please back up important content registered to the product or downloaded to the product from an outside source. Content recorded to memory on the product sometimes disappears or is altered by unexpected factors, such as static electricity or a fault, repair, mishandling, etc.

■ FCC Certification Information

- This product is certified by the Federal Communications Commission (FCC).
The product's FCC ID is JOYKB46.
You can view this certification in the following way.
How to confirm:
From the home screen → [⌘] → [Settings] → [System] → [Compliance information]

Notes on Water, Dust, Seawater, and Shock Resistance

This product is protection-rated (JIS C 0920) at IPX5/8-^{*1} water resistance and seawater capability^{*2} as well as IP6X-equivalent^{*3} dust resistance when the back cover and USB cover are completely attached (by Company test methods).

The product also meets 27 ruggedization test requirements, based on 22 categories of the US Department of Defense's MIL-STD-810G standards and including 5 categories from proprietary tests (by Company test methods). Product capabilities are confirmed in a test environment, and does not guarantee capabilities under all conditions of actual use. No guarantees are made with regard to non-breakage or non-fault.

^{*1} IPX5 equivalent means that the product will maintain its operability as a phone even if it is sprayed with water from a 6.3 mm diameter nozzle at a distance of about 3 meters for more than 3 minutes at a rate of about 12.5 liters per minute from any direction. IPX8 equivalent indicates no water seepage and phone capability is maintained even when gently submerged and left at the bottom of a tank for about 30 minutes filled with still, normal-temperature tap water at a depth of 1.5 m.

^{*2} Indicates no water seepage and phone capability is maintained even when submerged in normal-temperature, 20-kPa (maximum depth of 2.0 m) seawater* for about 60 minutes.

* Seawater: Evaluation made with Company original standards using artificial seawater simulate the seawater composition of the Japanese coast. Regarding use at pools, product has been assessed according to Japanese domestic disinfection standards.

^{*3} IP6X-equivalent indicates ability to resist dust intrusion even when placed in a test device containing test dust particles (diameter 75 μm or less) for 8 hours.

Drop	Tested by dropping from about 2.0 m in 26 directions onto metal and concrete Tested by dropping from about 1.0 m 500 times consecutively Tested by dropping a steel ball of approximately 100 g on the display surface from the height of 1 m
Shock	Tested by attaching device to test apparatus and subjecting to shock of 40 G from 6 directions 3 times
Immersion	Tested by immersing in about 2.0 m of water for 60 minutes
Blowing Rain	Tested by subjecting to rainfall of 1.7 mm/min from 6 directions for 30 minutes each direction Tested by subjecting to rainfall for 30 minutes with wind of 18 m/sec.
Rain Drip	Water resistance tested by dripping from 1 m (15 minutes)
Sand and Dust	Dust resistance tested by subjecting to dust continuously for 6 hours (wind 8.9 m/sec, concentration 10.6 g/m ³)
Salt Fog	Resistance to salt water tested by subjecting continuously for 24 hours to 5% salt fog and then drying for 24 hours

Humidity	Tested by subjecting continuously for 10 days (95% RH)
Solar Radiation	Tested by subjecting continuously for 20 hours to 1,120 W/m ² followed by shielding from radiation for 4 hours, repeated for 10 days
Vibration	Tested by subjecting to vibration for 3 hours (in 3 directions at 1 hour each/20 to 2,000 Hz)
Icing/ Freezing Rain	Tested by exposing to -10°C chilled water until coated with ice to 6 mm
Temperature Shock	Tested by subjecting to sudden temperature change from -21 to 50°C continuously for 3 hours
High Temperature (Operation)	Operation environment: Tested in an operation environment of 60°C continuously for 3 hours, with 3 cycles of the temperature change ranged 32 to 49°C
High Temperature (Storage)	Storage environment: Tested in a storage environment of 70°C continuously for 4 hours, with a temperature change ranged 30 to 60°C

Low Temperature (Operation)	Operation environment: Tested in an operation environment of -21°C continuously for 3 hours
Low Pressure (Storage)	Storage environment: Tested in a storage environment of -30°C continuously for 4 hours
Low Pressure (Operation)	Tested continuously for 2 hours (57.2 kPa/ equivalent to altitude of about 4,572 m)
Low Pressure (Storage)	
Freeze-Thaw	Tested by first subjecting to -10°C environment with condensation and mist for 1 hour, and then checking operation in a 25°C, 95% RH environment
Withstand load	Tested by subjecting to even surface load of 100 kgf
Seawater resistance	Tested by immersing in normal-temperature, 20-kPa seawater (maximum depth of 2.0 m) for about 60 minutes

Before using the product, thoroughly read "Important Items to Remember before Use" to ensure correct use. Failure to follow the contents described in these sections may cause the intrusion of water, sand or other foreign material, resulting in overheating, ignition, electric shock, injury or a fault.

Since operation of the product on each usage scene was confirmed based on the above assumption, proper operation of the product in every possible condition during actual use is not guaranteed. Malfunctions determined to be caused by mishandling by the customer are not covered by the warranty.

Handling Precautions

- Close firmly the USB cover of the product, and make sure the back cover is completely attached. Water resistance is effective when completely sealed.
- Never open/close the back cover or USB cover when the product or your hands are wet.

- Do not let the product submerged into or get wet with the liquids (hot water of hot spring, water containing soap, detergent, bath powder, alcohol, soft drink, seasoning, etc.) other than tap water. Do not use it in a place where it gets wet with pet urine either.
If the product gets splashed, immediately rinse it off with tap water.
- Do not place the product directly on sand at a beach, etc. If sand or other small particles get inside the mouthpiece (microphone), etc., it may cause overheating or a fault.
- Do not use or leave the product in a humid place such as a bathroom or kitchen for an extended period of time.
The product is tested to ensure its proper operability when the product is exposed to hot water of the temperature as hot as bath shower water (43°C or less).
- Moisture may still remain after draining. While this will not affect use, you should not leave the product next to items you do not want to get wet. The product may wet clothing, inside of carry bag, etc.
- Drain any water in the mouthpiece (microphone) that may be affecting audibility.

- The product is not designed to resist water pressure. Avoid exposing to high water pressure or submersing in water for a long period.
- Do not wash the product in a washing machine or ultrasonic bath.
- Do not immerse the product into a bathtub. The product is not designed to be heat resistant.
- The rapid changes of temperature may cause condensation, resulting in malfunction. Wait until the product reaches room temperature before you bring the product from a cold place into a warm bathroom.
- The product does not float on water.

● USB cover

- Close firmly the USB cover of the product, and make sure the back cover is completely attached. Any minute particles becoming lodged between contact surfaces (a single hair, etc.), no matter how small, can cause seepage.
- Do not wear gloves while opening/closing the USB cover or attaching/removing the back cover. Any minute particles becoming lodged between contact surfaces (a single hair, etc.), no matter how small, can cause seepage. Before closing the cover, wipe any water, soiling, etc. with a dry, clean cloth, no matter how small.
- Any deterioration or damage with the USB cover will affect water resistance.

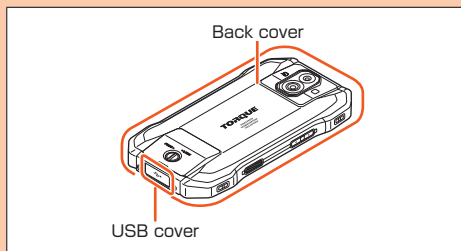

Closing the USB cover

After stowing the hinge of the cover ①, press on the whole cover with the pad of your finger. Press along the cover in directions shown ② to close the cover firmly ensuring there are no gaps.

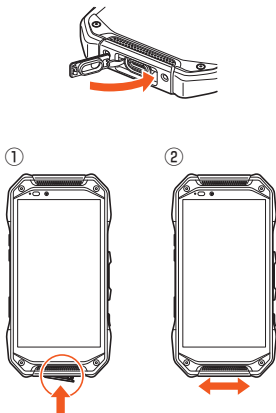

Attaching the back cover (►P.56)

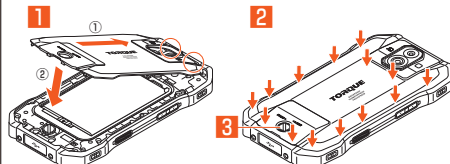

1 Attach the back cover

Insert the back cover diagonally from the two claws on the edge of the back cover (①), and then push the bottom end of the back cover (②) to fit it.

2 Press the back cover where shown by the arrows making sure the cover is pressed down completely around

3 Rotate the lock knob clockwise to lock the back cover

Use the accompanied LOCK Rotating Tool (Sample).



● If any liquid other than water gets on the product

- If anything other than water (washing detergent, alcohol, etc.) gets on the product, immediately rinse with water.
- You can wash the product under a mild flow (up to 6 liters per minute) of tap water at room temperature (5°C to 35°C) at a distance of about 10 cm from the faucet or showerhead.
- If soiled, wash by hand without using a brush, etc., holding the product so that the back cover and USB cover do not open.

● After the product gets wet

- After becoming wet, drain water, and then without removing the back cover, wipe both the product and back cover with a dry, clean cloth.
- In cold regions, any water on the product may freeze. Using the product with frozen water may cause malfunction. Do not leave water drop on the product.

● Rubber seal

- The rubber seal around the back cover and USB cover is important in maintaining water resistance. Do not scratch or remove it.

- Be careful not to pinch the rubber seal when closing the back cover and USB cover. Trying to close the cover with a seal pinched can scratch the seal and affect water resistance. Any minute particles becoming lodged between contact surfaces (a single hair, etc.), no matter how small, can cause seepage.
- Any liquid other than water (alcohol, etc.) on the product can affect product durability.
- Do not insert pointed objects in the USB cover or back cover. Doing so may damage/deform the product or scratch the rubber seal, allowing water seepage.
- Parts used for maintaining water resistance should be replaced every 2 years regardless of their appearance. Contact your nearest au shop for replacement.

● Heat resistance

- Do not submerge the product in hot water or get it wet with hot water. Do not use the product in saunas or expose it to hot air from hair dryer, etc. The product is not designed to be heat resistant.

● Shock

- The product shock resistance assumes usage in daily situations; subjecting the product to excessive shock such as by throwing or causing/letting the product fall forcefully may break the product.

● In seawater/Underwater

- Check the following before using in seawater.
 - * Close the USB cover and back cover securely. Water resistance is effective when completely sealed.
 - * Any minute particles becoming lodged between contact surfaces (a single hair, etc.), no matter how small, can cause seepage.
 - * Make sure the back cover is locked.
- Check the following during and after use in seawater.
 - * Never open/close the USB cover or back cover when the product or your hands are wet.
 - * When opening the battery cover, open gently so as not to allow water to enter inside. If water contacts the inner surface of the back cover, always wipe away before using the product.
- Do not use the product in the water at approximately 20-kPa (maximum depth of 2.0 m) or deeper. Do not use in the water continuously for more than 60 minutes.
- The product sinks; use a strap, etc. and be careful not to drop in the water.
- Close the USB cover and back cover securely before using underwater.
- After using in seawater, open the USB cover and front cover, and wash the product using fresh water. At this time, never open the back cover.
- Never open the back cover while it is wet.
- Do not subject the product to shock in the water. Do not dive in water while holding the product, and do not subject to harsh water pressure of rapids, a waterfall, etc. Do not use the product in a way that subjects it directly to high-pressure water.

- Wash the product referring to "Cleaning" (►P.40).
 - * Always wash product after using or immersing in seawater, and completely dry before charging.
- Sunscreen or sun oil splashing on the product may discolor the surface of the product or cause a fault. If on product, immediately rinse.
- Touch panel cannot be operated underwater.

Precautions on Charging

Accessories and optional accessories are not water/dust resistant. Note the following before and after charging.

- Never charge the battery if the product is wet. Doing so may cause fire, burns, injuries, or electric shock.
- Make sure the product is not wet. If charging after the product has gotten wet, first drain water well and wipe with a dry, clean cloth, etc., before opening the USB cover, etc.
- If the USB cover was opened to charge, close the cover firmly after charging. To prevent water intrusion from the USB cover, it is recommended that a Wireless Charging Pad (sold separately) be used for charging.
- Do not touch the specified charger (sold separately) with wet hands. Doing so may cause electric shock.

- Do not expose the specified charger (sold separately) to water. Do not use it near water, such as in a bathroom, shower room, kitchen, or washroom. Doing so may cause fire, burns, electric shock, or malfunction. Do not bring it into a bathroom, etc. even when you are not charging with it. Doing so may cause fire, burns, electric shock, or malfunction.

Cleaning

If using the product where seawater or sand, mud, dust, and other foreign particles can get on it, continuing to use it without cleaning may cause a fault. Be sure to clean as follows.

- Turn off the power, and with the back cover attached, rinse the locations below (→) with mild flow (6 liters per minute).**

Sand or seawater remaining on rubber seals may affect water resistance. Keep buttons pressed while rinsing.

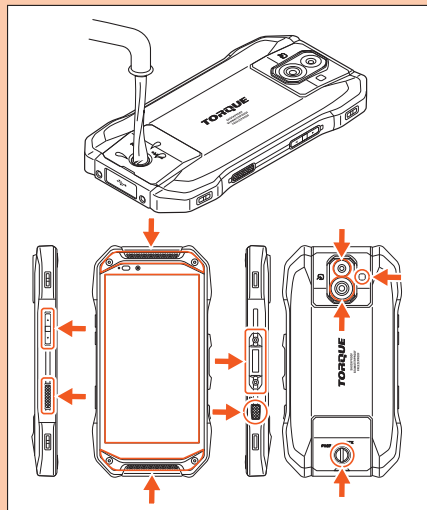

- Remove the front cover (▶ P.56), open the USB cover, and rinse mainly at the locations below (→). Rinse the front cover as well.**

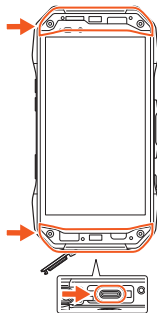
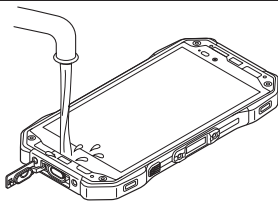

- 3** Wash the product by gently swishing it in a bowl with 5 cm of fresh water for 2 minutes. Rinse the front cover as well.

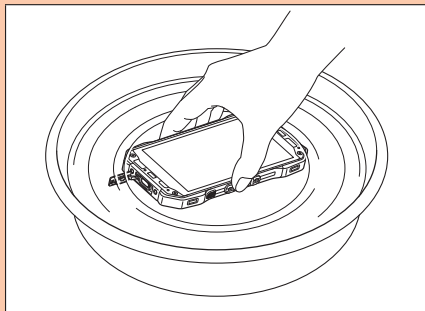

- 4** Wipe away water with a soft cloth, then lightly tap while holding terminal covers and wipe away any water. Lightly tap the speaker and atmospheric pressure sensor areas and wipe away any water.

If any water is in the atmospheric pressure sensor, it may not work properly.

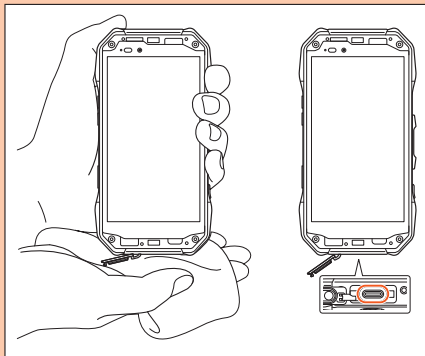

- 5** Drain water referring to "How to Drain Water" (▶P.42).
- 6** Dry adequately, check that no water is remaining in the connector areas, close the USB cover, and attach the front cover (▶P.55).



memo

◎ Dry the USB cover and the front cover adequately such as by leaving them in a well-ventilated, shaded place before closing the USB cover and attaching the front cover. Completely dry before charging the product.

How to Drain Water

If you use the product after it gets wet, be sure to drain water from the speaker, mouthpiece (microphone), and atmospheric pressure sensor. Water remaining in those parts might wet your clothes or bag, or the sound might become hard to hear.

Follow the steps below to drain water.

- 1** Wipe water thoroughly on the surface of the product with a clean dry lint-free cloth.

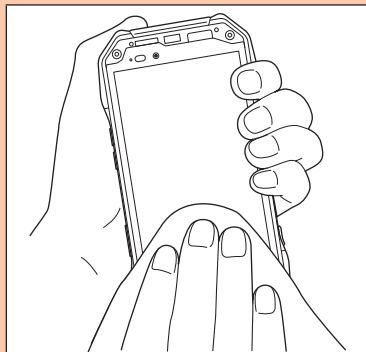

2 Shake the product.

① Hold the product firmly and shake it in the direction of arrows until water does not come out.

- * When shaking the product, stay alert to your surroundings.
- * Be careful not to have the product pop out, and hold it firmly to drain water.

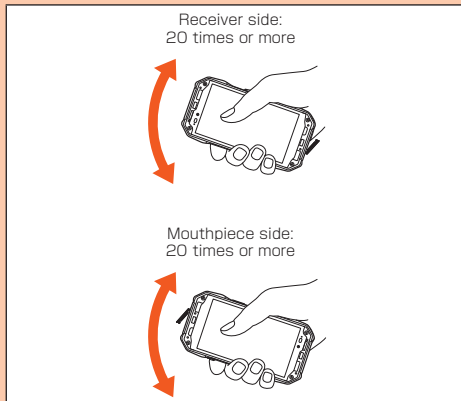

② Wipe drained water.

- * The mouthpiece (microphone), atmospheric pressure sensor, speaker, and external connection terminal, and buttons are particularly hard to drain water from. With those parts facing down, press them against the cloth to wipe off any water.

③ Place the product on a dry towel or cloth, then leave it at room temperature for a while.

③ Press the product gently against a clean dry lint-free cloth, and wipe off water remained in the gaps such as in the mouthpiece (microphone), speaker, atmospheric pressure sensor, etc.

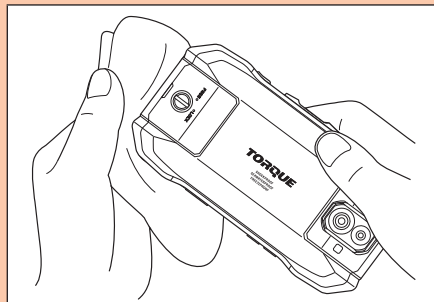

④ Leave the product for 1 hour or more at room temperature to dry after removing drained water thoroughly.

Even after you take these procedures, water may remain on the product. Do not place the product near things that you do not want to wet.

Also, take care not to wet your clothes, bag, etc.

Notes on Using Bluetooth® / Wireless LAN (Wi-Fi®) Function

- The Bluetooth® function of the product confirms to domestic standards of Japan, FCC standards, and have been certified.
- In some countries/regions, the use of the Bluetooth® function may be restricted. If you are using the product overseas, check the relevant laws and regulations of the country/region you visit.
- The wireless LAN (Wi-Fi®) function of the product confirms to domestic standards of Japan, FCC standards, and have been certified.
- In some countries/regions, the use of the wireless LAN (Wi-Fi®) function may be restricted. If you are using the product overseas, check the relevant laws and regulations of the country/region you visit.
- The 2.4 GHz band used by wireless LAN (Wi-Fi®) and Bluetooth® devices is operated by various other devices. For this reason, the communication speed and connectable range may be decreased, or disconnection may occur, due to interference from other devices.

- Do not use this product in places where electromagnetic waves are generated or near electric products, AV and OA equipment, or other magnetized devices.
- Subjecting this product to magnetic or electrical noise might increase noise and prevent it from performing communications. (This product is particularly susceptible to noise when used near a microwave oven.)
- Using this product near a TV, radio or similar appliance might cause reception interference and disrupt TV images.
- Searching might not be successful if there are multiple wireless LAN (Wi-Fi®) access points near the product or the same channel is being used.
- Since using the product on airplanes is restricted, follow the instructions given by the respective airlines.
- The communication speed and connectable range vary depending on the distance between communication devices, obstacles and the devices used.

IEEE802.11b/g/n

IEEE802.11a/n/ac

W52	W52	W53	W56
----------------	-----	-----	-----

Cautions on Using 2.4 GHz Band

The frequencies used by the Bluetooth® and/or wireless LAN (Wi-Fi®) functions of the product are in the 2.4 GHz band. In this frequency band, other similar wireless stations, in-plant wireless stations for mobile unit identification that require a license to use, such as factory production lines, specific small power wireless stations that do not require licenses, amateur wireless stations (collectively called "other wireless stations" from here on) are operated in addition to home electrical appliances such as microwave ovens, devices for industrial, scientific and medical devices.

1. Before using the product, make sure that "other wireless stations" are not in operation nearby.
2. In the event that instances of radio wave interference have occurred between the product and "other wireless stations", immediately either relocate the product or stop operation of the device (stop the emission of radio waves).
3. If unsure or require assistance, contact an au shop or Customer Center.



memo

- ◎ The connections between this product and all other Bluetooth® and wireless LAN (Wi-Fi®) devices have not been confirmed. Therefore, connections with all Bluetooth® and wireless LAN (Wi-Fi®) devices are not guaranteed.
- ◎ This product supports security features for wireless communications that are compliant with the Bluetooth® and wireless LAN (Wi-Fi®) standard specifications, but the security may not be sufficient depending on the usage environment and configuration. Be careful when making data communication using Bluetooth® or wireless LAN (Wi-Fi®) function.
- ◎ Wireless LAN (Wi-Fi®) has the advantage that it can be freely connected anywhere within the radio wave range, as it uses radio waves for exchanging information. At the same time, there is a risk that a malicious third party may obtain unauthorized access if security settings have not been configured. You are recommended to configure security settings before use at your decision and responsibility.
- ◎ The Company assumes no responsibility for leakage of data or information that may occur during Bluetooth®/wireless LAN (Wi-Fi®) communication.
- ◎ Since Bluetooth® and wireless LAN (Wi-Fi®) functions use the same frequency band, using the both functions at the same may cause radio wave interference resulting in decreased communication speed or disconnection from the network. If connection fails, stop using either of the Bluetooth® and Wireless LAN (Wi-Fi®) functions.

Bluetooth® and wireless LAN (Wi-Fi®) functions of the product use frequencies in the 2.4 GHz band.

• **Bluetooth® function: 2.4FH1/XX1**



This product uses the 2.4 GHz band. FH-SS is used as the modulation scheme. The interference distance is about 10 m or less.

The band of mobile unit identification devices cannot be avoided.

• **Wireless LAN (Wi-Fi®) Function: 2.4DS4/OF4**



This product uses the 2.4 GHz band. DS-SS and OFDM are used as the modulation schemes. The interference distance is about 40 m or less.

This means that all bandwidths are used, and that band of mobile unit identification devices can be avoided.

Available channels vary depending on countries. For use in an airplane, check with the airline company in advance.

Cautions on Using 5 GHz Band

Outdoor use of 5.2 GHz/5.3 GHz band (W52/W53) is prohibited under the Radio Law, except communications with a base station or a land mobile relay station for 5.2 GHz band high output power data communication system.

The used channels of the product are as follows.

- W52 (5.2GHz band / 36, 40, 44, 48ch)
- W53 (5.3GHz band / 52, 56, 60, 64ch)
- W56 (5.6GHz band / 100, 104, 108, 112, 116, 120, 124, 128, 132, 136, 140ch)

Security Code/PIN Code

Security Code

The product has various security codes that you can use.

The available security codes are as follows. Do not forget the various security codes that are set as they are necessary for various operations and contracts.

Be sure to change initial codes to your own codes before using the product.

● Security code

Example of usage	①To do remote operation of voice mail and call forwarding services from a fixed-line phone
	②To use Customer Center and to do various inquiries, applications, and modifications on the au homepage
Initial value	A four-digit number chosen by the customer and noted on the application form

● Security setting for the start screen

Example of usage	To enable/disable the security setting
Initial value	Follow initial default settings.

● Password ("NFC/Osaifu-Keitai Lock")

Example of usage	To use "NFC/Osaifu-Keitai Lock"
Initial value	1234

PIN Code

■ PIN code

To prevent unauthorized use of the au IC card by a third party, you can set the product to require PIN code entry every time the power is turned on. You also need to enter PIN code when setting whether PIN code entry is required.

If PIN code is incorrectly entered three times consecutively, the PIN code will be locked. You can unlock the PIN code using PUK code.

- At the time of purchase, the PIN code is "1234", and entry is not required. You can change the PIN code to any 4- to 8-digit number and the product to require entry if necessary.
- To use the product with a PIN code required, be sure to change the PIN code to your own number you have chosen.

■ PUK Code

In case PIN code is locked, you can unlock it by entering PUK code.

- PUK code is an 8-digit number given at the time of purchase, which is printed on the back side of the plastic card on which your au IC card is attached.
- After entering PUK code, you need to set a new PIN code.

- If PUK code is incorrectly entered ten times consecutively, contact an au shop, TOYOTA store dealing in au, or Customer Center.
- PIN code is not reset by initializing the product.

<Please copy this section and use>

[Password entry field]	
Google account ID	Security (start screen) Lock: Lock No.
<input type="text" value="@gmail.com"/>	<input type="text"/>
Google account password	Security (start screen) Lock: Password
<input type="password"/>	<input type="password"/>
au ID	Security (start screen) Lock: Pattern
<input type="text"/>	
au ID password	
<input type="password"/>	
Facebook account ID	
<input type="text"/>	
Facebook account password	
<input type="password"/>	

- * Strictly manage your account and password to prevent a third party from obtaining them.

Notes on Data Communication Charges

- Since constant Internet connection is possible with the product, data communication may be performed automatically by some applications, resulting in high data communication charges. Therefore, subscription to a data flat-rate service/ data communication charge discount service is recommended.
- Connection for browsing homepages, downloading applications, communication using applications, sending/receiving e-mails and configuring various settings is by the Internet, and data communication charge applies.
 - * Data communication charge does not apply to wireless LAN (Wi-Fi[®]) connection.

Notes on Applications

- Be sure to check the security of the application, then install it at your own risk. Some applications may affect the operation of other applications or the whole operation of the product. Some applications might cause virus infection, damage various data, and send out your location information, usage history or personal information stored in your cell phone via the Internet.
- The Company assumes no responsibility for any problems that might be caused by applications you have installed. In such case, you may be charged a repair fee even during the warranty period.
- The Company assumes no responsibility for any disadvantage brought to you or any third party by applications you have installed.
- Some applications require that a microSD memory card be inserted.
- Some applications prevent the screen from entering sleep mode while they are active, or rapidly drain the battery while running in the background.
- Changes to method of operation or to screen display may occur without notice due to version upgrades of applications installed on the product. Note that there may be differences with descriptions in this manual.

Setting the App Permissions

The first time you launch an app/function that accesses the functions or information of the product, a confirmation screen for requesting access permission appears.

If the confirmation screen appears, confirm the content and operate.

Example: File Commander is activated for the first time

1 Apps permission confirmation screen → [DENY] / [ALLOW]

in normal cases to allow the use of the function. Repeat the same operations to allow the use of multiple functions.

Setting Permissions for Individual App/Function

■ Setting permissions for individual app

1 Home screen → → [Settings] → [Apps & notifications]

2 [See all (number of apps) apps] select an app → [Permissions] → set the function

■ Setting permissions for individual function

1 Home screen → [App icon] → [Settings] → [Apps & notifications]

2 [App permissions] → select a function → set the app



memo

- If you do not permit, app/function may not be activated or use of function may be limited.
- For some apps/functions, an explanation screen for the permission appears. The confirmation screen may also appear multiple times, or the display may differ. Confirm the displayed content and follow the onscreen instructions.
- In this manual, description of confirmation screens may be omitted.

Cell Phone Etiquette

■ Use of Cell Phones is Not Allowed in the Following Places!

- Do not listen to music, watch videos while driving a car or motorbike, or riding a bicycle. Use of cell phones while driving a car or motorbike is prohibited by law. (Use of cell phones while riding a bicycle may also be punishable by law.) In addition, stay alert to the traffic around you even when walking. Surrounding sounds might not be heard clearly, and gazing at the screen may distract your attention causing a traffic accident. Be especially careful at railroad crossings, station platforms and pedestrian crossings.
- Since using the product on airplanes is restricted, follow the instructions given by the respective airlines.

■ Be Considerate of People Around You

- Do not make calls in theaters, museums, libraries, and other similar places. Turn power off or turn on manner mode so as not to disturb others around you with your ringtones.
 - In a city area, use in a place where you do not bother people walking.
 - It is extremely dangerous to walk while looking at the screen of the cell phone. Do not suddenly stop to talk on/operate the cell phone or do so while walking.
 - Move to a place where you do not disturb others while you are in shinkansen, a hotel lobby, etc.
 - Be careful not to be loud while talking.
 - Be careful of sound leakage from earphones in trains or other places with many people around you.
 - Ask permission if you take photos with your cell phone camera.
 - When using the camera, follow common rules of etiquette regarding camera use.
 - There may be a person with a cardiac pacemaker nearby at a place filled with people such as in a crowded train. Turn on "Airplane mode" or turn the cell phone off in such places.
- When a medical institution has laid down designated areas where use of the product is prohibited or is not allowed to be brought in, abide by the instructions of that medical institution.

Getting Ready

Names and Functions of Parts

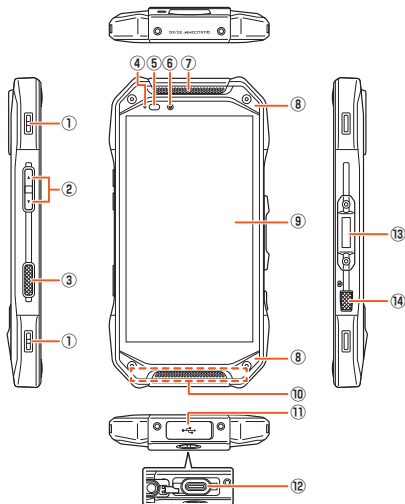

① Strap eyelet

② ◀ ▶ Volume up/down button

Adjust media sound volume such as music or videos.

③ [Grid Icon] Direct button

Press and hold to activate the set function.

④ Incoming (charging) lamp

Lights in red during charging.

Flashes in green for a missed call or new mail.

⑤ Proximity sensor/Light sensor

If the display becomes covered during a call, the proximity sensor turns the display off to prevent erroneous touch panel operation.

Light sensor detects the ambient light level to adjust the display brightness.

⑥ In camera (lens)

⑦ Receiver/speaker

Hear the other party's voice on call, playback sound of the auto answering, etc.

⑧ Front cover

Remove when performing maintenance or replacing the front screen.

"Attaching/Removing the Front Cover" (▶ P.55)

⑨ Display (touch panel)

10 Mouthpiece (microphone)/atmospheric pressure sensor/speaker

Relays your voice to the other party. Or used to record voice sound. Take care not to cover the mouthpiece (microphone) with your fingers, etc. during calling or video recording.

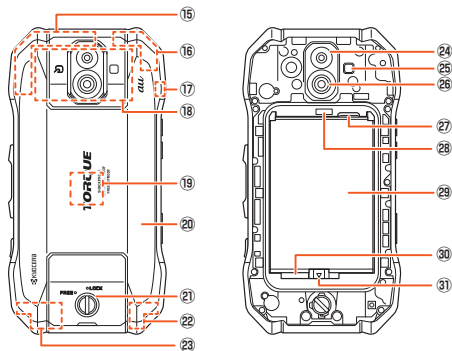

11 USB cover

The opening in the cover is a necessary part of its waterproof construction. Do not poke with a pointed object or block it.

12 External connection terminal

Used to connect Type-C Common AC Adapter O2 (sold separately), etc.

13 Power button / fingerprint sensor

Use to turn on/off, activate/deactivate the sleep mode.

If a fingerprint is registered, unlock the screen by fingerprint authentication.

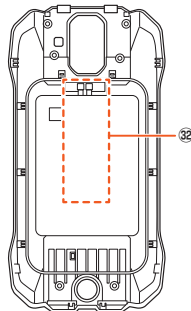

Back cover (rear)

14 Camera button

Press and hold to activate the camera. Also use as shutter for still photos and underwater camera screen.

15 Built-in sub antenna*1

16 Built-in GPS antenna*1

17 Built-in Bluetooth®/Wi-Fi® antenna*1

- 18 **NFC (FeliCa compatible) antenna**^{*1}
Hold over a reader/writer when using Osaifu-Keitai®.
Send or receive data via IC transmission.
- 19 **Wireless charging area**^{*1}
For wireless charging, place the "R" letter of "TORQUE" logo on the  mark on a separately-sold wireless charging pad.
- 20 **Back cover**^{*2}
- 21 **Lock knob**
- 22 **Built-in WiMAX 2+ antenna**^{*1}
- 23 **Built-in main antenna**^{*1}
- 24 **Out camera (lens)**
- 25 **Shooting/simple light**
- 26 **Wide camera (lens)**
- 27 **au Nano IC Card O4 slot**
- 28 **Wireless charging antenna connection terminal**
- 29 **Battery pack**
Under the battery back, au Nano IC Card O4 slot and microSD memory card slot are found.
- 30 **microSD memory card slot**
- 31 **Battery lock**
- 32 **Wireless charging antenna/charging connection area**

^{*1} Do not cover antennas with your hand or put stickers etc. Doing so may affect calling/communication quality or wireless charging.

- ^{*2} Avoid adhering stickers, etc. on the back cover where the wireless charging antenna/charging connection area are located. Doing so may affect wireless charging.



memo

- ◎ Do not put stickers, etc. on the proximity sensor/light sensor.
- ◎ Product is equipped with an atmospheric pressure sensor. You can display barometric pressure and elevation when using a barometric display app, however, values are not absolute due to a number of variables, and are approximate only.
- ◎ Do not remove the film sheet from the mouthpiece (microphone)/atmospheric pressure sensor/speaker.
- ◎ A front screen is adhered to the product to protect the display (touch panel). If the screen becomes damaged or worn, it can be replaced with the front screen (KYV46KGA) (sold separately).

Incoming Lamp/Charging Lamp

Lighting/blinking of the incoming/charging light notifies you the charging status, missed calls, or new mail, etc.

LED Color and Functioning	Notification
Lighting-up in red	Indicates that the product is in charging.
Lighting-up in green	Indicates that the charging is complete.
Blinking in green	Indicates missed calls or notification messages.

Attaching/Removing the Front Cover

Remove the front cover when performing maintenance or replacing the front screen. Do not remove in any other circumstances.

Attaching the Front Cover

- 1 Use the hexagon wrench (sample) to turn the four screws where circled ○ in the direction of arrows**

Avoid tightening more than necessary. Doing so may cause damage.

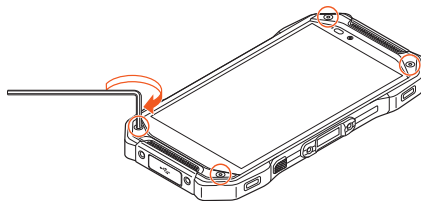

Removing the Front Cover

- 1 Use the hexagon wrench (sample) to turn the four screws where circled ○ in the direction of arrows

The non-loss screws are designed to remain installed on the front cover. Remove the front cover with the screws attached.

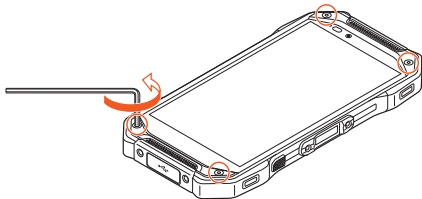

Attaching/Removing the Battery Pack

Attach/remove the battery pack after turning off the product.

- Use the specified battery pack of the product.

Attaching the Battery Pack

- 1 Use the LOCK Rotating Tool (sample) to turn the lock to "FREE"

LOCK Rotating Tool (sample)

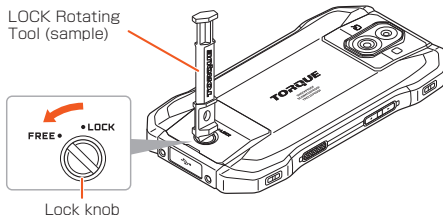

2 Remove the back cover on the rear side of the product

Lift the back cover by the center notch of the cover using fingertips (fingernail, etc.) in the direction of the arrow to remove.

- Remove the cover while releasing the tabs on the back side of the back cover.

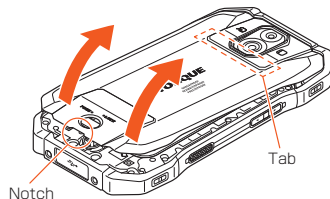

3 Slide the battery lock to the (open) direction

The battery lock is unlocked.

- The battery pack can be attached only when the battery lock is unlocked.

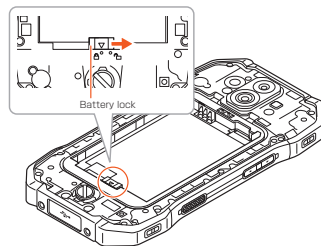

4 Attach the battery pack

Confirm the position of connection, and then slide the battery pack in and press it firmly into place.

- Install the battery pack after confirming the au IC card or microSD memory card is properly inserted.

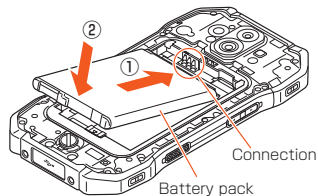

5 Slide the battery lock to the (close) direction

The battery lock is locked and the battery pack is fixed.

- The battery lock can be slid to the  (close) direction only when the microSD memory card is inserted to the rear end.

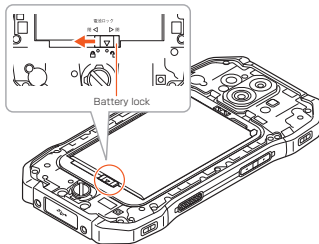

6 Attach the back cover

Insert the back cover diagonally from the two claws on the edge of the back cover (①), and then push the bottom end of the back cover (②) to fit it.

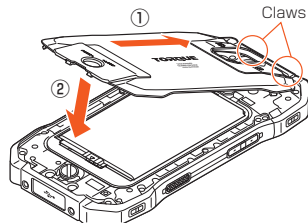

7 Press the back cover where shown by the arrows making sure the cover is pressed down completely around

- The back cover can be closed only when the battery lock is locked.

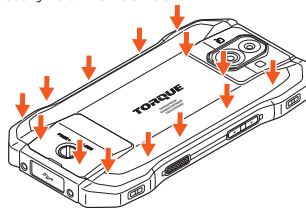

8 Use the LOCK Rotating Tool (sample) to turn the lock to "LOCK"

Avoid tightening more than necessary. Doing so may cause damage.

- The lock knob can be turned to "LOCK" only when the battery lock is locked.

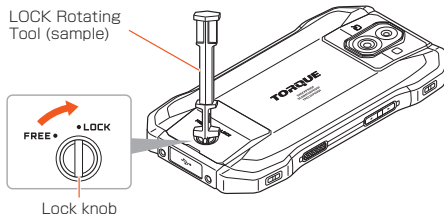

memo

- ◎ Attaching incorrectly may cause damage to the battery pack.

Removing the Battery Pack

1 Remove the back cover (▶P.56)

2 Slide the battery lock to the (open) direction

The battery lock is unlocked and the battery pack is also released.

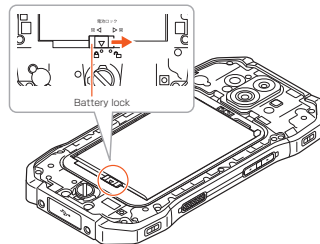

3 Remove the battery pack

Use one hand to catch the battery pack as shown, and tap the product while bringing hands together to remove.

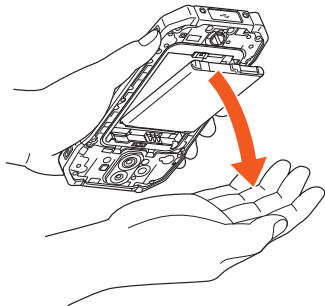

4 Slide the battery lock to the (close) direction, and attach the back cover (▶P.56)



memo

- Do not use a screwdriver, etc. to remove the battery pack. Doing so may damage the battery pack.

au IC Card (SIM Card)

The au IC card contains your phone number and other information.

The product is compatible with au Nano IC Card 04.

au Nano IC Card 04

(Back)



(Front)



IC (metal) part



memo

- Note that mishandling au IC card might cause malfunction or damage. Remember the following points.
 - Do not touch the IC (metal) part of the au IC card.
 - Check the correct insert direction.
 - Do not forcefully attach/remove the card.
- If the au IC card is not attached correctly or the au IC card has any abnormality, an error message is displayed.
- Do not lose the removed au IC card.
- Do not insert your au IC card with a conversion adapter attached. Doing so may cause malfunction.

When au IC Card is Not Inserted

When au IC Card is not inserted, the following operations are not available.

- Making*/Receiving a call
- Sending/receiving SMS
- Sending/receiving +Message
- Initial setting and sending/receiving of au-mail
- PIN code setting
- Checking your phone number and e-mail address of the product

Besides the items above, functions that require your phone number may also be unavailable.

* Emergency calls such as 110 (Police), 119 (Fire/Ambulance), 118 (Maritime rescue) are also unavailable. However, only emergency calls may be available in overseas. (Emergency call numbers differ depending on the countries/regions.)

PIN Code Limit Settings

To protect your personal information, you can limit unauthorized use of the au IC card by a third party by changing PIN code or locking SIM card (►P.47 "PIN Code")

Attaching/Removing au IC Card

Attach/remove the au IC card after turning off the product.

Attaching au IC Card

1 Turn the power off and remove the battery pack (►P.59 "Removing the Battery Pack")

2 Check the correct insert direction, and slowly insert the au IC card straight until it clicks

Note the orientations of the notch and IC (metal) surface.

Make sure that the au IC card clicks and is locked when inserting it. The au IC card may fly out if you release your finger before the au IC card is locked. Be careful not to let the au IC card come off.

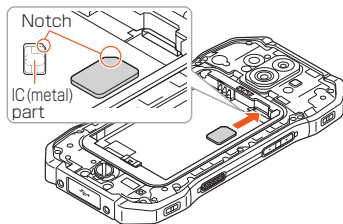

- 3 Install the battery pack and back cover (►P.56)**

Removing au IC Card

- 1 Turn the power off and remove the battery pack (►P.59 "Removing the Battery Pack")**
- 2 Push the au IC in the direction of arrow**

Pushing the au IC card until you hear a click, the au IC card comes out.

- Keep your fingers on while the au IC card slightly comes out. Be aware that the card may fly out if you release your finger while pressing hard.

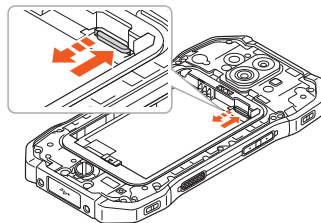

- 3 Slowly pull the au IC card**

Slowly pull out the card as straight as possible.

- Depending on the card, it is difficult to pull out from the slot due to the failure of unlocking. In that case, remove the card by pulling lightly with your fingers.

- 4 Install the battery pack and back cover (►P.56)**

Attaching/Removing microSD Memory Card

Attaching microSD Memory Card

- 1 Turn the power off and remove the battery pack (►P.59 "Removing the Battery Pack")
- 2 Confirm the direction of the microSD memory card and slowly insert it into the slot straight

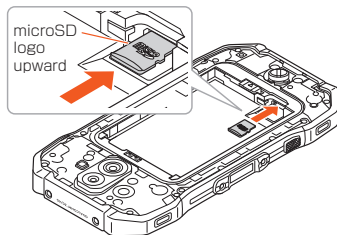

- 3 Install the battery pack and back cover (►P.56)



memo

- ◎ Make sure that the top/bottom and front/rear of the microSD memory card are facing correctly. Trying to force a wrongly oriented card into the slot could make it impossible to remove the card or result in damage.

Removing microSD Memory Card

- 1 Turn the power off and remove the battery pack (►P.59 "Removing the Battery Pack")
- 2 Slowly pull the microSD memory card in the direction of arrow

Slowly slide and pull out the card as straight as possible.

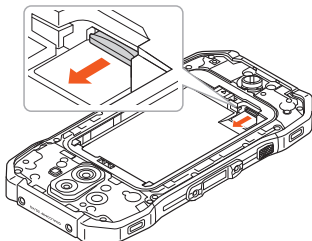

3 Install the battery pack and back cover (►P.56)

memo

- Do not touch the terminal part of a microSD memory card.
- Be careful not to pull out the microSD memory card forcefully. Doing so may cause malfunction or data erasure.
- After using the product for a long time, the removed microSD memory card may become warm. This is not a malfunction.

Charging

The battery pack is not fully charged at the time of purchase. Charge the battery sufficiently before use. When charging is complete, the charging light that lights up in red turns into green.

memo

- The specified charger (sold separately) is not water proof. Never charge the battery if the product is wet.
- The product may become warm while charging, this is not abnormal.
- When temperature of environment or the product is extremely high or low, charging may be stopped. Charge the battery at room temperature as much as possible.
- Charging the product while using the camera function, etc., the charging time may take longer than usual.
- Handle the battery pack after carefully reading "Safety Precautions (Observe Strictly)" (►P.10).
- When you operate the product with the specified charger (sold separately) connected, the product may repeat short-time charging/discharging resulting in short battery life.

- ◎ Make sure that the battery pack is correctly attached and connection is correct if the charging lamp of the product blinks in red. If the indicator keeps blinking, stop charging and then contact an au shop or Repair and Delivery Support Center.
- ◎ Close the USB cover firmly after charging to prevent moisture and dust from entering. Do not pull or twist forcefully.
- ◎ Do not wirelessly charge while the specified charger (sold separately) or USB Type-C cable (commercially available) is connected to the product. The product will not charge properly, and it may also cause malfunctioning.
- ◎ Keep a metal accessory or conductive materials (metal pieces, pencil lead, etc.) from coming in contact with the connection terminal and prevent them from getting inside.
- ◎ A magnetic field created by current during charging may affect the geomagnetic sensor.

Charging with the Specified AC Adapter

How to charge the product using Type-C Common AC Adapter 02 (sold separately) is described here. For details on the specified AC adapter (sold separately), see "Related Accessories" (▶P.91).

1 Insert the power plug of Type-C Common AC Adapter 02 (sold separately) into an outlet (100 to 240 VAC)

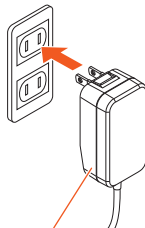

Type-C Common AC Adapter 02
(sold separately)

2 Open the USB cover of the product

- 3** Insert the USB Type-C plug of Type-C Common AC Adapter 02 (sold separately) straight into the external connection terminal

The USB Type-C plug is reversible and can be inserted to the terminal which side is up. Make sure that the charging light lights up in red. When the product is turned on, "1" appears on the status bar. When charging is complete, the charging lamp turns into green.

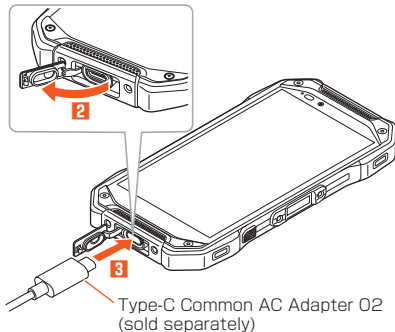

- 4** When charging is complete, pull out the USB Type-C plug of Type-C Common AC Adapter 02 (sold separately) straight from the external connection terminal
- 5** Close the USB cover
- 6** Unplug the power plug of Type-C Common AC Adapter 02 (sold separately) from the outlet



memo

- ◎ Note that applying unnecessary force with an external device connected to the external connection terminal may cause damage.
- ◎ When the battery is charged in the case it has run out, charging light may not light up soon, but charging is started.

Charging with the Wireless Charging Pad

How to use the Wireless Charging Pad 02 (sold separately) for charging is explained here. For usage precautions and details, also see the instructions included with the Wireless Charging Pad 02 (sold separately).



Simply placing the product on top of an au-specified wireless charger product (sold separately) displaying the mark on the left allows charging without the need to connect a cable. Be sure to also read the instructions for any supported product. Products with the mark are compliant with the wireless charging specifications of the Wireless Power Consortium (WPC).

おくだけ
充電

This product supports "おくだけ充電[®]" (okudake juden)" place-and-charge functionality. "おくだけ充電" and the "おくだけ充電" logo are registered trademarks of NTT DOCOMO, INC.

- 1** Connect the microUSB connector of an AC adapter (sold separately) compatible with the Wireless Charging Pad 02 (sold separately) to its microUSB jack, and plug the compatible AC adapter (sold separately) into an outlet (100V - 240V AC)

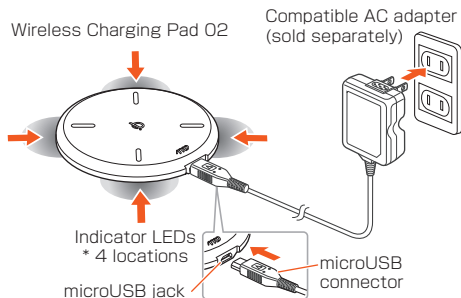

- 2 With the wireless charging area on the back of the product downward, place the product so that the "R" of the "TORQUE" logo comes in contact with the Φ mark on the Wireless Charging Pad 02 (sold separately)**

The indicator LEDs flash in blue; after about 12 seconds, check that they remain lit and that the charging light on the product is lit red. If the indicator LEDs still flash blue after about 12 seconds, the product is not positioned where it can charge. Adjust the position of the product.

When charging is complete, the charging light turns into green.

* The indicator LEDs on the Wireless Charging Pad 02 (sold separately) will remain lit blue after charging with this product. For further information on lighting and charging conditions of the indicator LEDs, read the instructions that come with the Wireless Charging Pad 02 (sold separately).

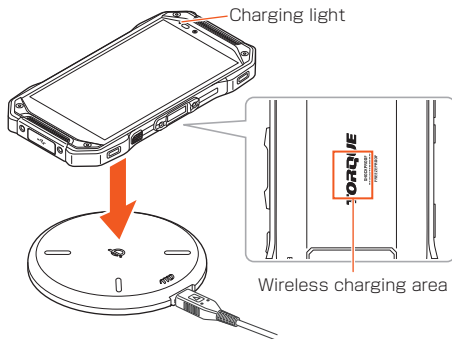

- 3 After charging, remove the product, and unplug the compatible AC adapter (sold separately) from the outlet**



- ◎ If you move the product from its position after the indicator LEDs have already lit blue, the product may not charge or may take a long time to charge. Remove the product, wait about 15 seconds, and place again where the indicator LEDs light blue.
- ◎ If charging does not start, check that the back cover is properly attached. Also check that the charging connection under the back cover is not soiled.
- ◎ Charging is controlled at a reduced rate during wireless charging to prolong the life of the battery pack.

Turning the Power On/Off

Turning the Power On

1 Press and hold (Power button) until the incoming light turns on

The start screen is displayed. (►P.71).

- For the first time you turn on the product, the initial setting activates. Configure the settings as necessary. For details, refer to "Initial Settings" in the packaged "Setting Guide".



- ◎ When logos are being displayed on the screen, do not touch the screen because the initial setting of the touch panel activates. Doing so may prevent the touch panel from working properly.
- ◎ If you skip the operation of the initial settings at the first start-up, you can set later.

Turning the Power Off

- 1 Press and hold  (Power button) for at least 1 second
- 2 [Power off]

Forcing the Product to Shut Down and Restart

You can force the product to power off and reboot when the screen does not respond, or the power cannot be turned off.

- 1 Hold down  (Power button) and  (Volume up button) at the same time for at least 11 seconds



memo

◎ If you turn off the product forcibly and restart, an unsaved data will be lost. Do not perform except when the product does not respond.

Switching to English Display

You can switch the language displayed on the screen to English.

- 1 Home screen →  → [設定 (Settings)] → [システム (System)] → [言語と入力 (Languages & input)] → [言語 (Languages)]

2 [English]

The message "起動中のアプリ、メール送受信、ダウンロードなどが終了される場合があります。"

(Applications, mail transmission/reception, and downloads may be terminated.) appears, confirm the message and then tap [OK].

Start Screen

The start screen is displayed when the product is turned on or the sleep mode is deactivated.

Switching to the Home Screen from the Start Screen

When the start screen is displayed, you can display the home screen by the following operation.

1 Slide/flick "📷" to the "START" direction

The home screen is displayed (▶P.72). Or the previous screen before the sleep mode is activated is displayed.

- Slide/flick toward "CAMERA"/"PHONE" to activate camera/phone (▶P.81).



① Clock

② Notifications

- Displays notifications such as a missing call.
- Double-tap a notification to activate notifying application.

③ START icon



memo

- ◎ Alternatively, tap [📷] → [START]/[CAMERA]/[PHONE] to display the home screen or activate the camera/phone.

Sleep Mode

If you press [🔌] (Power button) while the backlight of the display is turned on, or no operation is performed for a certain period, the product enters sleep mode. You can cancel sleep mode by the following operation.

1 In sleep mode, press [🔌] (Power button)

The start screen is displayed. (▶P.71).



memo

- ◎ To change the time to enter sleep mode, home screen → [⌘] → [Settings] → [Display] → [Sleep], and select the time.
- ◎ When you press [🔌] (Power button) to display the screen in sleep mode, do not touch the screen. Doing so may prevent the touch panel from working properly.

Basic Operations

Using the Home Screen

The home screen consists of multiple screens. Slide/flick right or left to switch them.

- ① Status bar
- ② Shortcut/folder
- ③ Quick start area
- ④ Apps icons



《Home Screen》

Activating the Apps

Some functions activated by tapping app icons may incur communication charges.

1 Home screen → [App Icon]

The list of applications is displayed.

- Also, swipe the bottom of the home screen upward to display the app list.

2 Tap the app to activate

- If you tapped a folder, tap the app to activate from the app list in the folder.

Switching the Home App

If you installed a home app, you can switch the home app of the product.

- #### 1 Home screen → [App Icon] → [Settings] → [Apps & notifications] → [Default apps] → [Home app] → select the home app

Monitoring the Product's Status

Viewing Icons

Notification icons for missed calls, new mail, running operations, etc. are displayed on the left of the status bar, and status icons for product status are displayed on the right.























Main Notification Icons

Icon	Description
	Time
	Missed call
	New +Message/New SMS
	New e-mail message (au-mail)
	New e-mail message (Gmail)
	Emergency rapid mail
	Snooze alarm or alarm ended without canceling
	Notification of calendar
	During calling or receiving a call
	Auto answering exists
	Audio notification for Outdoor Portal enabled
	Internal memory low

Icon	Description
	File receiving request from other Bluetooth® device
	Send/upload data
	Receive/download data
	Installed completely
	Notification of updating installed apps
	Software update
	Screenshot completed
	USB tethering
	Bluetooth® tethering
	Bluetooth® tethering is used with USB tethering
	microSD memory card is mounted

Main Status Icons

Icon	Description
	Battery level
	100%/ Empty/ Charging/
	Battery care mode ON

Icon	Description
4G 	Signal strength/Signal condition (LTE/WiMAX 2+)  Level 4/  Out of service area/  In communication 4G  LTE/WiMAX 2+ available*  roaming (communication mode according to the network is also shown.)
	Airplane mode is set
	Wi-Fi® signal strength  Level 4/  Level 0
	Alarm setting
	Manner mode ON  Vibration ON/  Mute ON/  Drive mode ON
	Connecting with Bluetooth® device
	Auto answering set  Auto answering: Set/  Full
	VPN connection
	GPS in use
	Data saver set
	Wi-Fi® tethering

* The 2 networks, "LTE" and "WiMAX 2+", are available in Japan. In any case of the screen display is "4G". The Company determines the network less congested to connect due to busy network conditions.

Notification Panel

In the notification panel, you can check notifications and activate apps. Also, ON/OFF setting icons appear and the frequently used functions can be set immediately.

1 Slide down the status bar

The notification panel is displayed.

- Tap  to disable the notification panel.



memo

- ◎ Also, slide up the notification panel to disable the notification panel.
- ◎ To delete notifications individually, flick the notifications left/right to delete. Tap "CLEAR ALL" on the bottom right of the screen to delete all the notifications. Some notifications cannot be deleted.

Setting Silent Mode

Set the silent mode so as not to disturb others around you in public places.

1 Press ◀ (Volume up button) or ▶ (Volume down button)

The silent mode icon and sound volume adjustment bar is displayed.

2 Tap the silent mode icon to switch the silent mode type

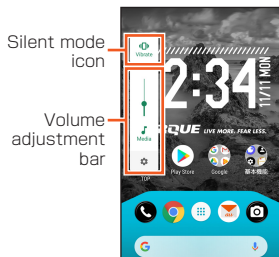

Silent mode type is switched as follows every time you tap the silent mode icon.

- 🔔: Silent mode OFF
- 🔇: Silent mode (vibration)
- 🚫: Silent mode (mute)
- 🚗: Driver mode

memo

- ◎ Using the sound volume adjustment bar, you can adjust media sound volume such as music or videos. Also, tap "⚙️" to display the sound setting screen to specify the detailed sound settings.
- ◎ Even in the silent mode, the shutter clicks for photos. Also during movie shooting, start/stop and timer beeps sound.
- ◎ By selecting "Drive", a guidance is played to notify the caller that you are driving a car when receiving a call and auto answering activates automatically.
- ◎ While data is played in the muting state in the silent mode, press ◀ (Volume up button)/▶ (Volume down button) to adjust the volume.

Setting Airplane Mode

When airplane mode is set to ON, all the wireless functions (telephone, data communication, wireless LAN (Wi-Fi[®]) function, and Bluetooth[®] function) are disabled.

1 Slide down the status bar → [Airplane mode]

When the airplane mode is set to ON, "✈" is displayed in the status bar.

- Alternatively, from home screen →  → [Settings] → [Network & internet] → set "Airplane mode" to "ON" to enable airplane mode.



memo

- ◎ Even if the airplane mode is set to ON, the wireless LAN (Wi-Fi[®])/Bluetooth[®] function can be set to ON. Using the product on airplanes or in hospitals may be restricted, follow the instructions given by the respective airlines and institutions.
- ◎ When the airplane mode is set to ON, the telephone function (calling) is disabled. Even if the airplane mode is set, you can call 110 (Police), 119 (Fire/Ambulance), 118 (Maritime rescue). After making a call, the airplane mode is automatically set to OFF.
- ◎ When the airplane mode is set to ON, the telephone function (receiving) is disabled. Sending/receiving mail, wireless LAN (Wi-Fi[®]) function, and communication using Bluetooth[®] function are also disabled.

Checking Your Phone Number

- 1 Home screen →  → [Settings] → [Profile]

The profile screen is displayed.

Using the Fingerprint Function

The product is equipped with a fingerprint sensor () for fingerprint authentication, which allows you to unlock the screen by touching the sensor with your registered finger.

- For precautions on using fingerprint authentication and using fingerprint sensor, see "取扱説明書 詳細版 (Full Instruction Manual)" (Japanese) available on the au homepage.

Registering Fingerprints

- 1 Home screen →  → [Settings] → [Security & location] → [Fingerprint]

- To additionally register a fingerprint, from the home screen →  → [Settings] → [Security & location] → [Fingerprint] → deactivate the security → [Add fingerprint].

- 2 [NEXT]

From here on, follow the on-screen instructions.

Authenticating with Fingerprints

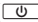

- 1 While the start screen is displayed, touch the fingerprint sensor () with the registered finger

By sliding/flicking  on the start screen, a screen to enter the specified unlocking method of screen lock is displayed.



- ◎ If your fingerprint is not recognized five times successively, you can no longer authenticate. Wait for a while and try again, or slide/flick  and enter the specified unlocking method of screen lock.

Displaying Menu

There are two types of methods to display a menu screen: by tapping "" or "", and by long-touching the entry field or item.

Setting Home Screen

Set various displays of the home screen.

- 1 Home screen → long-touch an empty space → [Home settings]

The home settings screen is displayed.

2	Notification dots	Set whether to display notification dots on the app icons.
	Add icon to Home screen	Set whether add the icon on the home screen when a new app is downloaded.
	Left side of the main home screen	Set the display that appears when the home screen is slid/flicked to the right.
	Order of the apps list	Set the display order of the apps on the app list.

- 3 Set each item

Saving Battery Consumption

You can extend the battery life without fully charging the battery.

- 1 **Home screen** →  → **[Settings]** → **[Battery]** → **[Battery care mode]** → **[ON]**

When the battery care mode is set, the heart mark  is attached to the battery icon on the status bar.



memo

- ◎ Charging stops at 85% when the battery care mode is set to ON. The battery usable time becomes short on one charge.
- ◎ When the battery care mode is set to ON at 86% or more, charging does not start until charging decreases to 85%.

Charging Other Mobile Devices

You can charge mobile devices that are compatible with USB PD standard by using the product and USB Type-C cable (sold separately).

- 1 **Insert the USB Type-C cable (commercially available) with the other mobile device connected straight into the external connection terminal of the product**
- 2 **Home screen** →  → **[Settings]** → **[Connected devices]** → **[USB]**
- 3 **Set "Charge connected device" to ON**
The connected mobile device is charged.
 - When charging the product using other mobile device, set "Charge connected device" to OFF.



memo

- ◎ Use a USB Type-C cable that is compatible with USB PD (Power Delivery) (sold separately).
- ◎ Charging may not be possible when the battery level of the product is low. Charge the product before using this function.
- ◎ Charging may not be possible when a long cable is used. Also, charging may not be possible via a hub or a conversion connector.
- ◎ Connected devices that are not compatible with USB PD standard cannot be charged. Charging all the USB PD compatible devices is not guaranteed.

Telephone

Making a Call

- 1 Home screen → [📞] → tap "DIALPAD" tab

The phone number input screen is displayed.

- 2 Enter a phone number

When calling to fixed-line phones, enter the area code first even if the recipient is in the same city.

- 3 [📞] → talk → [📞]

Press ◀ (Volume up button)/ ▶ (Volume down button) during a call to adjust volume (other party's voice).



memo

- If you cover the screen by your face etc. while dialing/calling, the display turns off to prevent false operation.
- Note that even if you cover the mouthpiece (microphone), the sound can be conveyed to the other party.

Receiving a Call

- 1 Incoming call panel on the top of the screen → [ANSWER]

The call starts.

- You can also answer the call by sliding [📞 Answer] to the right during sleep mode or when the start screen is displayed.

- 2 Talk → [📞]

Making a Call from Contacts

- 1 Contacts list screen → tap the contact

The details screen of the contact is displayed.

- 2 [📞]

Appendix

Updating Software

You can update the product to the most recent software for optimal performance and to get the latest enhancements.

■ Notes on Software Update

- You are charged for data communication when connecting to the Internet from the product using data communication. Data communication takes place in large amounts especially for updating the OS. Use of Wi-Fi® is recommended.
- When software update is necessary, you will be informed on the au homepage, etc. For details, contact an au shop or Customer Center (call toll-free 157). In addition, users of the product will receive a notice from au, when software update is necessary to improve the functionality of the product.
- It is recommended to back up your data before updating software.
- If software update has failed or stopped, perform the same procedure again.
- If the software update fails, it may become impossible to operate the product. If this

happens, bring it to an au shop or TOYOTA store dealing in au (not accepted by some shops).

- When using the product overseas, the software update functions may not be available.
- Any operations are not available during software update. Calling 110 (Police), 119 (Fire/Ambulance), 118 (Maritime rescue) and 157 (Customer Center) is not available. Alarm does not work, either.

Downloading Software into the Product to Update

Downloading updated software via the Internet directly from the product is available.

1 Home screen → → [Settings] → [System] → [System update]

From here on, follow the on-screen instructions.



memo

- ◎ Note that depending on the terms of your subscription contract, communication charges may be incurred for the product to automatically search for available networks.
- ◎ After a software/OS update, the product cannot revert to the previous version software.

Troubleshooting

Before you assume that the product is malfunctioning, check for possible remedies in "クイック診断 (Quick check)" and "トラブル診断 (Trouble check)" on "故障紛失サポート (Repair and Delivery Support)" app.

■ Quick check

Home screen → [📱] → [サポート (Support)] → [故障紛失サポート (Repair and Delivery Support)] → [クイック診断してみる (Try quick check)]
(Displayed language is Japanese only)

■ Trouble check

Home screen → [📱] → [サポート (Support)] → [故障紛失サポート (Repair and Delivery Support)] → [便利な機能 (Useful functions)] → [トラブル診断を試す (Try trouble check)] (Displayed language is Japanese only)

Also available on the following au home page.

<https://www.au.com/trouble-check/>







See also "Online Manual" (Japanese) or "取扱説明書 詳細版 (Full Instruction Manual)" (Japanese) available on the au homepage.

<https://www.au.com/online-manual/kyv46/>
<https://www.au.com/support/service/mobile/guide/manual/>

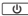
Trouble	Detail	Page
Cannot turn on power	Is the battery pack charged?	P.64
	Is the battery pack attached properly?	P.56
	Are the terminals of the battery pack dirty?	—
	[🔌] (Power button) pressed and held until the charging light turns on?	P.69
Cannot charge	Is the specified charger (sold separately) connected properly?	P.65
	Is the battery pack attached properly?	P.56
	Is the product or the battery at a high or low temperature? The product may stop charging depending on temperature.	P.64
	Is the specified accessory (adapter, etc.) used for charging?	P.65
Cannot authenticate the fingerprint	Check for scratches on the fingerprint sensor and wipe off dirt on it.	P.77
	Check if your fingerprint is stained, wet, or dry.	P.77

Trouble	Detail	Page
Cannot charge with the Wireless Charging Pad (sold separately)	Is the product placed in the correct orientation and within a chargeable area on the Wireless Charging Pad (sold separately)?	P.67
	Is there any foreign object between the product and the Wireless Charging Pad (sold separately)?	P.67
	Are the Wireless Charging Pad (sold separately) and special AC Adapter properly connected?	P.67
	Is the product or the battery at a high or low temperature? The product may stop charging depending on temperature.	P.64
	Is the back cover attached properly?	P.56
	If the battery pack is at the end of its service life and is bulging, you may not be able to charge wirelessly Replace the battery.	—

Trouble	Detail	Page
Charging does not complete with the Wireless Charging Pad (sold separately).	The charging indicator is still lit after completing charging, but this is not abnormal. Check the display on the phone.	P.67
	Is the product or the battery at a high or low temperature? Charging sometimes takes a long time depending on the temperature.	—
	Charging while using the product can also cause charging to take a long time.	—
Cannot operate/The screen does not respond/ Cannot turn off the power	You can force the product to power off and restart by holding down  (Power button) and  (Volume up button) at the same time for at least 11 seconds.	—
The power is turned off automatically	Is the battery pack adequately charged?	P.64
The power is turned off while the wake-up logo is displayed	Is the battery pack adequately charged?	P.64

Trouble	Detail	Page
Cannot make calls	Is the power turned on?	P.69
	Is the au IC card inserted?	P.61
	Was the number entered correctly? (Was the area code entered?)	P.81
	Did you tap  after entering the number?	P.81
	Is "Airplane mode" still set?	P.76
Cannot receive calls	Is the signal strong enough?	P.74
	Is the product within the service area?	P.74
	Is the power turned on?	P.69
	Is the au IC card inserted?	P.61
	Is "Incoming Reject" still set?	—
	Is "Airplane mode" still set?	P.76
	Is "Call forwarding services" still set?	—
 (out of service area) appears	Is the product within the service area or where signal is good enough?	P.74
	Is the built-in antenna covered with finger, etc.?	P.52
	Is a card inserted other than the au IC card?	P.60

Trouble	Detail	Page
Cannot connect to Wi-Fi®	Is Wi-Fi® signal strong enough?	P.74
	Is Wi-Fi® setting completed?	—
	Is the product or the battery at a high temperature? The product may stop functioning if at a high/low temperature.	—
	Is "Airplane mode" still set?	P.76
Display/incoming light turns on but ringtone does not sound	Is the "Ring volume" set to the minimum?	—
	Is "Silent mode" set?	P.75
Cannot operate the buttons or touch panel	Is the power turned on?	P.69
	Is the security setting for the start screen set?	—
	Turn off the power and then turn it on again.	P.69
Cannot operate the touch panel as intended	Check for the correct operation of the touch panel.	—
	Turn off the power and then turn it on again.	P.69
A message indicating that charging is necessary is displayed	The battery is almost empty.	P.64

Trouble	Detail	Page
The product answers calls when it shouldn't	Is "Auto answering" set?	—
The battery pack can only be used for a short time	Is it adequately charged? • Charge until the red charging lamp turns green.	P.64
	Does the battery pack have adequate service life remaining?	P.29
	Is the product left in the place for a long period where  (out of service area) appears?	P.74
When making a call, there is a busy signal and the call does not go through the receiver	Is the product within the service area or where signal is good enough?	P.74
	The wireless line is extremely busy or the party is calling. Retry later.	—
Display goes off shortly	Is the time period before entering "Sleep" set to short?	—
Display is dark	Is the "Brightness level" set to dark?	—
	Is the product or the battery at a high temperature? The display may become dark depending on the temperature of the product.	—

Trouble	Detail	Page
Cannot hear/hard to hear the other party's voice	Is the call volume set to the minimum?	P.81
	Is the receiver/speaker covered with your ear? Place the receiver/speaker to your earhole.	P.52
Cannot use microphone of earphone microphone	Is the connector inserted correctly? Insert the connector straight into the external connection terminal.	P.92
Operation speed decreased/apps operate unstably/cannot activate some apps	Operation becomes unstable when available memory is low. When available memory is low, delete unnecessary apps to secure free memory.	P.73
Settings made for specified contacts do not work	Is the caller ID notified? If the caller does not notify the caller ID, ringtone setting in Contacts is not effective. Group's incoming settings in Contacts is not effective, either.	—
	Are two or more same telephone number registered in the phone book?	—

Trouble	Detail	Page
microSD memory card cannot be recognized	Is the microSD memory card correctly inserted?	P.63
	Is the microSD memory card unmounted?	—
Camera does not operate	Is the product or the battery at a high temperature? The product may stop functioning if at a high/low temperature.	P.64
Cannot make an emergency call	Is the specified au IC card inserted?	P.61
	Is a card other than specified au IC card used?	—
	Is the product within the service area or where signal is good enough?	P.74

After-Sales Service

■ When Asking for Repair

For repair, contact Repair and Delivery Support Center.

During the warranty period	Repairs will be done based on the terms of services of the free-of-charge repair warranty.
Outside the warranty period	We shall repair the product for a charge as requested by the customer if repair renders it usable.

* The warranty period is one year from the day when you purchase the product.



- ◎ Before handing the product for repair, make a backup of the contents of memory since they may disappear during repair. Note that the Company shall not be liable for any damages and loss of income should the contents of memory be altered or lost.
- ◎ Recycled parts that meet the Company's quality standards are sometimes used for repair.
- ◎ au portable terminals collected by Replacement cell phone delivery service which you used before are recycled to portable terminals for replacement after repairs. Also, parts replaced by au after-sales service are collected and recycled by the Company. They are not returned to customers.
- ◎ Instances where the product has been changed, modified, or analyzed (including software modification or analysis (including rooting, etc.) reverse-engineered, reverse-compiled, or reverse-assembled) or has been repaired at a location other than an authorized repair location designated by the Company may not be covered by warranty or may prevent the product from being accepted for repairs.

- ◎ The battery pack is not covered by the free-of-charge repair warranty except for events arising from defects in battery materials and manufacturing.
- ◎ The accessories and samples such as the front screen other than the product are not covered by the free-of-charge repair warranty.

■ Performance Parts for Repair

The Company retains performance parts for repair of the KYV46 main unit and its peripherals for 4 years after discontinuation of production. Performance parts for repair refers to parts required for maintaining the functions of the product.

■ Terms of Services of Free-of-Charge Repair Warranty

1. When you apply for repair, inform us of your serial number (IMEI number). You can check the main unit or the sticker attached on the packaging box for the serial number (IMEI number).
2. Repairs will be done based on the terms of services of the free-of-charge repair warranty when the product is used correctly based on the instruction manual and the product is malfunctioning.

3. Repairs will be charged in the following cases even during the warranty period. (Also, the product cannot be repaired in some cases.)
- ① When the product is not used correctly based on the instruction manual.
 - ② When the product is malfunctioning or damaged due to inappropriate modification and repair.
 - ③ When the product is repaired by repair offices other than the company specified.
 - ④ When the product is malfunctioning or damaged due to a handling fault or accident. Or when there are some traces that the product is damaged by falling, water or humidity.
 - ⑤ When the product is malfunctioning or damaged due to earthquakes, storms, floods or other natural disasters, as well as fires, salt, abnormal voltage, etc.
4. Repairs may be refused depending on the damage condition of devices.
5. Note that the company shall not be liable for any damages and loss arising from the product malfunction.
6. The Company assumes no responsibility for any accidents when the product is connected with an unspecified device.
7. On-site repair is not available.
8. This warranty is valid only in Japan.

* The warranty guarantees that free-of-charge repairs will be done based on the terms of period and conditions indicated above. Therefore, the warranty does not limit your legal rights against persons in charge of the warranty and other operators.

■ Repair and Delivery Support

An after-sales service membership program on a monthly basis called "Repair and Delivery Support" is available for using your au portable terminal for a long time without worries. This service expands coverage for many troubles including malfunction, theft and loss.

For the monthly fee and details of this service, check on the au homepage.

<https://www.au.com/mobile/service/kosho-funshitsu/>



- ◎ You can apply for membership only at the time of purchasing your au portable terminal.
- ◎ Once you cancel the membership, you cannot reapply for it until you purchase an au portable terminal next time.
- ◎ Note that when changing the model or purchasing an extra portable terminal, this service only covers the most recently purchased au portable terminal.
- ◎ When an au portable terminal is handed over to you or someone else, the "Repair and Delivery Support" membership is also handed over to the successor of the portable terminal.
- ◎ When you get a new au portable terminal by changing the model, purchasing an extra portable terminal, etc., the "Repair and Delivery Support" membership for the old au portable terminal is automatically canceled.
- ◎ Service contents are subject to change without notice.

■ au IC Card

The au IC card is lent to you by au. In case of loss or damage, the card will be replaced at your expense. When malfunction is suspected, or in case of theft or loss, contact an au shop or TOYOTA store dealing in au.

SIM Unlock

This product can be SIM-unlocked. SIM-unlocking the product allows other-carrier SIM cards to be used with it.

- Requests can be made for SIM-unlocking on the au homepage or at an au shop.
- Some services, functions, etc. may have restrictions when an other-carrier SIM card is used. The Company does not guarantee operation whatsoever.
- To set up your phone after unlocking SIM lock, from the home screen, [🌐] → [Settings] → [System] → [About phone] → [SIM card status] → [SIM STATUS UPDATE].
- For details, refer to the au homepage.

<https://www.au.com/support/service/mobile/procedure/simcard/>

Related Accessories

- Battery pack (KYV46UAA)
- Back cover (KYV46TLA/KYV46TRA/KYV46TKA)
- Front cover (KYV46VLA/KYV46VRA/KYV46VKA)
- Front screen (KYV46KGA)
- USB cover (KYV46WAA)
- Type-C Common AC Adapter 01 (0601PQA) (sold separately)
- Type-C Common AC Adapter 02 (0602PQA) (sold separately)
- MicroB to Type-C Conversion Adapter (0601PHA) (sold separately)
- Common AC Adapter 05 (0501PWA) (sold separately)
- au Carrying Case G Black (0106FCA) (sold separately)

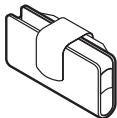

- Wireless Charging Pad 01 (0101PUA) (sold separately)
- Wireless Charging Pad 02 (0102PUA) (sold separately)
- KYOCERA 3.5ΦType-C conversion cable (0401QNA)

* Requires a MicroB to Type-C Conversion Adapter (sold separately).



memo

◎ Accessories can be purchased at au online shop.
<https://onlineshop.au.com/>

Using Earphones

■ Using an Earphone (Commercially Available) with a KYOCERA 3.5 ϕ Type-C Conversion Cable (0401QNA) (Sold Separately)

An earphone (sold separately) can be used by connecting a KYOCERA 3.5 ϕ Type-C conversion cable (0401QNA) (sold separately).

- 1 Connect the earphone (commercially available) and KYOCERA 3.5 ϕ Type-C conversion cable (0401QNA) (sold separately)**
- 2 Open the USB cover of the product (► P.65)**
- 3 Insert the KYOCERA 3.5 ϕ Type-C conversion cable (0401QNA) (sold separately) in the product**

Insert the plug of KYOCERA 3.5 ϕ Type-C conversion cable (0401QNA) (sold separately) straight into the external connection terminal.

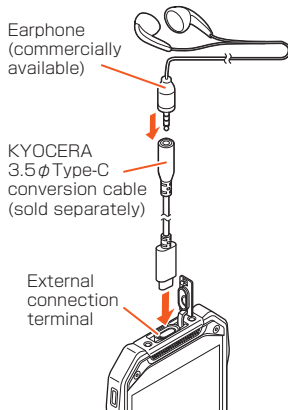

memo

- ◎ Depending on an earphone (commercially available), you may not be able to connect the KYOCERA 3.5 ϕ Type-C conversion cable (0401QNA) (sold separately).

Main Specifications

■ Main Unit

Display	Approx. 5.0 inches, approx. 16.77 million colors, Transparent TFT	
	1,080 × 1,920 dots (FHD)	
Weight	Approx. 200 g	
Dimensions (W × H × D)	Approx. 73 × 150 × 13.4 mm (thickest part approx. 17.4 mm) * Excluding protrusions	
Internal memory* ¹		ROM: Approx. 64GB RAM: Approx. 4GB
Continuous call time	In Japan	Approx. 1,300 minutes
	Overseas (GSM)	Approx. 690 minutes
Continuous standby time	In Japan	Approx. 490 hours
	Overseas (GSM)	Approx. 520 hours
Continuous tethering time		Approx. 830 minutes
Maximum number of Wi-Fi® tethering connection devices		10 devices

Charging times (estimate)	Type-C Common AC Adapter 01 (sold separately)	Approx. 170 minutes
	Type-C Common AC Adapter 02 (sold separately)	Approx. 170 minutes
	Wireless Charging Pad 02 (sold separately)	Approx. 230 minutes
Camera image pixel		CMOS
Effective out-camera pixels		Approx. 24 million pixels
Effective wide-camera pixels		Approx. 8 million pixels
Effective in-camera pixels		Approx. 8 million pixels
Wireless LAN (Wi-Fi®) function		IEEE802.11 a/b/g/n/ac compatible

Bluetooth® function	Compatible version	Bluetooth® standards Ver.5.0 compatible ^{*2}
	Output	Bluetooth® standards Class 1
	Communication range ^{*3}	Within 10 m with no obstacles in the range
	Supported Bluetooth profile ^{*4}	GATT (Generic Attribute Profile) SPP (Serial Port Profile) A2DP (Advanced Audio Distribution Profile) AVRCP (Audio/Video Remote Control Profile) HSP (Headset Profile) HFP (Hands-Free Profile) OPP (Object Push Profile) PBAP (Phone Book Access Profile) HID (Human Interface Device Profile) PAN (Personal Area Networking Profile) PAN-NAP (Personal Area Networking-Network Access Point) PAN USER (Personal Area Networking-User) HOGP (HID over GATT Profile) apt-X Bluetooth SSP MAP (Message Access Profile)

Bluetooth® function	Supported Bluetooth profile ^{*4}	AAC LDAC DUN (Dial-Up Networking Profile) ^{*5}
	Frequency bands	2.4 GHz band

- *1 Since the storage is shared by data and apps, storage space may be reduced depending on the usage of apps.
- *2 It is confirmed that the product and all Bluetooth® devices are compliant with Bluetooth® standards designated by Bluetooth SIG, and they are authenticated. However, procedures may differ or data transfer may not be possible depending on the device's characteristics or specifications.
- *3 It changes according to objects obstructing devices and signal reception.
- *4 Specifications provided in Bluetooth® standards for making communication between Bluetooth® compatible devices in accordance with their intended use.
- *5 Supported for some car navigation systems only. See the au homepage for usage. (JAPANESE)



memo

- © The continuous talk time and continuous standby time may drop to less than half depending on the battery charging status, usage environment such as temperature, reception condition at the location where the product is used, and the function settings.

Specific Absorption Rate (SAR) of Cell Phones

This model KYV46 mobile phone complies with Japanese technical regulations and international guidelines regarding exposure to radio waves. This cell phone has been designed in observance of the Japanese technical regulations ⁽¹⁾ regarding exposure to radio waves and limits to exposure to radio waves recommended by equivalent international guidelines. These international guidelines were set out by the International Commission on Non-Ionizing Radiation Protection (ICNIRP), which is in collaboration with the World Health Organization (WHO), and the permissible limits include a substantial safety margin designed to assure the safety of all persons, regardless of age and health condition.

The Japanese technical regulations and international guidelines define the limits using a unit of measurement known as the Specific Absorption Rate (SAR), which represents the average amount of radio frequency energy absorbed by the human body. The SAR limit for cell phones is 2.0 W/kg. The highest SAR value for this cell phone when tested for use at the ear is 0.607W/kg ⁽²⁾. The highest SAR value for this cell phone when tested for use on the body is 0.793W/

kg ⁽²⁾. There may be slight differences in SAR levels among individual products, but they all satisfy the limit.

The actual SAR of this cell phone while talking on the phone can be well below that indicated above. This is due to the cell phone being designed to only output the minimum power required to communicate with a base station. Therefore in general, the closer you are to a base station, the lower the power output of the cell phone is.

This cell phone can be used in positions other than against your head. Use a carrying case or similar accessory that holds the phone at least 1.5 cm separated from the body and ensure no metal parts are located between you and the cell phone. Under these conditions, this cell phone satisfies Japanese technical regulations and international guidelines for radio wave protection.

The World Health Organization has stated that "a large number of studies have been performed over the last two decades to assess whether mobile phones pose a potential health risk. To date, no adverse health effects have been established as being caused by mobile phone use".

If you would like to know more detailed information, please refer to the WHO website.

<https://www.who.int/emf>

Please refer to the websites listed below if you

would like to know more detailed information regarding SAR.

- Ministry of Internal Affairs and Communications website:

<https://www.tele.soumu.go.jp/e/sys/ele/index.htm>

- Association of Radio Industries and Businesses website:

<https://www.arib-emf.org/O1denpa/denpa02-02.html> (Japanese)

- au homepage:

<https://www.au.com/english>

*1 Technical regulations are defined by the Ministerial Ordinance Related to Radio Law (Article 14-2 of Radio Equipment Regulations).

*2 This includes the wireless function that can be used simultaneously.

FCC Notice

This device complies with part 15 of the FCC Rules. Operation is subject to the following two conditions: (1) This device may not cause harmful interference, and (2) this device must accept any interference received, including interference that may cause undesired operation.

Note:

This equipment has been tested and found to comply with the limits for a Class B digital device, pursuant to part 15 of the FCC Rules. These limits are designed to provide reasonable protection against harmful interference in a residential installation. This equipment generates, uses, and can radiate radio frequency energy and, if not installed and used in accordance with the instructions, may cause harmful interference to radio communications.

However, there is no guarantee that interference will not occur in a particular installation. If this equipment does cause harmful interference to radio or television reception, which can be determined by turning the equipment off and on, the user is encouraged to try to correct the interference by one or more of the following measures:

- Reorient or relocate the receiving antenna.
- Increase the separation between the equipment and receiver.
- Connect the equipment into an outlet on circuit different from that to which the receiver is connected.
- Consult the dealer or an experienced radio/TV technician for help and for additional suggestions.

Warning

The user is cautioned that changes or modifications not expressly approved by the manufacturer could void the user's authority to operate the equipment.



FCC RF EXPOSURE INFORMATION

Warning! Read this information before using your phone.

Warning! Read this information before using your phone. In August 1996, the Federal Communications Commission (FCC) of the United States, with its action in Report and Order FCC 96-326, adopted an updated safety standard for human to radio frequency electromagnetic energy emitted by FCC regulated transmitters. Those guidelines are consistent with the safety standard previously set by both U.S. and international standards bodies. The design of this phone

complies with the FCC guidelines and these international standards.

Body-worn Operation

This device was tested for typical body-worn operations with the back of the phone kept 0.39 inches (1.0 cm) from the body. To comply with FCC RF exposure requirements, a minimum separation distance of 0.39 inches (1.0 cm) must be maintained between the user's body and the back of the phone, including the antenna. All beltclips, holsters and similar accessories used by this device must not contain any metallic components. Body-worn accessories that do not meet these requirements may not comply with FCC RF exposure limits and should be avoided. This device is not intended to be used with a lanyard or strap on the body. The device contains a mounting point that may be used to attach the device to equipment, a backpack or tool belt, etc.

Turn off your phone before flying

You should turn off your phone when boarding any aircraft. To prevent possible interference with aircraft systems, U.S. Federal Aviation Administration (FAA) regulations require you to have permission from a crew member to use your phone while the plane is on the ground. To prevent

any risk of interference, FCC regulations prohibit using your phone while the plane is in the air.

■ FCC Certification Information

- The product is certified by Federal Communications Commission (FCC). The product's FCC ID is JOYKB46.

You can view this certification in the following way.
How to confirm:

From [🏠] on the Home screen, [Settings] → [System] → [Compliance information]

Export Administration Regulations

This product and its accessories may be subject to the Japan Export Administration Regulations ("Foreign Exchange and Foreign Trade Law" and its related laws). In addition, U.S. Re-export Regulations (Export Administration Regulations and the related laws and regulations) may apply to this product and its accessories. To export and re-export this product and its accessories take the required measures on your responsibility and at your expenses. For details on the procedures, contact the Ministry of Economy, Trade and Industry, the U.S. Department of Commerce.

Intellectual Property Rights

Trademarks

Company names and product names referred to in this manual are trademarks or registered trademarks of the respective companies.



Google and Google logo, Android and Android logo, Google Play and Google Play logo, Play Music and Play Music logo, Play Movies & TV and Play Movies & TV logo, Gmail and Gmail logo, Google Maps and Google Maps logo, Google Drive and Google Drive logo, Google Maps Navigation and Google Maps Navigation logo, Google Chrome and Google Chrome logo, Google Voice Search and Google Voice Search logo, YouTube and YouTube logo are trademarks or registered trademarks of Google LLC.

Microsoft®, Windows® and Windows® 7/Windows® 8.1/Windows® 10 are registered trademarks of Microsoft Corporation in the U.S.A. and other countries. The official name for Microsoft® Windows® is Microsoft® Windows® Operating System.

Microsoft®, Microsoft® Excel®, Microsoft® PowerPoint®, Windows Media®, and Exchange® are trademarks or registered trademarks of Microsoft Corporation in the United States and other countries.

Microsoft® Word and Microsoft® Office are product names of Microsoft Corporation in the United States.

QR code is a registered trademark of DENSO WAVE INCORPORATED.

microSD, microSDHC and microSDXC logos are trademarks of SD-3C, LLC.

Bluetooth® and logo are registered trademarks owned by the Bluetooth SIG, Inc., and KYOCERA Corporation is licensed to use those trademarks.

WiMAX is a trademark of WiMAX Forum.

Wi-Fi®, WPA®, Wi-Fi CERTIFIED logo, Wi-Fi Direct®, and Miracast® are registered trademarks of Wi-Fi Alliance. Wi-Fi CERTIFIED™ is trademark of Wi-Fi Alliance.

"Qi (chi)" and the qi symbol are trademarks of the Wireless Power Consortium (WPC).

FeliCa is a contactless IC card technology developed by Sony Corporation.

FeliCa is a registered trademark of Sony Corporation.

↻ is a registered trademark of FeliCa Networks, Inc.

Facebook and Facebook logo are trademarks or registered trademarks of Facebook, Inc.

Twitter and Twitter logo are trademarks of Twitter, Inc.

Instagram and Instagram logo are trademarks or registered trademarks of Instagram, LLC.

Amazon, Amazon.co.jp, and Amazon.co.jp logo are the trademarks or registered trademarks of Amazon.com, Inc. or its affiliates.

Terminal Eleven, the Terminal Eleven logo, and SkyView® are registered trademarks of Terminal Eleven LLC in the U.S.

iWnn of OMRON SOFTWARE Co., Ltd. is used for conversion methods for Japanese language, and for phrase prediction methods for English.
iWnn IME©OMRON SOFTWARE Co., Ltd. 2009-2019
All Rights Reserved.

THIS PRODUCT IS LICENSED UNDER THE MPEG-4 VISUAL PATENT PORTFOLIO LICENSE FOR THE PERSONAL AND NON-COMMERCIAL USE OF A CONSUMER FOR (i) ENCODING VIDEO IN COMPLIANCE WITH THE MPEG-4 VISUAL STANDARD ("MPEG-4 VIDEO") AND/OR (ii) DECODING MPEG-4 VIDEO THAT WAS ENCODED BY A CONSUMER ENGAGED IN A PERSONAL AND NONCOMMERCIAL ACTIVITY AND/OR WAS OBTAINED FROM A VIDEO PROVIDER LICENSED BY MPEG LA TO PROVIDE MPEG-4 VIDEO. NO LICENSE IS GRANTED OR SHALL BE IMPLIED FOR ANY OTHER USE. ADDITIONAL INFORMATION INCLUDING THAT RELATING TO PROMOTIONAL, INTERNAL AND COMMERCIAL USES AND LICENSING MAY BE OBTAINED FROM MPEG LA, LLC. SEE [HTTPS://WWW.MPEGLA.COM](https://www.mpegla.com).

THIS PRODUCT IS LICENSED UNDER THE AVC PATENT PORTFOLIO LICENSE FOR THE PERSONAL USE OF A CONSUMER OR OTHER USES IN WHICH IT DOES NOT RECEIVE REMUNERATION TO (i) ENCODE VIDEO IN COMPLIANCE WITH THE AVC STANDARD ("AVC VIDEO") AND/ OR (ii) DECODE AVC VIDEO THAT WAS ENCODED BY A CONSUMER ENGAGED IN A PERSONAL ACTIVITY AND/OR WAS OBTAINED FROM A VIDEO PROVIDER LICENSED TO PROVIDE AVC VIDEO. NO LICENSE IS GRANTED OR SHALL BE IMPLIED FOR ANY OTHER USE. ADDITIONAL INFORMATION MAY BE OBTAINED FROM MPEG LA, LLC. SEE [HTTPS://WWW.MPEGLA.COM](https://www.mpegla.com).

- (1) ACCESS, the ACCESS logo, and NetFront are registered trademarks or trademarks of ACCESS CO., LTD. in the United States, Japan and/or other countries.
- (2) This software is based in part on the work of the Independent JPEG Group.

"デイレーステップ", "TORQUE (logo)", "LIVE MORE. FEAR LESS.", "HYBRID SHIELD", "ウェットタッチ", "グローブタッチ", and "ACTION OVERLAY" are registered trademarks of KYOCERA Corporation.

"もじチェン" by LIM Corporation LTD. is used for switching font. "もじチェン" is a registered trademark of LIM Corporation LTD.

The product contains fonts provided by LIM Corporation LTD.

The product contains fonts provided by Morisawa Inc.

"PhotoSolid", the function to avoid blurring still images, is a product of Morpho, Inc. "PhotoSolid" is a registered trademark of Morpho, Inc.

"Morpho Rapid Effect", the image effect technology, is a product of Morpho, Inc. "Morpho Rapid Effect" is a trademark of Morpho, Inc.

"Morpho HDR", the HDR (High Dynamic Range) technology, is a product of Morpho, Inc. "Morpho HDR" is a trademark of Morpho, Inc.

USB Type-C™ is a trademark of USB Implementers Forum.

All other company names and product names in this manual are trademarks or registered trademarks of respective companies.

License

Users of the product are authorized to use software installed into the product described in this instruction manual. Pay attention to the following points when using the software.

- (a) The software installed on this product or part of it may not be altered, delivered, modified, analyzed, reverse-engineered, derived, and any such actions are prohibited.
- (b) Illegally importing the software or a part of it is prohibited.
- (c) This Software is provided without implied warranties of merchantability, fitness for a particular purpose and noninfringement of third party rights.

Note that the existing license agreement takes priority for usage of GNU General Public License (GPL), GNU Library/Lesser General Public License (LGPL) included in software, software based on other open source software license and software that KYOCERA Corporation is licensed.

For information on the Open source software, refer to "Open source software" as follows;

■ Open Source Software

Note that the existing license agreement takes priority for usage of GNU General Public License (GPL), GNU Library/ Lesser General Public License (LGPL) included in software, software based on other open source software license and software that KYOCERA Corporation is licensed. The exact terms of GPL, LGPL and some other licenses are reproduced in "About phone" in this product. For details, refer to KYOCERA homepage.

This product includes software copyrighted by KYOCERA Corporation and licensed software. Copyright of the software designed and developed complying with the open source software standard belongs to KYOCERA Corporation or the third parties, distribution, reproduction, transformation and transmission over public lines without consent of KYOCERA Corporation are prohibited, unless you are authorized or permitted by Copyright Law.

■ Recording Diagnosis and Usage Condition Data

KYOCERA Corporation asks for users' cooperation in order to improve the quality of products and services. KYOCERA Corporation records and saves data of failure diagnosis and the usage conditions (application usage by users, log related to error, detail information of application usage by users (specified functions, usage frequency, memory/battery status)) in the product in order to track and cope with diagnosis events such as unexpected shutdown or system error for the purpose of improvement of quality and services. Those information may be collected upon repair request by user after obtaining the user agreement.

For inquiries, call:

Customer Center

For general, charge, operations (toll free)

Business hours 9:00 to 20:00 (7 days a week)

From au cell phones: 157 area code not required

From fixed-line phones:  0077-7-111

For service canceling procedure
in case of loss or theft (toll free)

Business hours 24-hour (7 days a week)

From au cell phones: 113 area code not required

From fixed-line phones:  0077-7-113

In case above numbers are not available,

 0120-977-033 (except Okinawa)

 0120-977-699 (Okinawa)

Repair and Delivery Support Center

For loss, theft or damage (toll free)

Business hours 9:00 to 20:00 (7 days a week)

From fixed-line phones/au cell phones,

 0120-925-919



やめましょう、
歩きスマホ。



あぶない！
電池への衝撃



キケン！
水ぬれ充電



モバイル・リサイクル・ネットワーク
携帯電話・PHSのリサイクルにご協力を。

Cell phone and PHS operators collect and recycle unused telephones, batteries and battery chargers at stores bearing the  logo regardless of brand and manufacturer to protect the environment and reuse valuable resources.

September 2019, 1st Edition

Sales: KDDI CORPORATION • OKINAWA CELLULAR TELEPHONE COMPANY

Manufactured by: KYOCERA Corporation