

XPERIA 1

SOV40

Basic Manual

■ **Online Manual (Japanese)**
Check "Online Manual" (Japanese) which describes detail explanations on various functions on the product from the following procedure.
In the Home screen, slide the screen up ▶[お客さまサポート (Customer support)] ▶[取扱説明書 (Online Manual)] (Japanese)

Also, you can check "Online Manual" (Japanese) on the au homepage.
https://www.au.com/online-manual/sov40/ (Japanese)

In this manual, the contents on Android 9 are provided.
For the latest edition, refer to "Online Manual" (Japanese) or "取扱説明書(詳細版)(Full Instruction Manual)" (Japanese) available on the au homepage.
https://www.au.com/support/service/mobile/guide/manual/ (Japanese)

Notification LED

The Notification LED prompts charging, or informs battery level while charging, missed calls, new mails, etc. by turning on or flashing.

LED Status	Description
Red	The battery is charging when the remaining battery level is 14% or lower.
Orange	The battery is charging when the remaining battery level is 15% - 89%.
Green	The battery is charging when the remaining battery level is 90% or higher.
Flashing red	The remaining battery level is 14% or lower.
Flashing white ¹	Indicates a missed call, new au-mail, new message, etc.

¹ Flashes in sleep mode

au IC card

Your phone number etc. is recorded in au IC card.
The product is compatible with au Nano IC Card 04.

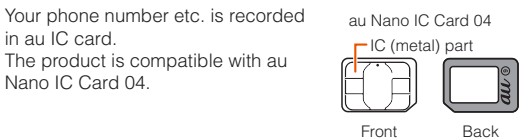

2 Insert the USB Type-C plug of TypeC Common AC Adapter 02 (sold separately) into the USB Type-C connection terminal of the product straight
When charging is started with the product powered on, the start sound for charging sounds and the Notification LED of the product lights.

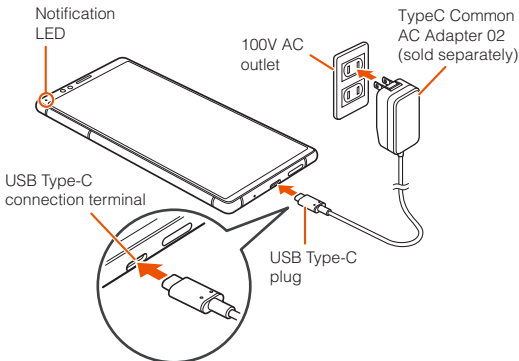

3 When charging is complete, remove the USB Type-C plug of TypeC Common AC Adapter 02 (sold separately) from the product
4 Remove the power plug of TypeC Common AC Adapter 02 (sold separately) from the outlet

Preface

Thank you for buying "Xperia 1" (simply called "the product" or "main unit" from here on).
Before using the product, read "Basic Manual" (this manual), "Cautions on using the product" and "Setting Guide" for proper handling.

Packaged items

Before your start using the product, make sure that you have all the following packaged items with the product.

- Xperia 1

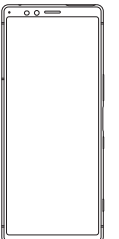
- USB Type-C™-3.5 ϕ conversion/TV Antenna cable 01 (03SOHSA)

- 取扱説明書 (Basic Manual) (Japanese)
ご利用にあたっての注意事項 (Cautions on using the product) (Japanese)
設定ガイド (Setting Guide) (Japanese)



The following items are not included in the package.

- microSD memory card
- AC adapter
- Earphones
- Desktop holder
- USB Type-C™ cable

Attaching/removing au IC card

Before attaching/removing au IC card, make sure to turn off the product.

■ Attaching au IC card

1 Remove the tray from the main unit
Put your fingertip (nail) into the groove of the microSD memory card/au IC card slot and draw the cover straight out.

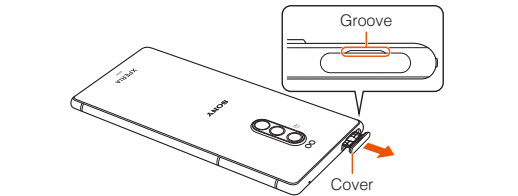

2 Set au IC card into the tray with the IC (metal) part facing up
Pay attention to the location of the notch.
Surely set au IC card into the tray not to come off.

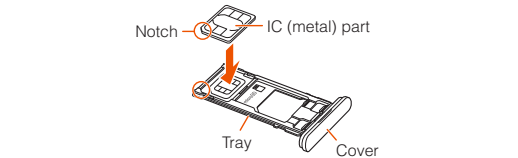

Connecting headphones or earphones

To hear sound from commercially available headphones or earphones, connect the supplied USB Type-C™-3.5 ϕ conversion/TV Antenna cable 01.

1 Insert the plug on the commercially available headphones or earphones in the headset socket on the USB Type-C™-3.5 ϕ conversion/TV Antenna cable 01
2 Insert the USB Type-C plug of USB Type-C™-3.5 ϕ conversion/TV Antenna cable 01 to the USB Type-C connection terminal of the product

Turning the power on/off

■ Turning the power on

1 Press and hold Power key until the product vibrates once
The lock screen appears.
When "ようこそ (Welcome)" appears after the product is powered on, follow the onscreen instructions to set the initial settings.
For details on the initial settings, refer to "Setting Guide" supplied with the product.

2 Swipe (flick) the screen up
The Home screen appears.

■ Turning the power off

1 Press and hold Power key (over one sec.)
2 [Power off]

❖Information

- Purchase a specified charger (sold separately).
- The battery is built into the product.
- Illustrations used in this manual are just images for explanations. They may be different from actual ones.

About Operating Instructions

■ **"Setting Guide"/"Basic Manual" (this manual)**
Handles only basic operations for main features.

■ Online Manual (Japanese)

Check "Online Manual" (Japanese) which describes detail explanations on various functions on the product from the following procedure.
In the Home screen, slide the screen up ▶[お客さまサポート (Customer support)] ▶[取扱説明書 (Online Manual)] (Japanese)



Also, you can check "Online Manual" (Japanese) on the au homepage.
https://www.au.com/online-manual/sov40/ (Japanese)

■ "取扱説明書 (Full Instruction Manual)" (Japanese)

For detailed descriptions on various functions, refer to the "取扱説明書(詳細版) (Full Instruction Manual)" (Japanese) available on the au homepage.
https://www.au.com/support/service/mobile/guide/manual/ (Japanese)

3 Keep the product horizontal and then push the tray in straight

Pay attention to the direction the tray is being pushed in.
Firmly press where circled ○, and check that there is no gap between the main unit and the microSD memory card/au IC card slot cover.

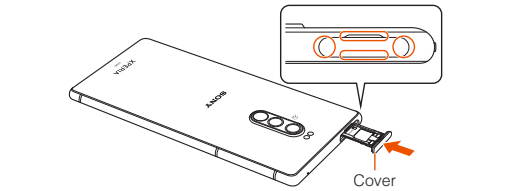

■ Removing au IC card

1 Remove the tray from the main unit
Put your fingertip (nail) into the groove of the microSD memory card/au IC card slot and draw the cover straight out.

2 Remove the au IC card from the tray

3 Keep the product horizontal and then push the tray in straight
Pay attention to the direction the tray is being pushed in.
Firmly press where circled ○, and check that there is no gap between the main unit and the microSD memory card/au IC card slot cover. (▶P.9)

❖Information

- To restart the product in safe mode (start with almost default state), press and hold Power key (over one sec.) ▶ Long-touch "Power off" ▶[OK].

■ Forcedly turning the power off

1 Press and hold Power key and the upper part of the volume key at the same time for approximately nine seconds, and release your fingers after the product vibrates three times consecutively

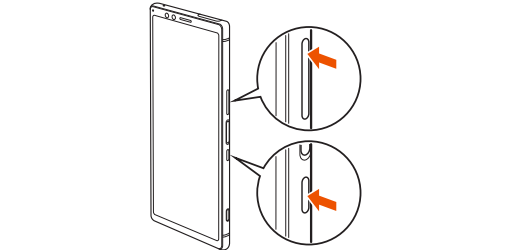

Changing the language to English

You can change the display language from Japanese to English after the initial settings.
In the Home screen, slide the screen up ▶[設定 (Settings)] ▶[システム (System)] ▶[言語と入力 (Languages & input)] ▶[言語 (Languages)] ▶[言語を追加 (Add a language)] and select "English" ▶"United States", and then drag ≡ of "English (United States)" up to the top in the language list.

■ For Those Requiring an English Instruction Manual

Download URL:
https://www.au.com/english/support/manual/

Regarding notations used in this document

- In this manual, operations of tapping menu items/icons/ buttons on the screen, etc. are indicated as [(name of the item, etc.)].
- In this manual, screens and operations for the product with au Nano IC Card 04 attached are described.
- Screen illustrations shown in this manual may look different from the actual screens. In some cases, minor details or a part of a screen may be omitted.
- In this manual, "Basic Manual" (this manual), "Cautions on using the product", "Setting Guide" and "取扱説明書(詳細版) (Full instruction manual)" (Japanese) are collectively referred to as "Instruction Manual".
- In this manual, explanations for the wallpaper "Black" are provided.
- In this manual, operations in portrait view are described as a standard. In horizontal view, menu items, icons, buttons on the screen, etc. may differ.
- In this manual, "au Nano IC Card 04" is abbreviated as "au IC card".
- In this manual, "microSD™ memory card (commercially available)", "microSDHC™ memory card (commercially available)" and "microSDXC™ memory card (commercially available)" are abbreviated as "microSD memory card".

❖Information

- Note the following points, otherwise handling au IC card may cause malfunction or damage.
 - Do not touch the IC (metal) part of au IC card.
 - Insert in the correct direction.
 - Do not use force to attach or remove.
- The error message appears when au IC card is not set properly or there is a malfunction in au IC card.
- Do not lose au IC card when it is removed.
- Do not insert au IC card with conversion adapter attached. Doing so may cause a malfunction.

Attaching/Removing a microSD memory card

Before attaching/removing microSD memory card, make sure to turn off the product.

■ Attaching a microSD memory card

1 Remove the tray from the main unit
Put your fingertip (nail) into the groove of the microSD memory card/au IC card slot and draw the cover straight out.

Locking the screen/Unlocking screen lock

■ Locking the screen

Turn off the screen to set sleep mode to prevent the touch panel or key from operating mistakenly or lock the screen.

1 While the screen is displayed, press Power key

■ Unlocking screen lock

The lock screen appears when turning the power on or sleep mode is canceled by pressing Power key.

- While Ambient display (which allows you to check date & time or notifications in sleep mode) is activated, double-tap the screen or press Power key to display the lock screen.

1 On the lock screen, swipe (flick) the screen up

❖Information

- In the lock screen, swipe (flick) "🔒" or "📷" to use Google Assistant or Camera.

Basic Operation

Key icons

Operations for key icons at the bottom of the screen are as follows.



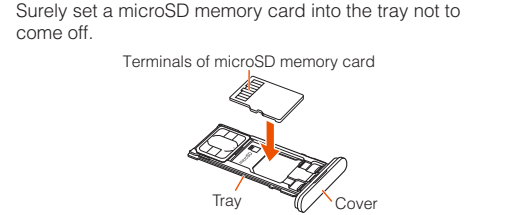

- All of the indicated amounts exclude tax unless otherwise specified.
- Company names and product names referred to in this manual are trademarks or registered trademarks of respective companies. The TM and ® marks may be omitted in this manual.
- "The Company" as appears in the manual refers to the following companies:
Sold by: KDDI CORPORATION, OKINAWA CELLULAR TELEPHONE COMPANY
Manufactured by: Sony Mobile Communications Inc.

2 Set a microSD memory card into the tray with the terminal side facing up
Surely set a microSD memory card into the tray not to come off.

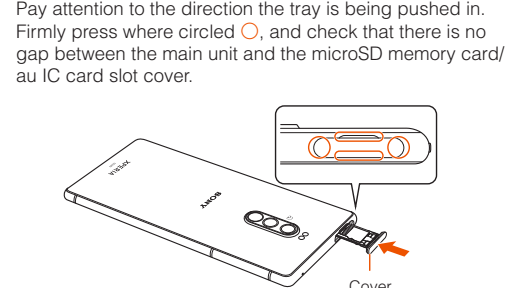

3 Keep the product horizontal and then push the tray in straight
Pay attention to the direction the tray is being pushed in.
Firmly press where circled ○, and check that there is no gap between the main unit and the microSD memory card/au IC card slot cover.

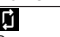

	Return to the previous screen. Close the menu or the Notification panel.
	Tap to display the Home screen. Long-touch to activate Google Assistant.
	Displayed when the product orientation is different than the screen orientation. Tap to change between portrait/horizontal views.

❖Information

- In the Home screen or a screen in which an app is being used, swipe (flick) the key icon display area up for a list of thumbnails of recently used apps where you can activate/ exit apps, etc.

Using the touch panel

The display of the product is a touch panel operated by touching it with your finger.

■ Tap/Double-tap

Tap: Gently touch the screen and then immediately release your finger. Double-tap: Touch the same position twice.

■ Long-touch

Keep touching an item with your finger.

■ Slide

While your finger is gently touching the screen, trace it to the desired direction to move over.

■ Swipe (flick)

Operate the screen by quickly moving (flicking) your finger up/down/left/right.

Getting Ready

Names and functions of parts

- ① Second microphone¹:
Reduces noise so that the other party can easily hear your voice.

② microSD memory card/au IC card slot

③ Notification LED (▶P.7)

④ Proximity/Light sensor:
Switches the touch panel on and off to prevent from erroneous operation during a call/ Auto-control for display brightness.

⑤ Front camera

⑥ Earpiece/Speaker

⑦ Display (Touch panel)

⑧ Mouthpiece/Microphone

⑨ USB Type-C connection terminal

⑩ Speaker

⑪ Volume key/Zoom key

⑫ Fingerprint sensor

⑬ Power key/Screen lock key

⑭ Camera key
- ⑮ Nameplate²

⑯ Flash/Photo light

⑰ RGB-IR sensor:
Detects element of lighting source of shooting environment to adjust white balance automatically when shooting.

⑱ Built-in antenna³

⑲ au IC card

⑳ Ⓜ mark

㉑ Built-in antenna/Wi-Fi® antenna³

㉒ Camera lens

㉓ GPS/Wi-Fi®/Bluetooth® antenna³

㉔ Wi-Fi® antenna³

㉕ Back cover¹

❖Information

- Do not touch the terminal of the microSD memory card.
- Insert a microSD memory card in the appropriate direction. Inserting forcibly could result in removal failure or may cause damage the card.

■ Removing a microSD memory card

1 Remove the tray from the main unit
Put your fingertip (nail) into the groove of the microSD memory card/au IC card slot and draw the cover straight out.

2 Remove the microSD memory card from the tray

3 Keep the product horizontal and then push the tray in straight
Pay attention to the direction the tray is being pushed in.
Firmly press where circled ○, and check that there is no gap between the main unit and the microSD memory card/au IC card slot cover. (▶P.11)

Charging

When you purchase your product, the internal battery is not fully charged. Charge the battery before use.

❖Information

- When charging starts, the Notification LED of the product lights according to the battery level. To check the battery level, see the status bar in the top of the screen, or in the Home screen, slide the screen up ▶[Settings] ▶[Battery].
- If you start charging with the product turned off, a screen launches indicating the charging status but operations are not available. Thus, do not charge the product in a place where the use is prohibited.
- The charging time may take longer when charging with a PC or while using the camera function.

■ **Charging with the AC Adapter**
Charging with connecting TypeC Common AC Adapter 02 (sold separately) is explained.

1 Insert the power plug of TypeC Common AC Adapter 02 (sold separately) into an outlet

Using Side sense

Side sense is a function which supports operations of the product by one-hand. You can operate it with the side edge of the screen.

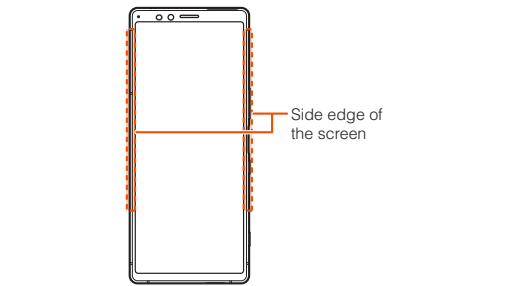

- Double-tap the side edge of the screen to display the Side sense menu which allows you to activate app or turn on/off functions.
- Slide the side edge of the screen down to go back (return to the previous screen).
- Slide the side edge of the screen up to display the multi-window menu.

Displaying the menu

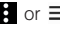
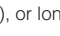
To display the menu; tap the menu icon ( or ), or long touch the input field or item.

- Depending on application/function, color or shape of menu icon, or menu display may differ.

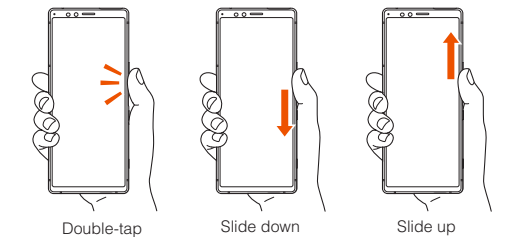

- ❖**Information**
- In the Side sense menu, tap ►[TRY SIDE SENSE TUTORIAL] where you can practice double-tapping and sliding with Side sense.
- To exit the Side sense menu, operate as follows.
 - Tap or .
 - Tap the outside of the Side sense menu
 - Double-tap the side edge of the screen
- When you cannot operate the Side sense function correctly, in the Home screen, slide the screen up ►[Settings] ►[Display] ►[Advanced] ►[Side sense], and then change the Side sense operation settings with "Sensor sensitivity", "Configure touch position", or "Gestures".

Home screen

Home screen consists of multiple pages. Tap to return to the Home screen anytime.

- ① Widgets
- ② Shortcuts (Apps)
 - Long-touch it to display the shortcut menu. You can perform the specified operation or check the app information.
 - When is displayed, long-touch and drag it where to add an operation shortcut to the Home screen.
- ③ Dock
 - Shortcuts (apps) or folder can be located. They are always displayed even when the page of the Home screen is switched.
- ④ Wallpapers
- ⑤ Folders (Google, 基本機能 (Basic functions))
 - Several shortcuts (apps) are stored.
- ⑥ Quick search box
 - Search for apps, contacts, etc., or search with words/phrases entered in the "Google" app.

- ❖**Information**
- When an app has notification, a dot or number may appear on the shortcut (app) or folder.

Using the Apps screen

In the Apps screen, apps which are installed to the product are displayed. Tap the icon to activate the app.

- You may incur communication charges depending on the function.

Starting an app

- 1 In the Home screen, slide the screen up**
- 2 Tap an app icon to use**
 - Some apps are stored in a folder.

Main apps

	Phone		Play Store
	Contacts		Camera
	au-mail		Album
	+メッセージ(SMS) (+Message(SMS))		Maps
	Chrome		Google
	Settings		Gmail
	Calendar		取扱説明書 (Online Manual) (Japanese)
	故障紛失サポート (Repair and Delivery Support)		

Setting app permission

When you activate an app/function that access the functions or information of the product for the first time, a confirmation screen for requesting access permission appears.

If such confirmation screen appears, confirm the content and tap "DENY"/"ALLOW".

- If you do not permit, app/function may not be activated or use of function may be restricted.
- For some apps/functions, an explanation screen for the permission may appear. Several request screens may appear or the screen content may differ. Confirm each content and follow the onscreen instructions.
- In this manual, description of the confirmation screen may be omitted.

Knowing the status of the product

Status bar

You can check the status of the product with the icons displayed on the status bar at the top of the screen. On the left of the status bar, the notification icons appear to inform new mails, operations in progress, etc., and on the right, the status icons appear to indicate signal status, battery level, etc.

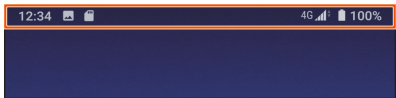

Examples of notification icons

	Missed call
	Incoming call/dialing call/calling
	New PC mail message
	New Gmail message
	New au-mail message
	New +Message/new SMS
	USB device is connected/Moisture is detected on the USB Type-C connection terminal
	Wi-Fi® open network available

Main status icons

	Battery level (100%, Charging)
	Signal level (Level 4 ¹ , Out of service area)
	4G (LTE/WiMAX 2+) data communication status ²
	GSM/UMTS/LTE network roaming is ON
	Silent mode (vibrate) is set
	Silent mode (no vibrate) is set
	Wi-Fi® is connected ¹
	Airplane mode is activated

¹ appears in the right of the icon during communication.

² Two types of network, "LTE" and "WiMAX 2+" can be used. "4G" appears on the screen for both networks.
The company determines which network is less busy depending on the condition of the line to connect.

Appendix

Updating Software

You can update the product to the most recent software for optimal performance and to get the latest enhancements.

- You are charged for the data communication when accessing the Internet from the product via data communication. A large amount of data communication is required especially for upgrading the software (OS upgrading). Using Wi-Fi® connection is recommended.
- You are recommended to back up your data before updating software.
- For details, visit <https://www.sonymobile.co.jp/support/> (Japanese) or refer to the Online Manual or "取扱説明書 (詳細版) (Full instruction manual)" (Japanese) available on au homepage.

Downloading and updating software

The update software can be downloaded from the product directly via Internet.

- Note that when Wi-Fi® communication becomes unstable, data communication takes the place automatically, which may incur communication charges.

- 1 In the Home screen, slide the screen up ►[Settings] ►[System] ►[Advanced] ►[Software update]**
- 2 [:] ►[Refresh]**
 - After that, follow the onscreen instructions.

Information

- Accessories can be purchased from the au Online Shop. <https://onlineshop.au.com/> (Japanese)

Main specifications

Main unit

Display	Approx. 6.5 inches Organic EL (HDR-capable), Approx. 16.77 million colors 1,644 x 3,840 dots
Weight	Approx. 178 g
Dimension (W x H x T)	Approx. 72 mm x 167 mm x 8.2 mm (9.0 mm where thickest)
Internal memory	ROM: Approx. 64 GB RAM: Approx. 6 GB
Camera pixels	Camera: Effective pixels Approx. 12.2 million pixels / 12.2 million pixels Front camera: Effective pixels Approx. 8 million pixels
Continuous call time	In Japan Approx. 1,930 min. Overseas (GSM) Approx. 620 min.
Continuous stand-by time	In Japan Approx. 470 hours Overseas (GSM) Approx. 490 hours

- Note that when changing the model or purchasing an extra terminal, this service only covers the most recently purchased au terminal.
- When an au mobile phone is handed over to you or someone else, the "Repair and Delivery Support" membership is also handed over to the successor of the terminal.
- When you get a new au terminal by changing the model or purchasing an extra terminal, the "Repair and Delivery Support" membership for the old au terminal is automatically canceled.
- Service contents are subject to change without notice.

au IC card

The au IC card is lent to you by au. In case of loss or damage, the card will be replaced at your expense. When a malfunction is suspected, or in case of theft or loss, contact an au shop or Toyota store.

Peripheral devices

- USB Type-C™-3.5 φ conversion/TV Antenna cable 01 (03SOHSA)
- Sony Mobile Desktop Holder 02 (02SOPUA) (sold separately)¹
- TypeC Common AC Adapter 01 (0601PQA) (sold separately)
- TypeC Common AC Adapter 02 (0602PQA) (sold separately)
- Common AC Adapter 05 (0501PWA) (sold separately)²
- Common DC Adapter 03 (0301PEA) (sold separately)²
- Micro-B Type-C Adapter (0601PHA) (sold separately)

¹ Use the Attachment 52B.

² For use, Micro-B Type-C Adapter (sold separately) is needed.

Setting silent mode

If any notification icons are displayed on the status bar, slide down the status bar to open the Notification panel. You can check the contents of notifications or start corresponding apps.

Slide the status bar down with two fingers or slide the Notification panel down to display the quick setting panel. You can set on/off of the functions.

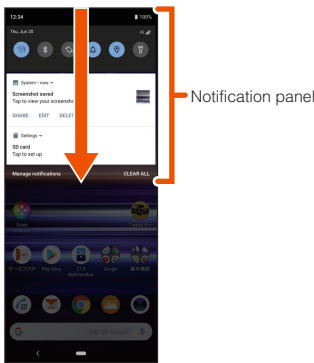

Information

- To delete a notification, swipe (flick) the notification left or right. However, some notifications may not be deleted.
- To close the Notification panel/quick setting panel, tap or slide the Notification panel/quick setting panel up.

Troubleshooting

Before you assume that the product is malfunctioning, perform "クイック診断 (Quick diagnosis)" or "トラブル診断 (Diagnosis for trouble)" in "故障紛失サポート (Repair and Delivery Support)" app.

クイック診断 (Quick diagnosis)

In the Home screen, slide the screen up ►[お客さまサポート (Customer support)] ►[故障紛失サポート (Repair and Delivery Support)] ►[クイック診断してみる (Go to Quick diagnosis)]

トラブル診断 (Diagnosis for trouble)

In the Home screen, slide the screen up ►[お客さまサポート (Customer support)] ►[故障紛失サポート (Repair and Delivery Support)] ►[便利な機能 (Useful functions)] ►[トラブル診断を試す (Go to Diagnosis for trouble)]
Or you can visit the following au homepage.
<https://www.au.com/trouble-check/> (Japanese)



Also refer to "故障とお考えになる前に" (troubleshooting) in the "Online Manual" (Japanese) or "取扱説明書 (詳細版) (Full Instruction Manual)" (Japanese) available on the au homepage.
<https://www.au.com/online-manual/sov40/> (Japanese)
<https://www.au.com/support/service/mobile/guide/manual/> (Japanese)

Setting silent mode

Setting silent mode (vibrate)

- 1 Press the upper or lower part of the volume key**
 - The volume adjusting bar appears.

- 2**
 - The icon on the volume adjusting bar changes to .

Setting the silent mode (no vibrate)

- 1 Press the upper or lower part of the volume key**
 - The volume adjusting bar appears.

- 2 ►**
 - The icon on the volume adjusting bar changes to .

Information

- Even in silent mode, sounds for shutter, shooting start/end sound when shooting videos, alarm, playback of video, or music, etc. are not muted.
- Adjusting sound volume with "Ring and notification volume" of "Sound" setting in silent mode cancels silent mode.
- Press Volume key and then drag the volume adjusting bar up/down to adjust volume of media sound. Also, tap to display "Sound" setting where you can change Ring and notification volume, Alarm volume, etc.

Setting Airplane mode

When the airplane mode is set, all wireless functions (phone, packet communication, Wi-Fi® function, Bluetooth® function) are turned off.

- 1 In the Home screen, slide the screen up ►[Settings] ►[Network & internet]**

After-sales service

When asking for repair

For repair, contact Repair and Delivery Support Center.

During the warranty period	Repairs will be done based on the terms of services of the free-of-charge repair warranty.
Outside the warranty period	We shall repair the product for a charge as requested by the customer if repair renders it usable.

* The warranty period is one year from the date you purchased the product.

Information

- Before handing in the product for repair, make a backup of the contents of memory since they may disappear during repair. Note that the Company shall not be liable for any damages and loss of income should the contents of memory be altered or lost.
- Recycled parts that meet the Company's quality standards are sometimes used for repair.
- Your old au terminal collected by replacement mobile phone delivery service is serviced for reuse and recycled as a replacement terminal. Also, parts replaced through au after-sales service are collected and recycled by KDDI. They cannot be returned to customers.
- The product which is processed, remodeled, analyzed (including by modifying or analyzing the software (including by rooting etc.), reverse engineering, decompiling), or repaired by an unauthorized repair office is not covered by the warranty and repair may be refused.

USB Type-C™-3.5 φ conversion/TV Antenna cable 01

Size	Length Approx. 117 mm
Weight	Approx. 5 g

For inquiries, call: Customer Service Center
For general information (toll free)
Business hours 9:00~20:00 (7 days a week)
au mobile phones (smartphones/feature phones) 157 without area code 0077-7-111
Non-au mobile phones/general subscriber phones

For loss or theft (toll free)
Business hours : 24 hours live support
au mobile phones (smartphones/feature phones) 113 without area code 0077-7-113
Non-au mobile phones/general subscriber phones

Repair and Delivery Support Center
For theft, loss, or malfunction (toll free)
Business hours 9:00~20:00 (7 days a week)
au mobile phones (smartphones/feature phones)/general subscriber phones 0120-925-919

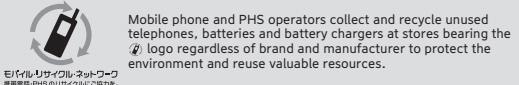

やめましょう、歩きスマホ。
キケン! 水ぬれ充電
あぶない! 電池への衝撃

SONY

Sold by: KDDI CORPORATION, OKINAWA CELLULAR TELEPHONE COMPANY
Manufactured by: Sony Mobile Communications Inc.

June 2019, 1st Edition
1319-5338.1