

Thank you for buying "Xperia™ XZs" (simply called the "product" from here on). In this guide, settings and precautions for using the product are described. *For detailed operations, refer to the "Basic Manual" (Japanese) app installed on the product or "取扱説明書 (詳細版) (Full Instruction Manual)" (Japanese) available on the au homepage.

- **Basic operation**
Describes the basic operations.
- **Initial settings**
When "ようこそ (Welcome)" appears after the product is powered on, make initial settings.
- **E-mail setting**
Make the initial settings for @ezweb.ne.jp etc.
- **Making a call**
Describes how to make a call.
- **Receiving a call**
Describes how to receive a call.
- **Transferring data from au Settings Menu**
Import/export data to/from the product using a microSD memory card or the au server.
- **Setting the brightness of the screen**
Adjusting the brightness is explained.
- **Setting the lighting time of the backlight**
Setting the lighting time is explained.
- **Sending contacts**
Send contacts to another phone.
- **Using "Basic Manual" app**
You can check the detail operation method of the product.

Company names and product names referred to in this manual are trademarks or registered trademarks of respective companies. The TM, ® marks may be omitted in this manual. Screen illustrations shown in this manual may look different from the actual screens. In some cases, minor details or a part of a screen may be omitted.

April 2017, 1st Edition
Sold by: KDDI CORPORATION, OKINAWA CELLULAR TELEPHONE COMPANY
Manufactured by: Sony Mobile Communications Inc.

Basic operation

Status bar
Current status and notification icons are displayed.

Power key/Screen lock key/ Fingerprint sensor
Power ON
Press and hold [Power] for over 1 second.

Screen Lock
Press [Screen Lock] while the screen is displayed. The backlight turns off and screen lock is activated (to avoid false operation of the keys or touch panel).

Unlocking Screen Lock
The lock screen appears when turning the power on or turning on the backlight of the screen by pressing [Screen Lock]. Swipe (flick) the screen up/left to cancel the screen lock. Alternatively, while the lock screen is displayed, touch [Power] to unlock.

Apps key
Tap to display the apps screen.

Task key
Tap to display the list of recently-used apps and activate/exit the app. Also, the split screen is available.

Home key
Tap to display the Home screen.

Back key
Tap to return to the previous screen.

Display (Touch panel)
Operate directly touching with your finger.

Displaying menu
There are two types for displaying the screen menu: tapping [Menu] and long touching an input field or item.

Opening the Notification panel

If any notification icons are displayed on the left side of the status bar, slide down the status bar to open the Notification panel. You can check details of notification icons, start corresponding apps, etc.

Slide the status bar down with two fingers or slide the Notification panel down to display the quick setting panel. You can set on/off of the functions.

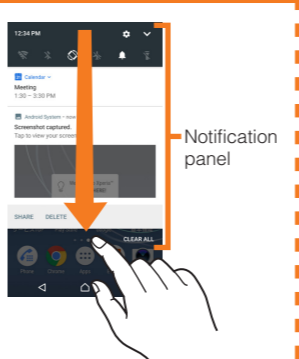

Touch panel operations

- **Tap/Double-tap**
Tap: Gently touch a screen and then immediately release your finger. Double-tap: Touch the same position twice.
- **Slide**
While your finger is gently touching the screen, trace it to the desired direction to move over.
- **Pinch**
Touch the screen with two fingers and widen (pinch-out) or narrow (pinch-in) the fingers' distance.
- **Long-touch**
Keep touching an item with your finger.
- **Swipe (flick)**
Operate the screen by quickly moving (flicking) your finger up/down/left/right.
- **Drag**
Keep touching an item or icon, trace it to the desired direction to move.

Setting app permission

When you first activate an app/function that access the functions or information of the product, a confirmation screen for requesting access permission appears.

If such confirmation screen appears, confirm the content and tap "DENY"/"ALLOW".

- If you do not permit, app/function may not be activated or use of function may be restricted.
- For some apps/functions, an explanation screen for the permission may appear. A confirmation screen may appear in several times and screen content may vary. Confirm each content and follow the onscreen instructions.
- In this manual, description of the confirmation screen may be omitted.

Character entry

Use software keyboard to enter characters. The software keyboard appears when you tap the entry field for registering a contact, composing a mail, etc.

Software keyboard
With "SwiftKey Keyboard", you can use QWERTY keyboard to enter characters, the numeric keypad to enter numbers and symbols, and the symbol keypad for more symbols.

- Tap [Numeric] to display the numeric keypad. For the symbol keypad, tap [Symbol] on the numeric keypad.
- Tap [Symbol] at the left edge of the candidate area to make advanced settings for SwiftKey keyboard.

Initial settings

When "ようこそ (Welcome)" appears after the product is powered on, follow the onscreen instructions to set functions and services.

- **STEP START: Starting basic settings**
Confirm the language and tap "開始する"/"GET STARTED".
 - To change the language, tap "日本語 (Japanese)" to open the language list, select "English (United States)", and tap "OK".
 - When you tap "VISUAL AIDS", the setting of accessibility functions can be made.
 - Alternatively, after the initial setting is complete, from the Home screen, tap [Settings] → [設定 (Settings)] → [言語と入力 (Languages & input)] → [言語 (Languages)] → [言語を追加 (Add a language)] and select "English" → "United States", and then drag the "≡" of "English (United States)" up to the top of the language list.
- **STEP 1: Setting important information**
Confirm applying the data communication charge and mark/unmark the collection of anonymous data/statistical information → [ACCEPT].
 - Alternatively, after the initial settings, operate from the Home screen, [Settings] → [About phone] → [Usage info settings] to set.
- **STEP 2: Selecting setup method**
Tap "Set up as new".
 - To use the data of the other Android phone etc. successively, tap "Copy your data" and then follow the onscreen instruction.
- **STEP 3: Setting up the network connection**
Tap "See all Wi-Fi networks"/"Use cellular network for setup".
 - When you select "Use cellular network for setup", tap "CONTINUE" to proceed to "STEP 5".
 - When you tap "Don't use any network for setup", making the settings of Google account etc. that the network connection is required cannot be made. Tap "CONTINUE" and then follow the onscreen instructions.
- **STEP 4: Setting Wi-Fi® connection**
You can use a home wireless LAN (Wi-Fi®) or public wireless LAN to access the Internet services. Operate in a place where signal of Wi-Fi® network can be received.

- Wi-Fi® network with [Open] is open network.
- Wi-Fi® network with [Lock] is protected by security. To connect, enter a password (security key).
- To add a Wi-Fi® network manually, operate from [Add new network] → Enter a network name (SSID) etc. → [SAVE]. Check the necessary information for the connection in advance.
- To detect Wi-Fi® networks manually or make the advanced settings of Wi-Fi®, after the initial settings, operate from the Home screen, [Settings] → [Wi-Fi] → [Refresh], or operate from the Home screen, [Settings] → [Wi-Fi] → [Wi-Fi].

Selecting from the detected Wi-Fi® network and set.
When you select a protected Wi-Fi® network, you need to enter a password (security key).

1 Select Wi-Fi® network

2 Enter a password (security key) → [CONNECT]

STEP 5: Setting up a Google account

Set up a Google account so that you can synchronize with Gmail, contacts of online service, calendar, etc. Setting for creating new Google account is explained here.

- If you set up a Google account, you can use Google apps such as "Gmail" or "Google Play".
- Gmail's mail address (user name) @gmail.com is automatically created from the user name set with a Google account.
- Although you can use the product without setting a Google account, some apps using Google account cannot be used. When you activate the app, the setup screen for Google account appears.

1 [More options] → [Create account]

2 Enter "First name", "Last name" → [NEXT]

3 Enter your birthday and gender → [NEXT]

4 Enter a user name → [NEXT]²

5 Enter a password → [NEXT]

6 Confirm the phone number³ → [NEXT] → [VERIFY]

7 [I AGREE] → [NEXT]

8 [NEXT]

*1 If you have a Google account, enter the Gmail mail address or the phone number and tap "NEXT", and then follow the onscreen instructions.
*2 Checking registration of username starts. If a username is unavailable, an entry screen for prompting another user name appears.
*3 The phone number of your au IC card is entered automatically. When you enter another phone number, enter the notified verification code and then tap "NEXT".

STEP 6: Setting the unlock method by using fingerprint

Set whether to use the fingerprint authentication function. Tap "ADD FINGERPRINT" and then follow the onscreen instructions. If you do not register your fingerprint, [SKIP] → [SKIP ANYWAY].

- If you register your fingerprint or unlock method of the screen lock, the setting screen of "Anything else?" appears after "STEP 10". Follow the onscreen instructions.
- Alternatively, after the initial settings, operate from the Home screen, [Settings] → [Lock screen & security] → [Fingerprint Manager] to set.

STEP 7: Setting Google services

Set the Google services such as backup etc. Confirm the settings → [NEXT].

STEP 8: Setting Google apps

Setting the Google apps permission. [CONTINUE] → Confirm the content of the app permission → [No thanks]/[YES I'M IN].

STEP 9: Setting Xperia™ services

Sign in for using Xperia™ services. Select the account and follow the onscreen instructions. If you do not sign in, [Not now] → [SKIP].

STEP 10: Setting the Xperia Intelligence engine™

Set the permission of Xperia Intelligence engine™ Tap "NEXT" and then follow the onscreen instructions.

STEP 11: Setting the Accelerated Location

Set whether to allow collection of location data. Mark/Unmark the "Location consent" → [NEXT].

STEP 12: Completion of setup

When the setup completion screen appears, tap "FINISH".

au Easy Setting

Set au convenient functions or services.

- By setting au ID, you can use various services provided by au such as auスマートパス (au Smart Pass) or "au Kantan Kessai", which allows you to purchase apps from Google Play.
- * au ID which is already used by another user cannot be set.
- Alternatively, after the initial setting is complete, from the Home screen, tap [Settings] → [au Settings Menu] → [au Easy Setting].

1 [Next]

2 Select "Register au ID" → [Next]

3 [au IDの設定・保存 (Set/save au ID)]

4 Enter a security code → [OK]

5 Set password → [設定 (Set)] → [終了 (Exit)]

6 Select "Update" → [Next]

7 Confirm terms of service → Select "Agree" → [Next] → [Agree]

8 Select "Turn Auto Backup on" or "Turn Auto Backup off" → [Next]

9 Select "Activate" or "Skip activation" → [Next]

10 Select "Activate" or "Skip activation" → [Next]

11 Select "Activate" or "Skip activation" → [Next]

12 Mark data to be restored → [次へ (Next)]

13 Mark apps to install → [次へ (Next)]

14 [Finish]

* The screens of step from 8 to 12 appear only if "Agree" is selected in step 7.
* To complete the initial setting of Lookout for au, permit the access permission on the each request screen appeared after step 11.

E-mail setting

This is an au service with which you can send/receive mails using E-mail (@ezweb.ne.jp).
 To use E-mail (@ezweb.ne.jp), subscription to LTE NET is required. If you did not subscribe it when you purchased the product, contact an au shop or Customer Service Center.
 Your E-mail address is determined automatically after initial setting. You can change the E-mail address later.
 * For model change from au mobile phone, E-mail address used on the previous model can be used continuously after initial settings.
 * The initial setting cannot be made via Wi-Fi® communication.

Initial settings

- From the Home screen, [🏠]
- Checking E-mail address→[閉じる (Close)]
- Confirm the content→[同意する (Agree)]/[同意しない (Disagree)]→[完了 (Done)]
 * When an explanation screen for Email function appears, follow the onscreen instructions.

Checking E-mail address

- From the Home screen, [🏠]
- [E-mail information]→[Check your E-mail address]

Changing E-mail address

- From the Home screen, [🏠]
- [E-mail settings]
- [Change Address/Setting Filter]
- [Eメールアドレスの変更へ (To change E-mail address)]
- Enter the security code→[送信 (Send)]→Confirm the content→[承諾する (I agree)]
- Enter E-mail address→[送信 (Send)]→[OK]

PC-mail

You can use mail addresses except for E-mail (@ezweb.ne.jp).
 To use PC-mail, set up PC-mail account. For the first time use, set up as follows.
 From the Home screen, [🏠]→[Email (📧)]→[GET STARTED]→Enter email address→[NEXT]→Enter a password→[NEXT]→Select the sync option→[NEXT]→Select the notification option→[NEXT]→Enter an account name and a name as sender→[FINISH SETUP]
 *For details, refer to the "Basic Manual" (Japanese) app installed on the product or "取扱説明書 (詳細版) (Full Instruction Manual)" (Japanese) available on the au homepage.

Restoring the backed up E-mail data

- From the Home screen, [🏠]
- [E-mail settings]
- [Backup/Restore]
- [Restore mails]
- Select the mails to restore→[OK]→Mark the backup data to restore→[OK]
- [Add]/[Overwrite]→[OK]

●When you select "Overwrite", all E-mail data saved in "Inbox"/"Outbox"/"Unsent" is deleted (including protected mails and unread mails) according to the mail type and the backup mail data is restored.

Making a call

Direct input calling

- From the Home screen, [☎️]
- [DIAL]
- Enter a phone number→[📞]

Calling from Contacts

- From the Home screen, [🏠]→[Contacts]
- Tap a contact to call
- [📞]/phone number

Calling from call log

From the Home screen, [🏠]→Tap [📞] tab→[📞] of the history to make a call.

Calling overseas from au mobile phones (au International Call Service)

You can make international calls without any special procedure from the product.
 On the phone number input screen→Enter an access number, country code, area code¹, and the phone number of the other party→[📞]
¹If the area code starts with "0", Enter it without including the "0". There are some exceptions such as fixed-line phones in Italy etc.

Receiving a call

When the backlight is OFF or on the lock screen

- Drag [📞] right
- Start a call
- To end the call, [📞]

●To reject the incoming call, in step 1, drag [📞] left.
 ●To answer with Answering Machine, in step 1, operate [RESPONSE OPTIONS]→[Reject with Answering Machine].

When the backlight is ON (except on the lock screen)

- [ANSWER]
- Start a call
- To end the call, [📞]

●To reject an incoming call, tap "DECLINE" in step 1.
 ●To answer with Answering Machine, tap the upper part of the notification→[RESPONSE OPTIONS]→[Reject with Answering Machine].

Transferring data from au Settings Menu

Import or export data between the product and your previous au mobile phone using microSD memory card or via the au server.

- To import data using the au server, save data to the au server using your previous au mobile phone in advance. To use the au server, set up ID (If there is no au Settings Menu on your previous au mobile phone, use "Friends Note" app or "au Cloud" app).
- To restore data using a microSD memory card, save the data to a microSD memory card using your previous au mobile phone in advance (If there is no au Settings Menu on your previous au mobile phone, use the au backup app).

- From the Home screen, [⚙️]
- [Settings]→[au Settings Menu]
- [Data Transfer]
- [機種変更はこちら (For change of model, tap here)]
 * After that, follow the onscreen instructions.

●To back up photos and contacts to the au server automatically using "Data Storage" app, set by the following operations.
 From the Home screen, [🏠]→[Settings]→[au Settings Menu]→[Backup Setting]→Mark items to be restored automatically

Setting the brightness of the screen

When the screen is dark and you cannot see the screen well, adjust the screen brightness as you like.

- From the Home screen, [⚙️]
- [Settings]→[Display]
- [Brightness level]
- Drag the slider left or right
 * To end the setting, tap [🏠].

●To adjust the screen brightness automatically according to the ambient brightness based on the set value in "Brightness level", operate from the Home screen, [🏠]→[Settings]→[Display]→Tap "●" of "Adaptive brightness" to switch to "●".

Setting the lighting time of the backlight

The screen backlight turns off automatically when the set time is elapsed while no operation is made. When you do not operate readily because the backlight turns off soon, change the lighting time of the backlight.

- From the Home screen, [⚙️]
- [Settings]→[Display]
- [Sleep]
- Select the lighting time

Sending contacts

You can send contacts to another phone.

- From the Home screen, [🏠]
- [Contacts]
- Sending one contact
 Tap a contact to send
- [📧]→[Share]
- Select a contact sending method→Follow the onscreen instructions
 * Operation differs depending on sending method you selected.

Sending several contacts
 3 In the Contact list screen→Long-touch a contact→Mark contacts to send
 4 [📧]→[Share]→Select a method of sending the contact→Follow the onscreen instructions
 * Operation differs depending on the app you selected.

Using "Basic Manual" app

You can check the detail operation method for the product. Some functions can be directly activated from the explanation screen.

- To download apps, you need to set a Google account.

- From the Home screen, [🏠]
- [お客さまサポート (Customer support)]
- [Basic Manual]
- [UPDATE]
- [OPEN]
- Check the content→Tap "X" at the upper left of the screen then close the "Basic Manual" app.

●You can register frequently seen pages to the favorites or find target operations by using the search function.
 ●Tap "使ってみる (Try it)" on the screen to activate an app or open the setting screen.